



Rogers

Assessment Property Record Card for Tax Year 2026

Data provided by LISA DELOZIER County Assessor

Date 04/18/2026
 Time 08:37:42
 Page 1

Assessment Data					Primary Image																																																																																																												
Account 660095878 Parcel ID 000000-00-0-00457-004-0018 Cadastral ID 10-21-14-06330 Property Type REAL - Real Property Property Class URP VI Area 4 Tax Area 40 - OWASSO CITY Name ID 312799 BECKNELL, CRYSTAL 14611 E 111TH PL N OWASSO OK 74055-0000 Parcel Location Situs 14611 E 111TH PL N Subdivision LAKE VALLEY V PHASE I Lot/Block 0018 / 0004 Parcel Size 1 - Lots Sec/Twn/Rng 10 / 21 / 14 / 5 Neighborhood 1059 - R-V04-SW OWASSO School District S021 - OWASSO SCHOOLS																																																																																																																	
Legal Description Lat/Long: 36.31600740 -95.80963867 LAKE VALLEY V - PHASE 1 BLOCK 4 LOT 18																																																																																																																	
Exemptions <table border="1"> <thead> <tr> <th>Code</th> <th>Type</th> <th>Active</th> <th>Maximum</th> <th>Exemption</th> </tr> </thead> <tbody> <tr> <td>H</td> <td>Homestead</td> <td>Yes</td> <td>1,000</td> <td>1,000</td> </tr> </tbody> </table>					Code	Type	Active	Maximum	Exemption	H	Homestead	Yes	1,000	1,000	Building Permits <table border="1"> <thead> <tr> <th>Number</th> <th>Description</th> <th>Opened</th> <th>Closed</th> <th>Amount</th> </tr> </thead> <tbody> <tr> <td>14-0209X</td> <td>R15-NEW 1851 SQ FT SFR</td> <td>03/2014</td> <td>09/2014</td> <td>123,805</td> </tr> </tbody> </table>					Number	Description	Opened	Closed	Amount	14-0209X	R15-NEW 1851 SQ FT SFR	03/2014	09/2014	123,805																																																																																				
Code	Type	Active	Maximum	Exemption																																																																																																													
H	Homestead	Yes	1,000	1,000																																																																																																													
Number	Description	Opened	Closed	Amount																																																																																																													
14-0209X	R15-NEW 1851 SQ FT SFR	03/2014	09/2014	123,805																																																																																																													
Parcel Valuation <table border="1"> <thead> <tr> <th>Source</th> <th>REAL</th> <th>Fair Cash</th> <th>Capped</th> <th>Asmnt Level</th> <th>Assessed</th> <th>Levy Rate</th> <th>97.960</th> <th>Current Tax</th> </tr> </thead> <tbody> <tr> <td>Remove Cap</td> <td>2015</td> <td>Land Value 32,637</td> <td>32,637</td> <td>11%</td> <td>3,590</td> <td>Assessed</td> <td>24,430</td> <td>2,393.16</td> </tr> <tr> <td>Year Frozen</td> <td>0</td> <td>Improvements 220,405</td> <td>189,455</td> <td></td> <td>20,840</td> <td>Penalty</td> <td>0</td> <td></td> </tr> <tr> <td>Uncapped Value</td> <td>0</td> <td>Mobile Home 0</td> <td>0</td> <td></td> <td>0</td> <td>Exemption</td> <td>1,000</td> <td>-98.00</td> </tr> <tr> <td>TIF Project ID</td> <td>0</td> <td>Total Value 253,042</td> <td>222,092</td> <td></td> <td>24,430</td> <td>Total Taxable</td> <td>23,430</td> <td>2,295.00</td> </tr> </tbody> </table>					Source	REAL	Fair Cash	Capped	Asmnt Level	Assessed	Levy Rate	97.960	Current Tax	Remove Cap	2015	Land Value 32,637	32,637	11%	3,590	Assessed	24,430	2,393.16	Year Frozen	0	Improvements 220,405	189,455		20,840	Penalty	0		Uncapped Value	0	Mobile Home 0	0		0	Exemption	1,000	-98.00	TIF Project ID	0	Total Value 253,042	222,092		24,430	Total Taxable	23,430	2,295.00	Sale History <table border="1"> <thead> <tr> <th>Bk/Pg</th> <th>Grantor</th> <th>Date</th> <th>Price</th> <th>Code</th> </tr> </thead> <tbody> <tr> <td>2415/110</td> <td>SIMMONS HOMES RESIDENTIAL</td> <td>07/24/2014</td> <td>178,500</td> <td>YES</td> </tr> <tr> <td>2336/323</td> <td>LAKE VALLEY INVESTMENT</td> <td>06/19/2013</td> <td>0</td> <td>4</td> </tr> </tbody> </table>					Bk/Pg	Grantor	Date	Price	Code	2415/110	SIMMONS HOMES RESIDENTIAL	07/24/2014	178,500	YES	2336/323	LAKE VALLEY INVESTMENT	06/19/2013	0	4																																												
Source	REAL	Fair Cash	Capped	Asmnt Level	Assessed	Levy Rate	97.960	Current Tax																																																																																																									
Remove Cap	2015	Land Value 32,637	32,637	11%	3,590	Assessed	24,430	2,393.16																																																																																																									
Year Frozen	0	Improvements 220,405	189,455		20,840	Penalty	0																																																																																																										
Uncapped Value	0	Mobile Home 0	0		0	Exemption	1,000	-98.00																																																																																																									
TIF Project ID	0	Total Value 253,042	222,092		24,430	Total Taxable	23,430	2,295.00																																																																																																									
Bk/Pg	Grantor	Date	Price	Code																																																																																																													
2415/110	SIMMONS HOMES RESIDENTIAL	07/24/2014	178,500	YES																																																																																																													
2336/323	LAKE VALLEY INVESTMENT	06/19/2013	0	4																																																																																																													
Assessment History <table border="1"> <thead> <tr> <th>Tax Year</th> <th>Statement Number</th> <th>Billed Owner</th> <th>Tax Area</th> <th>Total Value</th> <th>Exemptions</th> <th>Taxable Value</th> <th>Billed Tax</th> </tr> </thead> <tbody> <tr><td>2025</td><td>2025-660095878</td><td>BECKNELL, CRYSTAL</td><td>40</td><td>244,151</td><td>1000</td><td>22,719</td><td>2,226.00</td></tr> <tr><td>2024</td><td>2024-660095878</td><td>BECKNELL, CRYSTAL</td><td>40</td><td>261,704</td><td>1000</td><td>22,027</td><td>2,116.00</td></tr> <tr><td>2023</td><td>2023-660095878</td><td>BECKNELL, CRYSTAL</td><td>40</td><td>236,649</td><td>1000</td><td>21,357</td><td>2,001.00</td></tr> <tr><td>2022</td><td>2022-660095878</td><td>BECKNELL, CRYSTAL</td><td>40</td><td>230,706</td><td>1000</td><td>20,706</td><td>2,029.00</td></tr> <tr><td>2021</td><td>2021-660095878</td><td>BECKNELL, CRYSTAL</td><td>40</td><td>195,013</td><td>1000</td><td>20,073</td><td>1,942.00</td></tr> <tr><td>2020</td><td>2020-660095878</td><td>BECKNELL, CRYSTAL</td><td>40</td><td>189,636</td><td>1000</td><td>19,460</td><td>1,882.00</td></tr> <tr><td>2019</td><td>2019-660095878</td><td>BECKNELL, CRYSTAL</td><td>40</td><td>180,584</td><td>1000</td><td>18,864</td><td>1,827.00</td></tr> <tr><td>2018</td><td>2018-660095878</td><td>BECKNELL, CRYSTAL</td><td>40</td><td>181,951</td><td>1000</td><td>19,015</td><td>1,773.00</td></tr> <tr><td>2017</td><td>2017-660095878</td><td>BECKNELL, CRYSTAL</td><td>40</td><td>180,450</td><td>1000</td><td>18,850</td><td>1,774.00</td></tr> <tr><td>2016</td><td>2016-660095878</td><td>BECKNELL, CRYSTAL</td><td>40</td><td>176,018</td><td>1000</td><td>18,362</td><td>1,735.00</td></tr> <tr><td>2015</td><td>2015-660095878</td><td>BECKNELL, CRYSTAL</td><td>40</td><td>177,638</td><td>1000</td><td>18,540</td><td>1,768.00</td></tr> <tr><td>2014</td><td>2014-660095878</td><td>BECKNELL, CRYSTAL</td><td>40</td><td>6,985</td><td>0</td><td>768</td><td>74.00</td></tr> </tbody> </table>										Tax Year	Statement Number	Billed Owner	Tax Area	Total Value	Exemptions	Taxable Value	Billed Tax	2025	2025-660095878	BECKNELL, CRYSTAL	40	244,151	1000	22,719	2,226.00	2024	2024-660095878	BECKNELL, CRYSTAL	40	261,704	1000	22,027	2,116.00	2023	2023-660095878	BECKNELL, CRYSTAL	40	236,649	1000	21,357	2,001.00	2022	2022-660095878	BECKNELL, CRYSTAL	40	230,706	1000	20,706	2,029.00	2021	2021-660095878	BECKNELL, CRYSTAL	40	195,013	1000	20,073	1,942.00	2020	2020-660095878	BECKNELL, CRYSTAL	40	189,636	1000	19,460	1,882.00	2019	2019-660095878	BECKNELL, CRYSTAL	40	180,584	1000	18,864	1,827.00	2018	2018-660095878	BECKNELL, CRYSTAL	40	181,951	1000	19,015	1,773.00	2017	2017-660095878	BECKNELL, CRYSTAL	40	180,450	1000	18,850	1,774.00	2016	2016-660095878	BECKNELL, CRYSTAL	40	176,018	1000	18,362	1,735.00	2015	2015-660095878	BECKNELL, CRYSTAL	40	177,638	1000	18,540	1,768.00	2014	2014-660095878	BECKNELL, CRYSTAL	40	6,985	0	768	74.00
Tax Year	Statement Number	Billed Owner	Tax Area	Total Value	Exemptions	Taxable Value	Billed Tax																																																																																																										
2025	2025-660095878	BECKNELL, CRYSTAL	40	244,151	1000	22,719	2,226.00																																																																																																										
2024	2024-660095878	BECKNELL, CRYSTAL	40	261,704	1000	22,027	2,116.00																																																																																																										
2023	2023-660095878	BECKNELL, CRYSTAL	40	236,649	1000	21,357	2,001.00																																																																																																										
2022	2022-660095878	BECKNELL, CRYSTAL	40	230,706	1000	20,706	2,029.00																																																																																																										
2021	2021-660095878	BECKNELL, CRYSTAL	40	195,013	1000	20,073	1,942.00																																																																																																										
2020	2020-660095878	BECKNELL, CRYSTAL	40	189,636	1000	19,460	1,882.00																																																																																																										
2019	2019-660095878	BECKNELL, CRYSTAL	40	180,584	1000	18,864	1,827.00																																																																																																										
2018	2018-660095878	BECKNELL, CRYSTAL	40	181,951	1000	19,015	1,773.00																																																																																																										
2017	2017-660095878	BECKNELL, CRYSTAL	40	180,450	1000	18,850	1,774.00																																																																																																										
2016	2016-660095878	BECKNELL, CRYSTAL	40	176,018	1000	18,362	1,735.00																																																																																																										
2015	2015-660095878	BECKNELL, CRYSTAL	40	177,638	1000	18,540	1,768.00																																																																																																										
2014	2014-660095878	BECKNELL, CRYSTAL	40	6,985	0	768	74.00																																																																																																										



Rogers

Assessment Property Record Card for Tax Year 2026

Data provided by LISA DELOZIER County Assessor

Date 04/18/2026
Time 08:37:43
Page 2

Lot Data		Square-Foot - NBHD 1059 #1	
Lot Size	0	0	
Lot Count	1		
Units Buildable			
Non-Ag Acres	0.1414		
Topography			
Street Access			
Utilities			
Amenities			0
			0
Method	Square-Foot		
Base Lot Value	6,158.00 x 5.30 = 32,637		
Factor Value			
Adjustments	1.0000		
Lot Value	32,637		



\\tsclient\T\LOGAN\LOGAN RESIDENTIAL VI\2022-7-20\IMG_001 7/20/2022

Residential Data	
Type	1 Single Family Residence
Condition	3 - Average
Quality	2.5 - Fair
Architecture	
Style	100% One Story
Exterior Wall	100% Veneer, Masonry
Base/Total Area	1,853 / 1,853
Style	100% One Story
HVAC	100% Warmed & Cooled Air
Roof Cover	1 Composition Shingle
Area on Slab	1,853
Fixture/RghIn	11 /
Bed/F/H Bath	3 / 2.0 /
Basement Area	
Garage Type	400 Attached Garage - Unfinished
Remodel	
Year/Eff Age	2014 / 9

GRM Approach	
GRM Code	
Gross Rent	0.00
Indicated Value	

Multiple Regression			
MRA Code	1	Test	
Adusted R	0.8445		
Indicated Value	218,886	118.13	Per SqFt

Direct Comparables	
Selection Model	A Adam Test
Adjustment Model	1 2022 Residential
Comparables	8
Indicated Value	222,360 Per SqFt

Cost Approach		Manual : 01/2025	
Base Cost	102.33	Total Misc Impr	+ 2,310
Roofing Adj	+ 4.34	Garage Cost	+ 11,700
Subfloor Adj	+ -1.14	Total RCN	= 244,894
Heat/Cool Adj	+ 11.47	Depreciation (10%)	- 24,489
Plumbing Adj	+ 7.60	Lump Sums	+ 0
Basement Adj	+ 0.00	RCNLD	= 220,405
Adj Base Cost	= 124.60	Lot Value	+ 32,637
Total Area	x 1,853	Indicated Value	= 253,042
Adjusted Cost	= 230,884	Value Per SqFt	136.56

Value Reconciliation			
Selected Approach	Cost Approach		
Improvements	220,405		
Lot Value	32,637		
Indicated Value	253,042	136.56	Per SqFt
Agland Value			
Site Improvements			
Total Value	253,042	136.56	Total Value Per SqFt

Miscellaneous Improvements								
Code	Description	Sketch ID	Size	Year	Units	Unit Cost	Depr	Value
PRCH	SLAB PORCH - COVERED	120090	13x6		78	24.02		1,874
PRCH	SLAB PORCH - COVERED	120091	6x3		18	24.21		436



Rogers
Assessment Property Record Card for Tax Year 2026
 Data provided by LISA DELOZIER County Assessor

Date 04/18/2026
 Time 08:37:43
 Page 3

Sketch Image

660095878

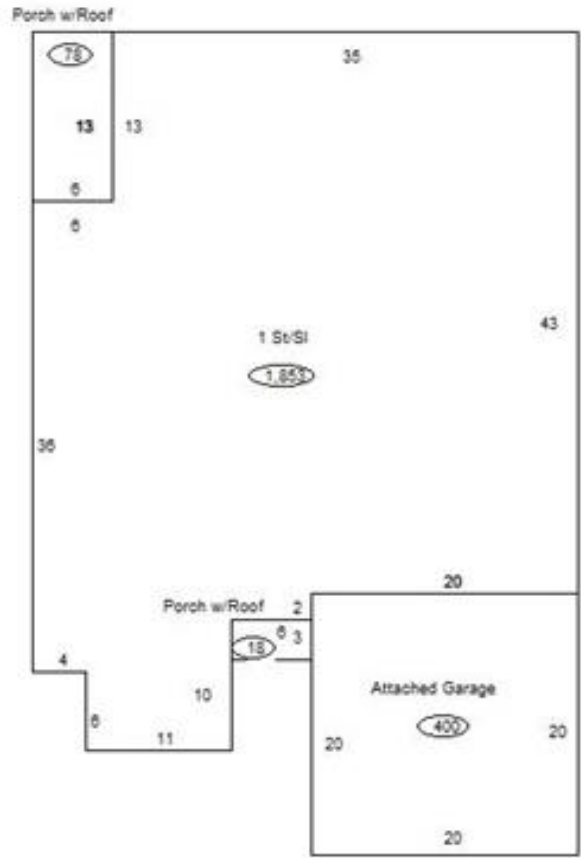

Sketch Vector Information

Sequence	Code	Type	Built Over	Scale	Section Label	Base Area	Multiplier	Total Area
1	R	1	Slab	13	1 St/Sl	1,853	1.000	1,853
2	G	1		13	Attached Garage	400	1.000	400
3	M	PRCH		13	SLBC	78	1.000	78
4	M	PRCH		13	SLBC	18	1.000	18
Total Building Area						1,853		1,853