



Rogers

Assessment Property Record Card for Tax Year 2026

Data provided by LISA DELOZIER County Assessor

Date 04/18/2026
Time 08:38:05
Page 1

Assessment Data					Primary Image																																																																																																												
Account 660095895 Parcel ID 000000-00-0-00673-001-0001 Cadastral ID 31-21-15-04550 Property Type REAL - Real Property Property Class RRP VI Area 4 Tax Area 7 - OWASSO/LIMESTONE FIRE Name ID 327631 RONNEKAMP, GEORGE STEPHEN & NELDA CAROLYN REVOCABLE LIVING TRUST 6910 N 194TH E AVE OWASSO OK 74055-0000																																																																																																																	
Parcel Location Situs 06910 N 194TH E AVE Subdivision RIDGE, THE Lot/Block 0001 / 0001 Parcel Size 1 - Lots Sec/Twn/Rng 31 / 21 / 15 / 5 Neighborhood 1074 - R-V01,3,4-SW OWASSO CATOOSA School District S021 - OWASSO SCHOOLS																																																																																																																	
Legal Description Lat/Long: 36.25393622 -95.75797278 RIDGE, THE BLOCK 1 LOT 1					Building Permits <table border="1"> <thead> <tr> <th>Number</th> <th>Description</th> <th>Opened</th> <th>Closed</th> <th>Amount</th> </tr> </thead> <tbody> <tr> <td>R204 11 14</td> <td>R16-NEW 2583 SQ FT SFR</td> <td>11/2014</td> <td>08/2015</td> <td>210,000</td> </tr> </tbody> </table>					Number	Description	Opened	Closed	Amount	R204 11 14	R16-NEW 2583 SQ FT SFR	11/2014	08/2015	210,000																																																																																														
Number	Description	Opened	Closed	Amount																																																																																																													
R204 11 14	R16-NEW 2583 SQ FT SFR	11/2014	08/2015	210,000																																																																																																													
Exemptions <table border="1"> <thead> <tr> <th>Code</th> <th>Type</th> <th>Active</th> <th>Maximum</th> <th>Exemption</th> </tr> </thead> <tbody> <tr> <td>H</td> <td>Homestead</td> <td>Yes</td> <td>1,000</td> <td>1,000</td> </tr> </tbody> </table>					Code	Type	Active	Maximum	Exemption	H	Homestead	Yes	1,000	1,000	Sale History <table border="1"> <thead> <tr> <th>Bk/Pg</th> <th>Grantor</th> <th>Date</th> <th>Price</th> <th>Code</th> </tr> </thead> <tbody> <tr> <td>/</td> <td>BARNES, STEPHEN W & CYNTHIA K</td> <td>05/10/2019</td> <td>364,000</td> <td>YES</td> </tr> <tr> <td>2506/836</td> <td>EXECUTIVE HOMES LLC</td> <td>10/16/2015</td> <td>343,500</td> <td>YES</td> </tr> <tr> <td>2444/88</td> <td>KNEES SHALL BOW LLC</td> <td>11/10/2014</td> <td>0</td> <td>4</td> </tr> </tbody> </table>					Bk/Pg	Grantor	Date	Price	Code	/	BARNES, STEPHEN W & CYNTHIA K	05/10/2019	364,000	YES	2506/836	EXECUTIVE HOMES LLC	10/16/2015	343,500	YES	2444/88	KNEES SHALL BOW LLC	11/10/2014	0	4																																																																										
Code	Type	Active	Maximum	Exemption																																																																																																													
H	Homestead	Yes	1,000	1,000																																																																																																													
Bk/Pg	Grantor	Date	Price	Code																																																																																																													
/	BARNES, STEPHEN W & CYNTHIA K	05/10/2019	364,000	YES																																																																																																													
2506/836	EXECUTIVE HOMES LLC	10/16/2015	343,500	YES																																																																																																													
2444/88	KNEES SHALL BOW LLC	11/10/2014	0	4																																																																																																													
Parcel Valuation <table border="1"> <thead> <tr> <th>Source</th> <th>REAL</th> <th>Fair Cash</th> <th>Capped</th> <th>Asmnt Level</th> <th>Assessed</th> <th>Levy Rate</th> <th>108.538</th> <th>Current Tax</th> </tr> </thead> <tbody> <tr> <td>Remove Cap</td> <td>2020</td> <td>Land Value 64,644</td> <td>64,644</td> <td>11%</td> <td>7,111</td> <td>Assessed</td> <td>46,061</td> <td>4,999.37</td> </tr> <tr> <td>Year Frozen</td> <td>0</td> <td>Improvements 363,913</td> <td>354,090</td> <td></td> <td>38,950</td> <td>Penalty</td> <td>0</td> <td></td> </tr> <tr> <td>Uncapped Value</td> <td>0</td> <td>Mobile Home 0</td> <td>0</td> <td></td> <td>0</td> <td>Exemption</td> <td>1,000</td> <td>-97.00</td> </tr> <tr> <td>TIF Project ID</td> <td>0</td> <td>Total Value 428,557</td> <td>418,734</td> <td></td> <td>46,061</td> <td>Total Taxable</td> <td>45,061</td> <td>4,902.00</td> </tr> </tbody> </table>										Source	REAL	Fair Cash	Capped	Asmnt Level	Assessed	Levy Rate	108.538	Current Tax	Remove Cap	2020	Land Value 64,644	64,644	11%	7,111	Assessed	46,061	4,999.37	Year Frozen	0	Improvements 363,913	354,090		38,950	Penalty	0		Uncapped Value	0	Mobile Home 0	0		0	Exemption	1,000	-97.00	TIF Project ID	0	Total Value 428,557	418,734		46,061	Total Taxable	45,061	4,902.00																																																											
Source	REAL	Fair Cash	Capped	Asmnt Level	Assessed	Levy Rate	108.538	Current Tax																																																																																																									
Remove Cap	2020	Land Value 64,644	64,644	11%	7,111	Assessed	46,061	4,999.37																																																																																																									
Year Frozen	0	Improvements 363,913	354,090		38,950	Penalty	0																																																																																																										
Uncapped Value	0	Mobile Home 0	0		0	Exemption	1,000	-97.00																																																																																																									
TIF Project ID	0	Total Value 428,557	418,734		46,061	Total Taxable	45,061	4,902.00																																																																																																									
Assessment History <table border="1"> <thead> <tr> <th>Tax Year</th> <th>Statement Number</th> <th>Billed Owner</th> <th>Tax Area</th> <th>Total Value</th> <th>Exemptions</th> <th>Taxable Value</th> <th>Billed Tax</th> </tr> </thead> <tbody> <tr><td>2025</td><td>2025-660095895</td><td>RONNEKAMP, GEORGE STEPHEN &</td><td>7</td><td>413,963</td><td>1000</td><td>43,719</td><td>4,756.00</td></tr> <tr><td>2024</td><td>2024-660095895</td><td>RONNEKAMP, GEORGE STEPHEN &</td><td>7</td><td>442,810</td><td>1000</td><td>42,417</td><td>4,695.00</td></tr> <tr><td>2023</td><td>2023-660095895</td><td>RONNEKAMP, GEORGE STEPHEN &</td><td>7</td><td>383,202</td><td>1000</td><td>41,152</td><td>4,458.00</td></tr> <tr><td>2022</td><td>2022-660095895</td><td>RONNEKAMP, GEORGE STEPHEN &</td><td>7</td><td>377,691</td><td>1000</td><td>40,546</td><td>4,565.00</td></tr> <tr><td>2021</td><td>2021-660095895</td><td>RONNEKAMP, STEVE &</td><td>7</td><td>370,049</td><td>1000</td><td>39,705</td><td>4,422.00</td></tr> <tr><td>2020</td><td>2020-660095895</td><td>RONNEKAMP, STEVE &</td><td>7</td><td>364,142</td><td>0</td><td>40,056</td><td>4,441.00</td></tr> <tr><td>2019</td><td>2019-660095895</td><td>RONNEKAMP, STEVE &</td><td>7</td><td>346,423</td><td>1000</td><td>37,107</td><td>4,131.00</td></tr> <tr><td>2018</td><td>2018-660095895</td><td>BARNES, STEPHEN W & CYNTHIA K</td><td>7</td><td>355,127</td><td>1000</td><td>38,064</td><td>4,101.00</td></tr> <tr><td>2017</td><td>2017-660095895</td><td>BARNES, STEPHEN W & CYNTHIA K</td><td>7</td><td>352,219</td><td>1000</td><td>37,744</td><td>4,103.00</td></tr> <tr><td>2016</td><td>2016-660095895</td><td>BARNES, STEPHEN W & CYNTHIA K</td><td>7</td><td>343,389</td><td>1000</td><td>36,773</td><td>4,001.00</td></tr> <tr><td>2015</td><td>2015-660095895</td><td>EXECUTIVE HOMES LLC</td><td>7</td><td>9,770</td><td>0</td><td>1,075</td><td>117.00</td></tr> <tr><td>2014</td><td>2014-660095895</td><td>KNEES SHALL BOW LLC</td><td>7</td><td>9,770</td><td>0</td><td>1,075</td><td>118.00</td></tr> </tbody> </table>										Tax Year	Statement Number	Billed Owner	Tax Area	Total Value	Exemptions	Taxable Value	Billed Tax	2025	2025-660095895	RONNEKAMP, GEORGE STEPHEN &	7	413,963	1000	43,719	4,756.00	2024	2024-660095895	RONNEKAMP, GEORGE STEPHEN &	7	442,810	1000	42,417	4,695.00	2023	2023-660095895	RONNEKAMP, GEORGE STEPHEN &	7	383,202	1000	41,152	4,458.00	2022	2022-660095895	RONNEKAMP, GEORGE STEPHEN &	7	377,691	1000	40,546	4,565.00	2021	2021-660095895	RONNEKAMP, STEVE &	7	370,049	1000	39,705	4,422.00	2020	2020-660095895	RONNEKAMP, STEVE &	7	364,142	0	40,056	4,441.00	2019	2019-660095895	RONNEKAMP, STEVE &	7	346,423	1000	37,107	4,131.00	2018	2018-660095895	BARNES, STEPHEN W & CYNTHIA K	7	355,127	1000	38,064	4,101.00	2017	2017-660095895	BARNES, STEPHEN W & CYNTHIA K	7	352,219	1000	37,744	4,103.00	2016	2016-660095895	BARNES, STEPHEN W & CYNTHIA K	7	343,389	1000	36,773	4,001.00	2015	2015-660095895	EXECUTIVE HOMES LLC	7	9,770	0	1,075	117.00	2014	2014-660095895	KNEES SHALL BOW LLC	7	9,770	0	1,075	118.00
Tax Year	Statement Number	Billed Owner	Tax Area	Total Value	Exemptions	Taxable Value	Billed Tax																																																																																																										
2025	2025-660095895	RONNEKAMP, GEORGE STEPHEN &	7	413,963	1000	43,719	4,756.00																																																																																																										
2024	2024-660095895	RONNEKAMP, GEORGE STEPHEN &	7	442,810	1000	42,417	4,695.00																																																																																																										
2023	2023-660095895	RONNEKAMP, GEORGE STEPHEN &	7	383,202	1000	41,152	4,458.00																																																																																																										
2022	2022-660095895	RONNEKAMP, GEORGE STEPHEN &	7	377,691	1000	40,546	4,565.00																																																																																																										
2021	2021-660095895	RONNEKAMP, STEVE &	7	370,049	1000	39,705	4,422.00																																																																																																										
2020	2020-660095895	RONNEKAMP, STEVE &	7	364,142	0	40,056	4,441.00																																																																																																										
2019	2019-660095895	RONNEKAMP, STEVE &	7	346,423	1000	37,107	4,131.00																																																																																																										
2018	2018-660095895	BARNES, STEPHEN W & CYNTHIA K	7	355,127	1000	38,064	4,101.00																																																																																																										
2017	2017-660095895	BARNES, STEPHEN W & CYNTHIA K	7	352,219	1000	37,744	4,103.00																																																																																																										
2016	2016-660095895	BARNES, STEPHEN W & CYNTHIA K	7	343,389	1000	36,773	4,001.00																																																																																																										
2015	2015-660095895	EXECUTIVE HOMES LLC	7	9,770	0	1,075	117.00																																																																																																										
2014	2014-660095895	KNEES SHALL BOW LLC	7	9,770	0	1,075	118.00																																																																																																										



Rogers

Assessment Property Record Card for Tax Year 2026

Data provided by LISA DELOZIER County Assessor

Date 04/18/2026
Time 08:38:06
Page 2

Lot Data		Square-Foot - NBHD 1074 #1	
Lot Size	0	0	
Lot Count	1		
Units Buildable			
Non-Ag Acres	0.4947		
Topography			
Street Access			
Utilities			
Amenities	LAND QUALITY		0
	LAND USE		0
Method	Square-Foot		
Base Lot Value	21,548.00 x 3.00 = 64,644		
Factor Value			
Adjustments	1.0000		
Lot Value	64,644		



\\tsclient\C\Users\Randy Necessary\Pictures\101_0628\IMG_0004. 6/28/2022

Residential Data	
Type	1 Single Family Residence
Condition	3 - Average
Quality	4 - Good
Architecture	
Style	100% One Story
Exterior Wall	95% Veneer, Masonry 5% Veneer, Stone
Base/Total Area	2,508 / 2,508
Style	100% One Story
HVAC	100% Warmed & Cooled Air
Roof Cover	1 Composition Shingle
Area on Slab	2,508
Fixture/RghIn	14 /
Bed/F/H Bath	4 / 2.5 /
Basement Area	
Garage Type	700 Attached Garage - Unfinished
Remodel	
Year/Eff Age	2015 / 8

GRM Approach	
GRM Code	
Gross Rent	0.00
Indicated Value	

Multiple Regression			
MRA Code	1	Test	
Adjusted R	0.8445		
Indicated Value	380,092	151.55	Per SqFt

Direct Comparables			
Selection Model	A	Adam Test	
Adjustment Model	1	2022 Residential	
Comparables	8		
Indicated Value	483,840		Per SqFt

Cost Approach		Manual : 01/2025	
Base Cost	113.31	Total Misc Impr	+ 10,254
Roofing Adj	+ 5.82	Garage Cost	+ 31,927
Subfloor Adj	+ -4.59	Total RCN	= 395,558
Heat/Cool Adj	+ 16.31	Depreciation (8%)	- 31,645
Plumbing Adj	+ 10.05	Lump Sums	+ 0
Basement Adj	+ 0.00	RCNLD	= 363,913
Adj Base Cost	= 140.90	Lot Value	+ 64,644
Total Area	x 2,508	Indicated Value	= 428,557
Adjusted Cost	= 353,377	Value Per SqFt	170.88

Value Reconciliation			
Selected Approach	Cost Approach		
Improvements	363,913		
Lot Value	64,644		
Indicated Value	428,557	170.88	Per SqFt
Agland Value			
Site Improvements			
Total Value	428,557	170.88	Total Value Per SqFt

Miscellaneous Improvements								
Code	Description	Sketch ID	Size	Year	Units	Unit Cost	Depr	Value
PRCH	SLAB PORCH - COVERED	124258	258		258	32.07		8,274
PRCH	SLAB PORCH - COVERED	124259	60		60	33.00		1,980



Rogers

Assessment Property Record Card for Tax Year 2026

Data provided by LISA DELOZIER County Assessor

Date 04/18/2026

Time 08:38:06

Page 3

Sketch Image

660095895

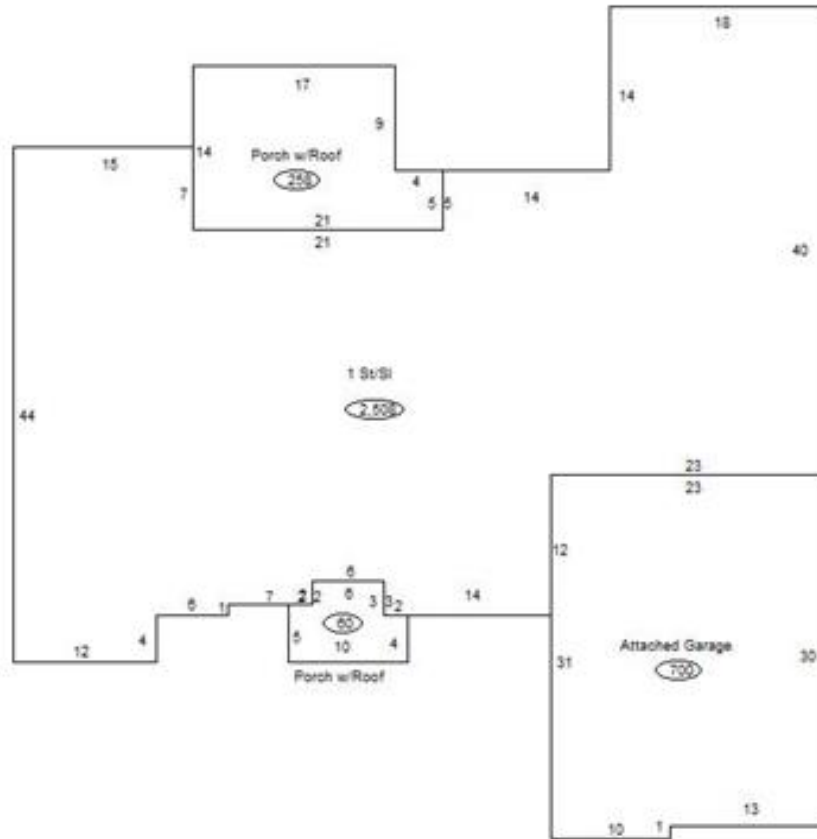

Sketch Vector Information

Sequence	Code	Type	Built Over	Scale	Section Label	Base Area	Multiplier	Total Area
1	R	1	Slab	13	1 St/Sl	2,508	1.000	2,508
2	G	1		13	Attached Garage	700	1.000	700
3	M	PRCH		13	SLBC	258	1.000	258
4	M	PRCH		13	SLBC	60	1.000	60
Total Building Area						2,508		2,508