



Rogers

Assessment Property Record Card for Tax Year 2026

Data provided by LISA DELOZIER County Assessor

Date 04/18/2026
 Time 08:38:55
 Page 1

Assessment Data					Primary Image																																																																																																												
Account 660095921 Parcel ID 000000-00-0-00673-002-0008 Cadastral ID 31-21-15-04810 Property Type REAL - Real Property Property Class RRP VI Area 4 Tax Area 7 - OWASSO/LIMESTONE FIRE Name ID 339220 SMITH, CLIFFORD L JR & MARCIA K FAMILY TRUST 6954 N 195TH E AVE OWASSO OK 74055-0000 Parcel Location Situs 06954 N 195TH E AVE Subdivision RIDGE, THE Lot/Block 0008 / 0002 Parcel Size 1 - Lots Sec/Twn/Rng 31 / 21 / 15 / 5 Neighborhood 1074 - R-V01,3,4-SW OWASSO CATOOSA School District S021 - OWASSO SCHOOLS																																																																																																																	
Legal Description Lat/Long: 36.25464038 -95.75651851																																																																																																																	
Legal Description RIDGE, THE BLOCK 2 LOT 8					Building Permits <table border="1"> <thead> <tr> <th>Number</th> <th>Description</th> <th>Opened</th> <th>Closed</th> <th>Amount</th> </tr> </thead> <tbody> <tr> <td>P18 000024</td> <td>R19- NEW POOL</td> <td>04/2018</td> <td>08/2018</td> <td>50,000</td> </tr> <tr> <td>R2015 02 10</td> <td>R16-NEW 2946 SQ FT SFR</td> <td>02/2015</td> <td>11/2015</td> <td>210,000</td> </tr> </tbody> </table>					Number	Description	Opened	Closed	Amount	P18 000024	R19- NEW POOL	04/2018	08/2018	50,000	R2015 02 10	R16-NEW 2946 SQ FT SFR	02/2015	11/2015	210,000																																																																																									
Number	Description	Opened	Closed	Amount																																																																																																													
P18 000024	R19- NEW POOL	04/2018	08/2018	50,000																																																																																																													
R2015 02 10	R16-NEW 2946 SQ FT SFR	02/2015	11/2015	210,000																																																																																																													
Exemptions <table border="1"> <thead> <tr> <th>Code</th> <th>Type</th> <th>Active</th> <th>Maximum</th> <th>Exemption</th> </tr> </thead> <tbody> <tr> <td>H</td> <td>Homestead</td> <td>Yes</td> <td>1,000</td> <td>1,000</td> </tr> </tbody> </table>					Code	Type	Active	Maximum	Exemption	H	Homestead	Yes	1,000	1,000	Sale History <table border="1"> <thead> <tr> <th>Bk/Pg</th> <th>Grantor</th> <th>Date</th> <th>Price</th> <th>Code</th> </tr> </thead> <tbody> <tr> <td>/</td> <td>CAMPBELL, JOSHUA & WHITNEY</td> <td>08/01/2022</td> <td>650,000</td> <td>19</td> </tr> <tr> <td>2500/930</td> <td>EXECUTIVE HOMES LLC</td> <td>09/15/2015</td> <td>363,000</td> <td>YES</td> </tr> <tr> <td>2448/801</td> <td>LANDMARK HOMES LLC</td> <td>01/08/2015</td> <td>165,500</td> <td>15</td> </tr> <tr> <td>2376/799</td> <td>KNEES SHALL BOW LLC</td> <td>12/23/2013</td> <td>262,500</td> <td>18</td> </tr> </tbody> </table>					Bk/Pg	Grantor	Date	Price	Code	/	CAMPBELL, JOSHUA & WHITNEY	08/01/2022	650,000	19	2500/930	EXECUTIVE HOMES LLC	09/15/2015	363,000	YES	2448/801	LANDMARK HOMES LLC	01/08/2015	165,500	15	2376/799	KNEES SHALL BOW LLC	12/23/2013	262,500	18																																																																					
Code	Type	Active	Maximum	Exemption																																																																																																													
H	Homestead	Yes	1,000	1,000																																																																																																													
Bk/Pg	Grantor	Date	Price	Code																																																																																																													
/	CAMPBELL, JOSHUA & WHITNEY	08/01/2022	650,000	19																																																																																																													
2500/930	EXECUTIVE HOMES LLC	09/15/2015	363,000	YES																																																																																																													
2448/801	LANDMARK HOMES LLC	01/08/2015	165,500	15																																																																																																													
2376/799	KNEES SHALL BOW LLC	12/23/2013	262,500	18																																																																																																													
Parcel Valuation <table border="1"> <thead> <tr> <th>Source</th> <th>REAL</th> <th>Fair Cash</th> <th>Capped</th> <th>Asmnt Level</th> <th>Assessed</th> <th>Levy Rate</th> <th>108.538</th> <th>Current Tax</th> </tr> </thead> <tbody> <tr> <td>Remove Cap</td> <td>2023</td> <td>Land Value 149,999</td> <td>149,999</td> <td>11%</td> <td>16,500</td> <td>Assessed</td> <td>67,329</td> <td>7,307.76</td> </tr> <tr> <td>Year Frozen</td> <td>0</td> <td>Improvements 462,086</td> <td>462,086</td> <td></td> <td>50,829</td> <td>Penalty</td> <td>0</td> <td></td> </tr> <tr> <td>Uncapped Value</td> <td>0</td> <td>Mobile Home 0</td> <td>0</td> <td></td> <td>0</td> <td>Exemption</td> <td>1,000</td> <td>-98.00</td> </tr> <tr> <td>TIF Project ID</td> <td>0</td> <td>Total Value 612,085</td> <td>612,085</td> <td></td> <td>67,329</td> <td>Total Taxable</td> <td>66,329</td> <td>7,210.00</td> </tr> </tbody> </table>										Source	REAL	Fair Cash	Capped	Asmnt Level	Assessed	Levy Rate	108.538	Current Tax	Remove Cap	2023	Land Value 149,999	149,999	11%	16,500	Assessed	67,329	7,307.76	Year Frozen	0	Improvements 462,086	462,086		50,829	Penalty	0		Uncapped Value	0	Mobile Home 0	0		0	Exemption	1,000	-98.00	TIF Project ID	0	Total Value 612,085	612,085		67,329	Total Taxable	66,329	7,210.00																																																											
Source	REAL	Fair Cash	Capped	Asmnt Level	Assessed	Levy Rate	108.538	Current Tax																																																																																																									
Remove Cap	2023	Land Value 149,999	149,999	11%	16,500	Assessed	67,329	7,307.76																																																																																																									
Year Frozen	0	Improvements 462,086	462,086		50,829	Penalty	0																																																																																																										
Uncapped Value	0	Mobile Home 0	0		0	Exemption	1,000	-98.00																																																																																																									
TIF Project ID	0	Total Value 612,085	612,085		67,329	Total Taxable	66,329	7,210.00																																																																																																									
Assessment History <table border="1"> <thead> <tr> <th>Tax Year</th> <th>Statement Number</th> <th>Billed Owner</th> <th>Tax Area</th> <th>Total Value</th> <th>Exemptions</th> <th>Taxable Value</th> <th>Billed Tax</th> </tr> </thead> <tbody> <tr><td>2025</td><td>2025-660095921</td><td>SMITH, CLIFFORD L JR & MARCIA K</td><td>7</td><td>595,216</td><td>1000</td><td>64,474</td><td>7,009.00</td></tr> <tr><td>2024</td><td>2024-660095921</td><td>SMITH, CLIFFORD L JR & MARCIA K</td><td>7</td><td>618,369</td><td>1000</td><td>67,021</td><td>7,410.00</td></tr> <tr><td>2023</td><td>2023-660095921</td><td>SMITH, CLIFFORD L JR & MARCIA K</td><td>7</td><td>650,000</td><td>1000</td><td>70,500</td><td>7,628.00</td></tr> <tr><td>2022</td><td>2022-660095921</td><td>SMITH, CLIFFORD L JR &</td><td>7</td><td>473,905</td><td>0</td><td>47,855</td><td>5,371.00</td></tr> <tr><td>2021</td><td>2021-660095921</td><td>CAMPBELL, JOSHUA & WHITNEY</td><td>7</td><td>414,330</td><td>0</td><td>45,576</td><td>5,060.00</td></tr> <tr><td>2020</td><td>2020-660095921</td><td>CAMPBELL, JOSHUA & WHITNEY</td><td>7</td><td>407,577</td><td>0</td><td>44,754</td><td>4,962.00</td></tr> <tr><td>2019</td><td>2019-660095921</td><td>CAMPBELL, JOSHUA & WHITNEY</td><td>7</td><td>387,484</td><td>0</td><td>42,623</td><td>4,729.00</td></tr> <tr><td>2018</td><td>2018-660095921</td><td>CAMPBELL, JOSHUA & WHITNEY</td><td>7</td><td>375,283</td><td>0</td><td>41,281</td><td>4,431.00</td></tr> <tr><td>2017</td><td>2017-660095921</td><td>CAMPBELL, JOSHUA & WHITNEY</td><td>7</td><td>372,310</td><td>0</td><td>40,954</td><td>4,437.00</td></tr> <tr><td>2016</td><td>2016-660095921</td><td>CAMPBELL, JOSHUA & WHITNEY</td><td>7</td><td>362,860</td><td>0</td><td>39,915</td><td>4,328.00</td></tr> <tr><td>2015</td><td>2015-660095921</td><td>CAMPBELL, JOSHUA & WHITNEY</td><td>7</td><td>60,000</td><td>0</td><td>6,064</td><td>662.00</td></tr> <tr><td>2014</td><td>2014-660095921</td><td>LANDMARK HOMES LLC</td><td>7</td><td>52,500</td><td>0</td><td>5,775</td><td>635.00</td></tr> </tbody> </table>										Tax Year	Statement Number	Billed Owner	Tax Area	Total Value	Exemptions	Taxable Value	Billed Tax	2025	2025-660095921	SMITH, CLIFFORD L JR & MARCIA K	7	595,216	1000	64,474	7,009.00	2024	2024-660095921	SMITH, CLIFFORD L JR & MARCIA K	7	618,369	1000	67,021	7,410.00	2023	2023-660095921	SMITH, CLIFFORD L JR & MARCIA K	7	650,000	1000	70,500	7,628.00	2022	2022-660095921	SMITH, CLIFFORD L JR &	7	473,905	0	47,855	5,371.00	2021	2021-660095921	CAMPBELL, JOSHUA & WHITNEY	7	414,330	0	45,576	5,060.00	2020	2020-660095921	CAMPBELL, JOSHUA & WHITNEY	7	407,577	0	44,754	4,962.00	2019	2019-660095921	CAMPBELL, JOSHUA & WHITNEY	7	387,484	0	42,623	4,729.00	2018	2018-660095921	CAMPBELL, JOSHUA & WHITNEY	7	375,283	0	41,281	4,431.00	2017	2017-660095921	CAMPBELL, JOSHUA & WHITNEY	7	372,310	0	40,954	4,437.00	2016	2016-660095921	CAMPBELL, JOSHUA & WHITNEY	7	362,860	0	39,915	4,328.00	2015	2015-660095921	CAMPBELL, JOSHUA & WHITNEY	7	60,000	0	6,064	662.00	2014	2014-660095921	LANDMARK HOMES LLC	7	52,500	0	5,775	635.00
Tax Year	Statement Number	Billed Owner	Tax Area	Total Value	Exemptions	Taxable Value	Billed Tax																																																																																																										
2025	2025-660095921	SMITH, CLIFFORD L JR & MARCIA K	7	595,216	1000	64,474	7,009.00																																																																																																										
2024	2024-660095921	SMITH, CLIFFORD L JR & MARCIA K	7	618,369	1000	67,021	7,410.00																																																																																																										
2023	2023-660095921	SMITH, CLIFFORD L JR & MARCIA K	7	650,000	1000	70,500	7,628.00																																																																																																										
2022	2022-660095921	SMITH, CLIFFORD L JR &	7	473,905	0	47,855	5,371.00																																																																																																										
2021	2021-660095921	CAMPBELL, JOSHUA & WHITNEY	7	414,330	0	45,576	5,060.00																																																																																																										
2020	2020-660095921	CAMPBELL, JOSHUA & WHITNEY	7	407,577	0	44,754	4,962.00																																																																																																										
2019	2019-660095921	CAMPBELL, JOSHUA & WHITNEY	7	387,484	0	42,623	4,729.00																																																																																																										
2018	2018-660095921	CAMPBELL, JOSHUA & WHITNEY	7	375,283	0	41,281	4,431.00																																																																																																										
2017	2017-660095921	CAMPBELL, JOSHUA & WHITNEY	7	372,310	0	40,954	4,437.00																																																																																																										
2016	2016-660095921	CAMPBELL, JOSHUA & WHITNEY	7	362,860	0	39,915	4,328.00																																																																																																										
2015	2015-660095921	CAMPBELL, JOSHUA & WHITNEY	7	60,000	0	6,064	662.00																																																																																																										
2014	2014-660095921	LANDMARK HOMES LLC	7	52,500	0	5,775	635.00																																																																																																										



Rogers

Assessment Property Record Card for Tax Year 2026

Data provided by LISA DELOZIER County Assessor

Date 04/18/2026
Time 08:38:55
Page 2

Lot Data		Square-Foot - NBHD 1074 #1
Lot Size	130.2 x	186.76
Lot Count	1	
Units Buildable		
Non-Ag Acres		
Topography		
Street Access		
Utilities		
Amenities	LAND QUALITY	0
	LAND USE	0
Method	Square-Foot	
Base Lot Value	24,316.15 x 3.00 =	72,948
Factor Value		
Adjustments	2.0563	
Lot Value	149,999	



\\tsclient\C\Users\Randy Necessary\Pictures\101_0628\IMG_0032. 6/29/2022

Residential Data	
Type	1 Single Family Residence
Condition	3 - Average
Quality	4.5 - Good
Architecture	
Style	100% 1 1/2 Story Finished
Exterior Wall	95% Veneer, Masonry 5% Veneer, Stone
Base/Total Area	2,427 / 2,976
Style	100% 1 1/2 Story Finished
HVAC	100% Warmed & Cooled Air
Roof Cover	1 Composition Shingle
Area on Slab	2,427
Fixture/RghIn	16 /
Bed/F/H Bath	4 / 3.5 /
Basement Area	
Garage Type	722 Attached Garage - Unfinished
Remodel	
Year/Eff Age	2015 / 8

GRM Approach

GRM Code	
Gross Rent	0.00
Indicated Value	

Multiple Regression

MRA Code	1 Test
Adjusted R	0.8445
Indicated Value	494,507 166.16 Per SqFt

Direct Comparables

Selection Model	A Adam Test
Adjustment Model	1 2022 Residential
Comparables	8
Indicated Value	530,410 Per SqFt

Value Reconciliation

Selected Approach	Cost Approach
Improvements	432,086
Lot Value	149,999
Indicated Value	582,085 195.59 Per SqFt
Agland Value	
Site Improvements	30,000
Total Value	612,085 205.67 Total Value Per SqFt

Cost Approach Manual : 01/2025

Base Cost	107.81	Total Misc Impr	+	27,709
Roofing Adj	+ 5.07	Garage Cost	+	34,952
Subfloor Adj	+ -3.76	Total RCN	=	469,659
Heat/Cool Adj	+ 17.38	Depreciation (8%)	-	37,573
Plumbing Adj	+ 10.26	Lump Sums	+	0
Basement Adj	+ 0.00	RCNLD	=	432,086
Adj Base Cost	= 136.76	Lot Value	+	149,999
Total Area	x 2,976	Indicated Value	=	582,085
Adjusted Cost	= 406,998	Value Per SqFt		195.59

Miscellaneous Improvements

Code	Description	Sketch ID	Size	Year	Units	Unit Cost	Depr	Value
FPR1	FIREPLACE - RESIDENTIAL 1 STORY	0		1	1	7,721.18		7,721
PRCH	SLAB PORCH - COVERED	126029		40	40	36.54		1,462
PRCH	SLAB PORCH - COVERED	126030		444	444	34.73		15,420
PATO	SLAB PORCH - OPEN	140098		11x6	66	15.22		1,005
PATO	SLAB PORCH - OPEN	140099		13x11	143	14.69		2,101



Rogers

Assessment Property Record Card for Tax Year 2026

Data provided by LISA DELOZIER County Assessor

Date 04/18/2026
 Time 08:38:55
 Page 3

Sketch Image

660095921

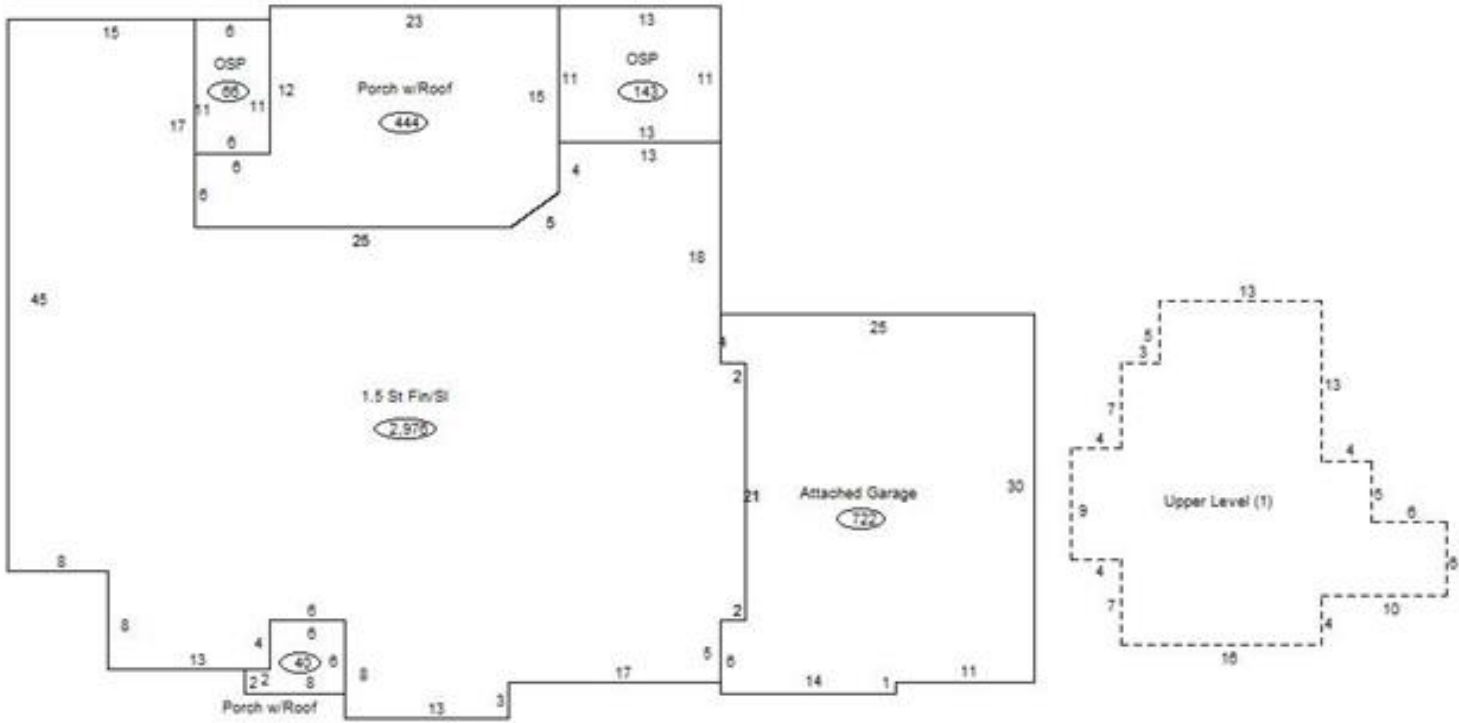

Sketch Vector Information

Sequence	Code	Type	Built Over	Scale	Section Label	Base Area	Multiplier	Total Area
1	R	5	Slab	13	1.5 St Fin/Sl	2,427	1.226	2,976
2	U	^UL		13	Upper Level (1)	549	1.000	549
3	G	1		13	Attached Garage	722	1.000	722
4	M	PRCH		13	SLBC	40	1.000	40
5	M	PRCH		13	SLBC	444	1.000	444
6	M	PATO		13	Open Slab	66	1.000	66
7	M	PATO		13	Open Slab	143	1.000	143
Total Building Area						2,427		2,976



Rogers

Assessment Property Record Card for Tax Year 2026

Data provided by LISA DELOZIER County Assessor

Date 04/18/2026
Time 08:38:55
Page 4

660095921

Outbuildings/Site Improvements

Building Image	Code	Description	Dimensions	Floor	Roofing	Total Units
	SG	SWIM-GUNITE	0x0x0			1
	Qual	Cond	Year	2018	Eff Age	
		Valuation Summary	Modifier Total	RCN	Depr (0% Phys/ % Func)	RCNLD
		Base Cost (30,000.00 x 1)	30,000		30,000	30,000