



# Rogers

## Assessment Property Record Card for Tax Year 2026

Data provided by LISA DELOZIER County Assessor

Date 04/18/2026  
Time 08:39:17  
Page 1

Assessment Data					Primary Image																																																																																																												
<b>Account</b> 660095933 <b>Parcel ID</b> 000000-00-0-00673-003-0010 <b>Cadastral ID</b> 31-21-15-04930 <b>Property Type</b> REAL - Real Property <b>Property Class</b> RRP VI Area 4 <b>Tax Area</b> 7 - OWASSO/LIMESTONE FIRE <b>Name ID</b> 326671 FULTZ, ERIC CAMERON & JENNIFER LEIGH  6957 N 195TH E PL OWASSO OK 74055-0000  <b>Parcel Location</b> <b>Situs</b> 06957 N 195TH PL <b>Subdivision</b> RIDGE, THE <b>Lot/Block</b> 0010 / 0003 <b>Parcel Size</b> 1 - Lots <b>Sec/Twn/Rng</b> 31 / 21 / 15 / 5 <b>Neighborhood</b> 1074 - R-V01,3,4-SW OWASSO CATOOSA <b>School District</b> S021 - OWASSO SCHOOLS																																																																																																																	
<b>Legal Description</b> Lat/Long: 36.25485708 -95.75575845																																																																																																																	
<b>Building Permits</b>					<table border="1"> <thead> <tr> <th>Number</th> <th>Description</th> <th>Opened</th> <th>Closed</th> <th>Amount</th> </tr> </thead> <tbody> <tr> <td>R2014 11 5</td> <td>R16-NEW 2583 SQ FT SFR</td> <td>11/2014</td> <td>08/2015</td> <td>210,000</td> </tr> </tbody> </table>					Number	Description	Opened	Closed	Amount	R2014 11 5	R16-NEW 2583 SQ FT SFR	11/2014	08/2015	210,000																																																																																														
Number	Description	Opened	Closed	Amount																																																																																																													
R2014 11 5	R16-NEW 2583 SQ FT SFR	11/2014	08/2015	210,000																																																																																																													
<b>Exemptions</b>					<b>Sale History</b>																																																																																																												
<table border="1"> <thead> <tr> <th>Code</th> <th>Type</th> <th>Active</th> <th>Maximum</th> <th>Exemption</th> </tr> </thead> <tbody> <tr> <td>H</td> <td>Homestead</td> <td>Yes</td> <td>1,000</td> <td>1,000</td> </tr> <tr> <td>H</td> <td>Homestead</td> <td>No</td> <td>1,000</td> <td></td> </tr> </tbody> </table>					Code	Type	Active	Maximum	Exemption	H	Homestead	Yes	1,000	1,000	H	Homestead	No	1,000		<table border="1"> <thead> <tr> <th>Bk/Pg</th> <th>Grantor</th> <th>Date</th> <th>Price</th> <th>Code</th> </tr> </thead> <tbody> <tr> <td>/</td> <td>HEIMDALE, BRANDON TYLER &amp;</td> <td>01/04/2019</td> <td>356,000</td> <td>YES</td> </tr> <tr> <td>2479/687</td> <td>EXECUTIVE HOMES LLC</td> <td>06/12/2015</td> <td>324,500</td> <td>YES</td> </tr> <tr> <td>2444/88</td> <td>KNEES SHALL BOW LLC</td> <td>11/10/2014</td> <td>0</td> <td>4</td> </tr> </tbody> </table>					Bk/Pg	Grantor	Date	Price	Code	/	HEIMDALE, BRANDON TYLER &	01/04/2019	356,000	YES	2479/687	EXECUTIVE HOMES LLC	06/12/2015	324,500	YES	2444/88	KNEES SHALL BOW LLC	11/10/2014	0	4																																																																					
Code	Type	Active	Maximum	Exemption																																																																																																													
H	Homestead	Yes	1,000	1,000																																																																																																													
H	Homestead	No	1,000																																																																																																														
Bk/Pg	Grantor	Date	Price	Code																																																																																																													
/	HEIMDALE, BRANDON TYLER &	01/04/2019	356,000	YES																																																																																																													
2479/687	EXECUTIVE HOMES LLC	06/12/2015	324,500	YES																																																																																																													
2444/88	KNEES SHALL BOW LLC	11/10/2014	0	4																																																																																																													
<b>Parcel Valuation</b>																																																																																																																	
<table border="1"> <thead> <tr> <th>Source</th> <th>REAL</th> <th>Fair Cash</th> <th>Capped</th> <th>Asmnt Level</th> <th>Assessed</th> <th>Levy Rate</th> <th>108.538</th> <th>Current Tax</th> </tr> </thead> <tbody> <tr> <td>Remove Cap</td> <td>2020</td> <td>Land Value 66,015</td> <td>66,015</td> <td>11%</td> <td>7,262</td> <td>Assessed</td> <td>46,704</td> <td>5,069.16</td> </tr> <tr> <td>Year Frozen</td> <td>0</td> <td>Improvements 377,600</td> <td>358,561</td> <td></td> <td>39,442</td> <td>Penalty</td> <td>0</td> <td></td> </tr> <tr> <td>Uncapped Value</td> <td>0</td> <td>Mobile Home 0</td> <td>0</td> <td></td> <td>0</td> <td>Exemption</td> <td>1,000</td> <td>-97.00</td> </tr> <tr> <td>TIF Project ID</td> <td>0</td> <td>Total Value 443,615</td> <td>424,576</td> <td></td> <td>46,704</td> <td>Total Taxable</td> <td>45,704</td> <td>4,972.00</td> </tr> </tbody> </table>		Source	REAL	Fair Cash	Capped	Asmnt Level	Assessed	Levy Rate	108.538	Current Tax	Remove Cap	2020	Land Value 66,015	66,015	11%	7,262	Assessed	46,704	5,069.16	Year Frozen	0	Improvements 377,600	358,561		39,442	Penalty	0		Uncapped Value	0	Mobile Home 0	0		0	Exemption	1,000	-97.00	TIF Project ID	0	Total Value 443,615	424,576		46,704	Total Taxable	45,704	4,972.00																																																																			
Source	REAL	Fair Cash	Capped	Asmnt Level	Assessed	Levy Rate	108.538	Current Tax																																																																																																									
Remove Cap	2020	Land Value 66,015	66,015	11%	7,262	Assessed	46,704	5,069.16																																																																																																									
Year Frozen	0	Improvements 377,600	358,561		39,442	Penalty	0																																																																																																										
Uncapped Value	0	Mobile Home 0	0		0	Exemption	1,000	-97.00																																																																																																									
TIF Project ID	0	Total Value 443,615	424,576		46,704	Total Taxable	45,704	4,972.00																																																																																																									
<b>Assessment History</b>																																																																																																																	
<table border="1"> <thead> <tr> <th>Tax Year</th> <th>Statement Number</th> <th>Billed Owner</th> <th>Tax Area</th> <th>Total Value</th> <th>Exemptions</th> <th>Taxable Value</th> <th>Billed Tax</th> </tr> </thead> <tbody> <tr><td>2025</td><td>2025-660095933</td><td>FULTZ, ERIC CAMERON &amp;</td><td>7</td><td>428,999</td><td>1000</td><td>44,343</td><td>4,824.00</td></tr> <tr><td>2024</td><td>2024-660095933</td><td>FULTZ, ERIC CAMERON &amp;</td><td>7</td><td>457,070</td><td>1000</td><td>43,022</td><td>4,762.00</td></tr> <tr><td>2023</td><td>2023-660095933</td><td>FULTZ, ERIC CAMERON &amp;</td><td>7</td><td>401,188</td><td>1000</td><td>41,740</td><td>4,521.00</td></tr> <tr><td>2022</td><td>2022-660095933</td><td>FULTZ, ERIC CAMERON &amp;</td><td>7</td><td>386,639</td><td>1000</td><td>40,496</td><td>4,560.00</td></tr> <tr><td>2021</td><td>2021-660095933</td><td>FULTZ, ERIC CAMERON &amp;</td><td>7</td><td>366,245</td><td>1000</td><td>39,287</td><td>4,376.00</td></tr> <tr><td>2020</td><td>2020-660095933</td><td>FULTZ, ERIC CAMERON &amp;</td><td>7</td><td>360,378</td><td>1000</td><td>38,642</td><td>4,299.00</td></tr> <tr><td>2019</td><td>2019-660095933</td><td>FULTZ, ERIC CAMERON &amp;</td><td>7</td><td>327,583</td><td>1000</td><td>35,034</td><td>3,902.00</td></tr> <tr><td>2018</td><td>2018-660095933</td><td>HEIMDALE, BRANDON TYLER &amp;</td><td>7</td><td>335,507</td><td>1000</td><td>35,906</td><td>3,869.00</td></tr> <tr><td>2017</td><td>2017-660095933</td><td>HEIMDALE, BRANDON TYLER &amp;</td><td>7</td><td>332,808</td><td>1000</td><td>35,609</td><td>3,872.00</td></tr> <tr><td>2016</td><td>2016-660095933</td><td>HEIMDALE, BRANDON TYLER &amp;</td><td>7</td><td>324,554</td><td>1000</td><td>34,701</td><td>3,777.00</td></tr> <tr><td>2015</td><td>2015-660095933</td><td>HEIMDALE, BRANDON TYLER &amp;</td><td>7</td><td>9,770</td><td>0</td><td>1,075</td><td>117.00</td></tr> <tr><td>2014</td><td>2014-660095933</td><td>KNEES SHALL BOW LLC</td><td>7</td><td>9,770</td><td>0</td><td>1,075</td><td>118.00</td></tr> </tbody> </table>										Tax Year	Statement Number	Billed Owner	Tax Area	Total Value	Exemptions	Taxable Value	Billed Tax	2025	2025-660095933	FULTZ, ERIC CAMERON &	7	428,999	1000	44,343	4,824.00	2024	2024-660095933	FULTZ, ERIC CAMERON &	7	457,070	1000	43,022	4,762.00	2023	2023-660095933	FULTZ, ERIC CAMERON &	7	401,188	1000	41,740	4,521.00	2022	2022-660095933	FULTZ, ERIC CAMERON &	7	386,639	1000	40,496	4,560.00	2021	2021-660095933	FULTZ, ERIC CAMERON &	7	366,245	1000	39,287	4,376.00	2020	2020-660095933	FULTZ, ERIC CAMERON &	7	360,378	1000	38,642	4,299.00	2019	2019-660095933	FULTZ, ERIC CAMERON &	7	327,583	1000	35,034	3,902.00	2018	2018-660095933	HEIMDALE, BRANDON TYLER &	7	335,507	1000	35,906	3,869.00	2017	2017-660095933	HEIMDALE, BRANDON TYLER &	7	332,808	1000	35,609	3,872.00	2016	2016-660095933	HEIMDALE, BRANDON TYLER &	7	324,554	1000	34,701	3,777.00	2015	2015-660095933	HEIMDALE, BRANDON TYLER &	7	9,770	0	1,075	117.00	2014	2014-660095933	KNEES SHALL BOW LLC	7	9,770	0	1,075	118.00
Tax Year	Statement Number	Billed Owner	Tax Area	Total Value	Exemptions	Taxable Value	Billed Tax																																																																																																										
2025	2025-660095933	FULTZ, ERIC CAMERON &	7	428,999	1000	44,343	4,824.00																																																																																																										
2024	2024-660095933	FULTZ, ERIC CAMERON &	7	457,070	1000	43,022	4,762.00																																																																																																										
2023	2023-660095933	FULTZ, ERIC CAMERON &	7	401,188	1000	41,740	4,521.00																																																																																																										
2022	2022-660095933	FULTZ, ERIC CAMERON &	7	386,639	1000	40,496	4,560.00																																																																																																										
2021	2021-660095933	FULTZ, ERIC CAMERON &	7	366,245	1000	39,287	4,376.00																																																																																																										
2020	2020-660095933	FULTZ, ERIC CAMERON &	7	360,378	1000	38,642	4,299.00																																																																																																										
2019	2019-660095933	FULTZ, ERIC CAMERON &	7	327,583	1000	35,034	3,902.00																																																																																																										
2018	2018-660095933	HEIMDALE, BRANDON TYLER &	7	335,507	1000	35,906	3,869.00																																																																																																										
2017	2017-660095933	HEIMDALE, BRANDON TYLER &	7	332,808	1000	35,609	3,872.00																																																																																																										
2016	2016-660095933	HEIMDALE, BRANDON TYLER &	7	324,554	1000	34,701	3,777.00																																																																																																										
2015	2015-660095933	HEIMDALE, BRANDON TYLER &	7	9,770	0	1,075	117.00																																																																																																										
2014	2014-660095933	KNEES SHALL BOW LLC	7	9,770	0	1,075	118.00																																																																																																										



# Rogers

## Assessment Property Record Card for Tax Year 2026

Data provided by LISA DELOZIER County Assessor

Date 04/18/2026  
Time 08:39:17  
Page 2

Lot Data		Square-Foot - NBHD 1074 #1	
Lot Size	0	0	
Lot Count	1		
Units Buildable			
Non-Ag Acres	0.5052		
Topography			
Street Access			
Utilities			
Amenities	LAND QUALITY		0
	LAND USE		0
Method	Square-Foot		
Base Lot Value	22,005.00 x 3.00 = 66,015		
Factor Value			
Adjustments	1.0000		
Lot Value	66,015		



\\tsclient\C\Users\Randy Necessary\Pictures\101\_0628\IMG\_0039. 6/29/2022

Residential Data	
Type	1 Single Family Residence
Condition	3 - Average
Quality	4 - Good
Architecture	
Style	100% One Story
Exterior Wall	95% Veneer, Masonry 5% Veneer, Stone
Base/Total Area	2,508 / 2,508
Style	100% One Story
HVAC	100% Warmed & Cooled Air
Roof Cover	1 Composition Shingle
Area on Slab	2,508
Fixture/RghIn	14 /
Bed/F/H Bath	4 / 2.5 /
Basement Area	
Garage Type	700 Attached Garage - Unfinished
Remodel	
Year/Eff Age	2015 / 8

### GRM Approach

GRM Code	
Gross Rent	0.00
Indicated Value	

### Multiple Regression

MRA Code	1	Test
Adjusted R	0.8445	
Indicated Value	380,092	151.55 Per SqFt

### Direct Comparables

Selection Model	A	Adam Test
Adjustment Model	1	2022 Residential
Comparables	8	
Indicated Value	451,830	Per SqFt

### Value Reconciliation

Selected Approach	Cost Approach		
Improvements	377,600		
Lot Value	66,015		
Indicated Value	443,615	176.88	Per SqFt
Agland Value			
Site Improvements			
Total Value	443,615	176.88	Total Value Per SqFt

Cost Approach		Manual : 01/2025	
Base Cost	113.31	Total Misc Impr	+ 25,131
Roofing Adj	+ 5.82	Garage Cost	+ 31,927
Subfloor Adj	+ -4.59	Total RCN	= 410,435
Heat/Cool Adj	+ 16.31	Depreciation ( 8%)	- 32,835
Plumbing Adj	+ 10.05	Lump Sums	+ 0
Basement Adj	+ 0.00	RCNLD	= 377,600
Adj Base Cost	= 140.90	Lot Value	+ 66,015
Total Area	x 2,508	Indicated Value	= 443,615
Adjusted Cost	= 353,377	Value Per SqFt	176.88

### Miscellaneous Improvements

Code	Description	Sketch ID	Size	Year	Units	Unit Cost	Depr	Value
PRCH	SLAB PORCH - COVERED	124255	262		262	32.06		8,400
PRCH	SLAB PORCH - COVERED	124256	68		68	32.98		2,243
FPR1	FIREPLACE - RESIDENTIAL 1 STORY			2	2	7,243.87		14,488



# Rogers

## Assessment Property Record Card for Tax Year 2026

Data provided by LISA DELOZIER County Assessor

Date 04/18/2026  
 Time 08:39:17  
 Page 3

Sketch Image

660095933

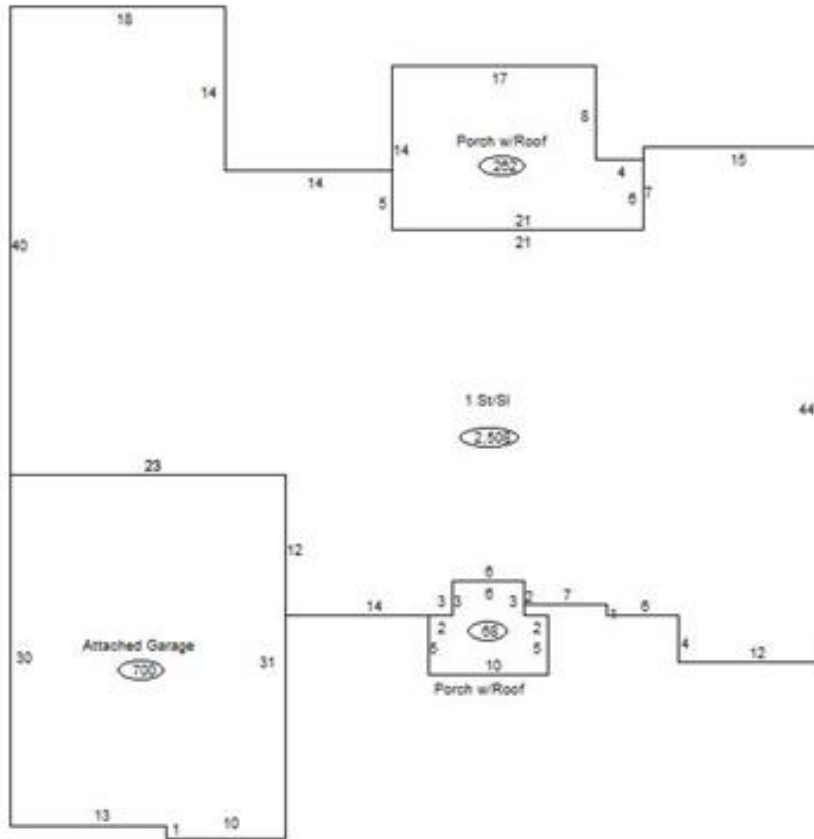

### Sketch Vector Information

Sequence	Code	Type	Built Over	Scale	Section Label	Base Area	Multiplier	Total Area
1	R	1	Slab	13	1 St/Sl	2,508	1.000	2,508
2	G	1		13	Attached Garage	700	1.000	700
3	M	PRCH		13	SLBC	262	1.000	262
4	M	PRCH		13	SLBC	68	1.000	68
<b>Total Building Area</b>						<b>2,508</b>		<b>2,508</b>