



Rogers

Assessment Property Record Card for Tax Year 2026

Data provided by LISA DELOZIER County Assessor

Date 04/18/2026
Time 08:40:18
Page 1

Assessment Data					Primary Image																																																																																																												
Account 660095968 Parcel ID 000000-00-0-00958-002-0013 Cadastral ID 13-21-15-05080 Property Type REAL - Real Property Property Class RRP VI Area 4 Tax Area 18 - CLAREMORE RURAL/W/O FIRE Name ID 324019 CARTER, MATTHEW CREDE & DOROTHY C 21723 SUMMIT TRAIL CLAREMORE OK 74017-0000 Parcel Location Situs 21723 S SUMMITT TRL Subdivision WOODLANDS AT WESTIN PARK Lot/Block 0013 / 0002 Parcel Size 1 - Lots Sec/Twn/Rng 13 / 21 / 15 / 5 Neighborhood 1089 - R-V03,4-SE CLAREMORE School District S001 - CLAREMORE SCHOOLS																																																																																																																	
Legal Description Lat/Long: 36.29555109 -95.66621995 WOODLANDS AT WESTIN PARK BLOCK 2 LOT 13																																																																																																																	
Exemptions					Building Permits																																																																																																												
<table border="1"> <thead> <tr> <th>Code</th> <th>Type</th> <th>Active</th> <th>Maximum</th> <th>Exemption</th> </tr> </thead> <tbody> <tr> <td></td> <td></td> <td></td> <td></td> <td></td> </tr> </tbody> </table>					Code	Type	Active	Maximum	Exemption						<table border="1"> <thead> <tr> <th>Number</th> <th>Description</th> <th>Opened</th> <th>Closed</th> <th>Amount</th> </tr> </thead> <tbody> <tr> <td>R2017-07-27</td> <td>R19- NEW 2099 SQ FT SFR</td> <td>07/2017</td> <td>02/2018</td> <td>200,000</td> </tr> </tbody> </table>					Number	Description	Opened	Closed	Amount	R2017-07-27	R19- NEW 2099 SQ FT SFR	07/2017	02/2018	200,000																																																																																				
Code	Type	Active	Maximum	Exemption																																																																																																													
Number	Description	Opened	Closed	Amount																																																																																																													
R2017-07-27	R19- NEW 2099 SQ FT SFR	07/2017	02/2018	200,000																																																																																																													
Parcel Valuation					Sale History																																																																																																												
<table border="1"> <thead> <tr> <th>Source</th> <th>REAL</th> <th>Fair Cash</th> <th>Capped</th> <th>Asmnt Level</th> <th>Assessed</th> <th>Levy Rate</th> <th>92.430</th> <th>Current Tax</th> </tr> </thead> <tbody> <tr> <td>Remove Cap</td> <td>2019</td> <td>Land Value 48,201</td> <td>41,349</td> <td>11%</td> <td>4,548</td> <td>Assessed</td> <td>43,810</td> <td>4,049.36</td> </tr> <tr> <td>Year Frozen</td> <td>0</td> <td>Improvements 358,775</td> <td>356,931</td> <td></td> <td>39,262</td> <td>Penalty</td> <td>0</td> <td></td> </tr> <tr> <td>Uncapped Value</td> <td>0</td> <td>Mobile Home 0</td> <td>0</td> <td></td> <td>0</td> <td>Exemption</td> <td>0</td> <td>0.00</td> </tr> <tr> <td>TIF Project ID</td> <td>0</td> <td>Total Value 406,976</td> <td>398,280</td> <td></td> <td>43,810</td> <td>Total Taxable</td> <td>43,810</td> <td>4,049.00</td> </tr> </tbody> </table>					Source	REAL	Fair Cash	Capped	Asmnt Level	Assessed	Levy Rate	92.430	Current Tax	Remove Cap	2019	Land Value 48,201	41,349	11%	4,548	Assessed	43,810	4,049.36	Year Frozen	0	Improvements 358,775	356,931		39,262	Penalty	0		Uncapped Value	0	Mobile Home 0	0		0	Exemption	0	0.00	TIF Project ID	0	Total Value 406,976	398,280		43,810	Total Taxable	43,810	4,049.00	<table border="1"> <thead> <tr> <th>Bk/Pg</th> <th>Grantor</th> <th>Date</th> <th>Price</th> <th>Code</th> </tr> </thead> <tbody> <tr> <td>2698/123</td> <td>LONGHORN CONSTRUCTION LLC</td> <td>03/01/2018</td> <td>302,500</td> <td>YES</td> </tr> <tr> <td>2516/766</td> <td>KNAPP, BRETT D PROPERTIES LLC</td> <td>12/09/2015</td> <td>585,000</td> <td>15</td> </tr> </tbody> </table>					Bk/Pg	Grantor	Date	Price	Code	2698/123	LONGHORN CONSTRUCTION LLC	03/01/2018	302,500	YES	2516/766	KNAPP, BRETT D PROPERTIES LLC	12/09/2015	585,000	15																																												
Source	REAL	Fair Cash	Capped	Asmnt Level	Assessed	Levy Rate	92.430	Current Tax																																																																																																									
Remove Cap	2019	Land Value 48,201	41,349	11%	4,548	Assessed	43,810	4,049.36																																																																																																									
Year Frozen	0	Improvements 358,775	356,931		39,262	Penalty	0																																																																																																										
Uncapped Value	0	Mobile Home 0	0		0	Exemption	0	0.00																																																																																																									
TIF Project ID	0	Total Value 406,976	398,280		43,810	Total Taxable	43,810	4,049.00																																																																																																									
Bk/Pg	Grantor	Date	Price	Code																																																																																																													
2698/123	LONGHORN CONSTRUCTION LLC	03/01/2018	302,500	YES																																																																																																													
2516/766	KNAPP, BRETT D PROPERTIES LLC	12/09/2015	585,000	15																																																																																																													
Assessment History																																																																																																																	
<table border="1"> <thead> <tr> <th>Tax Year</th> <th>Statement Number</th> <th>Billed Owner</th> <th>Tax Area</th> <th>Total Value</th> <th>Exemptions</th> <th>Taxable Value</th> <th>Billed Tax</th> </tr> </thead> <tbody> <tr> <td>2025</td> <td>2025-660095968</td> <td>CARTER, MATTHEW CREDE &</td> <td>18</td> <td>392,980</td> <td>0</td> <td>41,725</td> <td>3,857.00</td> </tr> <tr> <td>2024</td> <td>2024-660095968</td> <td>CARTER, MATTHEW CREDE &</td> <td>18</td> <td>413,745</td> <td>0</td> <td>39,738</td> <td>3,673.00</td> </tr> <tr> <td>2023</td> <td>2023-660095968</td> <td>CARTER, MATTHEW CREDE &</td> <td>18</td> <td>344,051</td> <td>0</td> <td>37,846</td> <td>3,467.00</td> </tr> <tr> <td>2022</td> <td>2022-660095968</td> <td>CARTER, MATTHEW CREDE &</td> <td>18</td> <td>347,258</td> <td>0</td> <td>37,479</td> <td>3,469.00</td> </tr> <tr> <td>2021</td> <td>2021-660095968</td> <td>CARTER, MATTHEW CREDE &</td> <td>18</td> <td>324,497</td> <td>0</td> <td>35,695</td> <td>3,152.00</td> </tr> <tr> <td>2020</td> <td>2020-660095968</td> <td>CARTER, MATTHEW CREDE &</td> <td>18</td> <td>321,884</td> <td>0</td> <td>35,267</td> <td>3,229.00</td> </tr> <tr> <td>2019</td> <td>2019-660095968</td> <td>CARTER, MATTHEW CREDE &</td> <td>18</td> <td>305,342</td> <td>0</td> <td>33,588</td> <td>3,111.00</td> </tr> <tr> <td>2018</td> <td>2018-660095968</td> <td>CARTER, MATTHEW CREDE &</td> <td>18</td> <td>34,000</td> <td>0</td> <td>3,740</td> <td>346.00</td> </tr> <tr> <td>2017</td> <td>2017-660095968</td> <td>LONGHORN CONSTRUCTION LLC</td> <td>18</td> <td>34,000</td> <td>0</td> <td>3,740</td> <td>343.00</td> </tr> <tr> <td>2016</td> <td>2016-660095968</td> <td>LONGHORN CONSTRUCTION LLC</td> <td>18</td> <td>34,000</td> <td>0</td> <td>3,740</td> <td>351.00</td> </tr> <tr> <td>2015</td> <td>2015-660095968</td> <td>KNAPP, BRETT D PROPERTIES LLC</td> <td>18</td> <td>8,860</td> <td>0</td> <td>975</td> <td>88.00</td> </tr> <tr> <td>2014</td> <td>2014-660095968</td> <td>KNAPP, BRETT D PROPERTIES LLC</td> <td>18</td> <td>8,860</td> <td>0</td> <td>975</td> <td>90.00</td> </tr> </tbody> </table>										Tax Year	Statement Number	Billed Owner	Tax Area	Total Value	Exemptions	Taxable Value	Billed Tax	2025	2025-660095968	CARTER, MATTHEW CREDE &	18	392,980	0	41,725	3,857.00	2024	2024-660095968	CARTER, MATTHEW CREDE &	18	413,745	0	39,738	3,673.00	2023	2023-660095968	CARTER, MATTHEW CREDE &	18	344,051	0	37,846	3,467.00	2022	2022-660095968	CARTER, MATTHEW CREDE &	18	347,258	0	37,479	3,469.00	2021	2021-660095968	CARTER, MATTHEW CREDE &	18	324,497	0	35,695	3,152.00	2020	2020-660095968	CARTER, MATTHEW CREDE &	18	321,884	0	35,267	3,229.00	2019	2019-660095968	CARTER, MATTHEW CREDE &	18	305,342	0	33,588	3,111.00	2018	2018-660095968	CARTER, MATTHEW CREDE &	18	34,000	0	3,740	346.00	2017	2017-660095968	LONGHORN CONSTRUCTION LLC	18	34,000	0	3,740	343.00	2016	2016-660095968	LONGHORN CONSTRUCTION LLC	18	34,000	0	3,740	351.00	2015	2015-660095968	KNAPP, BRETT D PROPERTIES LLC	18	8,860	0	975	88.00	2014	2014-660095968	KNAPP, BRETT D PROPERTIES LLC	18	8,860	0	975	90.00
Tax Year	Statement Number	Billed Owner	Tax Area	Total Value	Exemptions	Taxable Value	Billed Tax																																																																																																										
2025	2025-660095968	CARTER, MATTHEW CREDE &	18	392,980	0	41,725	3,857.00																																																																																																										
2024	2024-660095968	CARTER, MATTHEW CREDE &	18	413,745	0	39,738	3,673.00																																																																																																										
2023	2023-660095968	CARTER, MATTHEW CREDE &	18	344,051	0	37,846	3,467.00																																																																																																										
2022	2022-660095968	CARTER, MATTHEW CREDE &	18	347,258	0	37,479	3,469.00																																																																																																										
2021	2021-660095968	CARTER, MATTHEW CREDE &	18	324,497	0	35,695	3,152.00																																																																																																										
2020	2020-660095968	CARTER, MATTHEW CREDE &	18	321,884	0	35,267	3,229.00																																																																																																										
2019	2019-660095968	CARTER, MATTHEW CREDE &	18	305,342	0	33,588	3,111.00																																																																																																										
2018	2018-660095968	CARTER, MATTHEW CREDE &	18	34,000	0	3,740	346.00																																																																																																										
2017	2017-660095968	LONGHORN CONSTRUCTION LLC	18	34,000	0	3,740	343.00																																																																																																										
2016	2016-660095968	LONGHORN CONSTRUCTION LLC	18	34,000	0	3,740	351.00																																																																																																										
2015	2015-660095968	KNAPP, BRETT D PROPERTIES LLC	18	8,860	0	975	88.00																																																																																																										
2014	2014-660095968	KNAPP, BRETT D PROPERTIES LLC	18	8,860	0	975	90.00																																																																																																										



Rogers

Assessment Property Record Card for Tax Year 2026

Data provided by LISA DELOZIER County Assessor

Date 04/18/2026
 Time 08:40:18
 Page 2

Lot Data		Square-Foot - NBHD 1089 #1	
Lot Size	0	0	
Lot Count	1		
Units Buildable			
Non-Ag Acres	0.7631		
Topography			
Street Access			
Utilities			
Amenities	LAND QUALITY		0
			0
Method	Square-Foot		
Base Lot Value	33,242.00 x 1.45 = 48,201		
Factor Value			
Adjustments	1.0000		
Lot Value	48,201		



\\tsclient\C\Users\Randy Necessary\Pictures\101_0808\IMG_0027. 8/8/2022

Residential Data	
Type	1 Single Family Residence
Condition	3 - Average
Quality	4 - Good
Architecture	
Style	100% One Story
Exterior Wall	80% Veneer, Masonry 20% Veneer, Stone
Base/Total Area	2,189 / 2,189
Style	100% One Story
HVAC	100% Warmed & Cooled Air
Roof Cover	1 Composition Shingle
Area on Slab	2,189
Fixture/RghIn	18 /
Bed/F/H Bath	3 / 2.0 / 1.0
Basement Area	
Garage Type	814 Attached Garage - Unfinished
Remodel	
Year/Eff Age	2018 / 6

GRM Approach	
GRM Code	
Gross Rent	0.00
Indicated Value	

Multiple Regression			
MRA Code	1	Test	
Adjusted R	0.8445		
Indicated Value	365,256	166.86	Per SqFt

Direct Comparables	
Selection Model	A Adam Test
Adjustment Model	1 2022 Residential
Comparables	
Indicated Value	

Cost Approach		Manual : 01/2025	
Base Cost	115.95	Total Misc Impr	+ 20,250
Roofing Adj	+ 5.93	Garage Cost	+ 36,972
Subfloor Adj	+ -4.62	Total RCN	= 381,676
Heat/Cool Adj	+ 16.31	Depreciation (6%)	- 22,901
Plumbing Adj	+ 14.65	Lump Sums	+ 0
Basement Adj	+ 0.00	RCNLD	= 358,775
Adj Base Cost	= 148.22	Lot Value	+ 48,201
Total Area	x 2,189	Indicated Value	= 406,976
Adjusted Cost	= 324,454	Value Per SqFt	185.92

Value Reconciliation			
Selected Approach	Cost Approach		
Improvements	358,775		
Lot Value	48,201		
Indicated Value	406,976	185.92	Per SqFt
Agland Value			
Site Improvements			
Total Value	406,976	185.92	Total Value Per SqFt

Miscellaneous Improvements								
Code	Description	Sketch ID	Size	Year	Units	Unit Cost	Depr	Value
FPR1	FIREPLACE - RESIDENTIAL 1 STORY	0		1	1	7,243.87		7,244
PRCH	SLAB PORCH - COVERED	138260	19x13		247	32.11		7,931
PRCH	SLAB PORCH - COVERED	138285	156		156	32.53		5,075



Rogers

Assessment Property Record Card for Tax Year 2026

Data provided by LISA DELOZIER County Assessor

Date 04/18/2026

Time 08:40:18

Page 3

Sketch Image

660095968

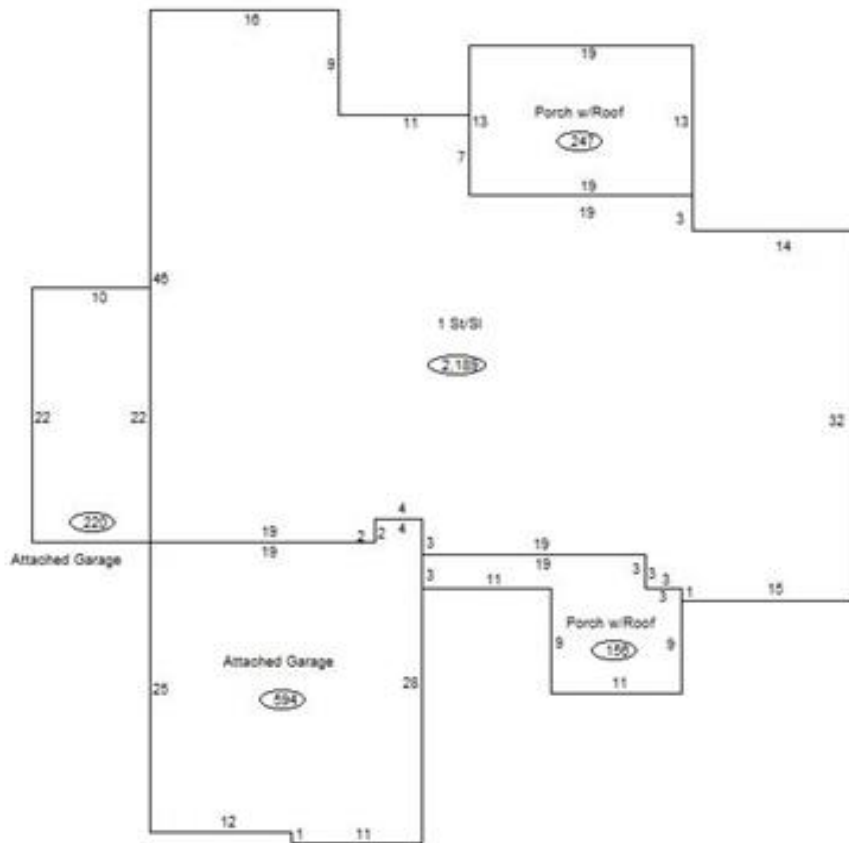

Sketch Vector Information

Sequence	Code	Type	Built Over	Scale	Section Label	Base Area	Multiplier	Total Area
1	R	1	Slab	13	1 St/Sl	2,189	1.000	2,189
2	G	1		13	Attached Garage	594	1.000	594
3	G	1		13	Attached Garage	220	1.000	220
4	M	PRCH		13	SLBC	247	1.000	247
5	M	PRCH		13	SLBC	156	1.000	156
Total Building Area						2,189		2,189