



Rogers

Assessment Property Record Card for Tax Year 2026

Data provided by LISA DELOZIER County Assessor

Date 04/18/2026
 Time 08:42:24
 Page 1

Assessment Data					Primary Image				
Account 660096095 Parcel ID 22N15E-31-3-00000-000-0001 Cadastral ID 31-22-15-02701 Property Type REAL - Real Property Property Class RR VI Area 4 Tax Area 28 - COLLINSVILLE/LIME FIRE Name ID 336640 COOK, DUSTIN & ASHLEY 19707 E 126TH ST N COLLINSVILLE OK 74021-0000 Parcel Location Situs 19707 E 126TH ST N Subdivision Lot/Block / Parcel Size 3.33 - Acres Sec/Twn/Rng 31 / 22 / 15 / 3 Neighborhood 6060 - UNPLATTED School District S026 - COLLINSVILLE SCHOOLS					 <p>\\tsclient\T\TOMMY DUNLAP\New folder (84)\IMG_0008.JPG 7/21/2022</p>				
Legal Description Lat/Long: 36.33734135 -95.75327074									
W 220' SW SE SW.					Building Permits				
					Number	Description	Opened	Closed	Amount
					R2016 01 11	R17-NEW 3120 SQ FT SFR	01/2016	08/2016	260,000
Exemptions					Sale History				
Code	Type	Active	Maximum	Exemption	Bk/Pg	Grantor	Date	Price	Code
H	Homestead	Yes	1,000	1,000	/	BRENGI, SCOTT & JULIE	11/19/2021	660,000	WG
H	Homestead	No	1,000		2487/535	TROULAKIS, DEAN &	07/15/2015	95,000	YES
					2359/405	TROULAKIS, DEAN &	09/24/2013	0	4
Parcel Valuation									
Source	REAL		Fair Cash	Capped	Asmnt Level	Assessed	Levy Rate	112.698	Current Tax
Remove Cap	2022	Land Value	79,635	79,635	11%	8,760	Assessed	64,367	7,254.03
Year Frozen	0	Improvements	505,516	505,516		55,607	Penalty	0	
Uncapped Value	0	Mobile Home	0	0		0	Exemption	1,000	-102.00
TIF Project ID	0	Total Value	585,151	585,151		64,367	Total Taxable	63,367	7,152.00
Assessment History									
Tax Year	Statement Number	Billed Owner			Tax Area	Total Value	Exemptions	Taxable Value	Billed Tax
2025	2025-660096095	COOK, DUSTIN & ASHLEY			28	569,837	1000	61,682	6,962.00
2024	2024-660096095	COOK, DUSTIN & ASHLEY			28	597,104	1000	64,681	7,420.00
2023	2023-660096095	COOK, DUSTIN & ASHLEY			28	604,711	1000	65,519	7,394.00
2022	2022-660096095	COOK, DUSTIN & ASHLEY			28	605,148	1000	65,566	7,356.00
2021	2021-660096095	BRENGI, SCOTT & JULIE			28	521,441	1000	53,290	6,062.00
2020	2020-660096095	BRENGI, SCOTT & JULIE			28	506,528	1000	51,708	5,896.00
2019	2019-660096095	BRENGI, SCOTT & JULIE			28	465,210	1000	50,173	5,665.00
2018	2018-660096095	BRENGI, SCOTT & JULIE			28	468,056	1000	50,486	5,755.00
2017	2017-660096095	BRENGI, SCOTT & JULIE			28	464,552	1000	50,100	5,632.00
2016	2016-660096095	BRENGI, SCOTT & JULIE			28	91,523	0	10,067	1,104.00
2015	2015-660096095	BRENGI, SCOTT & JULIE			28	61,558	0	1,892	210.00
2014	2014-660096095	TROULAKIS, DEAN &			28	61,558	0	1,802	195.00
2013	2013-660096095	TROULAKIS, DEAN &			28	15,603	0	1,716	185.00



Rogers

Assessment Property Record Card for Tax Year 2026

Data provided by LISA DELOZIER County Assessor

Date 04/18/2026
 Time 08:42:24
 Page 2

Lot Data	Square-Foot - NBHD 6060 #1	Primary Image
Lot Size Lot Count Units Buildable Non-Ag Acres 3.3127 Topography 1 Street Access Utilities Amenities LAND QUALITY 0 0 Method Square-Foot Base Lot Value 144,301.00 x .55 = 79,635 Factor Value Adjustments 1.0000 Lot Value 79,635		

Residential Data	
Type	1 Single Family Residence
Condition	3 - Average
Quality	4 - Good
Architecture	
Style	100% 1 1/2 Story Finished
Exterior Wall	95% Veneer, Masonry 5% Veneer, Stone
Base/Total Area	3,312 / 3,756
Style	100% 1 1/2 Story Finished
HVAC	100% Warmed & Cooled Air
Roof Cover	1 Composition Shingle
Area on Slab	3,312
Fixture/RghIn	14 /
Bed/F/H Bath	4 / 2.5 /
Basement Area	
Garage Type	910 Attached Garage - Unfinished
Remodel	
Year/Eff Age	2016 / 8

GRM Approach
GRM Code Gross Rent 0.00 Indicated Value

Multiple Regression
MRA Code 1 Test Adusted R 0.8445 Indicated Value 534,725 142.37 Per SqFt

Direct Comparables
Selection Model 1 Res Adjustment Model A2 AO Test Comparables Indicated Value

Cost Approach				Manual : 01/2025			
Base Cost	100.50	Total Misc Impr	+ 27,509				
Roofing Adj	+ 4.93	Garage Cost	+ 41,332				
Subfloor Adj	+ -3.78	Total RCN	= 537,102				
Heat/Cool Adj	+ 16.31	Depreciation (8%)	- 42,968				
Plumbing Adj	+ 6.71	Lump Sums	+ 0				
Basement Adj	+ 0.00	RCNLD	= 494,134				
Adj Base Cost	= 124.67	Lot Value	+ 79,635				
Total Area	x 3,756	Indicated Value	= 573,769				
Adjusted Cost	= 468,261	Value Per SqFt	152.76				

Value Reconciliation
Selected Approach Cost Approach Improvements 494,134 Lot Value 79,635 Indicated Value 573,769 152.76 Per SqFt Agland Value Site Improvements 11,382 Total Value 585,151 155.79 Total Value Per SqFt

Miscellaneous Improvements								
Code	Description	Sketch ID	Size	Year	Units	Unit Cost	Depr	Value
FPR1	FIREPLACE - RESIDENTIAL 1 STORY	0		1	1	7,243.87		7,244
PRCH	SLAB PORCH - COVERED	128192	30x12		360	31.75		11,430
PRCH	SLAB PORCH - COVERED	128193	23x12		276	32.01		8,835



Rogers

Assessment Property Record Card for Tax Year 2026

Data provided by LISA DELOZIER County Assessor

Date 04/18/2026

Time 08:42:24

Page 3

Sketch Image

660096095

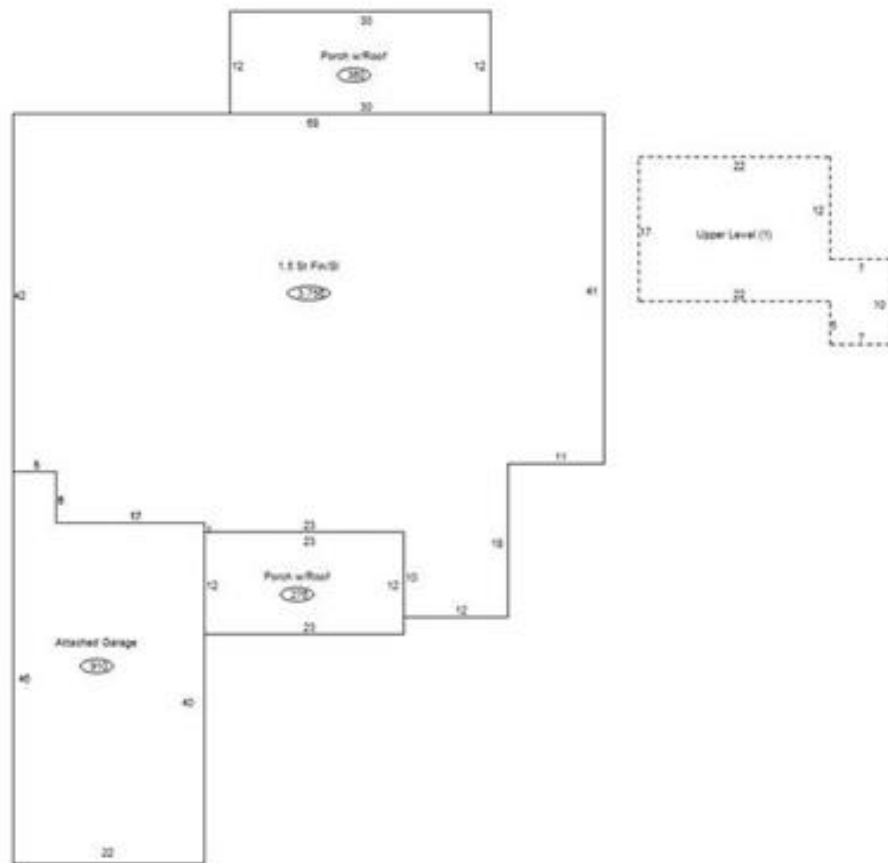

Sketch Vector Information

Sequence	Code	Type	Built Over	Scale	Section Label	Base Area	Multiplier	Total Area
1	R	5	Slab	13	1.5 St Fin/SI	3,312	1.134	3,756
2	G	1		13	Attached Garage	910	1.000	910
3	M	PRCH		13	SLBC	360	1.000	360
4	M	PRCH		13	SLBC	276	1.000	276
5	U	^UL		13	Upper Level (1)	444	1.000	444
Total Building Area						3,312		3,756



Rogers

Assessment Property Record Card for Tax Year 2026

Data provided by LISA DELOZIER County Assessor

Date 04/18/2026
 Time 08:42:24
 Page 4

660096095

Outbuildings/Site Improvements

Building Image	Code	Description	Dimensions	Floor	Roofing	Total Units
	BARN	BARN	0x0x0			1,440
	Qual	3	Cond 3	Year	Eff Age	
		Valuation Summary	Modifier Total	RCN	Depr (20% Phys/ % Func)	RCNLD
		Base Cost (9.88 x 1,440)	14,227	14,227	2,845	11,382