



Rogers

Assessment Property Record Card for Tax Year 2026

Data provided by LISA DELOZIER County Assessor

Date 04/18/2026
Time 08:42:35
Page 1

Assessment Data					Primary Image									
Account	660096112													
Parcel ID	20N17E-28-3-00000-000-0001													
Cadastral ID	28-20-17-00211													
Property Type	REAL - Real Property													
Property Class	RR	VI Area	3											
Tax Area	2 - INOLA RURAL													
Name ID	310794													
GEORGE, MATTHEW & TIFFANY														
18375 E 574 RD														
INOLA OK 74036-0000														
Parcel Location														
Situs	18375 E 574 RD													
Subdivision														
Lot/Block	/	Parcel Size	10 - Acres											
Sec/Twn/Rng	28 / 20 / 17 / 3													
Neighborhood	2017 - UNPLATTED LAND													
School District	S005 - INOLA SCHOOLS													
Legal Description														
Lat/Long: 36.18240291 -95.50320033														
E2 E2 NE SW.														
Building Permits														
<table border="1"> <thead> <tr> <th>Number</th> <th>Description</th> <th>Opened</th> <th>Closed</th> <th>Amount</th> </tr> </thead> <tbody> <tr> <td colspan="5" style="height: 100px;"> </td> </tr> </tbody> </table>					Number	Description	Opened	Closed	Amount					
Number	Description	Opened	Closed	Amount										
Exemptions														
Code	Type	Active	Maximum	Exemption										
H	Homestead	Yes	1,000	1,000										
Sale History														
Bk/Pg	Grantor	Date	Price	Code										
2349/159	DANGLER, JUDITH ELLEN STRIPLIN	08/09/2013	37,000	YES										
Parcel Valuation														
Source	REAL	Fair Cash	Capped	Asmnt Level	Assessed	Levy Rate	80.060	Current Tax						
Remove Cap	2014	Land Value	139,005	75,787	11%	8,337	Assessed	19,141	1,532.43					
Year Frozen	0	Improvements	105,312	98,217		10,804	Penalty	0						
Uncapped Value	0	Mobile Home	0	0		0	Exemption	1,000	-80.00					
TIF Project ID	0	Total Value	244,317	174,004		19,141	Total Taxable	18,141	1,452.00					
Assessment History														
Tax Year	Statement Number	Billed Owner	Tax Area	Total Value	Exemptions	Taxable Value	Billed Tax							
2025	2025-660096112	GEORGE, MATTHEW & TIFFANY	2	255,303	1000	17,583	1,408.00							
2024	2024-660096112	GEORGE, MATTHEW & TIFFANY	2	244,333	1000	17,042	1,370.00							
2023	2023-660096112	GEORGE, MATTHEW & TIFFANY	2	161,477	1000	16,516	1,330.00							
2022	2022-660096112	GEORGE, MATTHEW & TIFFANY	2	154,601	1000	16,006	1,298.00							
2021	2021-660096112	GEORGE, MATTHEW & TIFFANY	2	150,985	0	16,608	1,331.00							
2020	2020-660096112	GEORGE, MATTHEW & TIFFANY	2	150,078	0	16,262	1,314.00							
2019	2019-660096112	GEORGE, MATTHEW & TIFFANY	2	140,792	0	15,487	1,280.00							
2018	2018-660096112	GEORGE, MATTHEW & TIFFANY	2	135,239	0	14,876	1,242.00							
2017	2017-660096112	GEORGE, MATTHEW & TIFFANY	2	118,883	0	12,591	1,059.00							
2016	2016-660096112	GEORGE, MATTHEW & TIFFANY	2	109,703	0	11,992	1,020.00							
2015	2015-660096112	GEORGE, MATTHEW & TIFFANY	2	103,826	0	11,421	991.00							
2014	2014-660096112	GEORGE, MATTHEW & TIFFANY	2	105,113	0	11,562	1,038.00							
2013	2013-660096112	GEORGE, MATTHEW & TIFFANY	2	640	0	70	6.00							



Rogers

Assessment Property Record Card for Tax Year 2026

Data provided by LISA DELOZIER County Assessor

Date 04/18/2026
 Time 08:42:35
 Page 2

Lot Data		Square-Foot - NBHD 2017 #1		Primary Image				
Lot Size								
Lot Count								
Units Buildable								
Non-Ag Acres	10.0812							
Topography								
Street Access								
Utilities								
Amenities	LAND QUALITY		0					
			0					
Method	Square-Foot							
Base Lot Value	439,138.00 x .32 = 139,005			660096112_001.JPG 12/10/2025				
Factor Value				GRM Approach				
Adjustments	1.0000			GRM Code				
Lot Value	139,005			Gross Rent 0.00				
				Indicated Value				
Residential Data				Multiple Regression				
Type				MRA Code				
Condition	-			Adusted R				
Quality	-			Indicated Value				
Architecture				Direct Comparables				
Style				Selection Model 1 Res				
Exterior Wall				Adjustment Model A2 AO Test				
Base/Total Area /				Comparables				
Style				Indicated Value				
HVAC				Value Reconciliation				
Roof Cover				Selected Approach Cost Approach				
Area on Slab				Improvements				
Fixture/RghIn /				Lot Value 139,005				
Bed/F/H Bath / /				Indicated Value 139,005 0.00 Per SqFt				
Basement Area				Agland Value				
Garage Type				Site Improvements 21,441				
Remodel				Total Value 160,446 0.00 Total Value Per SqFt				
Year/Eff Age /								
Cost Approach				Manual : 01/2025				
Base Cost	0.00	Total Misc Impr	+ 0					
Roofing Adj	+ 0.00	Garage Cost	+ 0					
Subfloor Adj	+ 0.00	Total RCN	= 0					
Heat/Cool Adj	+ 0.00	Depreciation (0%)	- 0					
Plumbing Adj	+ 0.00	Lump Sums	+ 0					
Basement Adj	+ 0.00	RCNLD	= 0					
Adj Base Cost	= 0.00	Lot Value	+ 139,005					
Total Area	x	Indicated Value	= 139,005					
Adjusted Cost	= 0	Value Per SqFt	0.00					
Miscellaneous Improvements								
Code	Description	Sketch ID	Size	Year	Units	Unit Cost	Depr	Value



Rogers

Assessment Property Record Card for Tax Year 2026

Data provided by LISA DELOZIER County Assessor

Date 04/18/2026
 Time 08:42:35
 Page 3

660096112

Outbuildings/Site Improvements

Building Image	Code	Description	Dimensions	Floor	Roofing	Total Units
	PCPT	Carport - Portable - NCV	18x20x12	Base	Formed Metal	360
	Qual	3	Cond 3	Year 2015	Eff Age 8	
	Valuation Summary		Modifier Total	RCN	Depr (100% Phys/ % Func)	RCNLD
	Base Cost (5.30 x 360)	1,908		1,908	1,908	
	UTIL	Utility Building	25x30x8	Concrete	Formed Metal	750
	Qual	2.5	Cond 3	Year 2014	Eff Age 9	
	Valuation Summary		Modifier Total	RCN	Depr (17% Phys/ % Func)	RCNLD
	Base Cost (31.23 x 750)	23,423		23,423	3,982	19,441
	SHIP	Shipping/Storage Container	8x40x8			320
	Qual	0	Cond 0	Year 0	Eff Age 0	
	Valuation Summary		Modifier Total	RCN	Depr (0% Phys/ 0% Func)	RCNLD
	Base Cost (6.25 x 320)	2,000		2,000		2,000



Rogers

Assessment Property Record Card for Tax Year 2026

Data provided by LISA DELOZIER County Assessor

Date 04/18/2026
 Time 08:42:35
 Page 4

Lot Data	Primary Image
Lot Size Lot Count Units Buildable Non-Ag Acres Topography Street Access Utilities Amenities LAND QUALITY Method Base Lot Value Factor Value Adjustments Lot Value	

Residential Data	
Type	6 Mobile Home 67 x 28
Condition	3 - Average
Quality	4 - Good
Architecture	6 MS ADJ
Style	100% Double Wide
Exterior Wall	100% Frame, Siding, Vinyl
Base/Total Area	1,876 / 1,876
Style	100% Double Wide
HVAC	100% Warmed & Cooled Air
Roof Cover	1 Composition Shingle
Area on Slab	0
Fixture/RghIn	/
Bed/F/H Bath	/ /
Basement Area	
Garage Type	
Remodel	
Year/Eff Age	2014 / 9

GRM Approach	
GRM Code	
Gross Rent	0.00
Indicated Value	

Multiple Regression	
MRA Code	
Adjusted R	
Indicated Value	

Direct Comparables	
Selection Model	1 Res
Adjustment Model	A2 AO Test
Comparables	
Indicated Value	

Cost Approach				Manual : 01/2025			
Base Cost	38.88	Total Misc Impr	+ 2,838				
Roofing Adj	+ 3.51	Garage Cost	+ 0				
Subfloor Adj	+ 0.00	Total RCN	= 108,438				
Heat/Cool Adj	+ 3.23	Depreciation (36%)	- 39,038				
Plumbing Adj	+ 10.67	Lump Sums	+ 14,471				
Basement Adj	+ 0.00	RCNLD	= 83,871				
Adj Base Cost	= 56.29	Lot Value	+ 0				
Total Area	x 1,876	Indicated Value	= 83,871				
Adjusted Cost	= 105,600	Value Per SqFt	44.71				

Value Reconciliation			
Selected Approach	Cost Approach		
Improvements	83,871		
Lot Value			
Indicated Value	83,871	44.71	Per SqFt
Agland Value			
Site Improvements			
Total Value	83,871	44.71	Total Value Per SqFt

Miscellaneous Improvements								
Code	Description	Sketch ID	Size	Year	Units	Unit Cost	Depr	Value
WODC	WOOD DECK - COVERED	136273	18x10		180	50.54		9,097
WODO	WOOD DECK - OPEN	136274	550		550	21.24	54%	5,374
WDBS	Wood Burning Stove			1	1	2,838.13		2,838



Rogers

Assessment Property Record Card for Tax Year 2026

Data provided by LISA DELOZIER County Assessor

Date 04/18/2026
 Time 08:42:35
 Page 5

Sketch Image

660096112

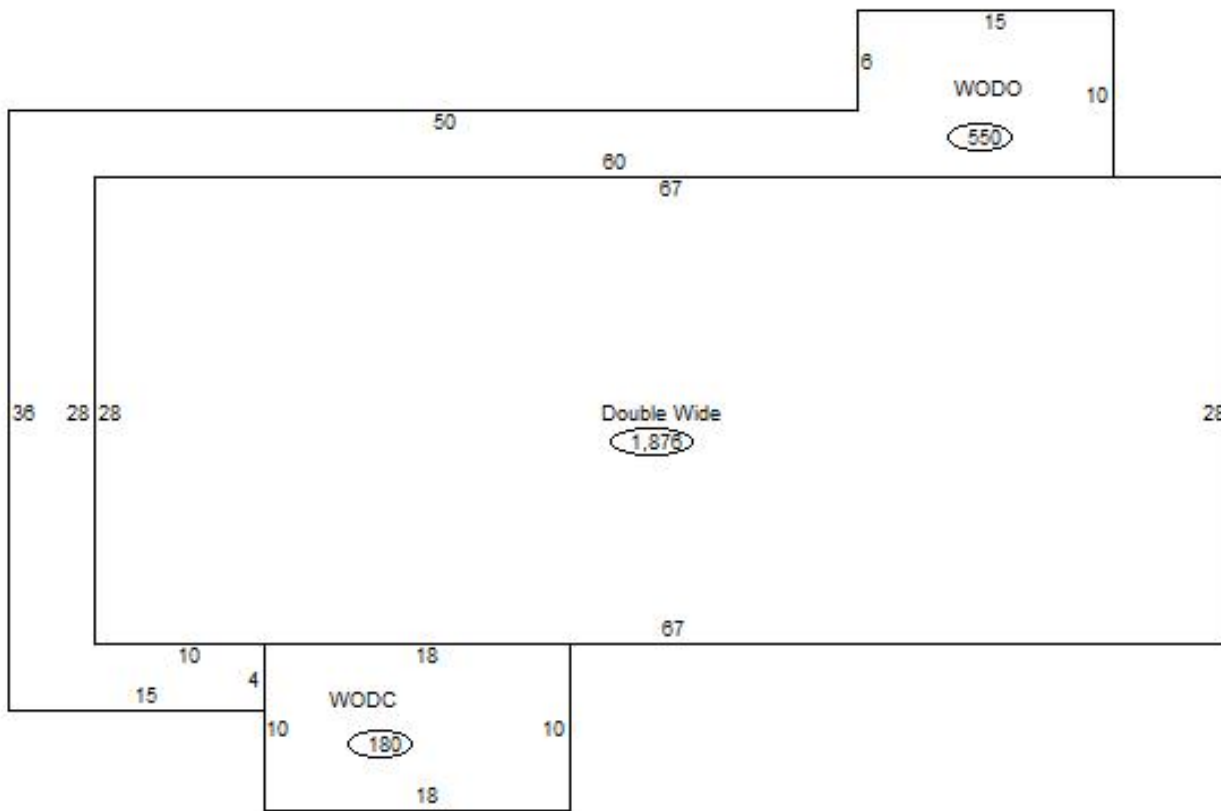

Sketch Vector Information

Sequence	Code	Type	Built Over	Scale	Section Label	Base Area	Multiplier	Total Area
1	R	14		13	Double Wide	1,876	1.000	1,876
2	M	WODC		13	WODC	180	1.000	180
3	M	WODO		13	WODO	550	1.000	550
Total Building Area						1,876		1,876