



# Rogers

## Assessment Property Record Card for Tax Year 2026

Data provided by LISA DELOZIER County Assessor

Date 04/18/2026  
 Time 08:42:56  
 Page 1

| Assessment Data   |                                    | Primary Image                      |             |           |         |                  |            |       |      |
|---|------------------------------------|------------------------------------|-------------|-----------|---------|------------------|------------|-------|------|
| Account   | 660096137                          | <p>660096137_001.JPG 12/9/2025</p> |             |           |         |                  |            |       |      |
| Parcel ID   | 20N15E-30-1-00000-000-0002         |                                    |             |           |         |                  |            |       |      |
| Cadastral ID  | 30-20-15-13320                     |                                    |             |           |         |                  |            |       |      |
| Property Type   | REAL - Real Property               |                                    |             |           |         |                  |            |       |      |
| Property Class  | UR VI Area 3                       |                                    |             |           |         |                  |            |       |      |
| Tax Area  | 1 - CATOOSA OT                     |                                    |             |           |         |                  |            |       |      |
| Name ID   | 294273                             |                                    |             |           |         |                  |            |       |      |
| SHERACK, FRANK M  |                                    |                                    |             |           |         |                  |            |       |      |
| 333 W ELM ST<br>CATOOSA OK 74015-0000   |                                    |                                    |             |           |         |                  |            |       |      |
| Parcel Location   |                                    |                                    |             |           |         |                  |            |       |      |
| Situs   | 00333 W ELM ST                     |                                    |             |           |         |                  |            |       |      |
| Subdivision   |                                    |                                    |             |           |         |                  |            |       |      |
| Lot/Block   | / Parcel Size .24 - Acres          |                                    |             |           |         |                  |            |       |      |
| Sec/Twn/Rng   | 30 / 20 / 15 / 1                   |                                    |             |           |         |                  |            |       |      |
| Neighborhood  | 2015 - UNPLATTED                   |                                    |             |           |         |                  |            |       |      |
| School District   | S002 - CATOOSA SCHOOLS             |                                    |             |           |         |                  |            |       |      |
| Legal Description   | Lat/Long: 36.18442717 -95.75308837 | Building Permits                   |             |           |         |                  |            |       |      |
| TR A IN SW SW NE DESC AS: BEG SW/C NE; N01-07-42W ALG W/L NE 87.92' TO SLY RR ROW; N50-43-28E ALG SD SLY RR ROW 108.37'; S01-10-10E 154.85' TO S/L; S88-5143W 85.34 TO POB. |                                    | Number                             | Description | Opened    | Closed  | Amount           |            |       |      |
|   |                                    |                                    |             |           |         |                  |            |       |      |
| Exemptions  |                                    | Sale History                       |             |           |         |                  |            |       |      |
| Code  | Type                               | Active                             | Maximum     | Exemption | Bk/Pg   | Grantor          | Date       | Price | Code |
| H   | Homestead                          | Yes                                | 1,000       | 1,000     | 2354/78 | SHERACK, FRANK M | 10/11/2011 | 0     | 4    |
| PD  | Add-Homestead                      | Yes                                | 1,000       | 1,000     |         |                  |            |       |      |

| Parcel Valuation |      |              |           |        |             |          |               |         |             |
|------------------|------|--------------|-----------|--------|-------------|----------|---------------|---------|-------------|
| Source           | REAL |              | Fair Cash | Capped | Asmnt Level | Assessed | Levy Rate     | 106.660 | Current Tax |
| Remove Cap       | 2007 | Land Value   | 7,635     | 5,717  | 11%         | 629      | Assessed      | 2,969   | 316.67      |
| Year Frozen      | 2024 | Improvements | 28,411    | 21,274 |             | 2,340    | Penalty       | 0       |             |
| Uncapped Value   | 0    | Mobile Home  | 0         | 0      |             | 0        | Exemption     | 2,000   | -214.00     |
| TIF Project ID   | 0    | Total Value  | 36,046    | 26,991 |             | 2,969    | Total Taxable | 969     | 103.00      |

| Assessment History |                  |                  |          |             |            |               |            |  |
|--------------------|------------------|------------------|----------|-------------|------------|---------------|------------|--|
| Tax Year           | Statement Number | Billed Owner     | Tax Area | Total Value | Exemptions | Taxable Value | Billed Tax |  |
| 2025               | 2025-660096137   | SHERACK, FRANK M | 1        | 32,407      | 2000       | 969           | 103.00     |  |
| 2024               | 2024-660096137   | SHERACK, FRANK M | 1        | 34,461      | 2000       | 969           | 102.00     |  |
| 2023               | 2023-660096137   | SHERACK, FRANK M | 1        | 31,002      | 1000       | 1,882         | 193.00     |  |
| 2022               | 2022-660096137   | SHERACK, FRANK M | 1        | 29,826      | 1000       | 1,799         | 181.00     |  |
| 2021               | 2021-660096137   | SHERACK, FRANK M | 1        | 24,701      | 1000       | 1,717         | 151.00     |  |
| 2020               | 2020-660096137   | SHERACK, FRANK M | 1        | 25,315      | 1000       | 1,752         | 155.00     |  |
| 2019               | 2019-660096137   | SHERACK, FRANK M | 1        | 24,289      | 1000       | 1,672         | 150.00     |  |
| 2018               | 2018-660096137   | SHERACK, FRANK M | 1        | 25,140      | 1000       | 1,765         | 158.00     |  |
| 2017               | 2017-660096137   | SHERACK, FRANK M | 1        | 24,952      | 1000       | 1,743         | 157.00     |  |
| 2016               | 2016-660096137   | SHERACK, FRANK M | 1        | 24,258      | 1000       | 1,663         | 148.00     |  |
| 2015               | 2015-660096137   | SHERACK, FRANK M | 1        | 24,044      | 1000       | 1,585         | 142.00     |  |
| 2014               | 2014-660096137   | SHERACK, FRANK M | 1        | 25,102      | 1000       | 1,510         | 137.00     |  |
| 2013               | 2013-660096137   | SHERACK, FRANK M | 1        | 22,152      | 1000       | 1,437         | 129.00     |  |



# Rogers

## Assessment Property Record Card for Tax Year 2026

Data provided by LISA DELOZIER County Assessor

Date 04/18/2026  
Time 08:42:56  
Page 2

| Lot Data   | Square-Foot - NBHD 2015 #1 | Primary Image |
|--|----------------------------|---------------|
| <b>Lot Size</b><br><b>Lot Count</b><br><b>Units Buildable</b><br><b>Non-Ag Acres</b> 0.2191<br><b>Topography</b><br><b>Street Access</b><br><b>Utilities</b><br><b>Amenities</b> LAND QUALITY 0<br>FLOOD ZONE 0<br><b>Method</b> Square-Foot<br><b>Base Lot Value</b> 9,544.00 x .80 = 7,635<br><b>Factor Value</b><br><b>Adjustments</b> 1.0000<br><b>Lot Value</b> 7,635 |                            |               |

| Residential Data       |                           |
|------------------------|---------------------------|
| <b>Type</b>            | 1 Single Family Residence |
| <b>Condition</b>       | 3 - Average               |
| <b>Quality</b>         | 1.5 - Low                 |
| <b>Architecture</b>    | TRAD TRADITIONAL          |
| <b>Style</b>           | 100% One Story            |
| <b>Exterior Wall</b>   | 100% Frame, Siding, Wood  |
| <b>Base/Total Area</b> | 672 / 672                 |
| <b>Style</b>           | 100% One Story            |
| <b>HVAC</b>            | 100% Floor Furnace        |
| <b>Roof Cover</b>      | 1 Composition Shingle     |
| <b>Area on Slab</b>    | 0                         |
| <b>Fixture/RghIn</b>   | 5 /                       |
| <b>Bed/F/H Bath</b>    | 2 / 1.0 /                 |
| <b>Basement Area</b>   |                           |
| <b>Garage Type</b>     |                           |
| <b>Remodel</b>         |                           |
| <b>Year/Eff Age</b>    | 1952 / 56                 |



660096137\_001.JPG 12/9/2025

| GRM Approach           |      |
|------------------------|------|
| <b>GRM Code</b>        |      |
| <b>Gross Rent</b>      | 0.00 |
| <b>Indicated Value</b> |      |

| Multiple Regression    |        |       |          |
|------------------------|--------|-------|----------|
| <b>MRA Code</b>        | 1      | Test  |          |
| <b>Adusted R</b>       | 0.8445 |       |          |
| <b>Indicated Value</b> | 28,026 | 41.71 | Per SqFt |

| Direct Comparables      |            |
|-------------------------|------------|
| <b>Selection Model</b>  | 1 Res      |
| <b>Adjustment Model</b> | A2 AO Test |
| <b>Comparables</b>      |            |
| <b>Indicated Value</b>  |            |

| Value Reconciliation     |               |       |                      |
|--------------------------|---------------|-------|----------------------|
| <b>Selected Approach</b> | Cost Approach |       |                      |
| <b>Improvements</b>      | 28,411        |       |                      |
| <b>Lot Value</b>         | 7,635         |       |                      |
| <b>Indicated Value</b>   | 36,046        | 53.64 | Per SqFt             |
| <b>Agland Value</b>      |               |       |                      |
| <b>Site Improvements</b> |               |       |                      |
| <b>Total Value</b>       | 36,046        | 53.64 | Total Value Per SqFt |

| Cost Approach        |          |                            |   | Manual : 01/2025 |  |  |  |
|----------------------|----------|----------------------------|---|------------------|--|--|--|
| <b>Base Cost</b>     | 98.61    | <b>Total Misc Impr</b>     | + | 806              |  |  |  |
| <b>Roofing Adj</b>   | + 4.55   | <b>Garage Cost</b>         | + |                  |  |  |  |
| <b>Subfloor Adj</b>  | + 2.77   | <b>Total RCN</b>           | = | 78,919           |  |  |  |
| <b>Heat/Cool Adj</b> | + 1.59   | <b>Depreciation ( 64%)</b> | - | 50,508           |  |  |  |
| <b>Plumbing Adj</b>  | + 8.72   | <b>Lump Sums</b>           | + | 0                |  |  |  |
| <b>Basement Adj</b>  | + 0.00   | <b>RCNLD</b>               | = | 28,411           |  |  |  |
| <b>Adj Base Cost</b> | = 116.24 | <b>Lot Value</b>           | + | 7,635            |  |  |  |
| <b>Total Area</b>    | x 672    | <b>Indicated Value</b>     | = | 36,046           |  |  |  |
| <b>Adjusted Cost</b> | = 78,113 | <b>Value Per SqFt</b>      |   | 53.64            |  |  |  |

| Miscellaneous Improvements |                      |           |      |      |       |           |      |       |
|----------------------------|----------------------|-----------|------|------|-------|-----------|------|-------|
| Code                       | Description          | Sketch ID | Size | Year | Units | Unit Cost | Depr | Value |
| PRCH                       | SLAB PORCH - COVERED | 62408     | 7x4  |      | 28    | 20.47     |      | 573   |
| PATO                       | SLAB PORCH - OPEN    | 62409     | 6x4  |      | 24    | 9.69      |      | 233   |



# Rogers

## Assessment Property Record Card for Tax Year 2026

Data provided by LISA DELOZIER County Assessor

Date 04/18/2026

Time 08:42:56

Page 3

Sketch Image

660096137

Porch w/Roof

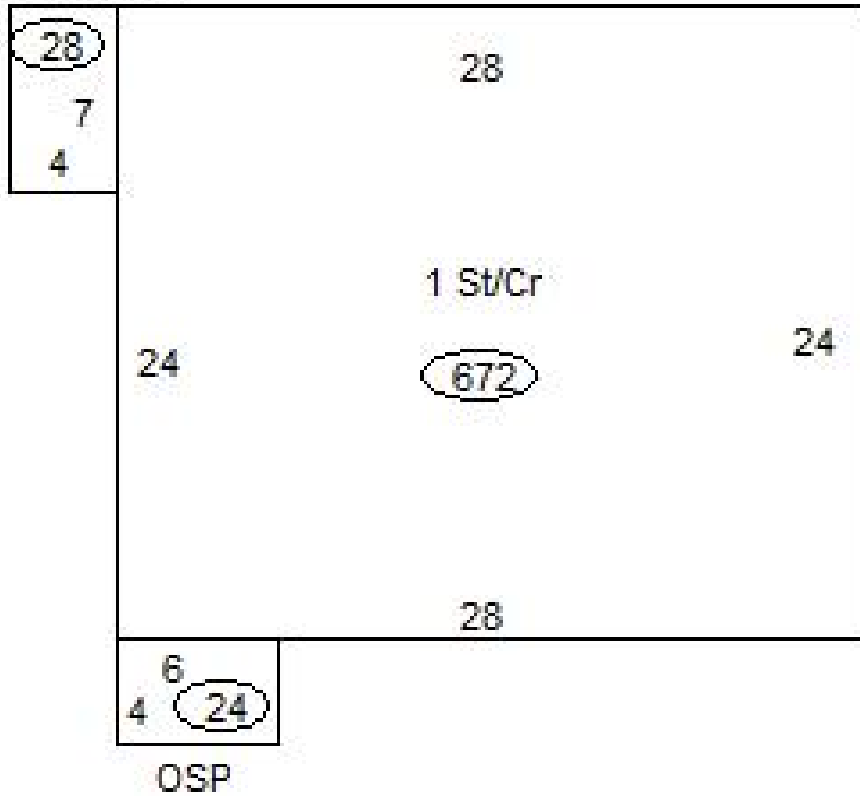

### Sketch Vector Information

| Sequence                   | Code | Type | Built Over | Scale | Section Label | Base Area | Multiplier | Total Area |
|----------------------------|------|------|------------|-------|---------------|-----------|------------|------------|
| 1                          | R    | 1    | Crawl      | 13    | 1 St/Cr       | 672       | 1.000      | 672        |
| 2                          | M    | PRCH |            | 13    | SLBC          | 28        | 1.000      | 28         |
| 3                          | M    | PATO |            | 13    | Open Slab     | 24        | 1.000      | 24         |
| <b>Total Building Area</b> |      |      |            |       |               | 672       |            | 672        |