



Rogers

Assessment Property Record Card for Tax Year 2026

Data provided by LISA DELOZIER County Assessor

Date 04/18/2026
 Time 08:49:39
 Page 1

Assessment Data					Primary Image																																																																																																				
Account 660096804 Parcel ID 000000-00-0-21650-001-0010 Cadastral ID 22-21-14-09180 Property Type REAL - Real Property Property Class URP VI Area 4 Tax Area 40 - OWASSO CITY Name ID 333677 JAMES, DESIREE DIANE & DARRYN CHRISTOPHER 15403 E 87TH ST N OWASSO OK 74055-0000 Parcel Location Situs 15403 E 87TH ST N Subdivision PARK PLACE AT PRESTON LAKES Lot/Block 0010 / 0001 Parcel Size 1 - Lots Sec/Twn/Rng 22 / 21 / 14 / 5 Neighborhood 1059 - R-V04-SW OWASSO School District S021 - OWASSO SCHOOLS																																																																																																									
Legal Description Lat/Long: 36.27995420 -95.80122668 LOT 10 BLOCK 1 PARK PLACE AT PRESTON LAKES										Building Permits <table border="1"> <thead> <tr> <th>Number</th> <th>Description</th> <th>Opened</th> <th>Closed</th> <th>Amount</th> </tr> </thead> <tbody> <tr> <td>14-1206-X</td> <td>R16-NEW 2287 SQ FT SFR</td> <td>01/2015</td> <td>08/2015</td> <td>157,685</td> </tr> </tbody> </table>					Number	Description	Opened	Closed	Amount	14-1206-X	R16-NEW 2287 SQ FT SFR	01/2015	08/2015	157,685																																																																																	
Number	Description	Opened	Closed	Amount																																																																																																					
14-1206-X	R16-NEW 2287 SQ FT SFR	01/2015	08/2015	157,685																																																																																																					
Exemptions <table border="1"> <thead> <tr> <th>Code</th> <th>Type</th> <th>Active</th> <th>Maximum</th> <th>Exemption</th> </tr> </thead> <tbody> <tr> <td></td> <td></td> <td></td> <td></td> <td></td> </tr> </tbody> </table>					Code	Type	Active	Maximum	Exemption						Sale History <table border="1"> <thead> <tr> <th>Bk/Pg</th> <th>Grantor</th> <th>Date</th> <th>Price</th> <th>Code</th> </tr> </thead> <tbody> <tr> <td>/</td> <td>KOURTIS, ROBERT G & GENE L</td> <td>02/25/2021</td> <td>300,000</td> <td>YES</td> </tr> <tr> <td>2494/331</td> <td>SIMMONS HOMES RESIDENTIAL</td> <td>08/19/2015</td> <td>268,500</td> <td>YES</td> </tr> <tr> <td>2421/745</td> <td>K & S DEVELOPMENTS INC</td> <td>03/24/2014</td> <td>0</td> <td>4</td> </tr> </tbody> </table>					Bk/Pg	Grantor	Date	Price	Code	/	KOURTIS, ROBERT G & GENE L	02/25/2021	300,000	YES	2494/331	SIMMONS HOMES RESIDENTIAL	08/19/2015	268,500	YES	2421/745	K & S DEVELOPMENTS INC	03/24/2014	0	4																																																																		
Code	Type	Active	Maximum	Exemption																																																																																																					
Bk/Pg	Grantor	Date	Price	Code																																																																																																					
/	KOURTIS, ROBERT G & GENE L	02/25/2021	300,000	YES																																																																																																					
2494/331	SIMMONS HOMES RESIDENTIAL	08/19/2015	268,500	YES																																																																																																					
2421/745	K & S DEVELOPMENTS INC	03/24/2014	0	4																																																																																																					
Parcel Valuation <table border="1"> <thead> <tr> <th>Source</th> <th>REAL</th> <th>Fair Cash</th> <th>Capped</th> <th>Asmnt Level</th> <th>Assessed</th> <th>Levy Rate</th> <th>97.960</th> <th>Current Tax</th> </tr> </thead> <tbody> <tr> <td>Remove Cap</td> <td>2022</td> <td>Land Value 55,109</td> <td>55,109</td> <td>11%</td> <td>6,062</td> <td>Assessed</td> <td>38,202</td> <td>3,742.27</td> </tr> <tr> <td>Year Frozen</td> <td></td> <td>Improvements 301,993</td> <td>292,178</td> <td></td> <td>32,140</td> <td>Penalty</td> <td>0</td> <td></td> </tr> <tr> <td>Uncapped Value</td> <td>0</td> <td>Mobile Home 0</td> <td>0</td> <td></td> <td>0</td> <td>Exemption</td> <td>0</td> <td>0.00</td> </tr> <tr> <td>TIF Project ID</td> <td>0</td> <td>Total Value 357,102</td> <td>347,287</td> <td></td> <td>38,202</td> <td>Total Taxable</td> <td>38,202</td> <td>3,742.00</td> </tr> </tbody> </table>										Source	REAL	Fair Cash	Capped	Asmnt Level	Assessed	Levy Rate	97.960	Current Tax	Remove Cap	2022	Land Value 55,109	55,109	11%	6,062	Assessed	38,202	3,742.27	Year Frozen		Improvements 301,993	292,178		32,140	Penalty	0		Uncapped Value	0	Mobile Home 0	0		0	Exemption	0	0.00	TIF Project ID	0	Total Value 357,102	347,287		38,202	Total Taxable	38,202	3,742.00																																																			
Source	REAL	Fair Cash	Capped	Asmnt Level	Assessed	Levy Rate	97.960	Current Tax																																																																																																	
Remove Cap	2022	Land Value 55,109	55,109	11%	6,062	Assessed	38,202	3,742.27																																																																																																	
Year Frozen		Improvements 301,993	292,178		32,140	Penalty	0																																																																																																		
Uncapped Value	0	Mobile Home 0	0		0	Exemption	0	0.00																																																																																																	
TIF Project ID	0	Total Value 357,102	347,287		38,202	Total Taxable	38,202	3,742.00																																																																																																	
Assessment History <table border="1"> <thead> <tr> <th>Tax Year</th> <th>Statement Number</th> <th>Billed Owner</th> <th>Tax Area</th> <th>Total Value</th> <th>Exemptions</th> <th>Taxable Value</th> <th>Billed Tax</th> </tr> </thead> <tbody> <tr><td>2025</td><td>2025-660096804</td><td>JAMES, DESIREE DIANE &</td><td>40</td><td>345,088</td><td>0</td><td>36,383</td><td>3,564.00</td></tr> <tr><td>2024</td><td>2024-660096804</td><td>JAMES, DESIREE DIANE &</td><td>40</td><td>364,922</td><td>0</td><td>34,650</td><td>3,329.00</td></tr> <tr><td>2023</td><td>2023-660096804</td><td>JAMES, DESIREE DIANE &</td><td>40</td><td>300,000</td><td>0</td><td>33,000</td><td>3,092.00</td></tr> <tr><td>2022</td><td>2022-660096804</td><td>JAMES, DESIREE DIANE &</td><td>40</td><td>300,000</td><td>0</td><td>33,000</td><td>3,233.00</td></tr> <tr><td>2021</td><td>2021-660096804</td><td>JAMES, DESIREE DIANE &</td><td>40</td><td>286,934</td><td>0</td><td>31,563</td><td>3,053.00</td></tr> <tr><td>2020</td><td>2020-660096804</td><td>KOURTIS, ROBERT G & GENE L</td><td>40</td><td>282,640</td><td>0</td><td>31,090</td><td>3,007.00</td></tr> <tr><td>2019</td><td>2019-660096804</td><td>KOURTIS, ROBERT G & GENE L</td><td>40</td><td>269,815</td><td>0</td><td>29,680</td><td>2,874.00</td></tr> <tr><td>2018</td><td>2018-660096804</td><td>KOURTIS, ROBERT G & GENE L</td><td>40</td><td>276,066</td><td>0</td><td>30,367</td><td>2,832.00</td></tr> <tr><td>2017</td><td>2017-660096804</td><td>KOURTIS, ROBERT G & GENE L</td><td>40</td><td>273,985</td><td>0</td><td>30,138</td><td>2,836.00</td></tr> <tr><td>2016</td><td>2016-660096804</td><td>KOURTIS, ROBERT G & GENE L</td><td>40</td><td>267,580</td><td>0</td><td>29,434</td><td>2,782.00</td></tr> <tr><td>2015</td><td>2015-660096804</td><td>KOURTIS, ROBERT G & GENE L</td><td>40</td><td>50,000</td><td>0</td><td>900</td><td>86.00</td></tr> </tbody> </table>										Tax Year	Statement Number	Billed Owner	Tax Area	Total Value	Exemptions	Taxable Value	Billed Tax	2025	2025-660096804	JAMES, DESIREE DIANE &	40	345,088	0	36,383	3,564.00	2024	2024-660096804	JAMES, DESIREE DIANE &	40	364,922	0	34,650	3,329.00	2023	2023-660096804	JAMES, DESIREE DIANE &	40	300,000	0	33,000	3,092.00	2022	2022-660096804	JAMES, DESIREE DIANE &	40	300,000	0	33,000	3,233.00	2021	2021-660096804	JAMES, DESIREE DIANE &	40	286,934	0	31,563	3,053.00	2020	2020-660096804	KOURTIS, ROBERT G & GENE L	40	282,640	0	31,090	3,007.00	2019	2019-660096804	KOURTIS, ROBERT G & GENE L	40	269,815	0	29,680	2,874.00	2018	2018-660096804	KOURTIS, ROBERT G & GENE L	40	276,066	0	30,367	2,832.00	2017	2017-660096804	KOURTIS, ROBERT G & GENE L	40	273,985	0	30,138	2,836.00	2016	2016-660096804	KOURTIS, ROBERT G & GENE L	40	267,580	0	29,434	2,782.00	2015	2015-660096804	KOURTIS, ROBERT G & GENE L	40	50,000	0	900	86.00
Tax Year	Statement Number	Billed Owner	Tax Area	Total Value	Exemptions	Taxable Value	Billed Tax																																																																																																		
2025	2025-660096804	JAMES, DESIREE DIANE &	40	345,088	0	36,383	3,564.00																																																																																																		
2024	2024-660096804	JAMES, DESIREE DIANE &	40	364,922	0	34,650	3,329.00																																																																																																		
2023	2023-660096804	JAMES, DESIREE DIANE &	40	300,000	0	33,000	3,092.00																																																																																																		
2022	2022-660096804	JAMES, DESIREE DIANE &	40	300,000	0	33,000	3,233.00																																																																																																		
2021	2021-660096804	JAMES, DESIREE DIANE &	40	286,934	0	31,563	3,053.00																																																																																																		
2020	2020-660096804	KOURTIS, ROBERT G & GENE L	40	282,640	0	31,090	3,007.00																																																																																																		
2019	2019-660096804	KOURTIS, ROBERT G & GENE L	40	269,815	0	29,680	2,874.00																																																																																																		
2018	2018-660096804	KOURTIS, ROBERT G & GENE L	40	276,066	0	30,367	2,832.00																																																																																																		
2017	2017-660096804	KOURTIS, ROBERT G & GENE L	40	273,985	0	30,138	2,836.00																																																																																																		
2016	2016-660096804	KOURTIS, ROBERT G & GENE L	40	267,580	0	29,434	2,782.00																																																																																																		
2015	2015-660096804	KOURTIS, ROBERT G & GENE L	40	50,000	0	900	86.00																																																																																																		



Rogers

Assessment Property Record Card for Tax Year 2026

Data provided by LISA DELOZIER County Assessor

Date 04/18/2026
Time 08:49:39
Page 2

Lot Data	Square-Foot - NBHD 1059 #1	Primary Image
Lot Size		
Lot Count	1	
Units Buildable		
Non-Ag Acres		
Topography		
Street Access		
Utilities		
Amenities	0	
	0	
Method	Square-Foot	
Base Lot Value	10,398.00 x 5.30 = 55,109	
Factor Value		
Adjustments	1.0000	
Lot Value	55,109	

Residential Data	
Type	1 Single Family Residence
Condition	3 - Average
Quality	3.25 - Average
Architecture	
Style	100% One Story
Exterior Wall	100% Veneer, Masonry
Base/Total Area	2,207 / 2,207
Style	100% One Story
HVAC	100% Warmed & Cooled Air
Roof Cover	1 Composition Shingle
Area on Slab	2,207
Fixture/RghIn	14 /
Bed/F/H Bath	4 / 3.0 /
Basement Area	
Garage Type	510 Attached Garage - Unfinished
Remodel	
Year/Eff Age	2015 / 8

Cost Approach		Manual : 01/2025	
Base Cost	107.86	Total Misc Impr	+ 16,493
Roofing Adj	+ 4.92	Garage Cost	+ 18,141
Subfloor Adj	+ -2.79	Total RCN	= 328,253
Heat/Cool Adj	+ 13.56	Depreciation (8%)	- 26,260
Plumbing Adj	+ 9.49	Lump Sums	+ 0
Basement Adj	+ 0.00	RCNLD	= 301,993
Adj Base Cost	= 133.04	Lot Value	+ 55,109
Total Area	x 2,207	Indicated Value	= 357,102
Adjusted Cost	= 293,619	Value Per SqFt	161.80



\\tsclient\TCASEY\CASEY BOOTH RESIDENTIAL VI\2022-8-22\ 8/23/2022

GRM Approach	
GRM Code	
Gross Rent	0.00
Indicated Value	

Multiple Regression			
MRA Code	1	Test	
Adusted R	0.8445		
Indicated Value	292,950	132.74	Per SqFt

Direct Comparables			
Selection Model	A	Adam Test	
Adjustment Model	1	2022 Residential	
Comparables	8		
Indicated Value	340,850		Per SqFt

Value Reconciliation			
Selected Approach	Cost Approach		
Improvements	301,993		
Lot Value	55,109		
Indicated Value	357,102	161.80	Per SqFt
Agland Value			
Site Improvements			
Total Value	357,102	161.80	Total Value Per SqFt

Miscellaneous Improvements								
Code	Description	Sketch ID	Size	Year	Units	Unit Cost	Depr	Value
FPR1	FIREPLACE - RESIDENTIAL 1 STORY	0		1	1	6,022.52		6,023
PRCH	SLAB PORCH - COVERED	123699	18x17		306	27.21		8,326
PRCH	SLAB PORCH - COVERED	123700	5x5		25	28.15		704
PATO	SLAB PORCH - OPEN	123701	12x10		120	12.00		1,440



Rogers
Assessment Property Record Card for Tax Year 2026
 Data provided by LISA DELOZIER County Assessor

Date 04/18/2026
 Time 08:49:39
 Page 3

Sketch Image

660096804

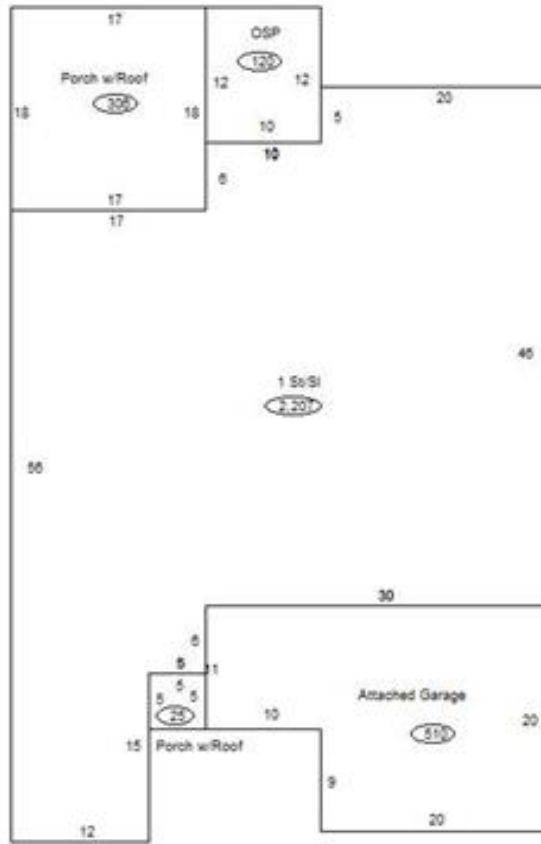

Sketch Vector Information

Sequence	Code	Type	Built Over	Scale	Section Label	Base Area	Multiplier	Total Area
1	R	1	Slab	13	1 St/Sl	2,207	1.000	2,207
2	G	1		13	Attached Garage	510	1.000	510
3	M	PRCH		13	SLBC	306	1.000	306
4	M	PRCH		13	SLBC	25	1.000	25
5	M	PATO		13	Open Slab	120	1.000	120
Total Building Area						2,207		2,207