



# Rogers

## Assessment Property Record Card for Tax Year 2026

Data provided by LISA DELOZIER County Assessor

Date 04/18/2026  
Time 08:50:35  
Page 1

Assessment Data					Primary Image																																																																																																				
<b>Account</b> 660096835 <b>Parcel ID</b> 000000-00-0-21650-001-0041 <b>Cadastral ID</b> 22-21-14-09490 <b>Property Type</b> REAL - Real Property <b>Property Class</b> URP VI Area 4 <b>Tax Area</b> 40 - OWASSO CITY <b>Name ID</b> 317503 LINCOLN, RYAN JEFFERY  8703 N 157TH E AVE OWASSO OK 74055-0000  <b>Parcel Location</b> <b>Situs</b> 08703 N 157TH E AVE <b>Subdivision</b> PARK PLACE AT PRESTON LAKES <b>Lot/Block</b> 0041 / 0001 Parcel Size 1 - Lots <b>Sec/Twn/Rng</b> 22 / 21 / 14 / 5 <b>Neighborhood</b> 1059 - R-V04-SW OWASSO <b>School District</b> S021 - OWASSO SCHOOLS																																																																																																									
<b>Legal Description</b> Lot/Long: 36.27939100 -95.79669410 LOT 41 BLOCK 1 PARK PLACE AT PRESTON LAKES										<b>Building Permits</b> <table border="1"> <thead> <tr> <th>Number</th> <th>Description</th> <th>Opened</th> <th>Closed</th> <th>Amount</th> </tr> </thead> <tbody> <tr> <td>15-0718X</td> <td>R17-NEW 2177 SQ FT SFR</td> <td>08/2015</td> <td>04/2016</td> <td>151,635</td> </tr> </tbody> </table>					Number	Description	Opened	Closed	Amount	15-0718X	R17-NEW 2177 SQ FT SFR	08/2015	04/2016	151,635																																																																																	
Number	Description	Opened	Closed	Amount																																																																																																					
15-0718X	R17-NEW 2177 SQ FT SFR	08/2015	04/2016	151,635																																																																																																					
<b>Exemptions</b> <table border="1"> <thead> <tr> <th>Code</th> <th>Type</th> <th>Active</th> <th>Maximum</th> <th>Exemption</th> </tr> </thead> <tbody> <tr> <td></td> <td></td> <td></td> <td></td> <td></td> </tr> </tbody> </table>					Code	Type	Active	Maximum	Exemption						<b>Sale History</b> <table border="1"> <thead> <tr> <th>Bk/Pg</th> <th>Grantor</th> <th>Date</th> <th>Price</th> <th>Code</th> </tr> </thead> <tbody> <tr> <td>2526/225</td> <td>SIMMONS HOMES RESIDENTIAL</td> <td>01/29/2016</td> <td>258,500</td> <td>YES</td> </tr> <tr> <td>2421/745</td> <td>K &amp; S DEVELOPMENTS INC</td> <td>03/24/2014</td> <td>0</td> <td>4</td> </tr> </tbody> </table>					Bk/Pg	Grantor	Date	Price	Code	2526/225	SIMMONS HOMES RESIDENTIAL	01/29/2016	258,500	YES	2421/745	K & S DEVELOPMENTS INC	03/24/2014	0	4																																																																							
Code	Type	Active	Maximum	Exemption																																																																																																					
Bk/Pg	Grantor	Date	Price	Code																																																																																																					
2526/225	SIMMONS HOMES RESIDENTIAL	01/29/2016	258,500	YES																																																																																																					
2421/745	K & S DEVELOPMENTS INC	03/24/2014	0	4																																																																																																					
<b>Parcel Valuation</b> <table border="1"> <thead> <tr> <th>Source</th> <th>REAL</th> <th>Fair Cash</th> <th>Capped</th> <th>Asmnt Level</th> <th>Assessed</th> <th>Levy Rate</th> <th>97.960</th> <th>Current Tax</th> </tr> </thead> <tbody> <tr> <td>Remove Cap</td> <td>2017</td> <td>Land Value 47,117</td> <td>47,117</td> <td>11%</td> <td>5,183</td> <td>Assessed</td> <td>37,787</td> <td>3,701.61</td> </tr> <tr> <td>Year Frozen</td> <td></td> <td>Improvements 296,404</td> <td>296,404</td> <td></td> <td>32,604</td> <td>Penalty</td> <td>0</td> <td></td> </tr> <tr> <td>Uncapped Value</td> <td>0</td> <td>Mobile Home 0</td> <td>0</td> <td></td> <td>0</td> <td>Exemption</td> <td>0</td> <td>0.00</td> </tr> <tr> <td>TIF Project ID</td> <td>0</td> <td>Total Value 343,521</td> <td>343,521</td> <td></td> <td>37,787</td> <td>Total Taxable</td> <td>37,787</td> <td>3,702.00</td> </tr> </tbody> </table>										Source	REAL	Fair Cash	Capped	Asmnt Level	Assessed	Levy Rate	97.960	Current Tax	Remove Cap	2017	Land Value 47,117	47,117	11%	5,183	Assessed	37,787	3,701.61	Year Frozen		Improvements 296,404	296,404		32,604	Penalty	0		Uncapped Value	0	Mobile Home 0	0		0	Exemption	0	0.00	TIF Project ID	0	Total Value 343,521	343,521		37,787	Total Taxable	37,787	3,702.00																																																			
Source	REAL	Fair Cash	Capped	Asmnt Level	Assessed	Levy Rate	97.960	Current Tax																																																																																																	
Remove Cap	2017	Land Value 47,117	47,117	11%	5,183	Assessed	37,787	3,701.61																																																																																																	
Year Frozen		Improvements 296,404	296,404		32,604	Penalty	0																																																																																																		
Uncapped Value	0	Mobile Home 0	0		0	Exemption	0	0.00																																																																																																	
TIF Project ID	0	Total Value 343,521	343,521		37,787	Total Taxable	37,787	3,702.00																																																																																																	
<b>Assessment History</b> <table border="1"> <thead> <tr> <th>Tax Year</th> <th>Statement Number</th> <th>Billed Owner</th> <th>Tax Area</th> <th>Total Value</th> <th>Exemptions</th> <th>Taxable Value</th> <th>Billed Tax</th> </tr> </thead> <tbody> <tr><td>2025</td><td>2025-660096835</td><td>LINCOLN, RYAN JEFFERY</td><td>40</td><td>334,579</td><td>0</td><td>36,639</td><td>3,589.00</td></tr> <tr><td>2024</td><td>2024-660096835</td><td>LINCOLN, RYAN JEFFERY</td><td>40</td><td>356,767</td><td>0</td><td>34,893</td><td>3,352.00</td></tr> <tr><td>2023</td><td>2023-660096835</td><td>LINCOLN, RYAN JEFFERY</td><td>40</td><td>317,822</td><td>0</td><td>33,233</td><td>3,114.00</td></tr> <tr><td>2022</td><td>2022-660096835</td><td>LINCOLN, RYAN JEFFERY</td><td>40</td><td>302,817</td><td>0</td><td>31,650</td><td>3,101.00</td></tr> <tr><td>2021</td><td>2021-660096835</td><td>LINCOLN, RYAN JEFFERY</td><td>40</td><td>274,025</td><td>0</td><td>30,143</td><td>2,916.00</td></tr> <tr><td>2020</td><td>2020-660096835</td><td>LINCOLN, RYAN JEFFERY</td><td>40</td><td>269,670</td><td>0</td><td>29,648</td><td>2,868.00</td></tr> <tr><td>2019</td><td>2019-660096835</td><td>LINCOLN, RYAN JEFFERY</td><td>40</td><td>256,689</td><td>0</td><td>28,236</td><td>2,734.00</td></tr> <tr><td>2018</td><td>2018-660096835</td><td>LINCOLN, RYAN JEFFERY</td><td>40</td><td>263,036</td><td>0</td><td>28,934</td><td>2,698.00</td></tr> <tr><td>2017</td><td>2017-660096835</td><td>LINCOLN, RYAN JEFFERY</td><td>40</td><td>260,953</td><td>0</td><td>28,705</td><td>2,701.00</td></tr> <tr><td>2016</td><td>2016-660096835</td><td>LINCOLN, RYAN JEFFERY</td><td>40</td><td>50,000</td><td>0</td><td>944</td><td>89.00</td></tr> <tr><td>2015</td><td>2015-660096835</td><td>SIMMONS HOMES RESIDENTIAL</td><td>40</td><td>50,000</td><td>0</td><td>900</td><td>86.00</td></tr> </tbody> </table>										Tax Year	Statement Number	Billed Owner	Tax Area	Total Value	Exemptions	Taxable Value	Billed Tax	2025	2025-660096835	LINCOLN, RYAN JEFFERY	40	334,579	0	36,639	3,589.00	2024	2024-660096835	LINCOLN, RYAN JEFFERY	40	356,767	0	34,893	3,352.00	2023	2023-660096835	LINCOLN, RYAN JEFFERY	40	317,822	0	33,233	3,114.00	2022	2022-660096835	LINCOLN, RYAN JEFFERY	40	302,817	0	31,650	3,101.00	2021	2021-660096835	LINCOLN, RYAN JEFFERY	40	274,025	0	30,143	2,916.00	2020	2020-660096835	LINCOLN, RYAN JEFFERY	40	269,670	0	29,648	2,868.00	2019	2019-660096835	LINCOLN, RYAN JEFFERY	40	256,689	0	28,236	2,734.00	2018	2018-660096835	LINCOLN, RYAN JEFFERY	40	263,036	0	28,934	2,698.00	2017	2017-660096835	LINCOLN, RYAN JEFFERY	40	260,953	0	28,705	2,701.00	2016	2016-660096835	LINCOLN, RYAN JEFFERY	40	50,000	0	944	89.00	2015	2015-660096835	SIMMONS HOMES RESIDENTIAL	40	50,000	0	900	86.00
Tax Year	Statement Number	Billed Owner	Tax Area	Total Value	Exemptions	Taxable Value	Billed Tax																																																																																																		
2025	2025-660096835	LINCOLN, RYAN JEFFERY	40	334,579	0	36,639	3,589.00																																																																																																		
2024	2024-660096835	LINCOLN, RYAN JEFFERY	40	356,767	0	34,893	3,352.00																																																																																																		
2023	2023-660096835	LINCOLN, RYAN JEFFERY	40	317,822	0	33,233	3,114.00																																																																																																		
2022	2022-660096835	LINCOLN, RYAN JEFFERY	40	302,817	0	31,650	3,101.00																																																																																																		
2021	2021-660096835	LINCOLN, RYAN JEFFERY	40	274,025	0	30,143	2,916.00																																																																																																		
2020	2020-660096835	LINCOLN, RYAN JEFFERY	40	269,670	0	29,648	2,868.00																																																																																																		
2019	2019-660096835	LINCOLN, RYAN JEFFERY	40	256,689	0	28,236	2,734.00																																																																																																		
2018	2018-660096835	LINCOLN, RYAN JEFFERY	40	263,036	0	28,934	2,698.00																																																																																																		
2017	2017-660096835	LINCOLN, RYAN JEFFERY	40	260,953	0	28,705	2,701.00																																																																																																		
2016	2016-660096835	LINCOLN, RYAN JEFFERY	40	50,000	0	944	89.00																																																																																																		
2015	2015-660096835	SIMMONS HOMES RESIDENTIAL	40	50,000	0	900	86.00																																																																																																		



# Rogers

## Assessment Property Record Card for Tax Year 2026

Data provided by LISA DELOZIER County Assessor

Date 04/18/2026  
 Time 08:50:36  
 Page 2

Lot Data		Square-Foot - NBHD 1059 #1
Lot Size		
Lot Count	1	
Units Buildable		
Non-Ag Acres		
Topography		
Street Access		
Utilities		
Amenities		0
		0
Method	Square-Foot	
Base Lot Value	8,890.00 x 5.30 =	47,117
Factor Value		
Adjustments	1.0000	
Lot Value		47,117

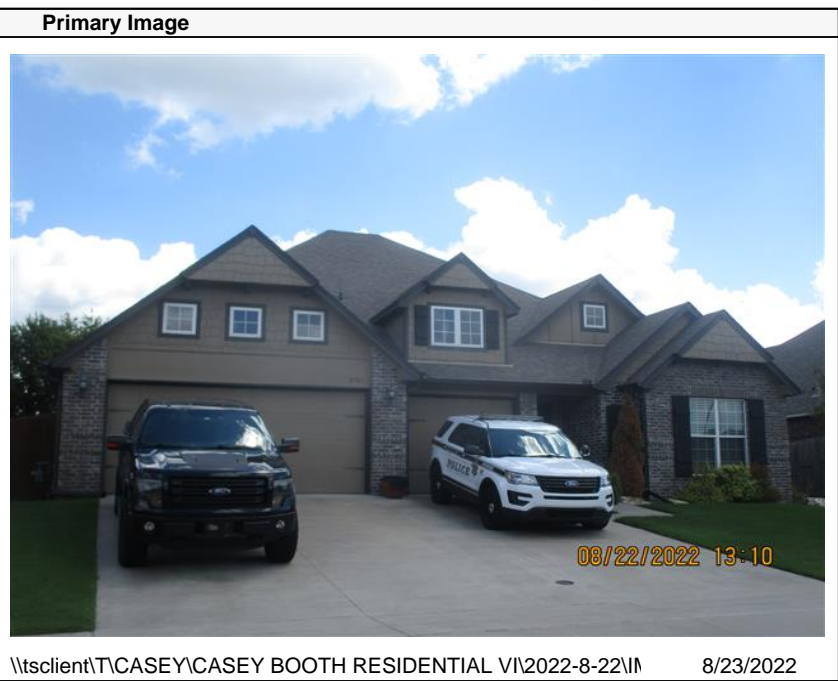

\\tsclient\TCASEY\CASEY BOOTH RESIDENTIAL VI\2022-8-22\I 8/23/2022

Residential Data	
Type	1 Single Family Residence
Condition	3 - Average
Quality	3.5 - Average
Architecture	
Style	100% One Story
Exterior Wall	100% Veneer, Masonry
Base/Total Area	2,177 / 2,177
Style	100% One Story
HVAC	100% Warmed & Cooled Air
Roof Cover	1 Composition Shingle
Area on Slab	2,177
Fixture/RghIn	11 /
Bed/F/H Bath	4 / 2.0 /
Basement Area	
Garage Type	580 Attached Garage - Unfinished
Remodel	
Year/Eff Age	2016 / 8

GRM Approach	
GRM Code	
Gross Rent	0.00
Indicated Value	

Multiple Regression			
MRA Code	1	Test	
Adusted R	0.8445		
Indicated Value	312,156	143.39	Per SqFt

Direct Comparables			
Selection Model	A	Adam Test	
Adjustment Model	1	2022 Residential	
Comparables	8		
Indicated Value	353,180		Per SqFt

Cost Approach		Manual : 01/2025	
Base Cost	110.68	Total Misc Impr	+ 5,573
Roofing Adj	+ 5.27	Garage Cost	+ 22,318
Subfloor Adj	+ -3.40	Total RCN	= 322,178
Heat/Cool Adj	+ 14.47	Depreciation ( 8%)	- 25,774
Plumbing Adj	+ 8.16	Lump Sums	+ 0
Basement Adj	+ 0.00	RCNLD	= 296,404
Adj Base Cost	= 135.18	Lot Value	+ 47,117
Total Area	x 2,177	Indicated Value	= 343,521
Adjusted Cost	= 294,287	Value Per SqFt	157.80

Value Reconciliation			
Selected Approach	Cost Approach		
Improvements	296,404		
Lot Value	47,117		
Indicated Value	343,521	157.80	Per SqFt
Agland Value			
Site Improvements			
Total Value	343,521	157.80	Total Value Per SqFt

Miscellaneous Improvements								
Code	Description	Sketch ID	Size	Year	Units	Unit Cost	Depr	Value
PRCH	SLAB PORCH - COVERED	129422	18x9		162	28.95		4,690
PRCH	SLAB PORCH - COVERED	129423	6x5		30	29.44		883



# Rogers

## Assessment Property Record Card for Tax Year 2026

Data provided by LISA DELOZIER County Assessor

Date 04/18/2026  
 Time 08:50:36  
 Page 3

Sketch Image

660096835

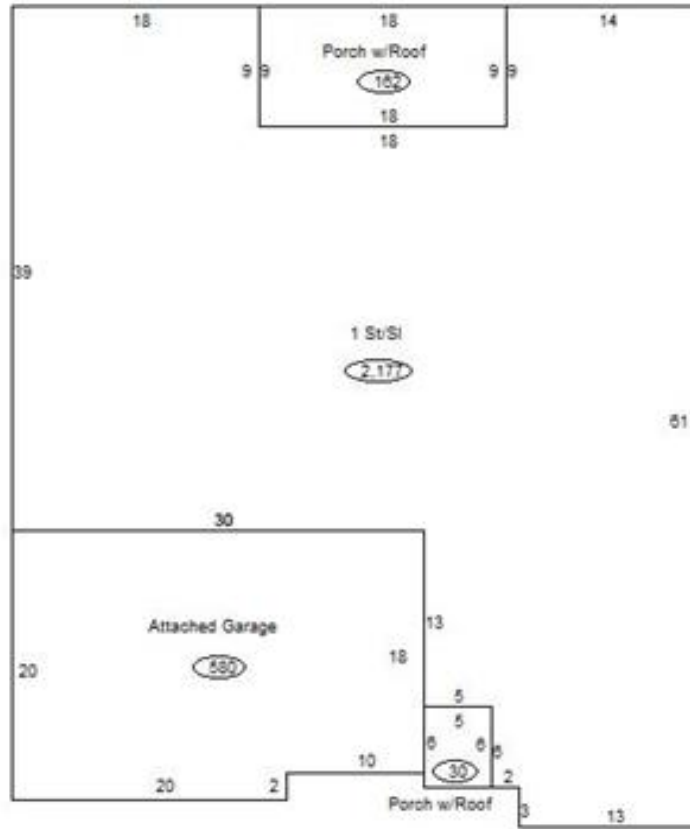

### Sketch Vector Information

Sequence	Code	Type	Built Over	Scale	Section Label	Base Area	Multiplier	Total Area
1	R	1	Slab	13	1 St/Sl	2,177	1.000	2,177
2	G	1		13	Attached Garage	580	1.000	580
3	M	PRCH		13	SLBC	162	1.000	162
4	M	PRCH		13	SLBC	30	1.000	30
<b>Total Building Area</b>						<b>2,177</b>		<b>2,177</b>