



# Rogers

## Assessment Property Record Card for Tax Year 2026

Data provided by LISA DELOZIER County Assessor

Date 04/18/2026  
Time 08:50:48  
Page 1

Assessment Data					Primary Image																																																																																																				
<b>Account</b> 660096842 <b>Parcel ID</b> 000000-00-0-21650-002-0004 <b>Cadastral ID</b> 22-21-14-09590 <b>Property Type</b> REAL - Real Property <b>Property Class</b> URP VI Area 4 <b>Tax Area</b> 40 - OWASSO CITY <b>Name ID</b> 329329 BEAUCHAMP, LISA ANN  15508 E 87TH ST N OWASSO OK 74055-0000  <b>Parcel Location</b> <b>Situs</b> 15508 E 87TH ST N <b>Subdivision</b> PARK PLACE AT PRESTON LAKES <b>Lot/Block</b> 0004 / 0002 Parcel Size 1 - Lots <b>Sec/Twn/Rng</b> 22 / 21 / 14 / 5 <b>Neighborhood</b> 1059 - R-V04-SW OWASSO <b>School District</b> S021 - OWASSO SCHOOLS																																																																																																									
<b>Legal Description</b> Lot/Long: 36.27888972 -95.79918306																																																																																																									
<b>Legal Description</b> LOT 4 BLOCK 2 PARK PLACE AT PRESTON LAKES					<b>Building Permits</b> <table border="1"> <thead> <tr> <th>Number</th> <th>Description</th> <th>Opened</th> <th>Closed</th> <th>Amount</th> </tr> </thead> <tbody> <tr> <td>15-0509-X</td> <td>R16-NEW 1518 SQ FT SFR</td> <td>06/2015</td> <td>11/2015</td> <td>121,385</td> </tr> </tbody> </table>					Number	Description	Opened	Closed	Amount	15-0509-X	R16-NEW 1518 SQ FT SFR	06/2015	11/2015	121,385																																																																																						
Number	Description	Opened	Closed	Amount																																																																																																					
15-0509-X	R16-NEW 1518 SQ FT SFR	06/2015	11/2015	121,385																																																																																																					
<b>Exemptions</b> <table border="1"> <thead> <tr> <th>Code</th> <th>Type</th> <th>Active</th> <th>Maximum</th> <th>Exemption</th> </tr> </thead> <tbody> <tr> <td>H</td> <td>Homestead</td> <td>No</td> <td>1,000</td> <td></td> </tr> </tbody> </table>					Code	Type	Active	Maximum	Exemption	H	Homestead	No	1,000		<b>Sale History</b> <table border="1"> <thead> <tr> <th>Bk/Pg</th> <th>Grantor</th> <th>Date</th> <th>Price</th> <th>Code</th> </tr> </thead> <tbody> <tr> <td>/</td> <td>BENEDETTI, MAURIZIO &amp;</td> <td>11/05/2019</td> <td>242,500</td> <td>YES</td> </tr> <tr> <td>2511/941</td> <td>SIMMONS HOMES RESIDENTIAL</td> <td>11/10/2015</td> <td>231,000</td> <td>YES</td> </tr> <tr> <td>2421/745</td> <td>K &amp; S DEVELOPMENTS INC</td> <td>03/24/2014</td> <td>0</td> <td>4</td> </tr> </tbody> </table>					Bk/Pg	Grantor	Date	Price	Code	/	BENEDETTI, MAURIZIO &	11/05/2019	242,500	YES	2511/941	SIMMONS HOMES RESIDENTIAL	11/10/2015	231,000	YES	2421/745	K & S DEVELOPMENTS INC	03/24/2014	0	4																																																																		
Code	Type	Active	Maximum	Exemption																																																																																																					
H	Homestead	No	1,000																																																																																																						
Bk/Pg	Grantor	Date	Price	Code																																																																																																					
/	BENEDETTI, MAURIZIO &	11/05/2019	242,500	YES																																																																																																					
2511/941	SIMMONS HOMES RESIDENTIAL	11/10/2015	231,000	YES																																																																																																					
2421/745	K & S DEVELOPMENTS INC	03/24/2014	0	4																																																																																																					
<b>Parcel Valuation</b> <table border="1"> <thead> <tr> <th>Source</th> <th>REAL</th> <th>Fair Cash</th> <th>Capped</th> <th>Asmnt Level</th> <th>Assessed</th> <th>Levy Rate</th> <th>97.960</th> <th>Current Tax</th> </tr> </thead> <tbody> <tr> <td>Remove Cap</td> <td>2020</td> <td>Land Value 48,771</td> <td>48,771</td> <td>11%</td> <td>5,365</td> <td>Assessed</td> <td>35,089</td> <td>3,437.32</td> </tr> <tr> <td>Year Frozen</td> <td></td> <td>Improvements 276,378</td> <td>270,214</td> <td></td> <td>29,724</td> <td>Penalty</td> <td>0</td> <td></td> </tr> <tr> <td>Uncapped Value</td> <td>0</td> <td>Mobile Home 0</td> <td>0</td> <td></td> <td>0</td> <td>Exemption</td> <td>0</td> <td>0.00</td> </tr> <tr> <td>TIF Project ID</td> <td>0</td> <td>Total Value 325,149</td> <td>318,985</td> <td></td> <td>35,089</td> <td>Total Taxable</td> <td>35,089</td> <td>3,437.00</td> </tr> </tbody> </table>										Source	REAL	Fair Cash	Capped	Asmnt Level	Assessed	Levy Rate	97.960	Current Tax	Remove Cap	2020	Land Value 48,771	48,771	11%	5,365	Assessed	35,089	3,437.32	Year Frozen		Improvements 276,378	270,214		29,724	Penalty	0		Uncapped Value	0	Mobile Home 0	0		0	Exemption	0	0.00	TIF Project ID	0	Total Value 325,149	318,985		35,089	Total Taxable	35,089	3,437.00																																																			
Source	REAL	Fair Cash	Capped	Asmnt Level	Assessed	Levy Rate	97.960	Current Tax																																																																																																	
Remove Cap	2020	Land Value 48,771	48,771	11%	5,365	Assessed	35,089	3,437.32																																																																																																	
Year Frozen		Improvements 276,378	270,214		29,724	Penalty	0																																																																																																		
Uncapped Value	0	Mobile Home 0	0		0	Exemption	0	0.00																																																																																																	
TIF Project ID	0	Total Value 325,149	318,985		35,089	Total Taxable	35,089	3,437.00																																																																																																	
<b>Assessment History</b> <table border="1"> <thead> <tr> <th>Tax Year</th> <th>Statement Number</th> <th>Billed Owner</th> <th>Tax Area</th> <th>Total Value</th> <th>Exemptions</th> <th>Taxable Value</th> <th>Billed Tax</th> </tr> </thead> <tbody> <tr><td>2025</td><td>2025-660096842</td><td>BEAUCHAMP, LISA ANN</td><td>40</td><td>313,955</td><td>0</td><td>33,418</td><td>3,274.00</td></tr> <tr><td>2024</td><td>2024-660096842</td><td>BEAUCHAMP, LISA ANN</td><td>40</td><td>335,140</td><td>0</td><td>31,826</td><td>3,058.00</td></tr> <tr><td>2023</td><td>2023-660096842</td><td>BEAUCHAMP, LISA ANN</td><td>40</td><td>297,568</td><td>0</td><td>30,311</td><td>2,840.00</td></tr> <tr><td>2022</td><td>2022-660096842</td><td>BEAUCHAMP, LISA ANN</td><td>40</td><td>290,087</td><td>0</td><td>28,868</td><td>2,828.00</td></tr> <tr><td>2021</td><td>2021-660096842</td><td>BEAUCHAMP, JASON T &amp;</td><td>40</td><td>249,936</td><td>0</td><td>27,493</td><td>2,660.00</td></tr> <tr><td>2020</td><td>2020-660096842</td><td>BEAUCHAMP, JASON T &amp;</td><td>40</td><td>246,229</td><td>0</td><td>27,085</td><td>2,620.00</td></tr> <tr><td>2019</td><td>2019-660096842</td><td>BENEDETTI, MAURIZIO &amp;</td><td>40</td><td>238,504</td><td>1000</td><td>25,235</td><td>2,444.00</td></tr> <tr><td>2018</td><td>2018-660096842</td><td>BENEDETTI, MAURIZIO &amp;</td><td>40</td><td>244,154</td><td>1000</td><td>25,857</td><td>2,411.00</td></tr> <tr><td>2017</td><td>2017-660096842</td><td>BENEDETTI, MAURIZIO &amp;</td><td>40</td><td>242,292</td><td>1000</td><td>25,652</td><td>2,414.00</td></tr> <tr><td>2016</td><td>2016-660096842</td><td>BENEDETTI, MAURIZIO &amp;</td><td>40</td><td>236,559</td><td>1000</td><td>25,021</td><td>2,365.00</td></tr> <tr><td>2015</td><td>2015-660096842</td><td>SIMMONS HOMES RESIDENTIAL</td><td>40</td><td>50,000</td><td>0</td><td>900</td><td>86.00</td></tr> </tbody> </table>										Tax Year	Statement Number	Billed Owner	Tax Area	Total Value	Exemptions	Taxable Value	Billed Tax	2025	2025-660096842	BEAUCHAMP, LISA ANN	40	313,955	0	33,418	3,274.00	2024	2024-660096842	BEAUCHAMP, LISA ANN	40	335,140	0	31,826	3,058.00	2023	2023-660096842	BEAUCHAMP, LISA ANN	40	297,568	0	30,311	2,840.00	2022	2022-660096842	BEAUCHAMP, LISA ANN	40	290,087	0	28,868	2,828.00	2021	2021-660096842	BEAUCHAMP, JASON T &	40	249,936	0	27,493	2,660.00	2020	2020-660096842	BEAUCHAMP, JASON T &	40	246,229	0	27,085	2,620.00	2019	2019-660096842	BENEDETTI, MAURIZIO &	40	238,504	1000	25,235	2,444.00	2018	2018-660096842	BENEDETTI, MAURIZIO &	40	244,154	1000	25,857	2,411.00	2017	2017-660096842	BENEDETTI, MAURIZIO &	40	242,292	1000	25,652	2,414.00	2016	2016-660096842	BENEDETTI, MAURIZIO &	40	236,559	1000	25,021	2,365.00	2015	2015-660096842	SIMMONS HOMES RESIDENTIAL	40	50,000	0	900	86.00
Tax Year	Statement Number	Billed Owner	Tax Area	Total Value	Exemptions	Taxable Value	Billed Tax																																																																																																		
2025	2025-660096842	BEAUCHAMP, LISA ANN	40	313,955	0	33,418	3,274.00																																																																																																		
2024	2024-660096842	BEAUCHAMP, LISA ANN	40	335,140	0	31,826	3,058.00																																																																																																		
2023	2023-660096842	BEAUCHAMP, LISA ANN	40	297,568	0	30,311	2,840.00																																																																																																		
2022	2022-660096842	BEAUCHAMP, LISA ANN	40	290,087	0	28,868	2,828.00																																																																																																		
2021	2021-660096842	BEAUCHAMP, JASON T &	40	249,936	0	27,493	2,660.00																																																																																																		
2020	2020-660096842	BEAUCHAMP, JASON T &	40	246,229	0	27,085	2,620.00																																																																																																		
2019	2019-660096842	BENEDETTI, MAURIZIO &	40	238,504	1000	25,235	2,444.00																																																																																																		
2018	2018-660096842	BENEDETTI, MAURIZIO &	40	244,154	1000	25,857	2,411.00																																																																																																		
2017	2017-660096842	BENEDETTI, MAURIZIO &	40	242,292	1000	25,652	2,414.00																																																																																																		
2016	2016-660096842	BENEDETTI, MAURIZIO &	40	236,559	1000	25,021	2,365.00																																																																																																		
2015	2015-660096842	SIMMONS HOMES RESIDENTIAL	40	50,000	0	900	86.00																																																																																																		



# Rogers

## Assessment Property Record Card for Tax Year 2026

Data provided by LISA DELOZIER County Assessor

Date 04/18/2026  
Time 08:50:48  
Page 2

Lot Data	Square-Foot - NBHD 1059 #1	Primary Image
Lot Size		
Lot Count	1	
Units Buildable		
Non-Ag Acres		
Topography		
Street Access		
Utilities		
Amenities	0	
	0	
Method	Square-Foot	
Base Lot Value	9,202.00 x 5.30 = 48,771	
Factor Value		
Adjustments	1.0000	
Lot Value	48,771	

Residential Data	
Type	1 Single Family Residence
Condition	3 - Average
Quality	3 - Average
Architecture	
Style	100% One Story
Exterior Wall	100% Veneer, Masonry
Base/Total Area	2,207 / 2,207
Style	100% One Story
HVAC	100% Warmed & Cooled Air
Roof Cover	1 Composition Shingle
Area on Slab	2,207
Fixture/RghIn	11 /
Bed/F/H Bath	4 / 3.0 /
Basement Area	
Garage Type	510 Attached Garage - Unfinished
Remodel	
Year/Eff Age	2015 / 8



\\tsclient\TCASEY\CASEY BOOTH RESIDENTIAL VI\2022-8-22\ 8/23/2022

GRM Approach	
GRM Code	
Gross Rent	0.00
Indicated Value	

Multiple Regression			
MRA Code	1	Test	
Adjusted R	0.8445		
Indicated Value	279,411	126.60	Per SqFt

Direct Comparables			
Selection Model	A	Adam Test	
Adjustment Model	1	2022 Residential	
Comparables	8		
Indicated Value	326,800		Per SqFt

Value Reconciliation			
Selected Approach	Cost Approach		
Improvements	276,378		
Lot Value	48,771		
Indicated Value	325,149	147.33	Per SqFt
Agland Value			
Site Improvements			
Total Value	325,149	147.33	Total Value Per SqFt

Cost Approach				Manual : 01/2025			
Base Cost	105.06	Total Misc Impr	+	3,653			
Roofing Adj	+ 4.59	Garage Cost	+	16,182			
Subfloor Adj	+ -2.19	Total RCN	=	300,411			
Heat/Cool Adj	+ 12.64	Depreciation ( 8%)	-	24,033			
Plumbing Adj	+ 7.03	Lump Sums	+	0			
Basement Adj	+ 0.00	RCNLD	=	276,378			
Adj Base Cost	= 127.13	Lot Value	+	48,771			
Total Area	x 2,207	Indicated Value	=	325,149			
Adjusted Cost	= 280,576	Value Per SqFt		147.33			

Miscellaneous Improvements								
Code	Description	Sketch ID	Size	Year	Units	Unit Cost	Depr	Value
PRCH	SLAB PORCH - COVERED	125792	17x6		102	26.61		2,714
PRCH	SLAB PORCH - COVERED	125793	7x5		35	26.82		939



**Rogers**  
**Assessment Property Record Card for Tax Year 2026**

Data provided by LISA DELOZIER County Assessor

Date 04/18/2026  
 Time 08:50:48  
 Page 3

Sketch Image

660096842

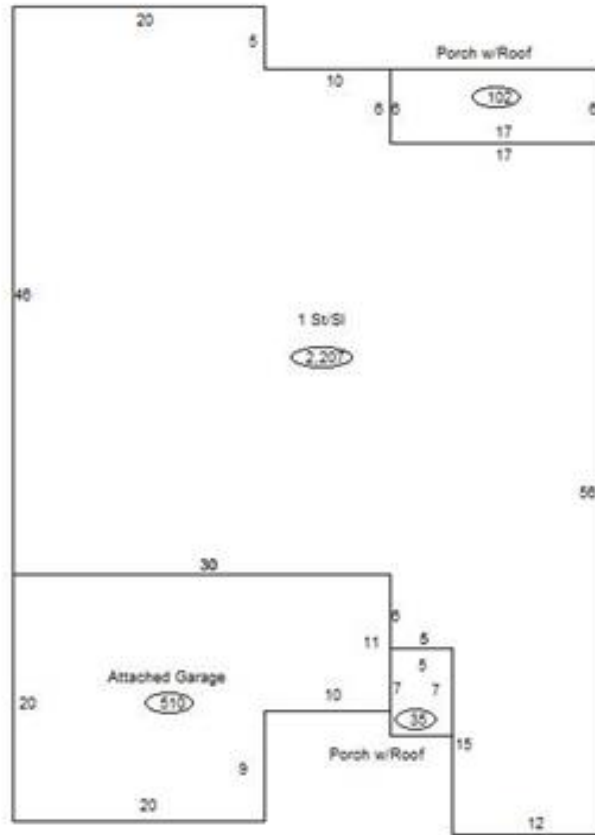

**Sketch Vector Information**

Sequence	Code	Type	Built Over	Scale	Section Label	Base Area	Multiplier	Total Area
1	R	1	Slab	13	1 St/Sl	2,207	1.000	2,207
2	G	1		13	Attached Garage	510	1.000	510
3	M	PRCH		13	SLBC	102	1.000	102
4	M	PRCH		13	SLBC	35	1.000	35
<b>Total Building Area</b>						<b>2,207</b>		<b>2,207</b>