



# Rogers

## Assessment Property Record Card for Tax Year 2026

Data provided by LISA DELOZIER County Assessor

Date 04/18/2026  
Time 08:50:50  
Page 1

Assessment Data					Primary Image																																																																																																				
<b>Account</b> 660096843 <b>Parcel ID</b> 000000-00-0-21650-002-0005 <b>Cadastral ID</b> 22-21-14-09600 <b>Property Type</b> REAL - Real Property <b>Property Class</b> URP VI Area 4 <b>Tax Area</b> 40 - OWASSO CITY <b>Name ID</b> 318007 CGS REALTY LLC  12150 E 96TH ST N STE 200 OWASSO OK 74055-0000  <b>Parcel Location</b> <b>Situs</b> 15510 E 87TH ST N <b>Subdivision</b> PARK PLACE AT PRESTON LAKES <b>Lot/Block</b> 0005 / 0002 Parcel Size 1 - Lots <b>Sec/Twn/Rng</b> 22 / 21 / 14 / 5 <b>Neighborhood</b> 1059 - R-V04-SW OWASSO <b>School District</b> S021 - OWASSO SCHOOLS																																																																																																									
<b>Legal Description</b> Lot/Long: 36.27886669 -95.79888122																																																																																																									
<b>Legal Description</b> LOT 5 BLOCK 2 PARK PLACE AT PRESTON LAKES					<b>Building Permits</b> <table border="1"> <thead> <tr> <th>Number</th> <th>Description</th> <th>Opened</th> <th>Closed</th> <th>Amount</th> </tr> </thead> <tbody> <tr> <td>14-0329X</td> <td>R15-NEW 2020 SQ FT SFR</td> <td>08/2014</td> <td>11/2014</td> <td>143,000</td> </tr> </tbody> </table>					Number	Description	Opened	Closed	Amount	14-0329X	R15-NEW 2020 SQ FT SFR	08/2014	11/2014	143,000																																																																																						
Number	Description	Opened	Closed	Amount																																																																																																					
14-0329X	R15-NEW 2020 SQ FT SFR	08/2014	11/2014	143,000																																																																																																					
<b>Exemptions</b> <table border="1"> <thead> <tr> <th>Code</th> <th>Type</th> <th>Active</th> <th>Maximum</th> <th>Exemption</th> </tr> </thead> <tbody> <tr> <td></td> <td></td> <td></td> <td></td> <td></td> </tr> </tbody> </table>					Code	Type	Active	Maximum	Exemption						<b>Sale History</b> <table border="1"> <thead> <tr> <th>Bk/Pg</th> <th>Grantor</th> <th>Date</th> <th>Price</th> <th>Code</th> </tr> </thead> <tbody> <tr> <td>2541/275</td> <td>SIMMONS HOMES RESIDENTIAL</td> <td>12/31/2014</td> <td>175,000</td> <td>4</td> </tr> <tr> <td>2421/745</td> <td>K &amp; S DEVELOPMENTS INC</td> <td>03/24/2014</td> <td>0</td> <td>4</td> </tr> </tbody> </table>					Bk/Pg	Grantor	Date	Price	Code	2541/275	SIMMONS HOMES RESIDENTIAL	12/31/2014	175,000	4	2421/745	K & S DEVELOPMENTS INC	03/24/2014	0	4																																																																							
Code	Type	Active	Maximum	Exemption																																																																																																					
Bk/Pg	Grantor	Date	Price	Code																																																																																																					
2541/275	SIMMONS HOMES RESIDENTIAL	12/31/2014	175,000	4																																																																																																					
2421/745	K & S DEVELOPMENTS INC	03/24/2014	0	4																																																																																																					
<b>Parcel Valuation</b> <table border="1"> <thead> <tr> <th>Source</th> <th>REAL</th> <th>Fair Cash</th> <th>Capped</th> <th>Asmnt Level</th> <th>Assessed</th> <th>Levy Rate</th> <th>97.960</th> <th>Current Tax</th> </tr> </thead> <tbody> <tr> <td>Remove Cap</td> <td>2017</td> <td>Land Value 48,734</td> <td>48,734</td> <td>11%</td> <td>5,361</td> <td>Assessed</td> <td>34,319</td> <td>3,361.89</td> </tr> <tr> <td>Year Frozen</td> <td></td> <td>Improvements 263,254</td> <td>263,254</td> <td></td> <td>28,958</td> <td>Penalty</td> <td>0</td> <td></td> </tr> <tr> <td>Uncapped Value</td> <td>0</td> <td>Mobile Home 0</td> <td>0</td> <td></td> <td>0</td> <td>Exemption</td> <td>0</td> <td>0.00</td> </tr> <tr> <td>TIF Project ID</td> <td>0</td> <td>Total Value 311,988</td> <td>311,988</td> <td></td> <td>34,319</td> <td>Total Taxable</td> <td>34,319</td> <td>3,362.00</td> </tr> </tbody> </table>										Source	REAL	Fair Cash	Capped	Asmnt Level	Assessed	Levy Rate	97.960	Current Tax	Remove Cap	2017	Land Value 48,734	48,734	11%	5,361	Assessed	34,319	3,361.89	Year Frozen		Improvements 263,254	263,254		28,958	Penalty	0		Uncapped Value	0	Mobile Home 0	0		0	Exemption	0	0.00	TIF Project ID	0	Total Value 311,988	311,988		34,319	Total Taxable	34,319	3,362.00																																																			
Source	REAL	Fair Cash	Capped	Asmnt Level	Assessed	Levy Rate	97.960	Current Tax																																																																																																	
Remove Cap	2017	Land Value 48,734	48,734	11%	5,361	Assessed	34,319	3,361.89																																																																																																	
Year Frozen		Improvements 263,254	263,254		28,958	Penalty	0																																																																																																		
Uncapped Value	0	Mobile Home 0	0		0	Exemption	0	0.00																																																																																																	
TIF Project ID	0	Total Value 311,988	311,988		34,319	Total Taxable	34,319	3,362.00																																																																																																	
<b>Assessment History</b> <table border="1"> <thead> <tr> <th>Tax Year</th> <th>Statement Number</th> <th>Billed Owner</th> <th>Tax Area</th> <th>Total Value</th> <th>Exemptions</th> <th>Taxable Value</th> <th>Billed Tax</th> </tr> </thead> <tbody> <tr><td>2025</td><td>2025-660096843</td><td>CGS REALTY LLC</td><td>40</td><td>301,329</td><td>0</td><td>33,146</td><td>3,247.00</td></tr> <tr><td>2024</td><td>2024-660096843</td><td>CGS REALTY LLC</td><td>40</td><td>321,253</td><td>0</td><td>32,213</td><td>3,095.00</td></tr> <tr><td>2023</td><td>2023-660096843</td><td>CGS REALTY LLC</td><td>40</td><td>286,953</td><td>0</td><td>30,679</td><td>2,875.00</td></tr> <tr><td>2022</td><td>2022-660096843</td><td>CGS REALTY LLC</td><td>40</td><td>279,383</td><td>0</td><td>29,218</td><td>2,862.00</td></tr> <tr><td>2021</td><td>2021-660096843</td><td>CGS REALTY LLC</td><td>40</td><td>252,974</td><td>0</td><td>27,827</td><td>2,692.00</td></tr> <tr><td>2020</td><td>2020-660096843</td><td>CGS REALTY LLC</td><td>40</td><td>251,173</td><td>0</td><td>27,629</td><td>2,673.00</td></tr> <tr><td>2019</td><td>2019-660096843</td><td>CGS REALTY LLC</td><td>40</td><td>239,548</td><td>0</td><td>26,350</td><td>2,551.00</td></tr> <tr><td>2018</td><td>2018-660096843</td><td>CGS REALTY LLC</td><td>40</td><td>243,163</td><td>0</td><td>26,748</td><td>2,494.00</td></tr> <tr><td>2017</td><td>2017-660096843</td><td>CGS REALTY LLC</td><td>40</td><td>241,316</td><td>0</td><td>26,545</td><td>2,498.00</td></tr> <tr><td>2016</td><td>2016-660096843</td><td>CGS REALTY LLC</td><td>40</td><td>125,028</td><td>0</td><td>5,121</td><td>484.00</td></tr> <tr><td>2015</td><td>2015-660096843</td><td>SIMMONS HOMES RESIDENTIAL</td><td>40</td><td>86,163</td><td>0</td><td>4,877</td><td>465.00</td></tr> </tbody> </table>										Tax Year	Statement Number	Billed Owner	Tax Area	Total Value	Exemptions	Taxable Value	Billed Tax	2025	2025-660096843	CGS REALTY LLC	40	301,329	0	33,146	3,247.00	2024	2024-660096843	CGS REALTY LLC	40	321,253	0	32,213	3,095.00	2023	2023-660096843	CGS REALTY LLC	40	286,953	0	30,679	2,875.00	2022	2022-660096843	CGS REALTY LLC	40	279,383	0	29,218	2,862.00	2021	2021-660096843	CGS REALTY LLC	40	252,974	0	27,827	2,692.00	2020	2020-660096843	CGS REALTY LLC	40	251,173	0	27,629	2,673.00	2019	2019-660096843	CGS REALTY LLC	40	239,548	0	26,350	2,551.00	2018	2018-660096843	CGS REALTY LLC	40	243,163	0	26,748	2,494.00	2017	2017-660096843	CGS REALTY LLC	40	241,316	0	26,545	2,498.00	2016	2016-660096843	CGS REALTY LLC	40	125,028	0	5,121	484.00	2015	2015-660096843	SIMMONS HOMES RESIDENTIAL	40	86,163	0	4,877	465.00
Tax Year	Statement Number	Billed Owner	Tax Area	Total Value	Exemptions	Taxable Value	Billed Tax																																																																																																		
2025	2025-660096843	CGS REALTY LLC	40	301,329	0	33,146	3,247.00																																																																																																		
2024	2024-660096843	CGS REALTY LLC	40	321,253	0	32,213	3,095.00																																																																																																		
2023	2023-660096843	CGS REALTY LLC	40	286,953	0	30,679	2,875.00																																																																																																		
2022	2022-660096843	CGS REALTY LLC	40	279,383	0	29,218	2,862.00																																																																																																		
2021	2021-660096843	CGS REALTY LLC	40	252,974	0	27,827	2,692.00																																																																																																		
2020	2020-660096843	CGS REALTY LLC	40	251,173	0	27,629	2,673.00																																																																																																		
2019	2019-660096843	CGS REALTY LLC	40	239,548	0	26,350	2,551.00																																																																																																		
2018	2018-660096843	CGS REALTY LLC	40	243,163	0	26,748	2,494.00																																																																																																		
2017	2017-660096843	CGS REALTY LLC	40	241,316	0	26,545	2,498.00																																																																																																		
2016	2016-660096843	CGS REALTY LLC	40	125,028	0	5,121	484.00																																																																																																		
2015	2015-660096843	SIMMONS HOMES RESIDENTIAL	40	86,163	0	4,877	465.00																																																																																																		



# Rogers

## Assessment Property Record Card for Tax Year 2026

Data provided by LISA DELOZIER County Assessor

Date 04/18/2026  
Time 08:50:50  
Page 2

Lot Data		Square-Foot - NBHD 1059 #1		Primary Image				
Lot Size								
Lot Count	1							
Units Buildable								
Non-Ag Acres								
Topography								
Street Access								
Utilities								
Amenities		0						
		0						
Method	Square-Foot							
Base Lot Value	9,195.00 x 5.30 = 48,734							
Factor Value								
Adjustments	1.0000							
Lot Value	48,734							
<b>Residential Data</b>				\\tsclient\TCASEY\CASEY BOOTH RESIDENTIAL VI\2022-8-22\I 8/23/2022				
Type	1 Single Family Residence			<b>GRM Approach</b>				
Condition	3 - Average			GRM Code				
Quality	3.5 - Average			Gross Rent 0.00				
Architecture				Indicated Value				
Style	100% One Story			<b>Multiple Regression</b>				
Exterior Wall	100% Veneer, Masonry			MRA Code 1 Test				
Base/Total Area	1,862 / 1,862			Adusted R 0.8445				
Style	100% One Story			Indicated Value 282,824 151.89 Per SqFt				
HVAC	100% Warmed & Cooled Air			<b>Direct Comparables</b>				
Roof Cover	1 Composition Shingle			Selection Model A Adam Test				
Area on Slab	1,862			Adjustment Model 1 2022 Residential				
Fixture/RghIn	11 /			Comparables 8				
Bed/F/H Bath	3 / 2.0 /			Indicated Value 311,010 Per SqFt				
Basement Area				<b>Value Reconciliation</b>				
Garage Type	598 Attached Garage - Unfinished			Selected Approach Cost Approach				
Remodel				Improvements 263,254				
Year/Eff Age	2014 / 9			Lot Value 48,734				
<b>Cost Approach</b>		<b>Manual : 01/2025</b>		Indicated Value 311,988 167.56 Per SqFt				
Base Cost	114.28	Total Misc Impr	+ 5,263	Agland Value				
Roofing Adj	+ 5.46	Garage Cost	+ 22,844	Site Improvements				
Subfloor Adj	+ -3.48	Total RCN	= 289,290	Total Value 311,988 167.56 Total Value Per SqFt				
Heat/Cool Adj	+ 14.47	Depreciation ( 9%)	- 26,036					
Plumbing Adj	+ 9.54	Lump Sums	+ 0					
Basement Adj	+ 0.00	RCNLD	= 263,254					
Adj Base Cost	= 140.27	Lot Value	+ 48,734					
Total Area	x 1,862	Indicated Value	= 311,988					
Adjusted Cost	= 261,183	Value Per SqFt	167.56					
<b>Miscellaneous Improvements</b>								
Code	Description	Sketch ID	Size	Year	Units	Unit Cost	Depr	Value
PRCH	SLAB PORCH - COVERED	121259	16x5		80	29.27		2,342
PRCH	SLAB PORCH - COVERED	121260	10x10		100	29.21		2,921



**Rogers**  
**Assessment Property Record Card for Tax Year 2026**

Data provided by LISA DELOZIER County Assessor

Date 04/18/2026  
 Time 08:50:50  
 Page 3

Sketch Image

660096843

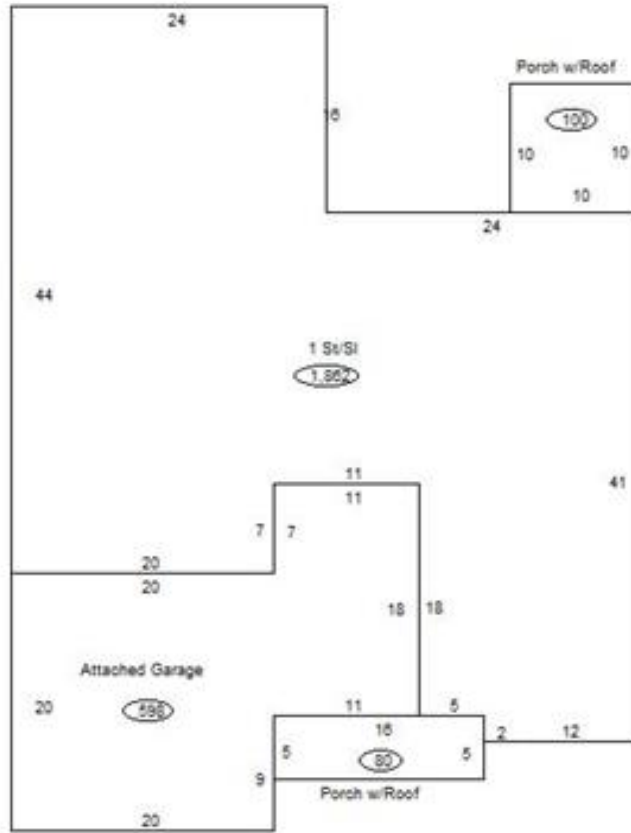

**Sketch Vector Information**

Sequence	Code	Type	Built Over	Scale	Section Label	Base Area	Multiplier	Total Area
1	R	1	Slab	13	1 St/Sl	1,862	1.000	1,862
2	G	1		13	Attached Garage	598	1.000	598
3	M	PRCH		13	SLBC	80	1.000	80
4	M	PRCH		13	SLBC	100	1.000	100
<b>Total Building Area</b>						1,862		1,862