



# Rogers

## Assessment Property Record Card for Tax Year 2026

Data provided by LISA DELOZIER County Assessor

Date 04/18/2026  
Time 08:51:17  
Page 1

Assessment Data					Primary Image																																																																																																				
<b>Account</b> 660096858 <b>Parcel ID</b> 000000-00-0-21650-003-0008 <b>Cadastral ID</b> 22-21-14-09750 <b>Property Type</b> REAL - Real Property <b>Property Class</b> URP VI Area 4 <b>Tax Area</b> 40 - OWASSO CITY <b>Name ID</b> 320299 PATEL, VIMAL & BHAVISHA VASHEE  15512 E 87TH PL N OWASSO OK 74055-0000  <b>Parcel Location</b> <b>Situs</b> 15512 E 87TH PL N <b>Subdivision</b> PARK PLACE AT PRESTON LAKES <b>Lot/Block</b> 0008 / 0003 Parcel Size 1 - Lots <b>Sec/Twn/Rng</b> 22 / 21 / 14 / 5 <b>Neighborhood</b> 1059 - R-V04-SW OWASSO <b>School District</b> S021 - OWASSO SCHOOLS																																																																																																									
<b>Legal Description</b> Lat/Long: 36.27969643 -95.79873701																																																																																																									
<b>Legal Description</b> LOT 8 BLOCK 3 PARK PLACE AT PRESTON LAKES					<b>Building Permits</b> <table border="1"> <thead> <tr> <th>Number</th> <th>Description</th> <th>Opened</th> <th>Closed</th> <th>Amount</th> </tr> </thead> <tbody> <tr> <td>16-0505X</td> <td>R17-NEW 2300 SQ FT SFR</td> <td>06/2016</td> <td>12/2016</td> <td>158,400</td> </tr> </tbody> </table>					Number	Description	Opened	Closed	Amount	16-0505X	R17-NEW 2300 SQ FT SFR	06/2016	12/2016	158,400																																																																																						
Number	Description	Opened	Closed	Amount																																																																																																					
16-0505X	R17-NEW 2300 SQ FT SFR	06/2016	12/2016	158,400																																																																																																					
<b>Exemptions</b> <table border="1"> <thead> <tr> <th>Code</th> <th>Type</th> <th>Active</th> <th>Maximum</th> <th>Exemption</th> </tr> </thead> <tbody> <tr> <td>H</td> <td>Homestead</td> <td>Yes</td> <td>1,000</td> <td>1,000</td> </tr> </tbody> </table>					Code	Type	Active	Maximum	Exemption	H	Homestead	Yes	1,000	1,000	<b>Sale History</b> <table border="1"> <thead> <tr> <th>Bk/Pg</th> <th>Grantor</th> <th>Date</th> <th>Price</th> <th>Code</th> </tr> </thead> <tbody> <tr> <td>2601/294</td> <td>SIMMONS HOMES RESIDENTIAL</td> <td>12/21/2016</td> <td>276,000</td> <td>YES</td> </tr> <tr> <td>2421/745</td> <td>K &amp; S DEVELOPMENTS INC</td> <td>03/24/2014</td> <td>0</td> <td>4</td> </tr> </tbody> </table>					Bk/Pg	Grantor	Date	Price	Code	2601/294	SIMMONS HOMES RESIDENTIAL	12/21/2016	276,000	YES	2421/745	K & S DEVELOPMENTS INC	03/24/2014	0	4																																																																							
Code	Type	Active	Maximum	Exemption																																																																																																					
H	Homestead	Yes	1,000	1,000																																																																																																					
Bk/Pg	Grantor	Date	Price	Code																																																																																																					
2601/294	SIMMONS HOMES RESIDENTIAL	12/21/2016	276,000	YES																																																																																																					
2421/745	K & S DEVELOPMENTS INC	03/24/2014	0	4																																																																																																					
<b>Parcel Valuation</b> <table border="1"> <thead> <tr> <th>Source</th> <th>REAL</th> <th>Fair Cash</th> <th>Capped</th> <th>Asmnt Level</th> <th>Assessed</th> <th>Levy Rate</th> <th>97.960</th> <th>Current Tax</th> </tr> </thead> <tbody> <tr> <td>Remove Cap</td> <td>2017</td> <td>Land Value</td> <td>47,700</td> <td>47,700</td> <td>11%</td> <td>5,247</td> <td>Assessed</td> <td>38,465 3,768.03</td> </tr> <tr> <td>Year Frozen</td> <td></td> <td>Improvements</td> <td>301,984</td> <td>301,984</td> <td></td> <td>33,218</td> <td>Penalty</td> <td>0</td> </tr> <tr> <td>Uncapped Value</td> <td>0</td> <td>Mobile Home</td> <td>0</td> <td>0</td> <td></td> <td>0</td> <td>Exemption</td> <td>1,000 -98.00</td> </tr> <tr> <td>TIF Project ID</td> <td>0</td> <td>Total Value</td> <td>349,684</td> <td>349,684</td> <td></td> <td>38,465</td> <td>Total Taxable</td> <td>37,465 3,670.00</td> </tr> </tbody> </table>										Source	REAL	Fair Cash	Capped	Asmnt Level	Assessed	Levy Rate	97.960	Current Tax	Remove Cap	2017	Land Value	47,700	47,700	11%	5,247	Assessed	38,465 3,768.03	Year Frozen		Improvements	301,984	301,984		33,218	Penalty	0	Uncapped Value	0	Mobile Home	0	0		0	Exemption	1,000 -98.00	TIF Project ID	0	Total Value	349,684	349,684		38,465	Total Taxable	37,465 3,670.00																																																			
Source	REAL	Fair Cash	Capped	Asmnt Level	Assessed	Levy Rate	97.960	Current Tax																																																																																																	
Remove Cap	2017	Land Value	47,700	47,700	11%	5,247	Assessed	38,465 3,768.03																																																																																																	
Year Frozen		Improvements	301,984	301,984		33,218	Penalty	0																																																																																																	
Uncapped Value	0	Mobile Home	0	0		0	Exemption	1,000 -98.00																																																																																																	
TIF Project ID	0	Total Value	349,684	349,684		38,465	Total Taxable	37,465 3,670.00																																																																																																	
<b>Assessment History</b> <table border="1"> <thead> <tr> <th>Tax Year</th> <th>Statement Number</th> <th>Billed Owner</th> <th>Tax Area</th> <th>Total Value</th> <th>Exemptions</th> <th>Taxable Value</th> <th>Billed Tax</th> </tr> </thead> <tbody> <tr><td>2025</td><td>2025-660096858</td><td>PATEL, VIMAL &amp; BHAVISHA VASHEE</td><td>40</td><td>340,538</td><td>0</td><td>37,459</td><td>3,669.00</td></tr> <tr><td>2024</td><td>2024-660096858</td><td>PATEL, VIMAL &amp; BHAVISHA VASHEE</td><td>40</td><td>363,150</td><td>0</td><td>36,700</td><td>3,526.00</td></tr> <tr><td>2023</td><td>2023-660096858</td><td>PATEL, VIMAL &amp; BHAVISHA VASHEE</td><td>40</td><td>322,790</td><td>0</td><td>34,953</td><td>3,275.00</td></tr> <tr><td>2022</td><td>2022-660096858</td><td>PATEL, VIMAL &amp; BHAVISHA VASHEE</td><td>40</td><td>317,778</td><td>0</td><td>33,288</td><td>3,261.00</td></tr> <tr><td>2021</td><td>2021-660096858</td><td>PATEL, VIMAL &amp; BHAVISHA VASHEE</td><td>40</td><td>288,207</td><td>0</td><td>31,703</td><td>3,067.00</td></tr> <tr><td>2020</td><td>2020-660096858</td><td>PATEL, VIMAL &amp; BHAVISHA VASHEE</td><td>40</td><td>283,789</td><td>0</td><td>31,217</td><td>3,020.00</td></tr> <tr><td>2019</td><td>2019-660096858</td><td>PATEL, VIMAL &amp; BHAVISHA VASHEE</td><td>40</td><td>270,580</td><td>0</td><td>29,764</td><td>2,882.00</td></tr> <tr><td>2018</td><td>2018-660096858</td><td>PATEL, VIMAL &amp; BHAVISHA VASHEE</td><td>40</td><td>277,015</td><td>0</td><td>30,472</td><td>2,842.00</td></tr> <tr><td>2017</td><td>2017-660096858</td><td>PATEL, VIMAL &amp; BHAVISHA VASHEE</td><td>40</td><td>274,894</td><td>0</td><td>30,238</td><td>2,845.00</td></tr> <tr><td>2016</td><td>2016-660096858</td><td>SIMMONS HOMES RESIDENTIAL</td><td>40</td><td>50,000</td><td>0</td><td>944</td><td>89.00</td></tr> <tr><td>2015</td><td>2015-660096858</td><td>SIMMONS HOMES RESIDENTIAL</td><td>40</td><td>50,000</td><td>0</td><td>900</td><td>86.00</td></tr> </tbody> </table>										Tax Year	Statement Number	Billed Owner	Tax Area	Total Value	Exemptions	Taxable Value	Billed Tax	2025	2025-660096858	PATEL, VIMAL & BHAVISHA VASHEE	40	340,538	0	37,459	3,669.00	2024	2024-660096858	PATEL, VIMAL & BHAVISHA VASHEE	40	363,150	0	36,700	3,526.00	2023	2023-660096858	PATEL, VIMAL & BHAVISHA VASHEE	40	322,790	0	34,953	3,275.00	2022	2022-660096858	PATEL, VIMAL & BHAVISHA VASHEE	40	317,778	0	33,288	3,261.00	2021	2021-660096858	PATEL, VIMAL & BHAVISHA VASHEE	40	288,207	0	31,703	3,067.00	2020	2020-660096858	PATEL, VIMAL & BHAVISHA VASHEE	40	283,789	0	31,217	3,020.00	2019	2019-660096858	PATEL, VIMAL & BHAVISHA VASHEE	40	270,580	0	29,764	2,882.00	2018	2018-660096858	PATEL, VIMAL & BHAVISHA VASHEE	40	277,015	0	30,472	2,842.00	2017	2017-660096858	PATEL, VIMAL & BHAVISHA VASHEE	40	274,894	0	30,238	2,845.00	2016	2016-660096858	SIMMONS HOMES RESIDENTIAL	40	50,000	0	944	89.00	2015	2015-660096858	SIMMONS HOMES RESIDENTIAL	40	50,000	0	900	86.00
Tax Year	Statement Number	Billed Owner	Tax Area	Total Value	Exemptions	Taxable Value	Billed Tax																																																																																																		
2025	2025-660096858	PATEL, VIMAL & BHAVISHA VASHEE	40	340,538	0	37,459	3,669.00																																																																																																		
2024	2024-660096858	PATEL, VIMAL & BHAVISHA VASHEE	40	363,150	0	36,700	3,526.00																																																																																																		
2023	2023-660096858	PATEL, VIMAL & BHAVISHA VASHEE	40	322,790	0	34,953	3,275.00																																																																																																		
2022	2022-660096858	PATEL, VIMAL & BHAVISHA VASHEE	40	317,778	0	33,288	3,261.00																																																																																																		
2021	2021-660096858	PATEL, VIMAL & BHAVISHA VASHEE	40	288,207	0	31,703	3,067.00																																																																																																		
2020	2020-660096858	PATEL, VIMAL & BHAVISHA VASHEE	40	283,789	0	31,217	3,020.00																																																																																																		
2019	2019-660096858	PATEL, VIMAL & BHAVISHA VASHEE	40	270,580	0	29,764	2,882.00																																																																																																		
2018	2018-660096858	PATEL, VIMAL & BHAVISHA VASHEE	40	277,015	0	30,472	2,842.00																																																																																																		
2017	2017-660096858	PATEL, VIMAL & BHAVISHA VASHEE	40	274,894	0	30,238	2,845.00																																																																																																		
2016	2016-660096858	SIMMONS HOMES RESIDENTIAL	40	50,000	0	944	89.00																																																																																																		
2015	2015-660096858	SIMMONS HOMES RESIDENTIAL	40	50,000	0	900	86.00																																																																																																		



# Rogers

## Assessment Property Record Card for Tax Year 2026

Data provided by LISA DELOZIER County Assessor

Date 04/18/2026  
 Time 08:51:17  
 Page 2

Lot Data		Square-Foot - NBHD 1059 #1
Lot Size		
Lot Count	1	
Units Buildable		
Non-Ag Acres		
Topography		
Street Access		
Utilities		
Amenities		0
		0
Method	Square-Foot	
Base Lot Value	9,000.00 x 5.30 =	47,700
Factor Value		
Adjustments	1.0000	
Lot Value		47,700



\\tsclient\TCASEY\CASEY BOOTH RESIDENTIAL VI\2022-8-22\ 8/23/2022

Residential Data	
Type	1 Single Family Residence
Condition	3 - Average
Quality	3.5 - Average
Architecture	
Style	100% One Story
Exterior Wall	95% Veneer, Masonry 5% Veneer, Stone
Base/Total Area	2,204 / 2,204
Style	100% One Story
HVAC	100% Warmed & Cooled Air
Roof Cover	1 Composition Shingle
Area on Slab	2,204
Fixture/RghIn	11 /
Bed/F/H Bath	4 / 2.0 /
Basement Area	
Garage Type	650 Attached Garage - Unfinished
Remodel	
Year/Eff Age	2016 / 8

### GRM Approach

GRM Code	
Gross Rent	0.00
Indicated Value	

### Multiple Regression

MRA Code	1 Test
Adusted R	0.8445
Indicated Value	320,731 145.52 Per SqFt

### Direct Comparables

Selection Model	A Adam Test
Adjustment Model	1 2022 Residential
Comparables	8
Indicated Value	361,550 Per SqFt

### Value Reconciliation

Selected Approach	Cost Approach
Improvements	301,984
Lot Value	47,700
Indicated Value	349,684 158.66 Per SqFt
Agland Value	
Site Improvements	
Total Value	349,684 158.66 Total Value Per SqFt

Cost Approach		Manual : 01/2025	
Base Cost	110.67	Total Misc Impr	+ 6,028
Roofing Adj	+ 5.26	Garage Cost	+ 24,544
Subfloor Adj	+ -3.40	Total RCN	= 328,244
Heat/Cool Adj	+ 14.47	Depreciation ( 8%)	- 26,260
Plumbing Adj	+ 8.06	Lump Sums	+ 0
Basement Adj	+ 0.00	RCNLD	= 301,984
Adj Base Cost	= 135.06	Lot Value	+ 47,700
Total Area	x 2,204	Indicated Value	= 349,684
Adjusted Cost	= 297,672	Value Per SqFt	158.66

### Miscellaneous Improvements

Code	Description	Sketch ID	Size	Year	Units	Unit Cost	Depr	Value
PRCH	SLAB PORCH - COVERED	130347	18x8		144	29.03		4,180
PRCH	SLAB PORCH - COVERED	130348	9x7		63	29.33		1,848



**Rogers**  
**Assessment Property Record Card for Tax Year 2026**

Data provided by LISA DELOZIER County Assessor

Date 04/18/2026  
 Time 08:51:17  
 Page 3

Sketch Image

660096858

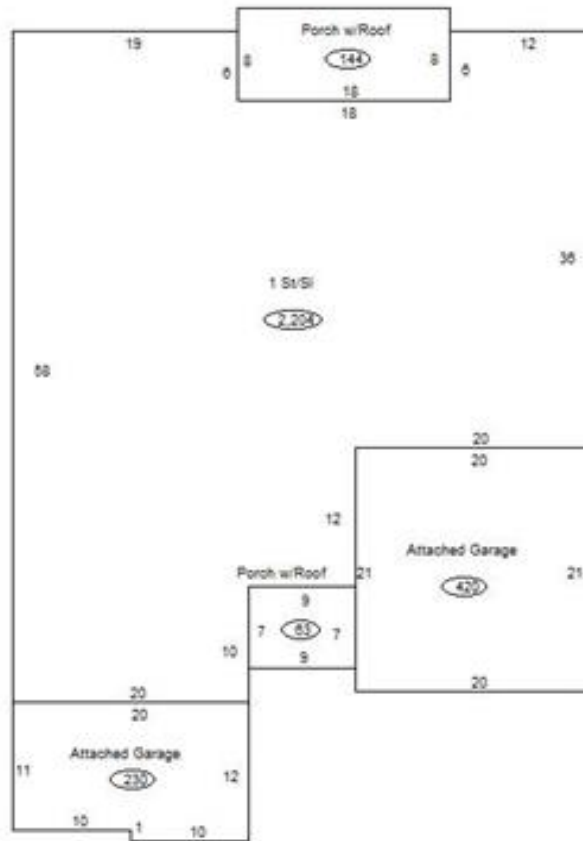

**Sketch Vector Information**

Sequence	Code	Type	Built Over	Scale	Section Label	Base Area	Multiplier	Total Area
1	R	1	Slab	13	1 St/Sl	2,204	1.000	2,204
2	G	1		13	Attached Garage	420	1.000	420
3	G	1		13	Attached Garage	230	1.000	230
4	M	PRCH		13	SLBC	144	1.000	144
5	M	PRCH		13	SLBC	63	1.000	63
<b>Total Building Area</b>						2,204		2,204