



Rogers

Assessment Property Record Card for Tax Year 2026

Data provided by LISA DELOZIER County Assessor

Date 04/18/2026
Time 08:51:21
Page 1

Assessment Data					Primary Image																																																																																																				
Account 660096860 Parcel ID 000000-00-0-21650-003-0010 Cadastral ID 22-21-14-09770 Property Type REAL - Real Property Property Class URP VI Area 4 Tax Area 40 - OWASSO CITY Name ID 341130 TAYLOR, MASON 15516 E 87TH PL N OWASSO OK 74055-0000 Parcel Location Situs 15516 E 87TH PL N Subdivision PARK PLACE AT PRESTON LAKES Lot/Block 0010 / 0003 Parcel Size 1 - Lots Sec/Twn/Rng 22 / 21 / 14 / 5 Neighborhood 1059 - R-V04-SW OWASSO School District S021 - OWASSO SCHOOLS																																																																																																									
Legal Description Lat/Long: 36.27966890 -95.79813359																																																																																																									
Building Permits					<table border="1"> <thead> <tr> <th>Number</th> <th>Description</th> <th>Opened</th> <th>Closed</th> <th>Amount</th> </tr> </thead> <tbody> <tr> <td>15-0425-X</td> <td>R16-NEW 2584 SQ FT SFR</td> <td>05/2015</td> <td>10/2015</td> <td>142,120</td> </tr> </tbody> </table>					Number	Description	Opened	Closed	Amount	15-0425-X	R16-NEW 2584 SQ FT SFR	05/2015	10/2015	142,120																																																																																						
Number	Description	Opened	Closed	Amount																																																																																																					
15-0425-X	R16-NEW 2584 SQ FT SFR	05/2015	10/2015	142,120																																																																																																					
Exemptions					Sale History																																																																																																				
<table border="1"> <thead> <tr> <th>Code</th> <th>Type</th> <th>Active</th> <th>Maximum</th> <th>Exemption</th> </tr> </thead> <tbody> <tr> <td>H</td> <td>Homestead</td> <td>No</td> <td>1,000</td> <td></td> </tr> </tbody> </table>					Code	Type	Active	Maximum	Exemption	H	Homestead	No	1,000		<table border="1"> <thead> <tr> <th>Bk/Pg</th> <th>Grantor</th> <th>Date</th> <th>Price</th> <th>Code</th> </tr> </thead> <tbody> <tr> <td>/</td> <td>STEVENS, TODD</td> <td>03/21/2023</td> <td>352,500</td> <td>YES</td> </tr> <tr> <td>2508/307</td> <td>SIMMONS HOMES RESIDENTIAL</td> <td>10/16/2015</td> <td>241,000</td> <td>YES</td> </tr> <tr> <td>2421/745</td> <td>K & S DEVELOPMENTS INC</td> <td>03/24/2014</td> <td>0</td> <td>4</td> </tr> </tbody> </table>					Bk/Pg	Grantor	Date	Price	Code	/	STEVENS, TODD	03/21/2023	352,500	YES	2508/307	SIMMONS HOMES RESIDENTIAL	10/16/2015	241,000	YES	2421/745	K & S DEVELOPMENTS INC	03/24/2014	0	4																																																																		
Code	Type	Active	Maximum	Exemption																																																																																																					
H	Homestead	No	1,000																																																																																																						
Bk/Pg	Grantor	Date	Price	Code																																																																																																					
/	STEVENS, TODD	03/21/2023	352,500	YES																																																																																																					
2508/307	SIMMONS HOMES RESIDENTIAL	10/16/2015	241,000	YES																																																																																																					
2421/745	K & S DEVELOPMENTS INC	03/24/2014	0	4																																																																																																					
Parcel Valuation																																																																																																									
<table border="1"> <thead> <tr> <th>Source</th> <th>REAL</th> </tr> </thead> <tbody> <tr> <td>Remove Cap</td> <td>2024</td> </tr> </tbody> </table>		Source	REAL	Remove Cap	2024	<table border="1"> <thead> <tr> <th>Fair Cash</th> <th>Capped</th> <th>Asmnt Level</th> <th>Assessed</th> </tr> </thead> <tbody> <tr> <td>Land Value</td> <td>58,074</td> <td>58,074</td> <td>6,388</td> </tr> <tr> <td>Improvements</td> <td>288,120</td> <td>288,120</td> <td>31,693</td> </tr> <tr> <td>Mobile Home</td> <td>0</td> <td>0</td> <td>0</td> </tr> <tr> <td>Total Value</td> <td>346,194</td> <td>346,194</td> <td>38,081</td> </tr> </tbody> </table>			Fair Cash	Capped	Asmnt Level	Assessed	Land Value	58,074	58,074	6,388	Improvements	288,120	288,120	31,693	Mobile Home	0	0	0	Total Value	346,194	346,194	38,081	<table border="1"> <thead> <tr> <th>Levy Rate</th> <th>Current Tax</th> </tr> </thead> <tbody> <tr> <td>97.960</td> <td>3,730.41</td> </tr> <tr> <td>Assessed</td> <td>38,081</td> </tr> <tr> <td>Penalty</td> <td>0</td> </tr> <tr> <td>Exemption</td> <td>0</td> </tr> <tr> <td>Total Taxable</td> <td>38,081</td> </tr> </tbody> </table>		Levy Rate	Current Tax	97.960	3,730.41	Assessed	38,081	Penalty	0	Exemption	0	Total Taxable	38,081																																																															
Source	REAL																																																																																																								
Remove Cap	2024																																																																																																								
Fair Cash	Capped	Asmnt Level	Assessed																																																																																																						
Land Value	58,074	58,074	6,388																																																																																																						
Improvements	288,120	288,120	31,693																																																																																																						
Mobile Home	0	0	0																																																																																																						
Total Value	346,194	346,194	38,081																																																																																																						
Levy Rate	Current Tax																																																																																																								
97.960	3,730.41																																																																																																								
Assessed	38,081																																																																																																								
Penalty	0																																																																																																								
Exemption	0																																																																																																								
Total Taxable	38,081																																																																																																								
Assessment History																																																																																																									
<table border="1"> <thead> <tr> <th>Tax Year</th> <th>Statement Number</th> <th>Billed Owner</th> <th>Tax Area</th> <th>Total Value</th> <th>Exemptions</th> <th>Taxable Value</th> <th>Billed Tax</th> </tr> </thead> <tbody> <tr><td>2025</td><td>2025-660096860</td><td>TAYLOR, MASON</td><td>40</td><td>334,589</td><td>0</td><td>36,805</td><td>3,605.00</td></tr> <tr><td>2024</td><td>2024-660096860</td><td>TAYLOR, MASON</td><td>40</td><td>352,981</td><td>0</td><td>38,828</td><td>3,730.00</td></tr> <tr><td>2023</td><td>2023-660096860</td><td>TAYLOR, MASON</td><td>40</td><td>295,021</td><td>1000</td><td>29,234</td><td>2,740.00</td></tr> <tr><td>2022</td><td>2022-660096860</td><td>STEVENS, TODD</td><td>40</td><td>287,656</td><td>1000</td><td>28,353</td><td>2,778.00</td></tr> <tr><td>2021</td><td>2021-660096860</td><td>STEVENS, TODD</td><td>40</td><td>260,092</td><td>1000</td><td>27,498</td><td>2,660.00</td></tr> <tr><td>2020</td><td>2020-660096860</td><td>STEVENS, TODD</td><td>40</td><td>256,084</td><td>1000</td><td>26,669</td><td>2,580.00</td></tr> <tr><td>2019</td><td>2019-660096860</td><td>STEVENS, TODD</td><td>40</td><td>244,206</td><td>1000</td><td>25,863</td><td>2,504.00</td></tr> <tr><td>2018</td><td>2018-660096860</td><td>STEVENS, TODD</td><td>40</td><td>250,327</td><td>1000</td><td>26,536</td><td>2,474.00</td></tr> <tr><td>2017</td><td>2017-660096860</td><td>STEVENS, TODD</td><td>40</td><td>248,413</td><td>1000</td><td>26,325</td><td>2,477.00</td></tr> <tr><td>2016</td><td>2016-660096860</td><td>STEVENS, TODD</td><td>40</td><td>242,528</td><td>1000</td><td>25,678</td><td>2,427.00</td></tr> <tr><td>2015</td><td>2015-660096860</td><td>SIMMONS HOMES RESIDENTIAL</td><td>40</td><td>50,000</td><td>0</td><td>900</td><td>86.00</td></tr> </tbody> </table>										Tax Year	Statement Number	Billed Owner	Tax Area	Total Value	Exemptions	Taxable Value	Billed Tax	2025	2025-660096860	TAYLOR, MASON	40	334,589	0	36,805	3,605.00	2024	2024-660096860	TAYLOR, MASON	40	352,981	0	38,828	3,730.00	2023	2023-660096860	TAYLOR, MASON	40	295,021	1000	29,234	2,740.00	2022	2022-660096860	STEVENS, TODD	40	287,656	1000	28,353	2,778.00	2021	2021-660096860	STEVENS, TODD	40	260,092	1000	27,498	2,660.00	2020	2020-660096860	STEVENS, TODD	40	256,084	1000	26,669	2,580.00	2019	2019-660096860	STEVENS, TODD	40	244,206	1000	25,863	2,504.00	2018	2018-660096860	STEVENS, TODD	40	250,327	1000	26,536	2,474.00	2017	2017-660096860	STEVENS, TODD	40	248,413	1000	26,325	2,477.00	2016	2016-660096860	STEVENS, TODD	40	242,528	1000	25,678	2,427.00	2015	2015-660096860	SIMMONS HOMES RESIDENTIAL	40	50,000	0	900	86.00
Tax Year	Statement Number	Billed Owner	Tax Area	Total Value	Exemptions	Taxable Value	Billed Tax																																																																																																		
2025	2025-660096860	TAYLOR, MASON	40	334,589	0	36,805	3,605.00																																																																																																		
2024	2024-660096860	TAYLOR, MASON	40	352,981	0	38,828	3,730.00																																																																																																		
2023	2023-660096860	TAYLOR, MASON	40	295,021	1000	29,234	2,740.00																																																																																																		
2022	2022-660096860	STEVENS, TODD	40	287,656	1000	28,353	2,778.00																																																																																																		
2021	2021-660096860	STEVENS, TODD	40	260,092	1000	27,498	2,660.00																																																																																																		
2020	2020-660096860	STEVENS, TODD	40	256,084	1000	26,669	2,580.00																																																																																																		
2019	2019-660096860	STEVENS, TODD	40	244,206	1000	25,863	2,504.00																																																																																																		
2018	2018-660096860	STEVENS, TODD	40	250,327	1000	26,536	2,474.00																																																																																																		
2017	2017-660096860	STEVENS, TODD	40	248,413	1000	26,325	2,477.00																																																																																																		
2016	2016-660096860	STEVENS, TODD	40	242,528	1000	25,678	2,427.00																																																																																																		
2015	2015-660096860	SIMMONS HOMES RESIDENTIAL	40	50,000	0	900	86.00																																																																																																		



Rogers

Assessment Property Record Card for Tax Year 2026

Data provided by LISA DELOZIER County Assessor

Date 04/18/2026
Time 08:51:21
Page 2

Lot Data	Square-Foot - NBHD 1059 #1	Primary Image
Lot Size		
Lot Count	1	
Units Buildable		
Non-Ag Acres		
Topography		
Street Access		
Utilities		
Amenities	0	
	0	
Method	Square-Foot	
Base Lot Value	10,230.00 x 5.30 = 54,219	
Factor Value		
Adjustments	1.0711	
Lot Value	58,074	

Residential Data	
Type	1 Single Family Residence
Condition	3 - Average
Quality	3.5 - Average
Architecture	
Style	100% One Story
Exterior Wall	100% Veneer, Masonry
Base/Total Area	1,951 / 1,951
Style	100% One Story
HVAC	100% Warmed & Cooled Air
Roof Cover	1 Composition Shingle
Area on Slab	1,951
Fixture/RghIn	11 /
Bed/F/H Bath	4 / 2.0 /
Basement Area	
Garage Type	618 Attached Garage - Unfinished
Remodel	
Year/Eff Age	2015 / 8

\\tsclient\TCASEY\CASEY BOOTH RESIDENTIAL VI\2022-8-22\ 8/23/2022	
---	--

GRM Approach	
GRM Code	
Gross Rent	0.00
Indicated Value	

Multiple Regression			
MRA Code	1	Test	
Adjusted R	0.8445		
Indicated Value	294,155	150.77	Per SqFt

Direct Comparables	
Selection Model	A Adam Test
Adjustment Model	1 2022 Residential
Comparables	8
Indicated Value	331,440 Per SqFt

Value Reconciliation			
Selected Approach	Cost Approach		
Improvements	288,120		
Lot Value	58,074		
Indicated Value	346,194	177.44	Per SqFt
Agland Value			
Site Improvements			
Total Value	346,194	177.44	Total Value Per SqFt

Cost Approach				Manual : 01/2025			
Base Cost	113.27	Total Misc Impr	+	18,866			
Roofing Adj	+ 5.40	Garage Cost	+	23,490			
Subfloor Adj	+ -3.43	Total RCN	=	313,174			
Heat/Cool Adj	+ 14.47	Depreciation (8%)	-	25,054			
Plumbing Adj	+ 9.10	Lump Sums	+	0			
Basement Adj	+ 0.00	RCNLD	=	288,120			
Adj Base Cost	= 138.81	Lot Value	+	58,074			
Total Area	x 1,951	Indicated Value	=	346,194			
Adjusted Cost	= 270,818	Value Per SqFt		177.44			

Miscellaneous Improvements								
Code	Description	Sketch ID	Size	Year	Units	Unit Cost	Depr	Value
FPR1	FIREPLACE - RESIDENTIAL 1 STORY	0		1	1	6,429.63		6,430
PRCH	SLAB PORCH - COVERED	124677		134	134	29.07		3,895
PRCH	SLAB PORCH - COVERED	124678	25x12		300	28.47		8,541



Rogers
Assessment Property Record Card for Tax Year 2026
 Data provided by LISA DELOZIER County Assessor

Date 04/18/2026
 Time 08:51:21
 Page 3

Sketch Image

660096860

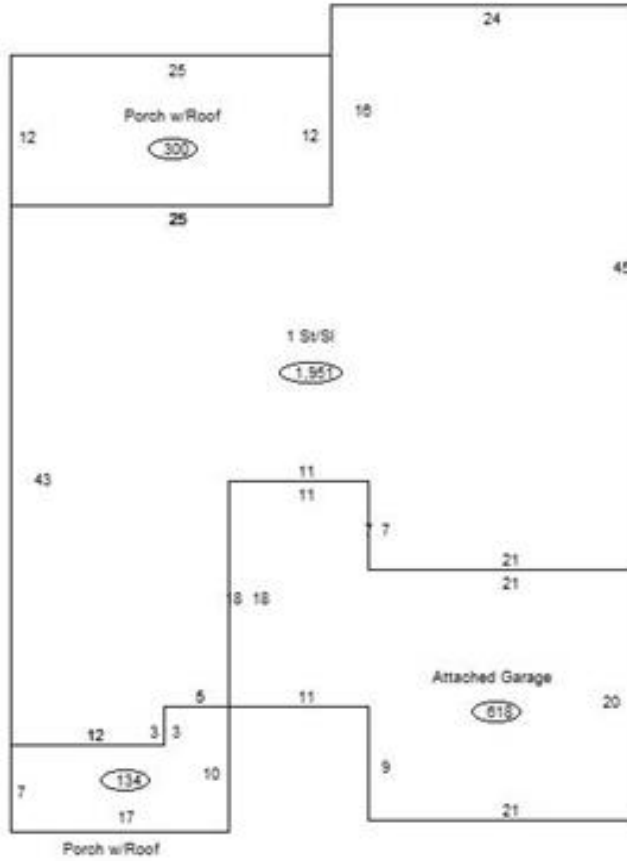

Sketch Vector Information

Sequence	Code	Type	Built Over	Scale	Section Label	Base Area	Multiplier	Total Area
1	R	1	Slab	13	1 St/Sl	1,951	1.000	1,951
2	G	1		13	Attached Garage	618	1.000	618
3	M	PRCH		13	SLBC	134	1.000	134
4	M	PRCH		13	SLBC	300	1.000	300
Total Building Area						1,951		1,951