



Rogers

Assessment Property Record Card for Tax Year 2026

Data provided by LISA DELOZIER County Assessor

Date 04/18/2026
Time 08:51:45
Page 1

Assessment Data					Primary Image																																																																																																				
Account 660096873 Parcel ID 000000-00-0-21650-003-0023 Cadastral ID 22-21-14-09900 Property Type REAL - Real Property Property Class URP VI Area 4 Tax Area 40 - OWASSO CITY Name ID 348527 BINDAS, GEORGE MICHAEL & SHERRI MARIE REVOCABLE LIVING TRUST 15511 E 87TH ST N OWASSO OK 74055-0000																																																																																																									
Parcel Location Situs 15511 E 87TH ST N Subdivision PARK PLACE AT PRESTON LAKES Lot/Block 0023 / 0003 Parcel Size 1 - Lots Sec/Twn/Rng 22 / 21 / 14 / 4 Neighborhood 1059 - R-V04-SW OWASSO School District S021 - OWASSO SCHOOLS																																																																																																									
Legal Description Lat/Long: 36.27930460 -95.79868431					Building Permits																																																																																																				
LOT 23 BLOCK 3 PARK PLACE AT PRESTON LAKES					<table border="1"> <thead> <tr> <th>Number</th> <th>Description</th> <th>Opened</th> <th>Closed</th> <th>Amount</th> </tr> </thead> <tbody> <tr> <td>16-0816-X</td> <td>R18-NEW 2020 SQ FT SFR</td> <td>09/2016</td> <td>07/2017</td> <td>143,000</td> </tr> </tbody> </table>					Number	Description	Opened	Closed	Amount	16-0816-X	R18-NEW 2020 SQ FT SFR	09/2016	07/2017	143,000																																																																																						
Number	Description	Opened	Closed	Amount																																																																																																					
16-0816-X	R18-NEW 2020 SQ FT SFR	09/2016	07/2017	143,000																																																																																																					
Exemptions					Sale History																																																																																																				
<table border="1"> <thead> <tr> <th>Code</th> <th>Type</th> <th>Active</th> <th>Maximum</th> <th>Exemption</th> </tr> </thead> <tbody> <tr> <td>H</td> <td>Homestead</td> <td>Yes</td> <td>1,000</td> <td>1,000</td> </tr> <tr> <td>HV</td> <td>Veteran</td> <td>No</td> <td>999,999</td> <td></td> </tr> </tbody> </table>					Code	Type	Active	Maximum	Exemption	H	Homestead	Yes	1,000	1,000	HV	Veteran	No	999,999		<table border="1"> <thead> <tr> <th>Bk/Pg</th> <th>Grantor</th> <th>Date</th> <th>Price</th> <th>Code</th> </tr> </thead> <tbody> <tr> <td>/</td> <td>TOWNSEND, KYLE JOSEPH</td> <td>10/13/2025</td> <td>330,000</td> <td>YES</td> </tr> <tr> <td>/</td> <td>LUGINBILL, GINA LINDSEY</td> <td>09/24/2020</td> <td>275,000</td> <td>YES</td> </tr> <tr> <td>2636/78</td> <td>SIMMONS HOMES RESIDENTIAL</td> <td>05/26/2017</td> <td>253,500</td> <td>YES</td> </tr> <tr> <td>2421/745</td> <td>K & S DEVELOPMENTS INC</td> <td>03/24/2014</td> <td>0</td> <td>4</td> </tr> </tbody> </table>					Bk/Pg	Grantor	Date	Price	Code	/	TOWNSEND, KYLE JOSEPH	10/13/2025	330,000	YES	/	LUGINBILL, GINA LINDSEY	09/24/2020	275,000	YES	2636/78	SIMMONS HOMES RESIDENTIAL	05/26/2017	253,500	YES	2421/745	K & S DEVELOPMENTS INC	03/24/2014	0	4																																																								
Code	Type	Active	Maximum	Exemption																																																																																																					
H	Homestead	Yes	1,000	1,000																																																																																																					
HV	Veteran	No	999,999																																																																																																						
Bk/Pg	Grantor	Date	Price	Code																																																																																																					
/	TOWNSEND, KYLE JOSEPH	10/13/2025	330,000	YES																																																																																																					
/	LUGINBILL, GINA LINDSEY	09/24/2020	275,000	YES																																																																																																					
2636/78	SIMMONS HOMES RESIDENTIAL	05/26/2017	253,500	YES																																																																																																					
2421/745	K & S DEVELOPMENTS INC	03/24/2014	0	4																																																																																																					
Parcel Valuation																																																																																																									
Source REAL		Fair Cash		Capped		Asmnt Level		Assessed		Levy Rate 97.960		Current Tax																																																																																													
Remove Cap 2026		Land Value 52,398		52,398		11%		5,764		Assessed 36,300		3,555.95																																																																																													
Year Frozen		Improvements 277,603		277,603		30,536		Penalty 0		Exemption 1,000		-98.00																																																																																													
Uncapped Value 0		Mobile Home 0		0		0		Total Taxable 35,300		3,458.00																																																																																															
TIF Project ID 0		Total Value 330,001		330,001		36,300																																																																																																			
Assessment History																																																																																																									
<table border="1"> <thead> <tr> <th>Tax Year</th> <th>Statement Number</th> <th>Billed Owner</th> <th>Tax Area</th> <th>Total Value</th> <th>Exemptions</th> <th>Taxable Value</th> <th>Billed Tax</th> </tr> </thead> <tbody> <tr> <td>2025</td> <td>2025-660096873</td> <td>TOWNSEND, KYLE JOSEPH</td> <td>40</td> <td>328,596</td> <td>34868</td> <td></td> <td>.00</td> </tr> <tr> <td>2024</td> <td>2024-660096873</td> <td>TOWNSEND, KYLE JOSEPH</td> <td>40</td> <td>350,233</td> <td>33853</td> <td></td> <td>.00</td> </tr> <tr> <td>2023</td> <td>2023-660096873</td> <td>TOWNSEND, KYLE JOSEPH</td> <td>40</td> <td>312,164</td> <td>32867</td> <td></td> <td>.00</td> </tr> <tr> <td>2022</td> <td>2022-660096873</td> <td>TOWNSEND, KYLE JOSEPH</td> <td>40</td> <td>304,708</td> <td>0</td> <td>31,910</td> <td>3,126.00</td> </tr> <tr> <td>2021</td> <td>2021-660096873</td> <td>TOWNSEND, KYLE JOSEPH</td> <td>40</td> <td>276,275</td> <td>0</td> <td>30,390</td> <td>2,940.00</td> </tr> <tr> <td>2020</td> <td>2020-660096873</td> <td>TOWNSEND, KYLE JOSEPH</td> <td>40</td> <td>260,359</td> <td>0</td> <td>28,639</td> <td>2,770.00</td> </tr> <tr> <td>2019</td> <td>2019-660096873</td> <td>LUGINBILL, GINA LINDSEY</td> <td>40</td> <td>250,262</td> <td>0</td> <td>27,529</td> <td>2,666.00</td> </tr> <tr> <td>2018</td> <td>2018-660096873</td> <td>LUGINBILL, GINA LINDSEY</td> <td>40</td> <td>254,350</td> <td>0</td> <td>27,979</td> <td>2,609.00</td> </tr> <tr> <td>2017</td> <td>2017-660096873</td> <td>LUGINBILL, GINA LINDSEY</td> <td>40</td> <td>50,000</td> <td>0</td> <td>992</td> <td>93.00</td> </tr> <tr> <td>2016</td> <td>2016-660096873</td> <td>SIMMONS HOMES RESIDENTIAL</td> <td>40</td> <td>50,000</td> <td>0</td> <td>944</td> <td>89.00</td> </tr> <tr> <td>2015</td> <td>2015-660096873</td> <td>SIMMONS HOMES RESIDENTIAL</td> <td>40</td> <td>50,000</td> <td>0</td> <td>900</td> <td>86.00</td> </tr> </tbody> </table>										Tax Year	Statement Number	Billed Owner	Tax Area	Total Value	Exemptions	Taxable Value	Billed Tax	2025	2025-660096873	TOWNSEND, KYLE JOSEPH	40	328,596	34868		.00	2024	2024-660096873	TOWNSEND, KYLE JOSEPH	40	350,233	33853		.00	2023	2023-660096873	TOWNSEND, KYLE JOSEPH	40	312,164	32867		.00	2022	2022-660096873	TOWNSEND, KYLE JOSEPH	40	304,708	0	31,910	3,126.00	2021	2021-660096873	TOWNSEND, KYLE JOSEPH	40	276,275	0	30,390	2,940.00	2020	2020-660096873	TOWNSEND, KYLE JOSEPH	40	260,359	0	28,639	2,770.00	2019	2019-660096873	LUGINBILL, GINA LINDSEY	40	250,262	0	27,529	2,666.00	2018	2018-660096873	LUGINBILL, GINA LINDSEY	40	254,350	0	27,979	2,609.00	2017	2017-660096873	LUGINBILL, GINA LINDSEY	40	50,000	0	992	93.00	2016	2016-660096873	SIMMONS HOMES RESIDENTIAL	40	50,000	0	944	89.00	2015	2015-660096873	SIMMONS HOMES RESIDENTIAL	40	50,000	0	900	86.00
Tax Year	Statement Number	Billed Owner	Tax Area	Total Value	Exemptions	Taxable Value	Billed Tax																																																																																																		
2025	2025-660096873	TOWNSEND, KYLE JOSEPH	40	328,596	34868		.00																																																																																																		
2024	2024-660096873	TOWNSEND, KYLE JOSEPH	40	350,233	33853		.00																																																																																																		
2023	2023-660096873	TOWNSEND, KYLE JOSEPH	40	312,164	32867		.00																																																																																																		
2022	2022-660096873	TOWNSEND, KYLE JOSEPH	40	304,708	0	31,910	3,126.00																																																																																																		
2021	2021-660096873	TOWNSEND, KYLE JOSEPH	40	276,275	0	30,390	2,940.00																																																																																																		
2020	2020-660096873	TOWNSEND, KYLE JOSEPH	40	260,359	0	28,639	2,770.00																																																																																																		
2019	2019-660096873	LUGINBILL, GINA LINDSEY	40	250,262	0	27,529	2,666.00																																																																																																		
2018	2018-660096873	LUGINBILL, GINA LINDSEY	40	254,350	0	27,979	2,609.00																																																																																																		
2017	2017-660096873	LUGINBILL, GINA LINDSEY	40	50,000	0	992	93.00																																																																																																		
2016	2016-660096873	SIMMONS HOMES RESIDENTIAL	40	50,000	0	944	89.00																																																																																																		
2015	2015-660096873	SIMMONS HOMES RESIDENTIAL	40	50,000	0	900	86.00																																																																																																		



Rogers

Assessment Property Record Card for Tax Year 2026

Data provided by LISA DELOZIER County Assessor

Date 04/18/2026
Time 08:51:45
Page 2

Lot Data	Square-Foot - NBHD 1059 #1	Primary Image
Lot Size		
Lot Count	1	
Units Buildable		
Non-Ag Acres		
Topography		
Street Access		
Utilities		
Amenities	0	
	0	
Method	Square-Foot	
Base Lot Value	8,520.00 x 5.30 = 45,156	
Factor Value		
Adjustments	1.1604	
Lot Value	52,398	

Residential Data	
Type	1 Single Family Residence
Condition	3.5 - Average
Quality	3 - Average
Architecture	
Style	100% One Story
Exterior Wall	100% Veneer, Masonry
Base/Total Area	1,982 / 1,982
Style	100% One Story
HVAC	100% Warmed & Cooled Air
Roof Cover	1 Composition Shingle
Area on Slab	1,982
Fixture/RghIn	18 /
Bed/F/H Bath	4 / 2.0 /
Basement Area	
Garage Type	598 Attached Garage - Unfinished
Remodel	STANDARD -
Year/Eff Age	2017 / 5



\\tsclient\TCASEY\CASEY BOOTH RESIDENTIAL VI\2022-8-22\ 8/23/2022

GRM Approach	
GRM Code	
Gross Rent	0.00
Indicated Value	

Multiple Regression			
MRA Code	1	Test	
Adjusted R	0.8445		
Indicated Value	274,790	138.64	Per SqFt

Direct Comparables			
Selection Model	A	Adam Test	
Adjustment Model	1	2022 Residential	
Comparables	8		
Indicated Value	338,350		Per SqFt

Value Reconciliation			
Selected Approach	Cost Approach		
Improvements	277,603		
Lot Value	52,398		
Indicated Value	330,001	166.50	Per SqFt
Agland Value			
Site Improvements			
Total Value	330,001	166.50	Total Value Per SqFt

Cost Approach				Manual : 01/2025			
Base Cost	107.70	Total Misc Impr	+	5,564			
Roofing Adj	+ 4.71	Garage Cost	+	18,287			
Subfloor Adj	+ -2.20	Total RCN	=	292,214			
Heat/Cool Adj	+ 12.64	Depreciation (5%)	-	14,611			
Plumbing Adj	+ 12.55	Lump Sums	+	0			
Basement Adj	+ 0.00	RCNLD	=	277,603			
Adj Base Cost	= 135.40	Lot Value	+	52,398			
Total Area	x 1,982	Indicated Value	=	330,001			
Adjusted Cost	= 268,363	Value Per SqFt		166.50			

Miscellaneous Improvements								
Code	Description	Sketch ID	Size	Year	Units	Unit Cost	Depr	Value
PRCH	SLAB PORCH - COVERED	135726	7x6		42	26.80		1,126
PATO	SLAB PORCH - OPEN	135727	11x10		110	11.38		1,252
PRCH	SLAB PORCH - COVERED	135728	12x10		120	26.55		3,186



Rogers

Assessment Property Record Card for Tax Year 2026

Data provided by LISA DELOZIER County Assessor

Date 04/18/2026
 Time 08:51:45
 Page 3

Sketch Image

660096873

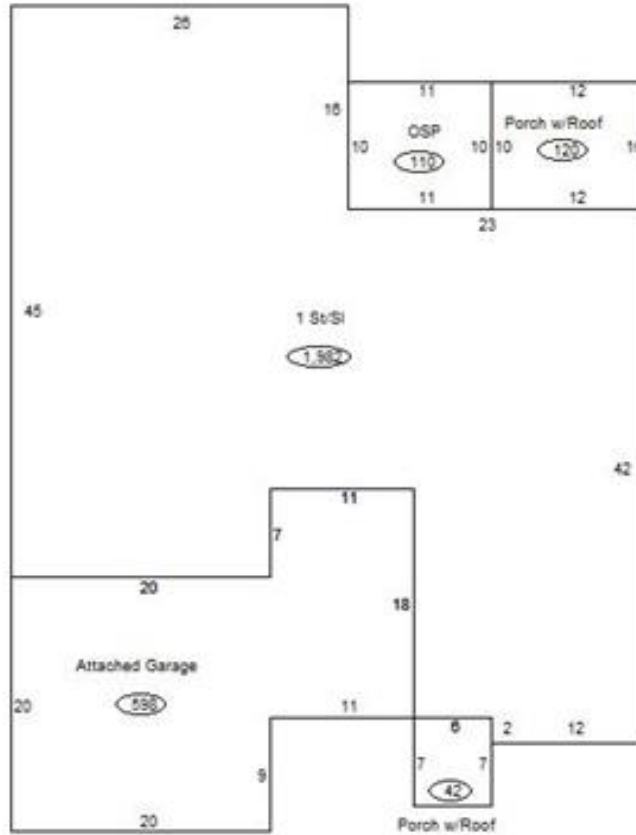

Sketch Vector Information

Sequence	Code	Type	Built Over	Scale	Section Label	Base Area	Multiplier	Total Area
1	R	1	Slab	13	1 St/Sl	1,982	1.000	1,982
2	G	1		13	Attached Garage	598	1.000	598
3	M	PRCH		13	SLBC	42	1.000	42
4	M	PATO		13	Open Slab	110	1.000	110
5	M	PRCH		13	SLBC	120	1.000	120
Total Building Area						1,982		1,982