



Rogers

Assessment Property Record Card for Tax Year 2026

Data provided by LISA DELOZIER County Assessor

Date 04/18/2026
Time 08:51:48
Page 1

Assessment Data					Primary Image																																																																																																				
Account 660096875 Parcel ID 000000-00-0-21650-003-0025 Cadastral ID 22-21-14-09920 Property Type REAL - Real Property Property Class URP VI Area 4 Tax Area 40 - OWASSO CITY Name ID 319392 VOSS, STEPHEN G & CHARLOTTE A 15507 E 87TH ST N OWASSO OK 74055-0000 Parcel Location Situs 15507 E 87TH ST N Subdivision PARK PLACE AT PRESTON LAKES Lot/Block 0025 / 0003 Parcel Size 1 - Lots Sec/Twn/Rng 22 / 21 / 14 / 5 Neighborhood 1059 - R-V04-SW OWASSO School District S021 - OWASSO SCHOOLS																																																																																																									
Legal Description Lot/Long: 36.27937538 -95.79937219																																																																																																									
Building Permits					<table border="1"> <thead> <tr> <th>Number</th> <th>Description</th> <th>Opened</th> <th>Closed</th> <th>Amount</th> </tr> </thead> <tbody> <tr> <td>16-0214X</td> <td>R17-NEW 2300 SQ FT SFR</td> <td>03/2016</td> <td>09/2016</td> <td>158,400</td> </tr> </tbody> </table>					Number	Description	Opened	Closed	Amount	16-0214X	R17-NEW 2300 SQ FT SFR	03/2016	09/2016	158,400																																																																																						
Number	Description	Opened	Closed	Amount																																																																																																					
16-0214X	R17-NEW 2300 SQ FT SFR	03/2016	09/2016	158,400																																																																																																					
Exemptions					Sale History																																																																																																				
<table border="1"> <thead> <tr> <th>Code</th> <th>Type</th> <th>Active</th> <th>Maximum</th> <th>Exemption</th> </tr> </thead> <tbody> <tr> <td>H</td> <td>Homestead</td> <td>Yes</td> <td>1,000</td> <td>1,000</td> </tr> </tbody> </table>					Code	Type	Active	Maximum	Exemption	H	Homestead	Yes	1,000	1,000	<table border="1"> <thead> <tr> <th>Bk/Pg</th> <th>Grantor</th> <th>Date</th> <th>Price</th> <th>Code</th> </tr> </thead> <tbody> <tr> <td>2578/277</td> <td>SIMMONS HOMES RESIDENTIAL</td> <td>09/16/2016</td> <td>270,500</td> <td>YES</td> </tr> <tr> <td>2421/745</td> <td>K & S DEVELOPMENTS INC</td> <td>03/24/2014</td> <td>0</td> <td>4</td> </tr> </tbody> </table>					Bk/Pg	Grantor	Date	Price	Code	2578/277	SIMMONS HOMES RESIDENTIAL	09/16/2016	270,500	YES	2421/745	K & S DEVELOPMENTS INC	03/24/2014	0	4																																																																							
Code	Type	Active	Maximum	Exemption																																																																																																					
H	Homestead	Yes	1,000	1,000																																																																																																					
Bk/Pg	Grantor	Date	Price	Code																																																																																																					
2578/277	SIMMONS HOMES RESIDENTIAL	09/16/2016	270,500	YES																																																																																																					
2421/745	K & S DEVELOPMENTS INC	03/24/2014	0	4																																																																																																					
Parcel Valuation																																																																																																									
<table border="1"> <thead> <tr> <th>Source</th> <th>REAL</th> </tr> </thead> <tbody> <tr> <td>Remove Cap</td> <td>2017</td> </tr> <tr> <td>Year Frozen</td> <td></td> </tr> <tr> <td>Uncapped Value</td> <td>0</td> </tr> <tr> <td>TIF Project ID</td> <td>0</td> </tr> </tbody> </table>		Source	REAL	Remove Cap	2017	Year Frozen		Uncapped Value	0	TIF Project ID	0	<table border="1"> <thead> <tr> <th>Fair Cash</th> <th>Capped</th> <th>Asmnt Level</th> <th>Assessed</th> </tr> </thead> <tbody> <tr> <td>Land Value</td> <td>45,156</td> <td>45,156</td> <td>4,967</td> </tr> <tr> <td>Improvements</td> <td>308,574</td> <td>288,194</td> <td>31,701</td> </tr> <tr> <td>Mobile Home</td> <td>0</td> <td>0</td> <td>0</td> </tr> <tr> <td>Total Value</td> <td>353,730</td> <td>333,350</td> <td>36,668</td> </tr> </tbody> </table>			Fair Cash	Capped	Asmnt Level	Assessed	Land Value	45,156	45,156	4,967	Improvements	308,574	288,194	31,701	Mobile Home	0	0	0	Total Value	353,730	333,350	36,668	<table border="1"> <thead> <tr> <th>Levy Rate</th> <th>Current Tax</th> </tr> </thead> <tbody> <tr> <td>97.960</td> <td>3,592.00</td> </tr> <tr> <td>Assessed</td> <td>36,668</td> </tr> <tr> <td>Penalty</td> <td>0</td> </tr> <tr> <td>Exemption</td> <td>1,000</td> </tr> <tr> <td>Total Taxable</td> <td>35,668</td> </tr> </tbody> </table>		Levy Rate	Current Tax	97.960	3,592.00	Assessed	36,668	Penalty	0	Exemption	1,000	Total Taxable	35,668																																																									
Source	REAL																																																																																																								
Remove Cap	2017																																																																																																								
Year Frozen																																																																																																									
Uncapped Value	0																																																																																																								
TIF Project ID	0																																																																																																								
Fair Cash	Capped	Asmnt Level	Assessed																																																																																																						
Land Value	45,156	45,156	4,967																																																																																																						
Improvements	308,574	288,194	31,701																																																																																																						
Mobile Home	0	0	0																																																																																																						
Total Value	353,730	333,350	36,668																																																																																																						
Levy Rate	Current Tax																																																																																																								
97.960	3,592.00																																																																																																								
Assessed	36,668																																																																																																								
Penalty	0																																																																																																								
Exemption	1,000																																																																																																								
Total Taxable	35,668																																																																																																								
Assessment History																																																																																																									
<table border="1"> <thead> <tr> <th>Tax Year</th> <th>Statement Number</th> <th>Billed Owner</th> <th>Tax Area</th> <th>Total Value</th> <th>Exemptions</th> <th>Taxable Value</th> <th>Billed Tax</th> </tr> </thead> <tbody> <tr><td>2025</td><td>2025-660096875</td><td>VOSS, STEPHEN G & CHARLOTTE A</td><td>40</td><td>344,533</td><td>1000</td><td>34,600</td><td>3,389.00</td></tr> <tr><td>2024</td><td>2024-660096875</td><td>VOSS, STEPHEN G & CHARLOTTE A</td><td>40</td><td>367,658</td><td>1000</td><td>33,564</td><td>3,224.00</td></tr> <tr><td>2023</td><td>2023-660096875</td><td>VOSS, STEPHEN G & CHARLOTTE A</td><td>40</td><td>326,071</td><td>1000</td><td>32,557</td><td>3,051.00</td></tr> <tr><td>2022</td><td>2022-660096875</td><td>VOSS, STEPHEN G & CHARLOTTE A</td><td>40</td><td>318,860</td><td>1000</td><td>31,580</td><td>3,094.00</td></tr> <tr><td>2021</td><td>2021-660096875</td><td>VOSS, STEPHEN G & CHARLOTTE A</td><td>40</td><td>287,553</td><td>1000</td><td>30,631</td><td>2,963.00</td></tr> <tr><td>2020</td><td>2020-660096875</td><td>VOSS, STEPHEN G & CHARLOTTE A</td><td>40</td><td>283,085</td><td>1000</td><td>29,799</td><td>2,882.00</td></tr> <tr><td>2019</td><td>2019-660096875</td><td>VOSS, STEPHEN G & CHARLOTTE A</td><td>40</td><td>271,835</td><td>1000</td><td>28,902</td><td>2,799.00</td></tr> <tr><td>2018</td><td>2018-660096875</td><td>VOSS, STEPHEN G & CHARLOTTE A</td><td>40</td><td>276,165</td><td>1000</td><td>29,378</td><td>2,739.00</td></tr> <tr><td>2017</td><td>2017-660096875</td><td>VOSS, STEPHEN G & CHARLOTTE A</td><td>40</td><td>273,983</td><td>1000</td><td>29,138</td><td>2,742.00</td></tr> <tr><td>2016</td><td>2016-660096875</td><td>VOSS, STEPHEN G & CHARLOTTE A</td><td>40</td><td>50,000</td><td>0</td><td>944</td><td>89.00</td></tr> <tr><td>2015</td><td>2015-660096875</td><td>SIMMONS HOMES RESIDENTIAL</td><td>40</td><td>50,000</td><td>0</td><td>900</td><td>86.00</td></tr> </tbody> </table>										Tax Year	Statement Number	Billed Owner	Tax Area	Total Value	Exemptions	Taxable Value	Billed Tax	2025	2025-660096875	VOSS, STEPHEN G & CHARLOTTE A	40	344,533	1000	34,600	3,389.00	2024	2024-660096875	VOSS, STEPHEN G & CHARLOTTE A	40	367,658	1000	33,564	3,224.00	2023	2023-660096875	VOSS, STEPHEN G & CHARLOTTE A	40	326,071	1000	32,557	3,051.00	2022	2022-660096875	VOSS, STEPHEN G & CHARLOTTE A	40	318,860	1000	31,580	3,094.00	2021	2021-660096875	VOSS, STEPHEN G & CHARLOTTE A	40	287,553	1000	30,631	2,963.00	2020	2020-660096875	VOSS, STEPHEN G & CHARLOTTE A	40	283,085	1000	29,799	2,882.00	2019	2019-660096875	VOSS, STEPHEN G & CHARLOTTE A	40	271,835	1000	28,902	2,799.00	2018	2018-660096875	VOSS, STEPHEN G & CHARLOTTE A	40	276,165	1000	29,378	2,739.00	2017	2017-660096875	VOSS, STEPHEN G & CHARLOTTE A	40	273,983	1000	29,138	2,742.00	2016	2016-660096875	VOSS, STEPHEN G & CHARLOTTE A	40	50,000	0	944	89.00	2015	2015-660096875	SIMMONS HOMES RESIDENTIAL	40	50,000	0	900	86.00
Tax Year	Statement Number	Billed Owner	Tax Area	Total Value	Exemptions	Taxable Value	Billed Tax																																																																																																		
2025	2025-660096875	VOSS, STEPHEN G & CHARLOTTE A	40	344,533	1000	34,600	3,389.00																																																																																																		
2024	2024-660096875	VOSS, STEPHEN G & CHARLOTTE A	40	367,658	1000	33,564	3,224.00																																																																																																		
2023	2023-660096875	VOSS, STEPHEN G & CHARLOTTE A	40	326,071	1000	32,557	3,051.00																																																																																																		
2022	2022-660096875	VOSS, STEPHEN G & CHARLOTTE A	40	318,860	1000	31,580	3,094.00																																																																																																		
2021	2021-660096875	VOSS, STEPHEN G & CHARLOTTE A	40	287,553	1000	30,631	2,963.00																																																																																																		
2020	2020-660096875	VOSS, STEPHEN G & CHARLOTTE A	40	283,085	1000	29,799	2,882.00																																																																																																		
2019	2019-660096875	VOSS, STEPHEN G & CHARLOTTE A	40	271,835	1000	28,902	2,799.00																																																																																																		
2018	2018-660096875	VOSS, STEPHEN G & CHARLOTTE A	40	276,165	1000	29,378	2,739.00																																																																																																		
2017	2017-660096875	VOSS, STEPHEN G & CHARLOTTE A	40	273,983	1000	29,138	2,742.00																																																																																																		
2016	2016-660096875	VOSS, STEPHEN G & CHARLOTTE A	40	50,000	0	944	89.00																																																																																																		
2015	2015-660096875	SIMMONS HOMES RESIDENTIAL	40	50,000	0	900	86.00																																																																																																		



Rogers

Assessment Property Record Card for Tax Year 2026

Data provided by LISA DELOZIER County Assessor

Date 04/18/2026
Time 08:51:49
Page 2

Lot Data	Square-Foot - NBHD 1059 #1	Primary Image
Lot Size		
Lot Count	1	
Units Buildable		
Non-Ag Acres		
Topography		
Street Access		
Utilities		
Amenities	0	
	0	
Method	Square-Foot	
Base Lot Value	8,520.00 x 5.30 = 45,156	
Factor Value		
Adjustments	1.0000	
Lot Value	45,156	

Residential Data	
Type	1 Single Family Residence
Condition	3 - Average
Quality	3.5 - Average
Architecture	
Style	100% One Story
Exterior Wall	95% Veneer, Masonry 5% Veneer, Stone
Base/Total Area	2,204 / 2,204
Style	100% One Story
HVAC	100% Warmed & Cooled Air
Roof Cover	1 Composition Shingle
Area on Slab	2,204
Fixture/RghIn	14 /
Bed/F/H Bath	4 / 3.0 /
Basement Area	
Garage Type	650 Attached Garage - Unfinished
Remodel	
Year/Eff Age	2017 / 7

\\tsclient\TCASEY\CASEY BOOTH RESIDENTIAL VI\2022-8-22\ 8/23/2022

GRM Approach	
GRM Code	
Gross Rent	0.00
Indicated Value	

Multiple Regression			
MRA Code	1	Test	
Adjusted R	0.8445		
Indicated Value	322,821	146.47	Per SqFt

Direct Comparables			
Selection Model	A	Adam Test	
Adjustment Model	1	2022 Residential	
Comparables	8		
Indicated Value	361,550		Per SqFt

Value Reconciliation			
Selected Approach	Cost Approach		
Improvements	308,574		
Lot Value	45,156		
Indicated Value	353,730	160.49	Per SqFt
Agland Value			
Site Improvements			
Total Value	353,730	160.49	Total Value Per SqFt

Cost Approach				Manual : 01/2025			
Base Cost	110.67	Total Misc Impr	+	4,999			
Roofing Adj	+ 5.26	Garage Cost	+	24,544			
Subfloor Adj	+ -3.40	Total RCN	=	331,800			
Heat/Cool Adj	+ 14.47	Depreciation (7%)	-	23,226			
Plumbing Adj	+ 10.14	Lump Sums	+	0			
Basement Adj	+ 0.00	RCNLD	=	308,574			
Adj Base Cost	= 137.14	Lot Value	+	45,156			
Total Area	x 2,204	Indicated Value	=	353,730			
Adjusted Cost	= 302,257	Value Per SqFt		160.49			

Miscellaneous Improvements								
Code	Description	Sketch ID	Size	Year	Units	Unit Cost	Depr	Value
PRCH	SLAB PORCH - COVERED	129039	18x6		108	29.18		3,151
PRCH	SLAB PORCH - COVERED	129040	9x7		63	29.33		1,848



Rogers

Assessment Property Record Card for Tax Year 2026

Data provided by LISA DELOZIER County Assessor

Date 04/18/2026
 Time 08:51:49
 Page 3

Sketch Image

660096875

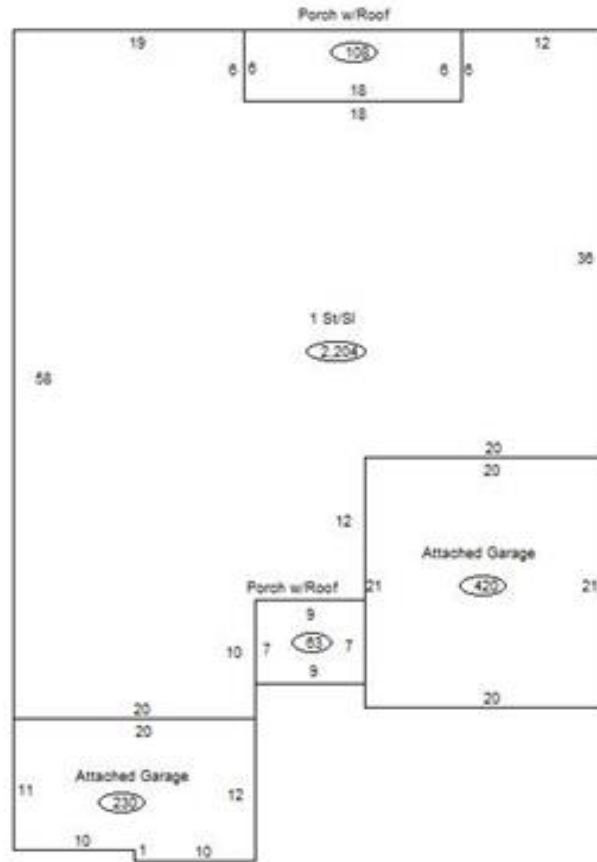

Sketch Vector Information

Sequence	Code	Type	Built Over	Scale	Section Label	Base Area	Multiplier	Total Area
1	R	1	Slab	13	1 St/Sl	2,204	1.000	2,204
2	G	1		13	Attached Garage	420	1.000	420
3	G	1		13	Attached Garage	230	1.000	230
4	M	PRCH		13	SLBC	108	1.000	108
5	M	PRCH		13	SLBC	63	1.000	63
Total Building Area						2,204		2,204