



Rogers

Assessment Property Record Card for Tax Year 2026

Data provided by LISA DELOZIER County Assessor

Date 04/18/2026
Time 08:51:59
Page 1

Assessment Data					Primary Image																																																																																																				
Account 660096881 Parcel ID 000000-00-0-21650-004-0005 Cadastral ID 22-21-14-09980 Property Type REAL - Real Property Property Class URP VI Area 4 Tax Area 40 - OWASSO CITY Name ID 315622 KOURTIS REALTY LTD CO 12150 E 96TH ST N #200 OWASSO OK 74055-0000 Parcel Location Situs 15518 E 88TH ST N Subdivision PARK PLACE AT PRESTON LAKES Lot/Block 0005 / 0004 Parcel Size 1 - Lots Sec/Twn/Rng 22 / 21 / 14 / 5 Neighborhood 1059 - R-V04-SW OWASSO School District S021 - OWASSO SCHOOLS																																																																																																									
Legal Description Lot/Long: 36.28061171 -95.79823561 LOT 5 BLOCK 4 PARK PLACE AT PRESTON LAKES										Building Permits <table border="1"> <thead> <tr> <th>Number</th> <th>Description</th> <th>Opened</th> <th>Closed</th> <th>Amount</th> </tr> </thead> <tbody> <tr> <td>15-0301-X</td> <td>R16-NEW 2207 SQ FT SFR</td> <td>04/2015</td> <td>08/2015</td> <td>153,285</td> </tr> </tbody> </table>					Number	Description	Opened	Closed	Amount	15-0301-X	R16-NEW 2207 SQ FT SFR	04/2015	08/2015	153,285																																																																																	
Number	Description	Opened	Closed	Amount																																																																																																					
15-0301-X	R16-NEW 2207 SQ FT SFR	04/2015	08/2015	153,285																																																																																																					
Exemptions <table border="1"> <thead> <tr> <th>Code</th> <th>Type</th> <th>Active</th> <th>Maximum</th> <th>Exemption</th> </tr> </thead> <tbody> <tr> <td></td> <td></td> <td></td> <td></td> <td></td> </tr> </tbody> </table>					Code	Type	Active	Maximum	Exemption						Sale History <table border="1"> <thead> <tr> <th>Bk/Pg</th> <th>Grantor</th> <th>Date</th> <th>Price</th> <th>Code</th> </tr> </thead> <tbody> <tr> <td>2484/360</td> <td>SIMMONS HOMES RESIDENTIAL</td> <td>07/02/2015</td> <td>226,000</td> <td>YES</td> </tr> <tr> <td>2421/745</td> <td>K & S DEVELOPMENTS INC</td> <td>03/24/2014</td> <td>0</td> <td>4</td> </tr> </tbody> </table>					Bk/Pg	Grantor	Date	Price	Code	2484/360	SIMMONS HOMES RESIDENTIAL	07/02/2015	226,000	YES	2421/745	K & S DEVELOPMENTS INC	03/24/2014	0	4																																																																							
Code	Type	Active	Maximum	Exemption																																																																																																					
Bk/Pg	Grantor	Date	Price	Code																																																																																																					
2484/360	SIMMONS HOMES RESIDENTIAL	07/02/2015	226,000	YES																																																																																																					
2421/745	K & S DEVELOPMENTS INC	03/24/2014	0	4																																																																																																					
Parcel Valuation <table border="1"> <thead> <tr> <th>Source</th> <th>REAL</th> <th>Fair Cash</th> <th>Capped</th> <th>Asmnt Level</th> <th>Assessed</th> <th>Levy Rate</th> <th>97.960</th> <th>Current Tax</th> </tr> </thead> <tbody> <tr> <td>Remove Cap</td> <td>2016</td> <td>Land Value 47,589</td> <td>47,589</td> <td>11%</td> <td>5,235</td> <td>Assessed</td> <td>34,229</td> <td>3,353.07</td> </tr> <tr> <td>Year Frozen</td> <td></td> <td>Improvements 267,366</td> <td>263,585</td> <td></td> <td>28,994</td> <td>Penalty</td> <td>0</td> <td></td> </tr> <tr> <td>Uncapped Value</td> <td>0</td> <td>Mobile Home 0</td> <td>0</td> <td></td> <td>0</td> <td>Exemption</td> <td>0</td> <td>0.00</td> </tr> <tr> <td>TIF Project ID</td> <td>0</td> <td>Total Value 314,955</td> <td>311,174</td> <td></td> <td>34,229</td> <td>Total Taxable</td> <td>34,229</td> <td>3,353.00</td> </tr> </tbody> </table>										Source	REAL	Fair Cash	Capped	Asmnt Level	Assessed	Levy Rate	97.960	Current Tax	Remove Cap	2016	Land Value 47,589	47,589	11%	5,235	Assessed	34,229	3,353.07	Year Frozen		Improvements 267,366	263,585		28,994	Penalty	0		Uncapped Value	0	Mobile Home 0	0		0	Exemption	0	0.00	TIF Project ID	0	Total Value 314,955	311,174		34,229	Total Taxable	34,229	3,353.00																																																			
Source	REAL	Fair Cash	Capped	Asmnt Level	Assessed	Levy Rate	97.960	Current Tax																																																																																																	
Remove Cap	2016	Land Value 47,589	47,589	11%	5,235	Assessed	34,229	3,353.07																																																																																																	
Year Frozen		Improvements 267,366	263,585		28,994	Penalty	0																																																																																																		
Uncapped Value	0	Mobile Home 0	0		0	Exemption	0	0.00																																																																																																	
TIF Project ID	0	Total Value 314,955	311,174		34,229	Total Taxable	34,229	3,353.00																																																																																																	
Assessment History <table border="1"> <thead> <tr> <th>Tax Year</th> <th>Statement Number</th> <th>Billed Owner</th> <th>Tax Area</th> <th>Total Value</th> <th>Exemptions</th> <th>Taxable Value</th> <th>Billed Tax</th> </tr> </thead> <tbody> <tr><td>2025</td><td>2025-660096881</td><td>KOURTIS REALTY LTD CO</td><td>40</td><td>304,219</td><td>0</td><td>32,599</td><td>3,193.00</td></tr> <tr><td>2024</td><td>2024-660096881</td><td>KOURTIS REALTY LTD CO</td><td>40</td><td>324,735</td><td>0</td><td>31,047</td><td>2,983.00</td></tr> <tr><td>2023</td><td>2023-660096881</td><td>KOURTIS REALTY LTD CO</td><td>40</td><td>289,986</td><td>0</td><td>29,568</td><td>2,771.00</td></tr> <tr><td>2022</td><td>2022-660096881</td><td>KOURTIS REALTY LTD CO</td><td>40</td><td>282,505</td><td>0</td><td>28,161</td><td>2,759.00</td></tr> <tr><td>2021</td><td>2021-660096881</td><td>KOURTIS REALTY LTD CO</td><td>40</td><td>243,815</td><td>0</td><td>26,820</td><td>2,595.00</td></tr> <tr><td>2020</td><td>2020-660096881</td><td>KOURTIS REALTY LTD CO</td><td>40</td><td>240,222</td><td>0</td><td>26,424</td><td>2,556.00</td></tr> <tr><td>2019</td><td>2019-660096881</td><td>KOURTIS REALTY LTD CO</td><td>40</td><td>229,211</td><td>0</td><td>25,213</td><td>2,441.00</td></tr> <tr><td>2018</td><td>2018-660096881</td><td>KOURTIS REALTY LTD CO</td><td>40</td><td>234,711</td><td>0</td><td>25,818</td><td>2,408.00</td></tr> <tr><td>2017</td><td>2017-660096881</td><td>KOURTIS REALTY LTD CO</td><td>40</td><td>232,926</td><td>0</td><td>25,622</td><td>2,411.00</td></tr> <tr><td>2016</td><td>2016-660096881</td><td>KOURTIS REALTY LTD CO</td><td>40</td><td>227,473</td><td>0</td><td>25,022</td><td>2,365.00</td></tr> <tr><td>2015</td><td>2015-660096881</td><td>KOURTIS REALTY LTD CO</td><td>40</td><td>50,000</td><td>0</td><td>900</td><td>86.00</td></tr> </tbody> </table>										Tax Year	Statement Number	Billed Owner	Tax Area	Total Value	Exemptions	Taxable Value	Billed Tax	2025	2025-660096881	KOURTIS REALTY LTD CO	40	304,219	0	32,599	3,193.00	2024	2024-660096881	KOURTIS REALTY LTD CO	40	324,735	0	31,047	2,983.00	2023	2023-660096881	KOURTIS REALTY LTD CO	40	289,986	0	29,568	2,771.00	2022	2022-660096881	KOURTIS REALTY LTD CO	40	282,505	0	28,161	2,759.00	2021	2021-660096881	KOURTIS REALTY LTD CO	40	243,815	0	26,820	2,595.00	2020	2020-660096881	KOURTIS REALTY LTD CO	40	240,222	0	26,424	2,556.00	2019	2019-660096881	KOURTIS REALTY LTD CO	40	229,211	0	25,213	2,441.00	2018	2018-660096881	KOURTIS REALTY LTD CO	40	234,711	0	25,818	2,408.00	2017	2017-660096881	KOURTIS REALTY LTD CO	40	232,926	0	25,622	2,411.00	2016	2016-660096881	KOURTIS REALTY LTD CO	40	227,473	0	25,022	2,365.00	2015	2015-660096881	KOURTIS REALTY LTD CO	40	50,000	0	900	86.00
Tax Year	Statement Number	Billed Owner	Tax Area	Total Value	Exemptions	Taxable Value	Billed Tax																																																																																																		
2025	2025-660096881	KOURTIS REALTY LTD CO	40	304,219	0	32,599	3,193.00																																																																																																		
2024	2024-660096881	KOURTIS REALTY LTD CO	40	324,735	0	31,047	2,983.00																																																																																																		
2023	2023-660096881	KOURTIS REALTY LTD CO	40	289,986	0	29,568	2,771.00																																																																																																		
2022	2022-660096881	KOURTIS REALTY LTD CO	40	282,505	0	28,161	2,759.00																																																																																																		
2021	2021-660096881	KOURTIS REALTY LTD CO	40	243,815	0	26,820	2,595.00																																																																																																		
2020	2020-660096881	KOURTIS REALTY LTD CO	40	240,222	0	26,424	2,556.00																																																																																																		
2019	2019-660096881	KOURTIS REALTY LTD CO	40	229,211	0	25,213	2,441.00																																																																																																		
2018	2018-660096881	KOURTIS REALTY LTD CO	40	234,711	0	25,818	2,408.00																																																																																																		
2017	2017-660096881	KOURTIS REALTY LTD CO	40	232,926	0	25,622	2,411.00																																																																																																		
2016	2016-660096881	KOURTIS REALTY LTD CO	40	227,473	0	25,022	2,365.00																																																																																																		
2015	2015-660096881	KOURTIS REALTY LTD CO	40	50,000	0	900	86.00																																																																																																		



Rogers

Assessment Property Record Card for Tax Year 2026

Data provided by LISA DELOZIER County Assessor

Date 04/18/2026
 Time 08:52:00
 Page 2

Lot Data	Square-Foot - NBHD 1059 #1	Primary Image
Lot Size		
Lot Count	1	
Units Buildable		
Non-Ag Acres		
Topography		
Street Access		
Utilities		
Amenities	0	
	0	
Method	Square-Foot	
Base Lot Value	8,979.00 x 5.30 = 47,589	
Factor Value		
Adjustments	1.0000	
Lot Value	47,589	

Residential Data	
Type	1 Single Family Residence
Condition	3 - Average
Quality	3 - Average
Architecture	
Style	100% One Story
Exterior Wall	100% Veneer, Masonry
Base/Total Area	2,207 / 2,207
Style	100% One Story
HVAC	100% Warmed & Cooled Air
Roof Cover	1 Composition Shingle
Area on Slab	2,207
Fixture/RghIn	11 /
Bed/F/H Bath	3 / 2.0 /
Basement Area	
Garage Type	510 Attached Garage - Unfinished
Remodel	
Year/Eff Age	2015 / 8



\\tsclient\TCASEY\CASEY BOOTH RESIDENTIAL VI\2022-8-23\ 8/23/2022

GRM Approach	
GRM Code	
Gross Rent	0.00
Indicated Value	

Multiple Regression			
MRA Code	1	Test	
Adjusted R	0.8445		
Indicated Value	279,411	126.60	Per SqFt

Direct Comparables			
Selection Model	A	Adam Test	
Adjustment Model	1	2022 Residential	
Comparables	8		
Indicated Value	326,800		Per SqFt

Cost Approach				Manual : 01/2025			
Base Cost	105.06	Total Misc Impr	+	3,653			
Roofing Adj	+ 4.59	Garage Cost	+	16,182			
Subfloor Adj	+ -2.19	Total RCN	=	300,411			
Heat/Cool Adj	+ 12.64	Depreciation (11%)	-	33,045			
Plumbing Adj	+ 7.03	Lump Sums	+	0			
Basement Adj	+ 0.00	RCNLD	=	267,366			
Adj Base Cost	= 127.13	Lot Value	+	47,589			
Total Area	x 2,207	Indicated Value	=	314,955			
Adjusted Cost	= 280,576	Value Per SqFt		142.71			

Value Reconciliation			
Selected Approach	Cost Approach		
Improvements	267,366		
Lot Value	47,589		
Indicated Value	314,955	142.71	Per SqFt
Agland Value			
Site Improvements			
Total Value	314,955	142.71	Total Value Per SqFt

Miscellaneous Improvements								
Code	Description	Sketch ID	Size	Year	Units	Unit Cost	Depr	Value
PRCH	SLAB PORCH - COVERED	125867	17x6		102	26.61		2,714
PRCH	SLAB PORCH - COVERED	125868	7x5		35	26.82		939



Rogers

Assessment Property Record Card for Tax Year 2026

Data provided by LISA DELOZIER County Assessor

Date 04/18/2026
 Time 08:52:00
 Page 3

Sketch Image

660096881

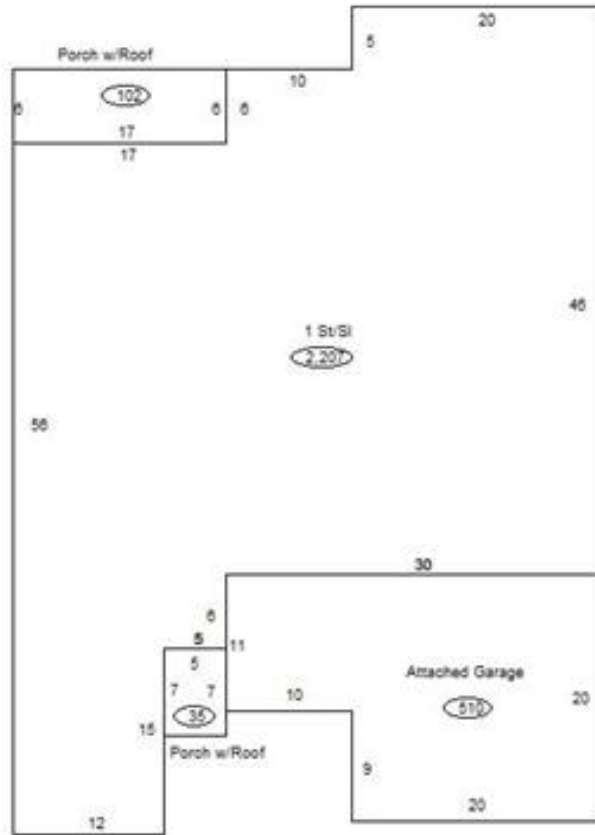

Sketch Vector Information

Sequence	Code	Type	Built Over	Scale	Section Label	Base Area	Multiplier	Total Area
1	R	1	Slab	13	1 St/Sl	2,207	1.000	2,207
2	G	1		13	Attached Garage	510	1.000	510
3	M	PRCH		13	SLBC	102	1.000	102
4	M	PRCH		13	SLBC	35	1.000	35
Total Building Area						2,207		2,207