



Rogers

Assessment Property Record Card for Tax Year 2026

Data provided by LISA DELOZIER County Assessor

Date 04/18/2026
 Time 08:56:18
 Page 1

Assessment Data				Primary Image																																																																																																					
Account 660097362 Parcel ID 000000-00-0-00458-002-0015 Cadastral ID 10-21-14-06500 Property Type REAL - Real Property Property Class URP VI Area 4 Tax Area 40 - OWASSO CITY Name ID 338946 TTWME INVESTMENTS LLC C/O TYLER A STEEN 14917 E 83RD ST N OWASSO OK 74055-0000 Parcel Location Situs 11210 N 146TH E AVE Subdivision LAKE VALLEY V PHASE II Lot/Block 0015 / 0002 Parcel Size 1 - Lots Sec/Twn/Rng 10 / 21 / 14 / 5 Neighborhood 1059 - R-V04-SW OWASSO School District S021 - OWASSO SCHOOLS																																																																																																									
Legal Description Lot/Long: 36.31799902 -95.81091406 LOT 15 BLOCK 2 LAKE VALLEY V PHASE II										Building Permits <table border="1"> <thead> <tr> <th>Number</th> <th>Description</th> <th>Opened</th> <th>Closed</th> <th>Amount</th> </tr> </thead> <tbody> <tr> <td>17-0308-X</td> <td>R18-NEW 1766 SQ FT SFR</td> <td>04/2017</td> <td>09/2017</td> <td>125,510</td> </tr> </tbody> </table>						Number	Description	Opened	Closed	Amount	17-0308-X	R18-NEW 1766 SQ FT SFR	04/2017	09/2017	125,510																																																																																
Number	Description	Opened	Closed	Amount																																																																																																					
17-0308-X	R18-NEW 1766 SQ FT SFR	04/2017	09/2017	125,510																																																																																																					
Exemptions <table border="1"> <thead> <tr> <th>Code</th> <th>Type</th> <th>Active</th> <th>Maximum</th> <th>Exemption</th> </tr> </thead> <tbody> <tr> <td></td> <td></td> <td></td> <td></td> <td></td> </tr> </tbody> </table>				Code	Type	Active	Maximum	Exemption						Sale History <table border="1"> <thead> <tr> <th>Bk/Pg</th> <th>Grantor</th> <th>Date</th> <th>Price</th> <th>Code</th> </tr> </thead> <tbody> <tr> <td>/</td> <td>RIGHT HOMES LLC</td> <td>07/07/2022</td> <td>0</td> <td>4</td> </tr> <tr> <td>/</td> <td>COLINA, RICKSY A</td> <td>12/05/2020</td> <td>208,500</td> <td>YES</td> </tr> <tr> <td>2663/381</td> <td>CAPITAL HOMES RES GRP LLC</td> <td>09/22/2017</td> <td>185,500</td> <td>YES</td> </tr> <tr> <td>2446/353</td> <td>LAKE VALLEY INVESTMENT</td> <td>12/19/2014</td> <td>0</td> <td>4</td> </tr> </tbody> </table>						Bk/Pg	Grantor	Date	Price	Code	/	RIGHT HOMES LLC	07/07/2022	0	4	/	COLINA, RICKSY A	12/05/2020	208,500	YES	2663/381	CAPITAL HOMES RES GRP LLC	09/22/2017	185,500	YES	2446/353	LAKE VALLEY INVESTMENT	12/19/2014	0	4																																																													
Code	Type	Active	Maximum	Exemption																																																																																																					
Bk/Pg	Grantor	Date	Price	Code																																																																																																					
/	RIGHT HOMES LLC	07/07/2022	0	4																																																																																																					
/	COLINA, RICKSY A	12/05/2020	208,500	YES																																																																																																					
2663/381	CAPITAL HOMES RES GRP LLC	09/22/2017	185,500	YES																																																																																																					
2446/353	LAKE VALLEY INVESTMENT	12/19/2014	0	4																																																																																																					
Parcel Valuation <table border="1"> <thead> <tr> <th>Source</th> <th>REAL</th> <th>Fair Cash</th> <th>Capped</th> <th>Asmnt Level</th> <th>Assessed</th> <th>Levy Rate</th> <th>97.960</th> <th>Current Tax</th> </tr> </thead> <tbody> <tr> <td>Remove Cap</td> <td>2021</td> <td>Land Value</td> <td>33,570</td> <td>33,570</td> <td>11%</td> <td>3,693</td> <td>Assessed</td> <td>28,442 2,786.18</td> </tr> <tr> <td>Year Frozen</td> <td></td> <td>Improvements</td> <td>228,512</td> <td>224,989</td> <td></td> <td>24,749</td> <td>Penalty</td> <td>0</td> </tr> <tr> <td>Uncapped Value</td> <td>0</td> <td>Mobile Home</td> <td>0</td> <td>0</td> <td>0</td> <td>0</td> <td>Exemption</td> <td>0 0.00</td> </tr> <tr> <td>TIF Project ID</td> <td>0</td> <td>Total Value</td> <td>262,082</td> <td>258,559</td> <td>28,442</td> <td>Total Taxable</td> <td>28,442</td> <td>2,786.00</td> </tr> </tbody> </table>										Source	REAL	Fair Cash	Capped	Asmnt Level	Assessed	Levy Rate	97.960	Current Tax	Remove Cap	2021	Land Value	33,570	33,570	11%	3,693	Assessed	28,442 2,786.18	Year Frozen		Improvements	228,512	224,989		24,749	Penalty	0	Uncapped Value	0	Mobile Home	0	0	0	0	Exemption	0 0.00	TIF Project ID	0	Total Value	262,082	258,559	28,442	Total Taxable	28,442	2,786.00																																																			
Source	REAL	Fair Cash	Capped	Asmnt Level	Assessed	Levy Rate	97.960	Current Tax																																																																																																	
Remove Cap	2021	Land Value	33,570	33,570	11%	3,693	Assessed	28,442 2,786.18																																																																																																	
Year Frozen		Improvements	228,512	224,989		24,749	Penalty	0																																																																																																	
Uncapped Value	0	Mobile Home	0	0	0	0	Exemption	0 0.00																																																																																																	
TIF Project ID	0	Total Value	262,082	258,559	28,442	Total Taxable	28,442	2,786.00																																																																																																	
Assessment History <table border="1"> <thead> <tr> <th>Tax Year</th> <th>Statement Number</th> <th>Billed Owner</th> <th>Tax Area</th> <th>Total Value</th> <th>Exemptions</th> <th>Taxable Value</th> <th>Billed Tax</th> </tr> </thead> <tbody> <tr> <td>2025</td> <td>2025-660097362</td> <td>TTWME INVESTMENTS LLC</td> <td>40</td> <td>255,291</td> <td>0</td> <td>27,087</td> <td>2,653.00</td> </tr> <tr> <td>2024</td> <td>2024-660097362</td> <td>TTWME INVESTMENTS LLC</td> <td>40</td> <td>272,279</td> <td>0</td> <td>25,798</td> <td>2,478.00</td> </tr> <tr> <td>2023</td> <td>2023-660097362</td> <td>TTWME INVESTMENTS LLC</td> <td>40</td> <td>242,094</td> <td>0</td> <td>24,569</td> <td>2,302.00</td> </tr> <tr> <td>2022</td> <td>2022-660097362</td> <td>TTWME INVESTMENTS LLC</td> <td>40</td> <td>236,159</td> <td>0</td> <td>23,399</td> <td>2,292.00</td> </tr> <tr> <td>2021</td> <td>2021-660097362</td> <td>RIGHT HOMES LLC</td> <td>40</td> <td>202,590</td> <td>0</td> <td>22,285</td> <td>2,156.00</td> </tr> <tr> <td>2020</td> <td>2020-660097362</td> <td>COLINA, RICKSY A</td> <td>40</td> <td>192,461</td> <td>0</td> <td>21,171</td> <td>2,048.00</td> </tr> <tr> <td>2019</td> <td>2019-660097362</td> <td>COLINA, RICKSY A</td> <td>40</td> <td>184,643</td> <td>0</td> <td>20,311</td> <td>1,967.00</td> </tr> <tr> <td>2018</td> <td>2018-660097362</td> <td>COLINA, RICKSY A</td> <td>40</td> <td>187,435</td> <td>0</td> <td>20,618</td> <td>1,923.00</td> </tr> <tr> <td>2017</td> <td>2017-660097362</td> <td>COLINA, RICKSY A</td> <td>40</td> <td>30,000</td> <td>0</td> <td>622</td> <td>59.00</td> </tr> <tr> <td>2016</td> <td>2016-660097362</td> <td>CAPITAL HOMES RES GRP LLC</td> <td>40</td> <td>30,000</td> <td>0</td> <td>592</td> <td>56.00</td> </tr> <tr> <td>2015</td> <td>2015-660097362</td> <td>CAPITAL HOMES RES GRP LLC</td> <td>40</td> <td>5,129</td> <td>0</td> <td>564</td> <td>54.00</td> </tr> </tbody> </table>										Tax Year	Statement Number	Billed Owner	Tax Area	Total Value	Exemptions	Taxable Value	Billed Tax	2025	2025-660097362	TTWME INVESTMENTS LLC	40	255,291	0	27,087	2,653.00	2024	2024-660097362	TTWME INVESTMENTS LLC	40	272,279	0	25,798	2,478.00	2023	2023-660097362	TTWME INVESTMENTS LLC	40	242,094	0	24,569	2,302.00	2022	2022-660097362	TTWME INVESTMENTS LLC	40	236,159	0	23,399	2,292.00	2021	2021-660097362	RIGHT HOMES LLC	40	202,590	0	22,285	2,156.00	2020	2020-660097362	COLINA, RICKSY A	40	192,461	0	21,171	2,048.00	2019	2019-660097362	COLINA, RICKSY A	40	184,643	0	20,311	1,967.00	2018	2018-660097362	COLINA, RICKSY A	40	187,435	0	20,618	1,923.00	2017	2017-660097362	COLINA, RICKSY A	40	30,000	0	622	59.00	2016	2016-660097362	CAPITAL HOMES RES GRP LLC	40	30,000	0	592	56.00	2015	2015-660097362	CAPITAL HOMES RES GRP LLC	40	5,129	0	564	54.00
Tax Year	Statement Number	Billed Owner	Tax Area	Total Value	Exemptions	Taxable Value	Billed Tax																																																																																																		
2025	2025-660097362	TTWME INVESTMENTS LLC	40	255,291	0	27,087	2,653.00																																																																																																		
2024	2024-660097362	TTWME INVESTMENTS LLC	40	272,279	0	25,798	2,478.00																																																																																																		
2023	2023-660097362	TTWME INVESTMENTS LLC	40	242,094	0	24,569	2,302.00																																																																																																		
2022	2022-660097362	TTWME INVESTMENTS LLC	40	236,159	0	23,399	2,292.00																																																																																																		
2021	2021-660097362	RIGHT HOMES LLC	40	202,590	0	22,285	2,156.00																																																																																																		
2020	2020-660097362	COLINA, RICKSY A	40	192,461	0	21,171	2,048.00																																																																																																		
2019	2019-660097362	COLINA, RICKSY A	40	184,643	0	20,311	1,967.00																																																																																																		
2018	2018-660097362	COLINA, RICKSY A	40	187,435	0	20,618	1,923.00																																																																																																		
2017	2017-660097362	COLINA, RICKSY A	40	30,000	0	622	59.00																																																																																																		
2016	2016-660097362	CAPITAL HOMES RES GRP LLC	40	30,000	0	592	56.00																																																																																																		
2015	2015-660097362	CAPITAL HOMES RES GRP LLC	40	5,129	0	564	54.00																																																																																																		



Rogers

Assessment Property Record Card for Tax Year 2026

Data provided by LISA DELOZIER County Assessor

Date 04/18/2026
 Time 08:56:18
 Page 2

Lot Data		Square-Foot - NBHD 1059 #1	
Lot Size	0	0	
Lot Count	1		
Units Buildable			
Non-Ag Acres	0.1454		
Topography			
Street Access			
Utilities			
Amenities			0
			0
Method	Square-Foot		
Base Lot Value	6,334.00 x 5.30 = 33,570		
Factor Value			
Adjustments	1.0000		
Lot Value	33,570		



\\tsclient\T\LOGAN\LOGAN RESIDENTIAL VI\2022-7-19\IMG_000; 7/19/2022

Residential Data	
Type	1 Single Family Residence
Condition	3 - Average
Quality	3 - Average
Architecture	
Style	100% One Story
Exterior Wall	10% Veneer, Masonry 90% Frame, Siding, Wood
Base/Total Area	1,770 / 1,770
Style	100% One Story
HVAC	100% Warmed & Cooled Air
Roof Cover	1 Composition Shingle
Area on Slab	1,770
Fixture/RghIn	14 /
Bed/F/H Bath	4 / 2.0 / 1.0
Basement Area	
Garage Type	504 Attached Garage - Unfinished
Remodel	
Year/Eff Age	2017 / 7

GRM Approach

GRM Code	
Gross Rent	0.00
Indicated Value	

Multiple Regression

MRA Code	1	Test
Adjusted R	0.8445	
Indicated Value	250,783	141.69 Per SqFt

Direct Comparables

Selection Model	A	Adam Test
Adjustment Model	1	2022 Residential
Comparables	8	
Indicated Value	253,510	Per SqFt

Value Reconciliation

Selected Approach	Cost Approach		
Improvements	228,512		
Lot Value	33,570		
Indicated Value	262,082	148.07	Per SqFt
Agland Value			
Site Improvements			
Total Value	262,082	148.07	Total Value Per SqFt

Cost Approach		Manual : 01/2025	
Base Cost	100.41	Total Misc Impr	+ 5,952
Roofing Adj	+ 4.71	Garage Cost	+ 16,032
Subfloor Adj	+ -2.39	Total RCN	= 245,712
Heat/Cool Adj	+ 12.64	Depreciation (7%)	- 17,200
Plumbing Adj	+ 11.03	Lump Sums	+ 0
Basement Adj	+ 0.00	RCNLD	= 228,512
Adj Base Cost	= 126.40	Lot Value	+ 33,570
Total Area	x 1,770	Indicated Value	= 262,082
Adjusted Cost	= 223,728	Value Per SqFt	148.07

Miscellaneous Improvements

Code	Description	Sketch ID	Size	Year	Units	Unit Cost	Depr	Value
PRCH	SLAB PORCH - COVERED	134791	16x8		128	26.53		3,396
PRCH	SLAB PORCH - COVERED	134793	96		96	26.63		2,556



Rogers

Assessment Property Record Card for Tax Year 2026

Data provided by LISA DELOZIER County Assessor

Date 04/18/2026
 Time 08:56:18
 Page 3

Sketch Image

660097362

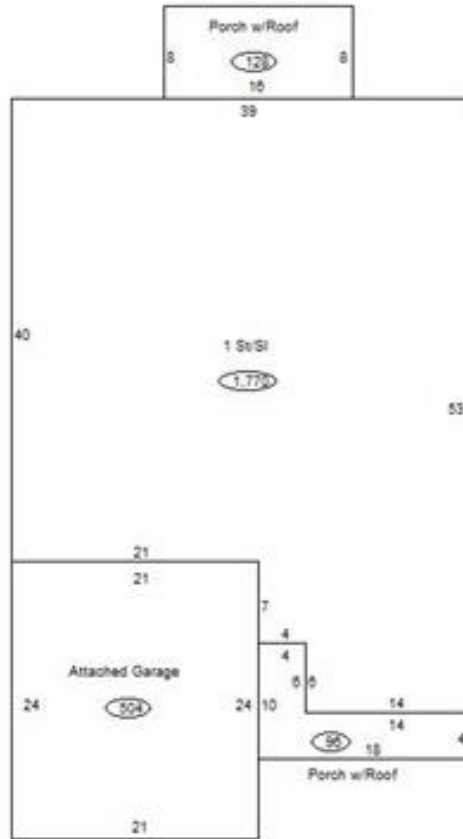

Sketch Vector Information

Sequence	Code	Type	Built Over	Scale	Section Label	Base Area	Multiplier	Total Area
1	R	1	Slab	13	1 St/Sl	1,770	1.000	1,770
2	M	PRCH		13	SLBC	128	1.000	128
3	G	1		13	Attached Garage	504	1.000	504
4	M	PRCH		13	SLBC	96	1.000	96
Total Building Area						1,770		1,770