



# Rogers

## Assessment Property Record Card for Tax Year 2026

Data provided by LISA DELOZIER County Assessor

Date 04/18/2026  
Time 08:56:29  
Page 1

Assessment Data					Primary Image																																																																																																				
<b>Account</b> 660097368 <b>Parcel ID</b> 000000-00-0-00458-002-0021 <b>Cadastral ID</b> 10-21-14-06560 <b>Property Type</b> REAL - Real Property <b>Property Class</b> URP VI Area 4 <b>Tax Area</b> 40 - OWASSO CITY <b>Name ID</b> 323420 APARICIO, UBALDO & CARLOTA  14609 E 113TH ST N OWASSO OK 74055-0000  <b>Parcel Location</b> <b>Situs</b> 14609 E 113TH ST N <b>Subdivision</b> LAKE VALLEY V PHASE II <b>Lot/Block</b> 0021 / 0002 <b>Parcel Size</b> 1 - Lots <b>Sec/Twn/Rng</b> 10 / 21 / 14 / 5 <b>Neighborhood</b> 1059 - R-V04-SW OWASSO <b>School District</b> S021 - OWASSO SCHOOLS																																																																																																									
<b>Legal Description</b> Lot/Long: 36.31830798 -95.80989423																																																																																																									
<b>Building Permits</b>					<table border="1"> <thead> <tr> <th>Number</th> <th>Description</th> <th>Opened</th> <th>Closed</th> <th>Amount</th> </tr> </thead> <tbody> <tr> <td>R18</td> <td>R18 NEW SFR</td> <td>09/2017</td> <td>12/2017</td> <td></td> </tr> </tbody> </table>					Number	Description	Opened	Closed	Amount	R18	R18 NEW SFR	09/2017	12/2017																																																																																							
Number	Description	Opened	Closed	Amount																																																																																																					
R18	R18 NEW SFR	09/2017	12/2017																																																																																																						
<b>Exemptions</b>					<b>Sale History</b>																																																																																																				
<table border="1"> <thead> <tr> <th>Code</th> <th>Type</th> <th>Active</th> <th>Maximum</th> <th>Exemption</th> </tr> </thead> <tbody> <tr> <td></td> <td></td> <td></td> <td></td> <td></td> </tr> </tbody> </table>					Code	Type	Active	Maximum	Exemption						<table border="1"> <thead> <tr> <th>Bk/Pg</th> <th>Grantor</th> <th>Date</th> <th>Price</th> <th>Code</th> </tr> </thead> <tbody> <tr> <td>2680/815</td> <td>CAPITAL HOMES RES GRP LLC</td> <td>12/12/2017</td> <td>187,000</td> <td>YES</td> </tr> <tr> <td>2446/353</td> <td>LAKE VALLEY INVESTMENT</td> <td>12/19/2014</td> <td>0</td> <td>4</td> </tr> </tbody> </table>					Bk/Pg	Grantor	Date	Price	Code	2680/815	CAPITAL HOMES RES GRP LLC	12/12/2017	187,000	YES	2446/353	LAKE VALLEY INVESTMENT	12/19/2014	0	4																																																																							
Code	Type	Active	Maximum	Exemption																																																																																																					
Bk/Pg	Grantor	Date	Price	Code																																																																																																					
2680/815	CAPITAL HOMES RES GRP LLC	12/12/2017	187,000	YES																																																																																																					
2446/353	LAKE VALLEY INVESTMENT	12/19/2014	0	4																																																																																																					
<b>Parcel Valuation</b>																																																																																																									
<table border="1"> <thead> <tr> <th>Source</th> <th>REAL</th> </tr> </thead> <tbody> <tr> <td>Remove Cap</td> <td>2018</td> </tr> <tr> <td>Year Frozen</td> <td></td> </tr> <tr> <td>Uncapped Value</td> <td>0</td> </tr> <tr> <td>TIF Project ID</td> <td>0</td> </tr> </tbody> </table>		Source	REAL	Remove Cap	2018	Year Frozen		Uncapped Value	0	TIF Project ID	0	<table border="1"> <thead> <tr> <th>Fair Cash</th> <th>Capped</th> <th>Asmnt Level</th> <th>Assessed</th> </tr> </thead> <tbody> <tr> <td>Land Value</td> <td>32,007</td> <td>32,007</td> <td>3,521</td> </tr> <tr> <td>Improvements</td> <td>228,034</td> <td>225,412</td> <td>24,795</td> </tr> <tr> <td>Mobile Home</td> <td>0</td> <td>0</td> <td>0</td> </tr> <tr> <td>Total Value</td> <td>260,041</td> <td>257,419</td> <td>28,316</td> </tr> </tbody> </table>			Fair Cash	Capped	Asmnt Level	Assessed	Land Value	32,007	32,007	3,521	Improvements	228,034	225,412	24,795	Mobile Home	0	0	0	Total Value	260,041	257,419	28,316	<table border="1"> <thead> <tr> <th>Levy Rate</th> <th>Current Tax</th> </tr> </thead> <tbody> <tr> <td>97.960</td> <td></td> </tr> <tr> <td>Assessed</td> <td>28,316</td> </tr> <tr> <td>Penalty</td> <td>0</td> </tr> <tr> <td>Exemption</td> <td>0</td> </tr> <tr> <td>Total Taxable</td> <td>28,316</td> </tr> </tbody> </table>		Levy Rate	Current Tax	97.960		Assessed	28,316	Penalty	0	Exemption	0	Total Taxable	28,316																																																									
Source	REAL																																																																																																								
Remove Cap	2018																																																																																																								
Year Frozen																																																																																																									
Uncapped Value	0																																																																																																								
TIF Project ID	0																																																																																																								
Fair Cash	Capped	Asmnt Level	Assessed																																																																																																						
Land Value	32,007	32,007	3,521																																																																																																						
Improvements	228,034	225,412	24,795																																																																																																						
Mobile Home	0	0	0																																																																																																						
Total Value	260,041	257,419	28,316																																																																																																						
Levy Rate	Current Tax																																																																																																								
97.960																																																																																																									
Assessed	28,316																																																																																																								
Penalty	0																																																																																																								
Exemption	0																																																																																																								
Total Taxable	28,316																																																																																																								
<b>Assessment History</b>																																																																																																									
<table border="1"> <thead> <tr> <th>Tax Year</th> <th>Statement Number</th> <th>Billed Owner</th> <th>Tax Area</th> <th>Total Value</th> <th>Exemptions</th> <th>Taxable Value</th> <th>Billed Tax</th> </tr> </thead> <tbody> <tr><td>2025</td><td>2025-660097368</td><td>APARICIO, UBALDO &amp; CARLOTA</td><td>40</td><td>253,249</td><td>0</td><td>26,968</td><td>2,642.00</td></tr> <tr><td>2024</td><td>2024-660097368</td><td>APARICIO, UBALDO &amp; CARLOTA</td><td>40</td><td>270,131</td><td>0</td><td>25,684</td><td>2,467.00</td></tr> <tr><td>2023</td><td>2023-660097368</td><td>APARICIO, UBALDO &amp; CARLOTA</td><td>40</td><td>241,658</td><td>0</td><td>24,461</td><td>2,292.00</td></tr> <tr><td>2022</td><td>2022-660097368</td><td>APARICIO, UBALDO &amp; CARLOTA</td><td>40</td><td>235,721</td><td>0</td><td>23,295</td><td>2,282.00</td></tr> <tr><td>2021</td><td>2021-660097368</td><td>APARICIO, UBALDO &amp; CARLOTA</td><td>40</td><td>202,191</td><td>0</td><td>22,186</td><td>2,146.00</td></tr> <tr><td>2020</td><td>2020-660097368</td><td>APARICIO, UBALDO &amp; CARLOTA</td><td>40</td><td>192,092</td><td>0</td><td>21,130</td><td>2,044.00</td></tr> <tr><td>2019</td><td>2019-660097368</td><td>APARICIO, UBALDO &amp; CARLOTA</td><td>40</td><td>184,290</td><td>0</td><td>20,272</td><td>1,963.00</td></tr> <tr><td>2018</td><td>2018-660097368</td><td>APARICIO, UBALDO &amp; CARLOTA</td><td>40</td><td>187,123</td><td>0</td><td>20,584</td><td>1,919.00</td></tr> <tr><td>2017</td><td>2017-660097368</td><td>CAPITAL HOMES RES GRP LLC</td><td>40</td><td>5,129</td><td>0</td><td>564</td><td>53.00</td></tr> <tr><td>2016</td><td>2016-660097368</td><td>CAPITAL HOMES RES GRP LLC</td><td>40</td><td>5,129</td><td>0</td><td>564</td><td>53.00</td></tr> <tr><td>2015</td><td>2015-660097368</td><td>CAPITAL HOMES RES GRP LLC</td><td>40</td><td>5,129</td><td>0</td><td>564</td><td>54.00</td></tr> </tbody> </table>										Tax Year	Statement Number	Billed Owner	Tax Area	Total Value	Exemptions	Taxable Value	Billed Tax	2025	2025-660097368	APARICIO, UBALDO & CARLOTA	40	253,249	0	26,968	2,642.00	2024	2024-660097368	APARICIO, UBALDO & CARLOTA	40	270,131	0	25,684	2,467.00	2023	2023-660097368	APARICIO, UBALDO & CARLOTA	40	241,658	0	24,461	2,292.00	2022	2022-660097368	APARICIO, UBALDO & CARLOTA	40	235,721	0	23,295	2,282.00	2021	2021-660097368	APARICIO, UBALDO & CARLOTA	40	202,191	0	22,186	2,146.00	2020	2020-660097368	APARICIO, UBALDO & CARLOTA	40	192,092	0	21,130	2,044.00	2019	2019-660097368	APARICIO, UBALDO & CARLOTA	40	184,290	0	20,272	1,963.00	2018	2018-660097368	APARICIO, UBALDO & CARLOTA	40	187,123	0	20,584	1,919.00	2017	2017-660097368	CAPITAL HOMES RES GRP LLC	40	5,129	0	564	53.00	2016	2016-660097368	CAPITAL HOMES RES GRP LLC	40	5,129	0	564	53.00	2015	2015-660097368	CAPITAL HOMES RES GRP LLC	40	5,129	0	564	54.00
Tax Year	Statement Number	Billed Owner	Tax Area	Total Value	Exemptions	Taxable Value	Billed Tax																																																																																																		
2025	2025-660097368	APARICIO, UBALDO & CARLOTA	40	253,249	0	26,968	2,642.00																																																																																																		
2024	2024-660097368	APARICIO, UBALDO & CARLOTA	40	270,131	0	25,684	2,467.00																																																																																																		
2023	2023-660097368	APARICIO, UBALDO & CARLOTA	40	241,658	0	24,461	2,292.00																																																																																																		
2022	2022-660097368	APARICIO, UBALDO & CARLOTA	40	235,721	0	23,295	2,282.00																																																																																																		
2021	2021-660097368	APARICIO, UBALDO & CARLOTA	40	202,191	0	22,186	2,146.00																																																																																																		
2020	2020-660097368	APARICIO, UBALDO & CARLOTA	40	192,092	0	21,130	2,044.00																																																																																																		
2019	2019-660097368	APARICIO, UBALDO & CARLOTA	40	184,290	0	20,272	1,963.00																																																																																																		
2018	2018-660097368	APARICIO, UBALDO & CARLOTA	40	187,123	0	20,584	1,919.00																																																																																																		
2017	2017-660097368	CAPITAL HOMES RES GRP LLC	40	5,129	0	564	53.00																																																																																																		
2016	2016-660097368	CAPITAL HOMES RES GRP LLC	40	5,129	0	564	53.00																																																																																																		
2015	2015-660097368	CAPITAL HOMES RES GRP LLC	40	5,129	0	564	54.00																																																																																																		



# Rogers

## Assessment Property Record Card for Tax Year 2026

Data provided by LISA DELOZIER County Assessor

Date 04/18/2026  
Time 08:56:29  
Page 2

Lot Data		Square-Foot - NBHD 1059 #1	
Lot Size	0	0	
Lot Count	1		
Units Buildable			
Non-Ag Acres	0.1386		
Topography			
Street Access			
Utilities			
Amenities			0
			0
Method	Square-Foot		
Base Lot Value	6,039.00 x 5.30 = 32,007		
Factor Value			
Adjustments	1.0000		
Lot Value	32,007		



\\tsclient\T\LOGAN\LOGAN RESIDENTIAL VI\2022-7-19\IMG\_0001 7/19/2022

Residential Data	
Type	1 Single Family Residence
Condition	3 - Average
Quality	3 - Average
Architecture	
Style	100% One Story
Exterior Wall	20% Veneer, Masonry 80% Frame, Siding, Wood
Base/Total Area	1,770 / 1,770
Style	100% One Story
HVAC	100% Warmed & Cooled Air
Roof Cover	1 Composition Shingle
Area on Slab	1,770
Fixture/RghIn	14 /
Bed/F/H Bath	4 / 2.0 / 1.0
Basement Area	
Garage Type	420 Attached Garage - Unfinished
Remodel	
Year/Eff Age	2017 / 7

GRM Approach	
GRM Code	
Gross Rent	0.00
Indicated Value	

Multiple Regression			
MRA Code	1	Test	
Adusted R	0.8445		
Indicated Value	243,276	137.44	Per SqFt

Direct Comparables			
Selection Model	A	Adam Test	
Adjustment Model	1	2022 Residential	
Comparables	8		
Indicated Value	246,350		Per SqFt

Cost Approach		Manual : 01/2025	
Base Cost	101.24	Total Misc Impr	+ 5,952
Roofing Adj	+ 4.71	Garage Cost	+ 14,049
Subfloor Adj	+ -2.39	Total RCN	= 245,198
Heat/Cool Adj	+ 12.64	Depreciation ( 7%)	- 17,164
Plumbing Adj	+ 11.03	Lump Sums	+ 0
Basement Adj	+ 0.00	RCNLD	= 228,034
Adj Base Cost	= 127.23	Lot Value	+ 32,007
Total Area	x 1,770	Indicated Value	= 260,041
Adjusted Cost	= 225,197	Value Per SqFt	146.92

Value Reconciliation			
Selected Approach	Cost Approach		
Improvements	228,034		
Lot Value	32,007		
Indicated Value	260,041	146.92	Per SqFt
Agland Value			
Site Improvements			
Total Value	260,041	146.92	Total Value Per SqFt

Miscellaneous Improvements								
Code	Description	Sketch ID	Size	Year	Units	Unit Cost	Depr	Value
PRCH	SLAB PORCH - COVERED	135524	16x8		128	26.53		3,396
PRCH	SLAB PORCH - COVERED	135526	96		96	26.63		2,556



# Rogers

## Assessment Property Record Card for Tax Year 2026

Data provided by LISA DELOZIER County Assessor

Date 04/18/2026  
 Time 08:56:29  
 Page 3

Sketch Image

660097368

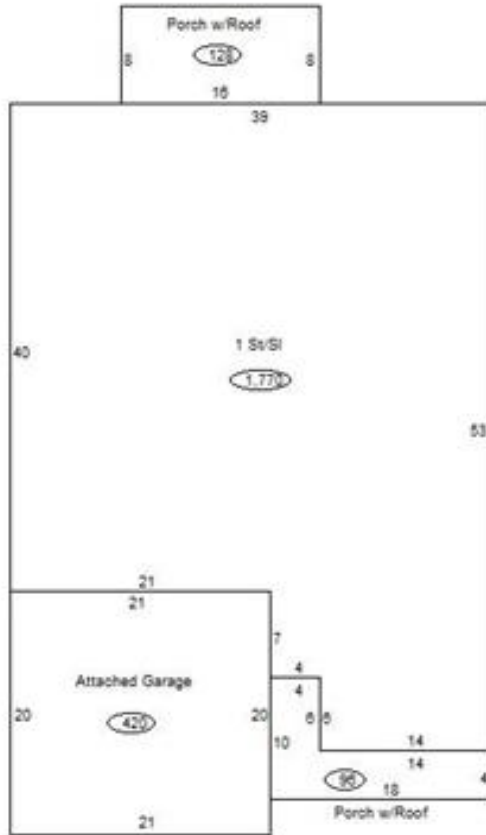

### Sketch Vector Information

Sequence	Code	Type	Built Over	Scale	Section Label	Base Area	Multiplier	Total Area
1	R	1	Slab	13	1 St/Sl	1,770	1.000	1,770
2	M	PRCH		13	SLBC	128	1.000	128
3	G	1		13	Attached Garage	420	1.000	420
4	M	PRCH		13	SLBC	96	1.000	96
<b>Total Building Area</b>						<b>1,770</b>		<b>1,770</b>