



# Rogers

## Assessment Property Record Card for Tax Year 2026

Data provided by LISA DELOZIER County Assessor

Date 04/18/2026  
Time 08:56:45  
Page 1

Assessment Data					Primary Image																																																																																																				
<b>Account</b> 660097377 <b>Parcel ID</b> 000000-00-0-00458-004-0009 <b>Cadastral ID</b> 10-21-14-06650 <b>Property Type</b> REAL - Real Property <b>Property Class</b> URP VI Area 4 <b>Tax Area</b> 40 - OWASSO CITY <b>Name ID</b> 317786 TOLLISON, BRIAN MARK  14618 E 111TH CT N OWASSO OK 74055-0000  <b>Parcel Location</b> <b>Situs</b> 14618 E 111TH CT N <b>Subdivision</b> LAKE VALLEY V PHASE II <b>Lot/Block</b> 0009 / 0004 <b>Parcel Size</b> 1 - Lots <b>Sec/Twn/Rng</b> 10 / 21 / 14 / 5 <b>Neighborhood</b> 1059 - R-V04-SW OWASSO <b>School District</b> S021 - OWASSO SCHOOLS																																																																																																									
<b>Legal Description</b> Lot/Long: 36.31627986 -95.80877074 LOT 9 BLOCK 4 LAKE VALLEY V PHASE II																																																																																																									
<b>Building Permits</b>					<table border="1"> <thead> <tr> <th>Number</th> <th>Description</th> <th>Opened</th> <th>Closed</th> <th>Amount</th> </tr> </thead> <tbody> <tr> <td>15-513X</td> <td>R16-NEW 1626 SQ FT SFR</td> <td>06/2015</td> <td>11/2015</td> <td>111,430</td> </tr> </tbody> </table>					Number	Description	Opened	Closed	Amount	15-513X	R16-NEW 1626 SQ FT SFR	06/2015	11/2015	111,430																																																																																						
Number	Description	Opened	Closed	Amount																																																																																																					
15-513X	R16-NEW 1626 SQ FT SFR	06/2015	11/2015	111,430																																																																																																					
<b>Exemptions</b>					<b>Sale History</b>																																																																																																				
<table border="1"> <thead> <tr> <th>Code</th> <th>Type</th> <th>Active</th> <th>Maximum</th> <th>Exemption</th> </tr> </thead> <tbody> <tr> <td></td> <td></td> <td></td> <td></td> <td></td> </tr> </tbody> </table>					Code	Type	Active	Maximum	Exemption						<table border="1"> <thead> <tr> <th>Bk/Pg</th> <th>Grantor</th> <th>Date</th> <th>Price</th> <th>Code</th> </tr> </thead> <tbody> <tr> <td>2535/394</td> <td>SIMMONS HOMES RESIDENTIAL</td> <td>03/11/2016</td> <td>180,500</td> <td>YES</td> </tr> <tr> <td>2442/257</td> <td>LAKE VALLEY INVESTMENT</td> <td>11/19/2014</td> <td>1,960,000</td> <td>15</td> </tr> </tbody> </table>					Bk/Pg	Grantor	Date	Price	Code	2535/394	SIMMONS HOMES RESIDENTIAL	03/11/2016	180,500	YES	2442/257	LAKE VALLEY INVESTMENT	11/19/2014	1,960,000	15																																																																							
Code	Type	Active	Maximum	Exemption																																																																																																					
Bk/Pg	Grantor	Date	Price	Code																																																																																																					
2535/394	SIMMONS HOMES RESIDENTIAL	03/11/2016	180,500	YES																																																																																																					
2442/257	LAKE VALLEY INVESTMENT	11/19/2014	1,960,000	15																																																																																																					
<b>Parcel Valuation</b>																																																																																																									
<table border="1"> <thead> <tr> <th>Source</th> <th>REAL</th> </tr> </thead> <tbody> <tr> <td>Remove Cap</td> <td>2017</td> </tr> <tr> <td>Year Frozen</td> <td></td> </tr> <tr> <td>Uncapped Value</td> <td>0</td> </tr> <tr> <td>TIF Project ID</td> <td>0</td> </tr> </tbody> </table>		Source	REAL	Remove Cap	2017	Year Frozen		Uncapped Value	0	TIF Project ID	0	<table border="1"> <thead> <tr> <th>Fair Cash</th> <th>Capped</th> <th>Asmnt Level</th> <th>Assessed</th> </tr> </thead> <tbody> <tr> <td>Land Value</td> <td>32,924</td> <td>32,924</td> <td>3,622</td> </tr> <tr> <td>Improvements</td> <td>219,304</td> <td>218,735</td> <td>24,061</td> </tr> <tr> <td>Mobile Home</td> <td>0</td> <td>0</td> <td>0</td> </tr> <tr> <td>Total Value</td> <td>252,228</td> <td>251,659</td> <td>27,683</td> </tr> </tbody> </table>			Fair Cash	Capped	Asmnt Level	Assessed	Land Value	32,924	32,924	3,622	Improvements	219,304	218,735	24,061	Mobile Home	0	0	0	Total Value	252,228	251,659	27,683	<table border="1"> <thead> <tr> <th>Levy Rate</th> <th>Current Tax</th> </tr> </thead> <tbody> <tr> <td>97.960</td> <td></td> </tr> <tr> <td>Assessed</td> <td>27,683</td> </tr> <tr> <td>Penalty</td> <td>0</td> </tr> <tr> <td>Exemption</td> <td>0</td> </tr> <tr> <td>Total Taxable</td> <td>27,683</td> </tr> </tbody> </table>		Levy Rate	Current Tax	97.960		Assessed	27,683	Penalty	0	Exemption	0	Total Taxable	27,683																																																									
Source	REAL																																																																																																								
Remove Cap	2017																																																																																																								
Year Frozen																																																																																																									
Uncapped Value	0																																																																																																								
TIF Project ID	0																																																																																																								
Fair Cash	Capped	Asmnt Level	Assessed																																																																																																						
Land Value	32,924	32,924	3,622																																																																																																						
Improvements	219,304	218,735	24,061																																																																																																						
Mobile Home	0	0	0																																																																																																						
Total Value	252,228	251,659	27,683																																																																																																						
Levy Rate	Current Tax																																																																																																								
97.960																																																																																																									
Assessed	27,683																																																																																																								
Penalty	0																																																																																																								
Exemption	0																																																																																																								
Total Taxable	27,683																																																																																																								
<b>Assessment History</b>																																																																																																									
<table border="1"> <thead> <tr> <th>Tax Year</th> <th>Statement Number</th> <th>Billed Owner</th> <th>Tax Area</th> <th>Total Value</th> <th>Exemptions</th> <th>Taxable Value</th> <th>Billed Tax</th> </tr> </thead> <tbody> <tr><td>2025</td><td>2025-660097377</td><td>TOLLISON, BRIAN MARK</td><td>40</td><td>243,393</td><td>0</td><td>26,365</td><td>2,583.00</td></tr> <tr><td>2024</td><td>2024-660097377</td><td>TOLLISON, BRIAN MARK</td><td>40</td><td>260,550</td><td>0</td><td>25,109</td><td>2,412.00</td></tr> <tr><td>2023</td><td>2023-660097377</td><td>TOLLISON, BRIAN MARK</td><td>40</td><td>233,797</td><td>0</td><td>23,914</td><td>2,241.00</td></tr> <tr><td>2022</td><td>2022-660097377</td><td>TOLLISON, BRIAN MARK</td><td>40</td><td>231,499</td><td>0</td><td>22,775</td><td>2,231.00</td></tr> <tr><td>2021</td><td>2021-660097377</td><td>TOLLISON, BRIAN MARK</td><td>40</td><td>198,459</td><td>0</td><td>21,690</td><td>2,098.00</td></tr> <tr><td>2020</td><td>2020-660097377</td><td>TOLLISON, BRIAN MARK</td><td>40</td><td>187,794</td><td>0</td><td>20,657</td><td>1,998.00</td></tr> <tr><td>2019</td><td>2019-660097377</td><td>TOLLISON, BRIAN MARK</td><td>40</td><td>178,866</td><td>1000</td><td>18,675</td><td>1,808.00</td></tr> <tr><td>2018</td><td>2018-660097377</td><td>TOLLISON, BRIAN MARK</td><td>40</td><td>183,326</td><td>1000</td><td>19,166</td><td>1,787.00</td></tr> <tr><td>2017</td><td>2017-660097377</td><td>TOLLISON, BRIAN MARK</td><td>40</td><td>181,908</td><td>1000</td><td>19,010</td><td>1,789.00</td></tr> <tr><td>2016</td><td>2016-660097377</td><td>TOLLISON, BRIAN MARK</td><td>40</td><td>143,802</td><td>0</td><td>6,758</td><td>639.00</td></tr> <tr><td>2015</td><td>2015-660097377</td><td>SIMMONS HOMES RESIDENTIAL</td><td>40</td><td>5,129</td><td>0</td><td>564</td><td>54.00</td></tr> </tbody> </table>										Tax Year	Statement Number	Billed Owner	Tax Area	Total Value	Exemptions	Taxable Value	Billed Tax	2025	2025-660097377	TOLLISON, BRIAN MARK	40	243,393	0	26,365	2,583.00	2024	2024-660097377	TOLLISON, BRIAN MARK	40	260,550	0	25,109	2,412.00	2023	2023-660097377	TOLLISON, BRIAN MARK	40	233,797	0	23,914	2,241.00	2022	2022-660097377	TOLLISON, BRIAN MARK	40	231,499	0	22,775	2,231.00	2021	2021-660097377	TOLLISON, BRIAN MARK	40	198,459	0	21,690	2,098.00	2020	2020-660097377	TOLLISON, BRIAN MARK	40	187,794	0	20,657	1,998.00	2019	2019-660097377	TOLLISON, BRIAN MARK	40	178,866	1000	18,675	1,808.00	2018	2018-660097377	TOLLISON, BRIAN MARK	40	183,326	1000	19,166	1,787.00	2017	2017-660097377	TOLLISON, BRIAN MARK	40	181,908	1000	19,010	1,789.00	2016	2016-660097377	TOLLISON, BRIAN MARK	40	143,802	0	6,758	639.00	2015	2015-660097377	SIMMONS HOMES RESIDENTIAL	40	5,129	0	564	54.00
Tax Year	Statement Number	Billed Owner	Tax Area	Total Value	Exemptions	Taxable Value	Billed Tax																																																																																																		
2025	2025-660097377	TOLLISON, BRIAN MARK	40	243,393	0	26,365	2,583.00																																																																																																		
2024	2024-660097377	TOLLISON, BRIAN MARK	40	260,550	0	25,109	2,412.00																																																																																																		
2023	2023-660097377	TOLLISON, BRIAN MARK	40	233,797	0	23,914	2,241.00																																																																																																		
2022	2022-660097377	TOLLISON, BRIAN MARK	40	231,499	0	22,775	2,231.00																																																																																																		
2021	2021-660097377	TOLLISON, BRIAN MARK	40	198,459	0	21,690	2,098.00																																																																																																		
2020	2020-660097377	TOLLISON, BRIAN MARK	40	187,794	0	20,657	1,998.00																																																																																																		
2019	2019-660097377	TOLLISON, BRIAN MARK	40	178,866	1000	18,675	1,808.00																																																																																																		
2018	2018-660097377	TOLLISON, BRIAN MARK	40	183,326	1000	19,166	1,787.00																																																																																																		
2017	2017-660097377	TOLLISON, BRIAN MARK	40	181,908	1000	19,010	1,789.00																																																																																																		
2016	2016-660097377	TOLLISON, BRIAN MARK	40	143,802	0	6,758	639.00																																																																																																		
2015	2015-660097377	SIMMONS HOMES RESIDENTIAL	40	5,129	0	564	54.00																																																																																																		



# Rogers

## Assessment Property Record Card for Tax Year 2026

Data provided by LISA DELOZIER County Assessor

Date 04/18/2026  
Time 08:56:45  
Page 2

Lot Data		Square-Foot - NBHD 1059 #1	
Lot Size	0	0	
Lot Count	1		
Units Buildable			
Non-Ag Acres	0.1426		
Topography			
Street Access			
Utilities			
Amenities		0	
		0	
Method	Square-Foot		
Base Lot Value	6,212.00 x 5.30 = 32,924		
Factor Value			
Adjustments	1.0000		
Lot Value	32,924		



\\tsclient\T\LOGAN\LOGAN RESIDENTIAL VI\2022-7-20\IMG\_002! 7/20/2022

Residential Data	
Type	1 Single Family Residence
Condition	3 - Average
Quality	3 - Average
Architecture	
Style	100% One Story
Exterior Wall	95% Veneer, Masonry 5% Frame, Siding, Wood
Base/Total Area	1,626 / 1,626
Style	100% One Story
HVAC	100% Warmed & Cooled Air
Roof Cover	1 Composition Shingle
Area on Slab	1,626
Fixture/RghIn	11 /
Bed/F/H Bath	3 / 2.0 /
Basement Area	
Garage Type	400 Attached Garage - Unfinished
Remodel	
Year/Eff Age	2015 / 8

### GRM Approach

GRM Code	
Gross Rent	0.00
Indicated Value	

### Multiple Regression

MRA Code	1 Test
Adusted R	0.8445
Indicated Value	226,810 139.49 Per SqFt

### Direct Comparables

Selection Model	A Adam Test
Adjustment Model	1 2022 Residential
Comparables	8
Indicated Value	235,990 Per SqFt

### Value Reconciliation

Selected Approach	Cost Approach
Improvements	219,304
Lot Value	32,924
Indicated Value	252,228 155.12 Per SqFt
Agland Value	
Site Improvements	
Total Value	252,228 155.12 Total Value Per SqFt

Cost Approach		Manual : 01/2025	
Base Cost	111.70	Total Misc Impr	+ 2,890
Roofing Adj	+ 4.90	Garage Cost	+ 13,584
Subfloor Adj	+ -2.31	Total RCN	= 238,374
Heat/Cool Adj	+ 12.64	Depreciation ( 8%)	- 19,070
Plumbing Adj	+ 9.54	Lump Sums	+ 0
Basement Adj	+ 0.00	RCNLD	= 219,304
Adj Base Cost	= 136.47	Lot Value	+ 32,924
Total Area	x 1,626	Indicated Value	= 252,228
Adjusted Cost	= 221,900	Value Per SqFt	155.12

### Miscellaneous Improvements

Code	Description	Sketch ID	Size	Year	Units	Unit Cost	Depr	Value
PRCH	SLAB PORCH - COVERED	125908	14x4		56	26.75		1,498
PRCH	SLAB PORCH - COVERED	125910	52		52	26.77		1,392



# Rogers

## Assessment Property Record Card for Tax Year 2026

Data provided by LISA DELOZIER County Assessor

Date 04/18/2026  
 Time 08:56:45  
 Page 3

Sketch Image

660097377

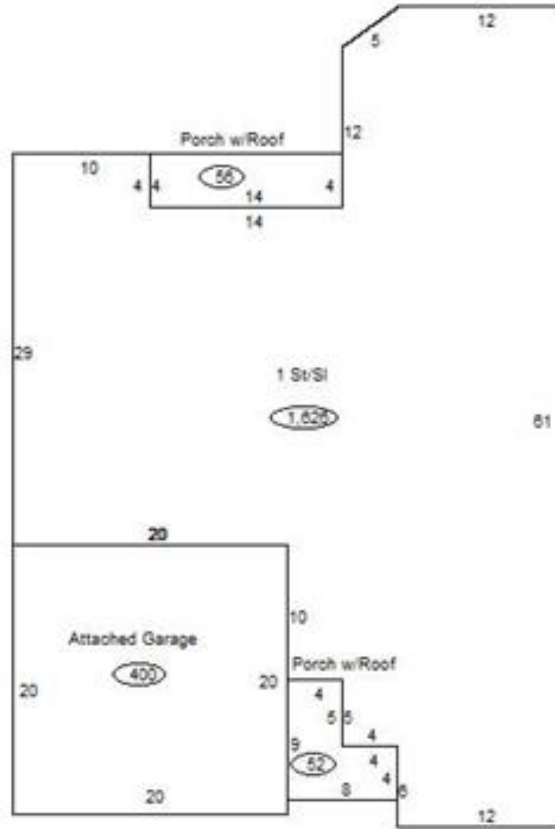

### Sketch Vector Information

Sequence	Code	Type	Built Over	Scale	Section Label	Base Area	Multiplier	Total Area
1	R	1	Slab	13	1 St/SI	1,626	1.000	1,626
2	M	PRCH		13	SLBC	56	1.000	56
3	G	1		13	Attached Garage	400	1.000	400
4	M	PRCH		13	SLBC	52	1.000	52
<b>Total Building Area</b>						1,626		1,626