



# Rogers

## Assessment Property Record Card for Tax Year 2026

Data provided by LISA DELOZIER County Assessor

Date 04/18/2026  
Time 08:58:01  
Page 1

Assessment Data					Primary Image																																																																																																				
<b>Account</b> 660097418 <b>Parcel ID</b> 000000-00-0-00458-006-0001 <b>Cadastral ID</b> 10-21-14-07060 <b>Property Type</b> REAL - Real Property <b>Property Class</b> URP VI Area 4 <b>Tax Area</b> 40 - OWASSO CITY <b>Name ID</b> 320967 CASTILLO, RICARDO J VILLASANA  14602 E 113TH ST N OWASSO OK 74055-0000  <b>Parcel Location</b> <b>Situs</b> 14602 E 113TH ST N <b>Subdivision</b> LAKE VALLEY V PHASE II <b>Lot/Block</b> 0001 / 0006 Parcel Size 1 - Lots <b>Sec/Twn/Rng</b> 10 / 21 / 14 / 5 <b>Neighborhood</b> 1059 - R-V04-SW OWASSO <b>School District</b> S021 - OWASSO SCHOOLS																																																																																																									
<b>Legal Description</b> Lat/Long: 36.31794099 -95.81051103 LOT 1 BLOCK 6 LAKE VALLEY V PHASE II																																																																																																									
<b>Exemptions</b> <table border="1"> <thead> <tr> <th>Code</th> <th>Type</th> <th>Active</th> <th>Maximum</th> <th>Exemption</th> </tr> </thead> <tbody> <tr> <td>H</td> <td>Homestead</td> <td>Yes</td> <td>1,000</td> <td>1,000</td> </tr> </tbody> </table>					Code	Type	Active	Maximum	Exemption	H	Homestead	Yes	1,000	1,000	<b>Building Permits</b> <table border="1"> <thead> <tr> <th>Number</th> <th>Description</th> <th>Opened</th> <th>Closed</th> <th>Amount</th> </tr> </thead> <tbody> <tr> <td>16-1002X</td> <td>R18-NEW 1766 SQ FT SFR</td> <td>11/2016</td> <td>07/2017</td> <td>121,660</td> </tr> </tbody> </table>					Number	Description	Opened	Closed	Amount	16-1002X	R18-NEW 1766 SQ FT SFR	11/2016	07/2017	121,660																																																																												
Code	Type	Active	Maximum	Exemption																																																																																																					
H	Homestead	Yes	1,000	1,000																																																																																																					
Number	Description	Opened	Closed	Amount																																																																																																					
16-1002X	R18-NEW 1766 SQ FT SFR	11/2016	07/2017	121,660																																																																																																					
<b>Parcel Valuation</b> <table border="1"> <thead> <tr> <th>Source</th> <th>REAL</th> <th>Fair Cash</th> <th>Capped</th> <th>Asmnt Level</th> <th>Assessed</th> <th>Levy Rate</th> <th>97.960</th> <th>Current Tax</th> </tr> </thead> <tbody> <tr> <td>Remove Cap</td> <td>2018</td> <td>Land Value</td> <td>38,483</td> <td>37,669</td> <td>11%</td> <td>4,144</td> <td>Assessed</td> <td>23,659 2,317.64</td> </tr> <tr> <td>Year Frozen</td> <td></td> <td>Improvements</td> <td>224,775</td> <td>177,407</td> <td></td> <td>19,515</td> <td>Penalty</td> <td>0</td> </tr> <tr> <td>Uncapped Value</td> <td>0</td> <td>Mobile Home</td> <td>0</td> <td>0</td> <td></td> <td>0</td> <td>Exemption</td> <td>1,000 -98.00</td> </tr> <tr> <td>TIF Project ID</td> <td>0</td> <td>Total Value</td> <td>263,258</td> <td>215,076</td> <td></td> <td>23,659</td> <td>Total Taxable</td> <td>22,659 2,220.00</td> </tr> </tbody> </table>					Source	REAL	Fair Cash	Capped	Asmnt Level	Assessed	Levy Rate	97.960	Current Tax	Remove Cap	2018	Land Value	38,483	37,669	11%	4,144	Assessed	23,659 2,317.64	Year Frozen		Improvements	224,775	177,407		19,515	Penalty	0	Uncapped Value	0	Mobile Home	0	0		0	Exemption	1,000 -98.00	TIF Project ID	0	Total Value	263,258	215,076		23,659	Total Taxable	22,659 2,220.00	<b>Sale History</b> <table border="1"> <thead> <tr> <th>Bk/Pg</th> <th>Grantor</th> <th>Date</th> <th>Price</th> <th>Code</th> </tr> </thead> <tbody> <tr> <td>2620/889</td> <td>CAPITAL HOMES RES GRP LLC</td> <td>03/24/2017</td> <td>177,000</td> <td>YES</td> </tr> <tr> <td>2446/353</td> <td>LAKE VALLEY INVESTMENT</td> <td>12/19/2014</td> <td>0</td> <td>4</td> </tr> </tbody> </table>					Bk/Pg	Grantor	Date	Price	Code	2620/889	CAPITAL HOMES RES GRP LLC	03/24/2017	177,000	YES	2446/353	LAKE VALLEY INVESTMENT	12/19/2014	0	4																																				
Source	REAL	Fair Cash	Capped	Asmnt Level	Assessed	Levy Rate	97.960	Current Tax																																																																																																	
Remove Cap	2018	Land Value	38,483	37,669	11%	4,144	Assessed	23,659 2,317.64																																																																																																	
Year Frozen		Improvements	224,775	177,407		19,515	Penalty	0																																																																																																	
Uncapped Value	0	Mobile Home	0	0		0	Exemption	1,000 -98.00																																																																																																	
TIF Project ID	0	Total Value	263,258	215,076		23,659	Total Taxable	22,659 2,220.00																																																																																																	
Bk/Pg	Grantor	Date	Price	Code																																																																																																					
2620/889	CAPITAL HOMES RES GRP LLC	03/24/2017	177,000	YES																																																																																																					
2446/353	LAKE VALLEY INVESTMENT	12/19/2014	0	4																																																																																																					
<b>Assessment History</b> <table border="1"> <thead> <tr> <th>Tax Year</th> <th>Statement Number</th> <th>Billed Owner</th> <th>Tax Area</th> <th>Total Value</th> <th>Exemptions</th> <th>Taxable Value</th> <th>Billed Tax</th> </tr> </thead> <tbody> <tr><td>2025</td><td>2025-660097418</td><td>CASTILLO, RICARDO J VILLASANA</td><td>40</td><td>256,438</td><td>1000</td><td>21,969</td><td>2,152.00</td></tr> <tr><td>2024</td><td>2024-660097418</td><td>CASTILLO, RICARDO J VILLASANA</td><td>40</td><td>273,587</td><td>1000</td><td>21,301</td><td>2,046.00</td></tr> <tr><td>2023</td><td>2023-660097418</td><td>CASTILLO, RICARDO J VILLASANA</td><td>40</td><td>238,546</td><td>1000</td><td>20,651</td><td>1,935.00</td></tr> <tr><td>2022</td><td>2022-660097418</td><td>CASTILLO, RICARDO J VILLASANA</td><td>40</td><td>224,425</td><td>1000</td><td>20,021</td><td>1,961.00</td></tr> <tr><td>2021</td><td>2021-660097418</td><td>CASTILLO, RICARDO J VILLASANA</td><td>40</td><td>192,070</td><td>1000</td><td>19,408</td><td>1,878.00</td></tr> <tr><td>2020</td><td>2020-660097418</td><td>CASTILLO, RICARDO J VILLASANA</td><td>40</td><td>182,154</td><td>1000</td><td>18,814</td><td>1,820.00</td></tr> <tr><td>2019</td><td>2019-660097418</td><td>CASTILLO, RICARDO J VILLASANA</td><td>40</td><td>174,881</td><td>1000</td><td>18,237</td><td>1,766.00</td></tr> <tr><td>2018</td><td>2018-660097418</td><td>CASTILLO, RICARDO J VILLASANA</td><td>40</td><td>177,552</td><td>1000</td><td>18,531</td><td>1,728.00</td></tr> <tr><td>2017</td><td>2017-660097418</td><td>CASTILLO, RICARDO J VILLASANA</td><td>40</td><td>30,000</td><td>0</td><td>622</td><td>59.00</td></tr> <tr><td>2016</td><td>2016-660097418</td><td>CAPITAL HOMES RES GRP LLC</td><td>40</td><td>30,000</td><td>0</td><td>592</td><td>56.00</td></tr> <tr><td>2015</td><td>2015-660097418</td><td>CAPITAL HOMES RES GRP LLC</td><td>40</td><td>5,129</td><td>0</td><td>564</td><td>54.00</td></tr> </tbody> </table>										Tax Year	Statement Number	Billed Owner	Tax Area	Total Value	Exemptions	Taxable Value	Billed Tax	2025	2025-660097418	CASTILLO, RICARDO J VILLASANA	40	256,438	1000	21,969	2,152.00	2024	2024-660097418	CASTILLO, RICARDO J VILLASANA	40	273,587	1000	21,301	2,046.00	2023	2023-660097418	CASTILLO, RICARDO J VILLASANA	40	238,546	1000	20,651	1,935.00	2022	2022-660097418	CASTILLO, RICARDO J VILLASANA	40	224,425	1000	20,021	1,961.00	2021	2021-660097418	CASTILLO, RICARDO J VILLASANA	40	192,070	1000	19,408	1,878.00	2020	2020-660097418	CASTILLO, RICARDO J VILLASANA	40	182,154	1000	18,814	1,820.00	2019	2019-660097418	CASTILLO, RICARDO J VILLASANA	40	174,881	1000	18,237	1,766.00	2018	2018-660097418	CASTILLO, RICARDO J VILLASANA	40	177,552	1000	18,531	1,728.00	2017	2017-660097418	CASTILLO, RICARDO J VILLASANA	40	30,000	0	622	59.00	2016	2016-660097418	CAPITAL HOMES RES GRP LLC	40	30,000	0	592	56.00	2015	2015-660097418	CAPITAL HOMES RES GRP LLC	40	5,129	0	564	54.00
Tax Year	Statement Number	Billed Owner	Tax Area	Total Value	Exemptions	Taxable Value	Billed Tax																																																																																																		
2025	2025-660097418	CASTILLO, RICARDO J VILLASANA	40	256,438	1000	21,969	2,152.00																																																																																																		
2024	2024-660097418	CASTILLO, RICARDO J VILLASANA	40	273,587	1000	21,301	2,046.00																																																																																																		
2023	2023-660097418	CASTILLO, RICARDO J VILLASANA	40	238,546	1000	20,651	1,935.00																																																																																																		
2022	2022-660097418	CASTILLO, RICARDO J VILLASANA	40	224,425	1000	20,021	1,961.00																																																																																																		
2021	2021-660097418	CASTILLO, RICARDO J VILLASANA	40	192,070	1000	19,408	1,878.00																																																																																																		
2020	2020-660097418	CASTILLO, RICARDO J VILLASANA	40	182,154	1000	18,814	1,820.00																																																																																																		
2019	2019-660097418	CASTILLO, RICARDO J VILLASANA	40	174,881	1000	18,237	1,766.00																																																																																																		
2018	2018-660097418	CASTILLO, RICARDO J VILLASANA	40	177,552	1000	18,531	1,728.00																																																																																																		
2017	2017-660097418	CASTILLO, RICARDO J VILLASANA	40	30,000	0	622	59.00																																																																																																		
2016	2016-660097418	CAPITAL HOMES RES GRP LLC	40	30,000	0	592	56.00																																																																																																		
2015	2015-660097418	CAPITAL HOMES RES GRP LLC	40	5,129	0	564	54.00																																																																																																		



# Rogers

## Assessment Property Record Card for Tax Year 2026

Data provided by LISA DELOZIER County Assessor

Date 04/18/2026  
 Time 08:58:01  
 Page 2

Lot Data		Square-Foot - NBHD 1059 #1	
Lot Size	0	0	
Lot Count	1		
Units Buildable			
Non-Ag Acres	0.1667		
Topography			
Street Access			
Utilities			
Amenities			0
			0
Method	Square-Foot		
Base Lot Value	7,261.00 x 5.30 = 38,483		
Factor Value			
Adjustments	1.0000		
Lot Value	38,483		



\\tsclient\T\LOGAN\LOGAN RESIDENTIAL VI\2022-7-21\IMG\_002: 7/21/2022

Residential Data	
Type	1 Single Family Residence
Condition	3 - Average
Quality	3 - Average
Architecture	
Style	100% One Story
Exterior Wall	10% Veneer, Masonry 90% Frame, Siding, Wood
Base/Total Area	1,770 / 1,770
Style	100% One Story
HVAC	100% Warmed & Cooled Air
Roof Cover	1 Composition Shingle
Area on Slab	1,770
Fixture/RghIn	11 /
Bed/F/H Bath	4 / 2.0 /
Basement Area	
Garage Type	504 Attached Garage - Unfinished
Remodel	
Year/Eff Age	2017 / 7

### GRM Approach

GRM Code	
Gross Rent	0.00
Indicated Value	

### Multiple Regression

MRA Code	1 Test
Adjusted R	0.8445
Indicated Value	250,783 141.69 Per SqFt

### Direct Comparables

Selection Model	A Adam Test
Adjustment Model	1 2022 Residential
Comparables	8
Indicated Value	253,510 Per SqFt

### Value Reconciliation

Selected Approach	Cost Approach
Improvements	224,775
Lot Value	38,483
Indicated Value	263,258 148.73 Per SqFt
Agland Value	
Site Improvements	
Total Value	263,258 148.73 Total Value Per SqFt

### Cost Approach Manual : 01/2025

Base Cost	100.41	Total Misc Impr	+	5,952
Roofing Adj	+ 4.71	Garage Cost	+	16,032
Subfloor Adj	+ -2.39	Total RCN	=	241,694
Heat/Cool Adj	+ 12.64	Depreciation ( 7%)	-	16,919
Plumbing Adj	+ 8.76	Lump Sums	+	0
Basement Adj	+ 0.00	RCNLD	=	224,775
Adj Base Cost	= 124.13	Lot Value	+	38,483
Total Area	x 1,770	Indicated Value	=	263,258
Adjusted Cost	= 219,710	Value Per SqFt		148.73

### Miscellaneous Improvements

Code	Description	Sketch ID	Size	Year	Units	Unit Cost	Depr	Value
PRCH	SLAB PORCH - COVERED	134645	16x8		128	26.53		3,396
PRCH	SLAB PORCH - COVERED	134647	96		96	26.63		2,556



# Rogers

## Assessment Property Record Card for Tax Year 2026

Data provided by LISA DELOZIER County Assessor

Date 04/18/2026

Time 08:58:01

Page 3

### Sketch Image

660097418

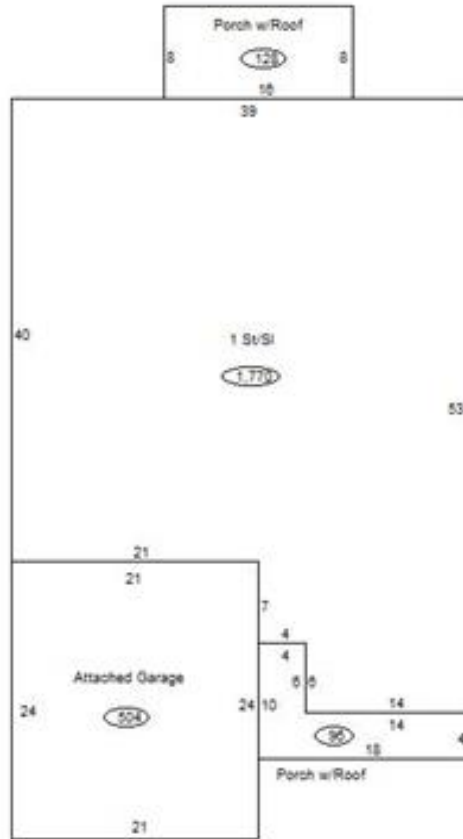

### Sketch Vector Information

Sequence	Code	Type	Built Over	Scale	Section Label	Base Area	Multiplier	Total Area
1	R	1	Slab	13	1 St/Sl	1,770	1.000	1,770
2	M	PRCH		13	SLBC	128	1.000	128
3	G	1		13	Attached Garage	504	1.000	504
4	M	PRCH		13	SLBC	96	1.000	96
<b>Total Building Area</b>						<b>1,770</b>		<b>1,770</b>