



# Rogers

## Assessment Property Record Card for Tax Year 2026

Data provided by LISA DELOZIER County Assessor

Date 04/18/2026  
Time 09:05:10  
Page 1

Assessment Data					Primary Image																																																																																												
<b>Account</b> 660098352 <b>Parcel ID</b> 22N16E-24-4-00000-000-0001 <b>Cadastral ID</b> 24-22-16-02122 <b>Property Type</b> REAL - Real Property <b>Property Class</b> RR VI Area 1 <b>Tax Area</b> 75 - SEQUOYAH/FOYIL FD <b>Name ID</b> 316600 BULMAN, BARRY & DAWN  15815 E 450 RD CLAREMORE OK 74017-  <b>Parcel Location</b> <b>Situs</b> 15815 E 450 RD <b>Subdivision</b> <b>Lot/Block</b> / <b>Parcel Size</b> 5 - Acres <b>Sec/Twn/Rng</b> 24 / 22 / 16 / 4 <b>Neighborhood</b> 6050 - UNPLATTED <b>School District</b> S006 - SEQUOYAH SCHOOLS																																																																																																	
<b>Legal Description</b> Lat/Long: 36.36627567 -95.54592229										<b>Building Permits</b> <table border="1"> <thead> <tr> <th>Number</th> <th>Description</th> <th>Opened</th> <th>Closed</th> <th>Amount</th> </tr> </thead> <tbody> <tr> <td>R22 508</td> <td>R23 NEW DTCH ACC BLDG 30X40</td> <td>12/2022</td> <td>04/2023</td> <td>20,000</td> </tr> </tbody> </table>					Number	Description	Opened	Closed	Amount	R22 508	R23 NEW DTCH ACC BLDG 30X40	12/2022	04/2023	20,000																																																																									
Number	Description	Opened	Closed	Amount																																																																																													
R22 508	R23 NEW DTCH ACC BLDG 30X40	12/2022	04/2023	20,000																																																																																													
<b>Exemptions</b> <table border="1"> <thead> <tr> <th>Code</th> <th>Type</th> <th>Active</th> <th>Maximum</th> <th>Exemption</th> </tr> </thead> <tbody> <tr> <td>E2 SW SE SE</td> <td></td> <td></td> <td></td> <td></td> </tr> </tbody> </table>					Code	Type	Active	Maximum	Exemption	E2 SW SE SE					<b>Sale History</b> <table border="1"> <thead> <tr> <th>Bk/Pg</th> <th>Grantor</th> <th>Date</th> <th>Price</th> <th>Code</th> </tr> </thead> <tbody> <tr> <td>2504/614</td> <td>HARRISON, ROY &amp;</td> <td>09/14/2015</td> <td>160,000</td> <td>YES</td> </tr> </tbody> </table>					Bk/Pg	Grantor	Date	Price	Code	2504/614	HARRISON, ROY &	09/14/2015	160,000	YES																																																																				
Code	Type	Active	Maximum	Exemption																																																																																													
E2 SW SE SE																																																																																																	
Bk/Pg	Grantor	Date	Price	Code																																																																																													
2504/614	HARRISON, ROY &	09/14/2015	160,000	YES																																																																																													
<b>Parcel Valuation</b> <table border="1"> <thead> <tr> <th>Source</th> <th>REAL</th> <th>Fair Cash</th> <th>Capped</th> <th>Asmnt Level</th> <th>Assessed</th> <th>Levy Rate</th> <th>101.310</th> <th>Current Tax</th> </tr> </thead> <tbody> <tr> <td>Remove Cap</td> <td>0</td> <td>Land Value 72,786</td> <td>66,468</td> <td>11%</td> <td>7,311</td> <td>Assessed</td> <td>41,147</td> <td>4,168.60</td> </tr> <tr> <td>Year Frozen</td> <td>0</td> <td>Improvements 336,919</td> <td>307,599</td> <td></td> <td>33,836</td> <td>Penalty</td> <td>0</td> <td></td> </tr> <tr> <td>Uncapped Value</td> <td>0</td> <td>Mobile Home 0</td> <td>0</td> <td></td> <td>0</td> <td>Exemption</td> <td>0</td> <td>0.00</td> </tr> <tr> <td>TIF Project ID</td> <td>0</td> <td>Total Value 409,705</td> <td>374,067</td> <td></td> <td>41,147</td> <td>Total Taxable</td> <td>41,147</td> <td>4,169.00</td> </tr> </tbody> </table>										Source	REAL	Fair Cash	Capped	Asmnt Level	Assessed	Levy Rate	101.310	Current Tax	Remove Cap	0	Land Value 72,786	66,468	11%	7,311	Assessed	41,147	4,168.60	Year Frozen	0	Improvements 336,919	307,599		33,836	Penalty	0		Uncapped Value	0	Mobile Home 0	0		0	Exemption	0	0.00	TIF Project ID	0	Total Value 409,705	374,067		41,147	Total Taxable	41,147	4,169.00																																											
Source	REAL	Fair Cash	Capped	Asmnt Level	Assessed	Levy Rate	101.310	Current Tax																																																																																									
Remove Cap	0	Land Value 72,786	66,468	11%	7,311	Assessed	41,147	4,168.60																																																																																									
Year Frozen	0	Improvements 336,919	307,599		33,836	Penalty	0																																																																																										
Uncapped Value	0	Mobile Home 0	0		0	Exemption	0	0.00																																																																																									
TIF Project ID	0	Total Value 409,705	374,067		41,147	Total Taxable	41,147	4,169.00																																																																																									
<b>Assessment History</b> <table border="1"> <thead> <tr> <th>Tax Year</th> <th>Statement Number</th> <th>Billed Owner</th> <th>Tax Area</th> <th>Total Value</th> <th>Exemptions</th> <th>Taxable Value</th> <th>Billed Tax</th> </tr> </thead> <tbody> <tr> <td>2025</td> <td>2025-660098352</td> <td>BULMAN, BARRY &amp; DAWN</td> <td>75</td> <td>377,499</td> <td>0</td> <td>39,187</td> <td>3,970.00</td> </tr> <tr> <td>2024</td> <td>2024-660098352</td> <td>BULMAN, BARRY &amp; DAWN</td> <td>75</td> <td>388,358</td> <td>0</td> <td>37,322</td> <td>3,803.00</td> </tr> <tr> <td>2023</td> <td>2023-660098352</td> <td>BULMAN, BARRY &amp; DAWN</td> <td>75</td> <td>292,401</td> <td>0</td> <td>31,782</td> <td>3,310.00</td> </tr> <tr> <td>2022</td> <td>2022-660098352</td> <td>BULMAN, BARRY &amp; DAWN</td> <td>75</td> <td>288,571</td> <td>0</td> <td>30,269</td> <td>3,217.00</td> </tr> <tr> <td>2021</td> <td>2021-660098352</td> <td>BULMAN, BARRY &amp; DAWN</td> <td>75</td> <td>262,068</td> <td>0</td> <td>28,827</td> <td>2,976.00</td> </tr> <tr> <td>2020</td> <td>2020-660098352</td> <td>BULMAN, BARRY &amp; DAWN</td> <td>75</td> <td>256,313</td> <td>0</td> <td>28,194</td> <td>3,018.00</td> </tr> <tr> <td>2019</td> <td>2019-660098352</td> <td>BULMAN, BARRY &amp; DAWN</td> <td>75</td> <td>246,950</td> <td>0</td> <td>27,164</td> <td>2,883.00</td> </tr> <tr> <td>2018</td> <td>2018-660098352</td> <td>BULMAN, BARRY &amp; DAWN</td> <td>75</td> <td>253,967</td> <td>0</td> <td>27,936</td> <td>2,980.00</td> </tr> <tr> <td>2017</td> <td>2017-660098352</td> <td>BULMAN, BARRY &amp; DAWN</td> <td>75</td> <td>251,554</td> <td>0</td> <td>27,671</td> <td>2,932.00</td> </tr> <tr> <td>2016</td> <td>2016-660098352</td> <td>BULMAN, BARRY &amp; DAWN</td> <td>75</td> <td>245,183</td> <td>0</td> <td>26,970</td> <td>2,853.00</td> </tr> </tbody> </table>										Tax Year	Statement Number	Billed Owner	Tax Area	Total Value	Exemptions	Taxable Value	Billed Tax	2025	2025-660098352	BULMAN, BARRY & DAWN	75	377,499	0	39,187	3,970.00	2024	2024-660098352	BULMAN, BARRY & DAWN	75	388,358	0	37,322	3,803.00	2023	2023-660098352	BULMAN, BARRY & DAWN	75	292,401	0	31,782	3,310.00	2022	2022-660098352	BULMAN, BARRY & DAWN	75	288,571	0	30,269	3,217.00	2021	2021-660098352	BULMAN, BARRY & DAWN	75	262,068	0	28,827	2,976.00	2020	2020-660098352	BULMAN, BARRY & DAWN	75	256,313	0	28,194	3,018.00	2019	2019-660098352	BULMAN, BARRY & DAWN	75	246,950	0	27,164	2,883.00	2018	2018-660098352	BULMAN, BARRY & DAWN	75	253,967	0	27,936	2,980.00	2017	2017-660098352	BULMAN, BARRY & DAWN	75	251,554	0	27,671	2,932.00	2016	2016-660098352	BULMAN, BARRY & DAWN	75	245,183	0	26,970	2,853.00
Tax Year	Statement Number	Billed Owner	Tax Area	Total Value	Exemptions	Taxable Value	Billed Tax																																																																																										
2025	2025-660098352	BULMAN, BARRY & DAWN	75	377,499	0	39,187	3,970.00																																																																																										
2024	2024-660098352	BULMAN, BARRY & DAWN	75	388,358	0	37,322	3,803.00																																																																																										
2023	2023-660098352	BULMAN, BARRY & DAWN	75	292,401	0	31,782	3,310.00																																																																																										
2022	2022-660098352	BULMAN, BARRY & DAWN	75	288,571	0	30,269	3,217.00																																																																																										
2021	2021-660098352	BULMAN, BARRY & DAWN	75	262,068	0	28,827	2,976.00																																																																																										
2020	2020-660098352	BULMAN, BARRY & DAWN	75	256,313	0	28,194	3,018.00																																																																																										
2019	2019-660098352	BULMAN, BARRY & DAWN	75	246,950	0	27,164	2,883.00																																																																																										
2018	2018-660098352	BULMAN, BARRY & DAWN	75	253,967	0	27,936	2,980.00																																																																																										
2017	2017-660098352	BULMAN, BARRY & DAWN	75	251,554	0	27,671	2,932.00																																																																																										
2016	2016-660098352	BULMAN, BARRY & DAWN	75	245,183	0	26,970	2,853.00																																																																																										



# Rogers

## Assessment Property Record Card for Tax Year 2026

Data provided by LISA DELOZIER County Assessor

Date 04/18/2026  
 Time 09:05:11  
 Page 2

Lot Data		Square-Foot - NBHD 6050 #1
Lot Size		
Lot Count		
Units Buildable		
Non-Ag Acres	5.1047	
Topography		
Street Access		
Utilities		
Amenities	LAND QUALITY	0
		0
Method	Square-Foot	
Base Lot Value	222,359.00 x .33 = 72,786	
Factor Value		
Adjustments	1.0000	
Lot Value	72,786	



\\tsclient\T\TOMMY DUNLAP\New folder (127)\IMG\_0028.JPG 12/30/2022

Residential Data	
Type	1 Single Family Residence
Condition	3 - Average
Quality	3.5 - Average
Architecture	
Style	100% 1 1/2 Story Finished
Exterior Wall	50% Frame, Siding, Wood 50% Veneer, Masonry
Base/Total Area	1,900 / 2,741
Style	100% 1 1/2 Story Finished
HVAC	100% Warmed & Cooled Air
Roof Cover	1 Composition Shingle
Area on Slab	1,900
Fixture/RghIn	13 /
Bed/F/H Bath	3 / 2.5 /
Basement Area	
Garage Type	924 Attached Garage - Unfinished
Remodel	
Year/Eff Age	1991 / 26

### GRM Approach

GRM Code	
Gross Rent	0.00
Indicated Value	

### Multiple Regression

MRA Code	1 Test
Adusted R	0.8445
Indicated Value	418,124 152.54 Per SqFt

### Direct Comparables

Selection Model	1 Res
Adjustment Model	A2 AO Test
Comparables	
Indicated Value	

### Cost Approach Manual : 01/2025

Base Cost	95.40	Total Misc Impr	+	36,999
Roofing Adj	+ 3.77	Garage Cost	+	34,382
Subfloor Adj	+ -2.40	Total RCN	=	397,094
Heat/Cool Adj	+ 14.47	Depreciation ( 32%)	-	127,070
Plumbing Adj	+ 7.59	Lump Sums	+	4,644
Basement Adj	+ 0.00	RCNLD	=	274,668
Adj Base Cost	= 118.83	Lot Value	+	72,786
Total Area	x 2,741	Indicated Value	=	347,454
Adjusted Cost	= 325,713	Value Per SqFt		126.76

### Value Reconciliation

Selected Approach	Cost Approach
Improvements	274,668
Lot Value	72,786
Indicated Value	347,454 126.76 Per SqFt
Agland Value	
Site Improvements	62,251
Total Value	409,705 149.47 Total Value Per SqFt

### Miscellaneous Improvements

Code	Description	Sketch ID	Size	Year	Units	Unit Cost	Depr	Value
FPR1	FIREPLACE - RESIDENTIAL 1 STORY	0		1	1	6,429.63		6,430
PRCH	SLAB PORCH - COVERED	99866	22x20		440	28.02		12,329
PRCH	SLAB PORCH - COVERED	99867	27x6		162	28.95		4,690
PRCH	SLAB PORCH - COVERED	99868	486		486	27.88		13,550
WODO	WOOD DECK - OPEN	99869	27x18		486	19.11	50%	4,644



# Rogers

## Assessment Property Record Card for Tax Year 2026

Data provided by LISA DELOZIER County Assessor

Date 04/18/2026

Time 09:05:11

Page 3

### Sketch Image

660098352

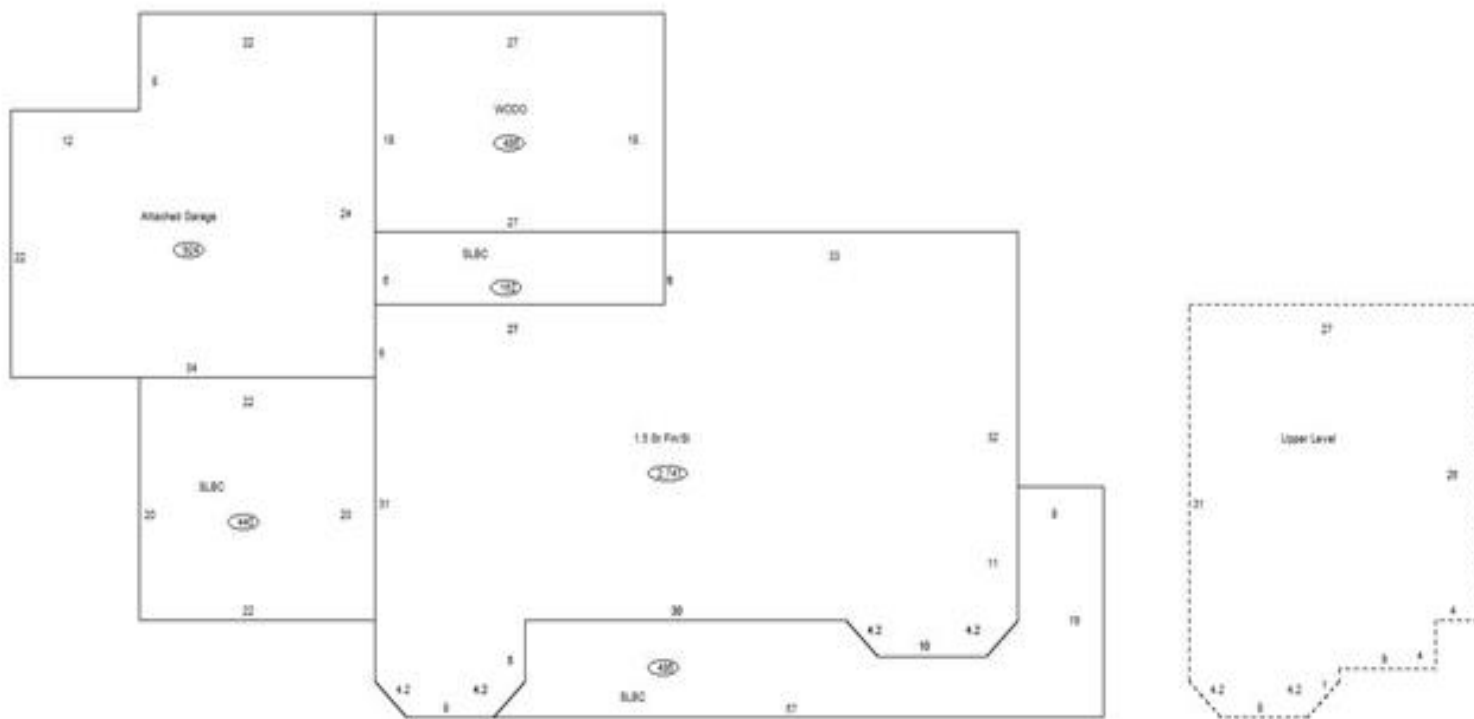

### Sketch Vector Information

Sequence	Code	Type	Built Over	Scale	Section Label	Base Area	Multiplier	Total Area
1	R	5	Slab	10	1.5 St Fin/SI	1,900	1.443	2,741
2	G	1		10	Attached Garage	924	1.000	924
3	M	PRCH		10	SLBC	440	1.000	440
4	M	PRCH		10	SLBC	162	1.000	162
5	M	PRCH		10	SLBC	486	1.000	486
6	M	WODO		10	WODO	486	1.000	486
7	U	^UL	Overhang	10	Upper Level	841	1.000	841
<b>Total Building Area</b>						<b>1,900</b>		<b>2,741</b>



# Rogers



## Assessment Property Record Card for Tax Year 2026

Data provided by LISA DELOZIER County Assessor

Date 04/18/2026  
 Time 09:05:11  
 Page 4

660098352

### Outbuildings/Site Improvements

Building Image	Code	Description	Dimensions	Floor	Roofing	Total Units
	UTIL	Shop Building	30x40x0		Formed Metal	1,200
	Qual	4	Cond 4	Year	2023	Eff Age 2
	<b>Valuation Summary</b> Base Cost (36.85 x 1,200) 44,220		<b>Modifier Total</b> 44,220	<b>RCN</b> 44,220	<b>Depr (3% Phys/ % Func)</b> 1,327	<b>RCNLD</b> 42,893
	LNT0	Lean To - Attached	12x40x0			480
	Qual		Cond	Year	2023	Eff Age
	<b>Valuation Summary</b> Base Cost (9.08 x 480) 4,358		<b>Modifier Total</b> 4,358	<b>RCN</b> 4,358	<b>Depr (0% Phys/ % Func)</b> 4,358	<b>RCNLD</b> 4,358
	SV	SWIM VINYL	0x0x0			1
	Qual	3	Cond 3	Year		Eff Age
	<b>Valuation Summary</b> Base Cost (25,000.00 x 1) 25,000		<b>Modifier Total</b> 25,000	<b>RCN</b> 25,000	<b>Depr (40% Phys/ % Func)</b> 10,000	<b>RCNLD</b> 15,000