



# Rogers

## Assessment Property Record Card for Tax Year 2026

Data provided by LISA DELOZIER County Assessor

Date 04/18/2026  
 Time 09:05:25  
 Page 1

Assessment Data					Primary Image																																																																																												
<b>Account</b> 660098363 <b>Parcel ID</b> 21N14E-11-2-00638-001-0005 <b>Cadastral ID</b> 11-21-14-02480 <b>Property Type</b> REAL - Real Property <b>Property Class</b> RRP VI Area 4 <b>Tax Area</b> 3 - OWASSO RURAL/NO FIRE <b>Name ID</b> 321953 SMITH, JOHNATHON L & JULIE A  11478 N 162ND E AVE OWASSO OK 74055-0000  <b>Parcel Location</b> <b>Situs</b> 11478 N 162ND E AVE <b>Subdivision</b> QUAILBROOK EST PHASE I <b>Lot/Block</b> 0005 / 0001 Parcel Size 1 - Lots <b>Sec/Twn/Rng</b> 11 / 21 / 14 / 5 <b>Neighborhood</b> 1042 - R-V03-SW OWASSO <b>School District</b> S021 - OWASSO SCHOOLS																																																																																																	
<b>Legal Description</b> Lot/Long: 36.32075214 -95.79372660																																																																																																	
<b>Legal Description</b> LOT 5 BLOCK 1 QUAILBROOK EST PHASE I					<b>Building Permits</b> <table border="1"> <thead> <tr> <th>Number</th> <th>Description</th> <th>Opened</th> <th>Closed</th> <th>Amount</th> </tr> </thead> <tbody> <tr> <td>R2015 09 45</td> <td>R17-NEW 2325 SQ FT SFR</td> <td>01/2016</td> <td>07/2016</td> <td>139,500</td> </tr> </tbody> </table>					Number	Description	Opened	Closed	Amount	R2015 09 45	R17-NEW 2325 SQ FT SFR	01/2016	07/2016	139,500																																																																														
Number	Description	Opened	Closed	Amount																																																																																													
R2015 09 45	R17-NEW 2325 SQ FT SFR	01/2016	07/2016	139,500																																																																																													
<b>Exemptions</b> <table border="1"> <thead> <tr> <th>Code</th> <th>Type</th> <th>Active</th> <th>Maximum</th> <th>Exemption</th> </tr> </thead> <tbody> <tr> <td>H</td> <td>Homestead</td> <td>Yes</td> <td>1,000</td> <td>1,000</td> </tr> </tbody> </table>					Code	Type	Active	Maximum	Exemption	H	Homestead	Yes	1,000	1,000	<b>Sale History</b> <table border="1"> <thead> <tr> <th>Bk/Pg</th> <th>Grantor</th> <th>Date</th> <th>Price</th> <th>Code</th> </tr> </thead> <tbody> <tr> <td>2647/272</td> <td>SIMMONS HOMES RESIDENTIAL</td> <td>07/14/2017</td> <td>289,500</td> <td>YES</td> </tr> <tr> <td>2487/735</td> <td>K &amp; S DEVELOPMENTS INC</td> <td>07/13/2015</td> <td>275,000</td> <td>WB</td> </tr> </tbody> </table>					Bk/Pg	Grantor	Date	Price	Code	2647/272	SIMMONS HOMES RESIDENTIAL	07/14/2017	289,500	YES	2487/735	K & S DEVELOPMENTS INC	07/13/2015	275,000	WB																																																															
Code	Type	Active	Maximum	Exemption																																																																																													
H	Homestead	Yes	1,000	1,000																																																																																													
Bk/Pg	Grantor	Date	Price	Code																																																																																													
2647/272	SIMMONS HOMES RESIDENTIAL	07/14/2017	289,500	YES																																																																																													
2487/735	K & S DEVELOPMENTS INC	07/13/2015	275,000	WB																																																																																													
<b>Parcel Valuation</b> <table border="1"> <thead> <tr> <th>Source</th> <th>REAL</th> <th>Fair Cash</th> <th>Capped</th> <th>Asmnt Level</th> <th>Assessed</th> <th>Levy Rate</th> <th>97.960</th> <th>Current Tax</th> </tr> </thead> <tbody> <tr> <td>Remove Cap</td> <td>2018</td> <td>Land Value 106,242</td> <td>58,589</td> <td>11%</td> <td>6,445</td> <td>Assessed</td> <td>38,617</td> <td>3,782.92</td> </tr> <tr> <td>Year Frozen</td> <td></td> <td>Improvements 298,799</td> <td>292,470</td> <td></td> <td>32,172</td> <td>Penalty</td> <td>0</td> <td></td> </tr> <tr> <td>Uncapped Value</td> <td>0</td> <td>Mobile Home 0</td> <td>0</td> <td></td> <td>0</td> <td>Exemption</td> <td>1,000</td> <td>-98.00</td> </tr> <tr> <td>TIF Project ID</td> <td>0</td> <td>Total Value 405,041</td> <td>351,059</td> <td></td> <td>38,617</td> <td>Total Taxable</td> <td>37,617</td> <td>3,685.00</td> </tr> </tbody> </table>										Source	REAL	Fair Cash	Capped	Asmnt Level	Assessed	Levy Rate	97.960	Current Tax	Remove Cap	2018	Land Value 106,242	58,589	11%	6,445	Assessed	38,617	3,782.92	Year Frozen		Improvements 298,799	292,470		32,172	Penalty	0		Uncapped Value	0	Mobile Home 0	0		0	Exemption	1,000	-98.00	TIF Project ID	0	Total Value 405,041	351,059		38,617	Total Taxable	37,617	3,685.00																																											
Source	REAL	Fair Cash	Capped	Asmnt Level	Assessed	Levy Rate	97.960	Current Tax																																																																																									
Remove Cap	2018	Land Value 106,242	58,589	11%	6,445	Assessed	38,617	3,782.92																																																																																									
Year Frozen		Improvements 298,799	292,470		32,172	Penalty	0																																																																																										
Uncapped Value	0	Mobile Home 0	0		0	Exemption	1,000	-98.00																																																																																									
TIF Project ID	0	Total Value 405,041	351,059		38,617	Total Taxable	37,617	3,685.00																																																																																									
<b>Assessment History</b> <table border="1"> <thead> <tr> <th>Tax Year</th> <th>Statement Number</th> <th>Billed Owner</th> <th>Tax Area</th> <th>Total Value</th> <th>Exemptions</th> <th>Taxable Value</th> <th>Billed Tax</th> </tr> </thead> <tbody> <tr> <td>2025</td> <td>2025-660098363</td> <td>SMITH, JOHNATHON L &amp;</td> <td>3</td> <td>395,994</td> <td>1000</td> <td>36,492</td> <td>3,575.00</td> </tr> <tr> <td>2024</td> <td>2024-660098363</td> <td>SMITH, JOHNATHON L &amp;</td> <td>3</td> <td>365,601</td> <td>1000</td> <td>35,400</td> <td>3,401.00</td> </tr> <tr> <td>2023</td> <td>2023-660098363</td> <td>SMITH, JOHNATHON L &amp;</td> <td>3</td> <td>330,263</td> <td>1000</td> <td>34,340</td> <td>3,218.00</td> </tr> <tr> <td>2022</td> <td>2022-660098363</td> <td>SMITH, JOHNATHON L &amp;</td> <td>3</td> <td>320,246</td> <td>1000</td> <td>33,310</td> <td>3,263.00</td> </tr> <tr> <td>2021</td> <td>2021-660098363</td> <td>SMITH, JOHNATHON L &amp;</td> <td>3</td> <td>304,246</td> <td>1000</td> <td>32,311</td> <td>3,126.00</td> </tr> <tr> <td>2020</td> <td>2020-660098363</td> <td>SMITH, JOHNATHON L &amp;</td> <td>3</td> <td>299,572</td> <td>1000</td> <td>31,341</td> <td>3,028.00</td> </tr> <tr> <td>2019</td> <td>2019-660098363</td> <td>SMITH, JOHNATHON L &amp;</td> <td>3</td> <td>285,445</td> <td>1000</td> <td>30,399</td> <td>2,939.00</td> </tr> <tr> <td>2018</td> <td>2018-660098363</td> <td>SMITH, JOHNATHON L &amp;</td> <td>3</td> <td>292,542</td> <td>1000</td> <td>31,180</td> <td>2,902.00</td> </tr> <tr> <td>2017</td> <td>2017-660098363</td> <td>SMITH, JOHNATHON L &amp;</td> <td>3</td> <td>91,041</td> <td>0</td> <td>10,015</td> <td>942.00</td> </tr> <tr> <td>2016</td> <td>2016-660098363</td> <td>SIMMONS HOMES RESIDENTIAL</td> <td>3</td> <td>15,023</td> <td>0</td> <td>1,653</td> <td>156.00</td> </tr> </tbody> </table>										Tax Year	Statement Number	Billed Owner	Tax Area	Total Value	Exemptions	Taxable Value	Billed Tax	2025	2025-660098363	SMITH, JOHNATHON L &	3	395,994	1000	36,492	3,575.00	2024	2024-660098363	SMITH, JOHNATHON L &	3	365,601	1000	35,400	3,401.00	2023	2023-660098363	SMITH, JOHNATHON L &	3	330,263	1000	34,340	3,218.00	2022	2022-660098363	SMITH, JOHNATHON L &	3	320,246	1000	33,310	3,263.00	2021	2021-660098363	SMITH, JOHNATHON L &	3	304,246	1000	32,311	3,126.00	2020	2020-660098363	SMITH, JOHNATHON L &	3	299,572	1000	31,341	3,028.00	2019	2019-660098363	SMITH, JOHNATHON L &	3	285,445	1000	30,399	2,939.00	2018	2018-660098363	SMITH, JOHNATHON L &	3	292,542	1000	31,180	2,902.00	2017	2017-660098363	SMITH, JOHNATHON L &	3	91,041	0	10,015	942.00	2016	2016-660098363	SIMMONS HOMES RESIDENTIAL	3	15,023	0	1,653	156.00
Tax Year	Statement Number	Billed Owner	Tax Area	Total Value	Exemptions	Taxable Value	Billed Tax																																																																																										
2025	2025-660098363	SMITH, JOHNATHON L &	3	395,994	1000	36,492	3,575.00																																																																																										
2024	2024-660098363	SMITH, JOHNATHON L &	3	365,601	1000	35,400	3,401.00																																																																																										
2023	2023-660098363	SMITH, JOHNATHON L &	3	330,263	1000	34,340	3,218.00																																																																																										
2022	2022-660098363	SMITH, JOHNATHON L &	3	320,246	1000	33,310	3,263.00																																																																																										
2021	2021-660098363	SMITH, JOHNATHON L &	3	304,246	1000	32,311	3,126.00																																																																																										
2020	2020-660098363	SMITH, JOHNATHON L &	3	299,572	1000	31,341	3,028.00																																																																																										
2019	2019-660098363	SMITH, JOHNATHON L &	3	285,445	1000	30,399	2,939.00																																																																																										
2018	2018-660098363	SMITH, JOHNATHON L &	3	292,542	1000	31,180	2,902.00																																																																																										
2017	2017-660098363	SMITH, JOHNATHON L &	3	91,041	0	10,015	942.00																																																																																										
2016	2016-660098363	SIMMONS HOMES RESIDENTIAL	3	15,023	0	1,653	156.00																																																																																										



# Rogers

## Assessment Property Record Card for Tax Year 2026

Data provided by LISA DELOZIER County Assessor

Date 04/18/2026  
 Time 09:05:25  
 Page 2

Lot Data		Square-Foot - NBHD 1042 #1	
Lot Size	0	0	
Lot Count	1		
Units Buildable			
Non-Ag Acres	0.5792		
Topography			
Street Access			
Utilities			
Amenities			0
			0
Method	Square-Foot		
Base Lot Value	25,229.00 x 4.21 = 106,242		
Factor Value			
Adjustments	1.0000		
Lot Value	106,242		



\\tsclient\TCASEY\CASEY BOOTH RESIDENTIAL VI\2022-9-1\IM 9/6/2022

Residential Data	
Type	1 Single Family Residence
Condition	3 - Average
Quality	3.5 - Average
Architecture	
Style	100% One Story
Exterior Wall	100% Veneer, Masonry
Base/Total Area	2,168 / 2,168
Style	100% One Story
HVAC	100% Warmed & Cooled Air
Roof Cover	1 Composition Shingle
Area on Slab	2,168
Fixture/RghIn	11 /
Bed/F/H Bath	3 / 2.0 /
Basement Area	
Garage Type	674 Attached Garage - Unfinished
Remodel	
Year/Eff Age	2016 / 8

### GRM Approach

GRM Code	
Gross Rent	0.00
Indicated Value	

### Multiple Regression

MRA Code	1	Test
Adjusted R	0.8445	
Indicated Value	319,784	147.50 Per SqFt

### Direct Comparables

Selection Model	A	Adam Test
Adjustment Model	1	2022 Residential
Comparables	3	
Indicated Value	410,920	Per SqFt

### Value Reconciliation

Selected Approach	Cost Approach		
Improvements	298,799		
Lot Value	106,242		
Indicated Value	405,041	186.83	Per SqFt
Agland Value			
Site Improvements			
Total Value	405,041	186.83	Total Value Per SqFt

Cost Approach		Manual : 01/2025	
Base Cost	110.78	Total Misc Impr	+ 6,065
Roofing Adj	+ 5.28	Garage Cost	+ 25,322
Subfloor Adj	+ -3.40	Total RCN	= 324,782
Heat/Cool Adj	+ 14.47	Depreciation ( 8%)	- 25,983
Plumbing Adj	+ 8.20	Lump Sums	+ 0
Basement Adj	+ 0.00	RCNLD	= 298,799
Adj Base Cost	= 135.33	Lot Value	+ 106,242
Total Area	x 2,168	Indicated Value	= 405,041
Adjusted Cost	= 293,395	Value Per SqFt	186.83

### Miscellaneous Improvements

Code	Description	Sketch ID	Size	Year	Units	Unit Cost	Depr	Value
PRCH	SLAB PORCH - COVERED	127569	132		132	29.08		3,839
PRCH	SLAB PORCH - COVERED	127570	76		76	29.29		2,226



# Rogers

## Assessment Property Record Card for Tax Year 2026

Data provided by LISA DELOZIER County Assessor

Date 04/18/2026

Time 09:05:25

Page 3

### Sketch Image

660098363

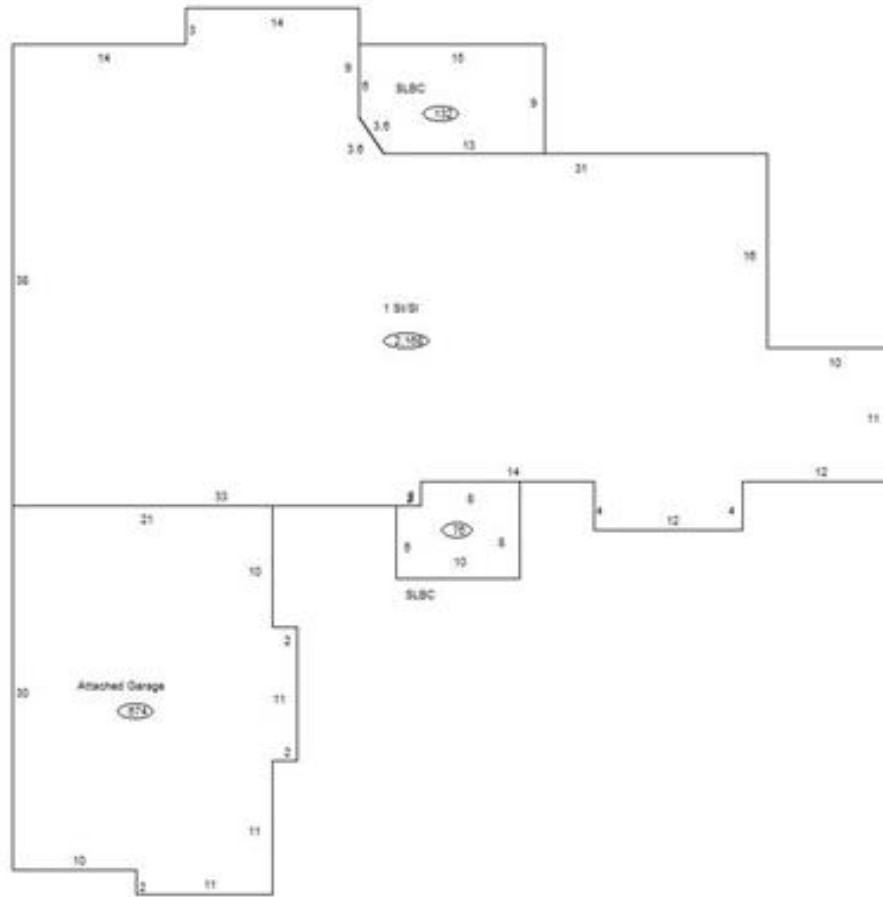

### Sketch Vector Information

Sequence	Code	Type	Built Over	Scale	Section Label	Base Area	Multiplier	Total Area
1	R	1	Slab	10	1 St/SI	2,168	1.000	2,168
2	G	1		10	Attached Garage	674	1.000	674
3	M	PRCH		10	SLBC	132	1.000	132
4	M	PRCH		10	SLBC	76	1.000	76
<b>Total Building Area</b>						<b>2,168</b>		<b>2,168</b>