



Rogers

Assessment Property Record Card for Tax Year 2026

Data provided by LISA DELOZIER County Assessor

Date 04/18/2026
Time 09:07:58
Page 1

Assessment Data					Primary Image																																																	
Account 660098455 Parcel ID 21N15E-31-3-00674-003-0031 Cadastral ID 31-21-15-00820 Property Type REAL - Real Property Property Class RR VI Area 4 Tax Area 7 - OWASSO/LIMESTONE FIRE Name ID 348076 WILLIAMS, HARRISON & EMILY 19672 E 69TH ST N OWASSO OK 74055-0000 Parcel Location Situs 19672 E 69TH ST N Subdivision RIDGE, THE 2 Lot/Block 0031 / 0003 Parcel Size 1 - Lots Sec/Twn/Rng 31 / 21 / 15 / Neighborhood 1074 - R-V01,3,4-SW OWASSO CATOOSA School District S021 - OWASSO SCHOOLS																																																						
Legal Description Lot/Long: 36.25335044 -95.75340802																																																						
Building Permits					<table border="1"> <thead> <tr> <th>Number</th> <th>Description</th> <th>Opened</th> <th>Closed</th> <th>Amount</th> </tr> </thead> <tbody> <tr> <td>R2016 05 33</td> <td>R17-NEW 2715 SQ FT SFR</td> <td>05/2016</td> <td>12/2016</td> <td>210,000</td> </tr> </tbody> </table>					Number	Description	Opened	Closed	Amount	R2016 05 33	R17-NEW 2715 SQ FT SFR	05/2016	12/2016	210,000																																			
Number	Description	Opened	Closed	Amount																																																		
R2016 05 33	R17-NEW 2715 SQ FT SFR	05/2016	12/2016	210,000																																																		
Exemptions					Sale History																																																	
<table border="1"> <thead> <tr> <th>Code</th> <th>Type</th> <th>Active</th> <th>Maximum</th> <th>Exemption</th> </tr> </thead> <tbody> <tr> <td>H</td> <td>Homestead</td> <td>Yes</td> <td>1,000</td> <td>1,000</td> </tr> <tr> <td>H</td> <td>Homestead</td> <td>No</td> <td>1,000</td> <td></td> </tr> <tr> <td>H</td> <td>Homestead</td> <td>No</td> <td>1,000</td> <td></td> </tr> </tbody> </table>					Code	Type	Active	Maximum	Exemption	H	Homestead	Yes	1,000	1,000	H	Homestead	No	1,000		H	Homestead	No	1,000		<table border="1"> <thead> <tr> <th>Bk/Pg</th> <th>Grantor</th> <th>Date</th> <th>Price</th> <th>Code</th> </tr> </thead> <tbody> <tr> <td>/</td> <td>COOK, GARY ALAN & MOLLY MARIE</td> <td>08/22/2025</td> <td>512,000</td> <td>YES</td> </tr> <tr> <td>/</td> <td>YEAROUT, BLAKE A & CHELSEA K</td> <td>06/16/2020</td> <td>370,000</td> <td>YES</td> </tr> <tr> <td>2600/460</td> <td>EXECUTIVE HOMES LLC</td> <td>12/16/2016</td> <td>355,000</td> <td>YES</td> </tr> <tr> <td>2501/224</td> <td>BLUE CHIP LAND CO LLC</td> <td>09/24/2015</td> <td>0</td> <td>15</td> </tr> </tbody> </table>					Bk/Pg	Grantor	Date	Price	Code	/	COOK, GARY ALAN & MOLLY MARIE	08/22/2025	512,000	YES	/	YEAROUT, BLAKE A & CHELSEA K	06/16/2020	370,000	YES	2600/460	EXECUTIVE HOMES LLC	12/16/2016	355,000	YES	2501/224	BLUE CHIP LAND CO LLC	09/24/2015	0	15
Code	Type	Active	Maximum	Exemption																																																		
H	Homestead	Yes	1,000	1,000																																																		
H	Homestead	No	1,000																																																			
H	Homestead	No	1,000																																																			
Bk/Pg	Grantor	Date	Price	Code																																																		
/	COOK, GARY ALAN & MOLLY MARIE	08/22/2025	512,000	YES																																																		
/	YEAROUT, BLAKE A & CHELSEA K	06/16/2020	370,000	YES																																																		
2600/460	EXECUTIVE HOMES LLC	12/16/2016	355,000	YES																																																		
2501/224	BLUE CHIP LAND CO LLC	09/24/2015	0	15																																																		
Parcel Valuation																																																						
Source REAL		Fair Cash		Capped		Asmnt Level		Assessed		Levy Rate 108.538		Current Tax																																										
Remove Cap 2026		Land Value 121,212		121,212		11%		13,333		Assessed 56,320		6,112.86																																										
Year Frozen		Improvements 390,791		390,791		42,987		Penalty 0		Exemption 1,000		-98.00																																										
Uncapped Value 0		Mobile Home 0		0		0		Total Taxable 55,320		6,015.00																																												
TIF Project ID 0		Total Value 512,003		512,003		56,320																																																
Assessment History																																																						
Tax Year		Statement Number		Billed Owner		Tax Area		Total Value		Exemptions		Taxable Value		Billed Tax																																								
2025		2025-660098455		WILLIAMS, HARRISON &		7		421,312		1000		45,067		4,902.00																																								
2024		2024-660098455		COOK, GARY ALAN & MOLLY MARIE		7		449,767		1000		43,725		4,840.00																																								
2023		2023-660098455		COOK, GARY ALAN & MOLLY MARIE		7		415,394		1000		42,422		4,595.00																																								
2022		2022-660098455		COOK, GARY ALAN & MOLLY MARIE		7		390,381		1000		41,157		4,634.00																																								
2021		2021-660098455		COOK, GARY ALAN & MOLLY MARIE		7		372,086		1000		39,929		4,447.00																																								
2020		2020-660098455		COOK, GARY ALAN & MOLLY MARIE		7		365,954		1000		38,403		4,273.00																																								
2019		2019-660098455		YEAROUT, BLAKE A & CHELSEA K		7		347,777		1000		37,255		4,147.00																																								
2018		2018-660098455		YEAROUT, BLAKE A & CHELSEA K		7		356,367		1000		38,200		4,116.00																																								
2017		2017-660098455		YEAROUT, BLAKE A & CHELSEA K		7		353,442		0		38,879		4,212.00																																								
2016		2016-660098455		EXECUTIVE HOMES LLC		7		539		0		59		7.00																																								



Rogers

Assessment Property Record Card for Tax Year 2026

Data provided by LISA DELOZIER County Assessor

Date 04/18/2026
Time 09:07:58
Page 2

Lot Data	Square-Foot - NBHD 1074 #1	Primary Image
Lot Size	0 0	
Lot Count	1	
Units Buildable		
Non-Ag Acres	0.4966	
Topography		
Street Access		
Utilities		
Amenities	LAND QUALITY 0 LAND USE 0	
Method	Square-Foot	
Base Lot Value	21,633.00 x 3.00 = 64,899	
Factor Value		
Adjustments	1.8677	
Lot Value	121,212	

Residential Data	
Type	1 Single Family Residence
Condition	3 - Average
Quality	4 - Good
Architecture	
Style	100% One Story
Exterior Wall	95% Veneer, Masonry 5% Veneer, Stone
Base/Total Area	2,716 / 2,716
Style	100% One Story
HVAC	100% Warmed & Cooled Air
Roof Cover	1 Composition Shingle
Area on Slab	2,716
Fixture/RghIn	16 /
Bed/F/H Bath	4 / 2.0 / 1.0
Basement Area	
Garage Type	704 Attached Garage - Unfinished
Remodel	
Year/Eff Age	2016 / 8



\\tsclient\C\Users\Randy Necessary\Pictures\101_0627\IMG_0050. 6/28/2022

GRM Approach	
GRM Code	
Gross Rent	0.00
Indicated Value	

Multiple Regression			
MRA Code	1	Test	
Adjusted R	0.8445		
Indicated Value	402,853	148.33	Per SqFt

Direct Comparables			
Selection Model	A	Adam Test	
Adjustment Model	1	2022 Residential	
Comparables	8		
Indicated Value	465,740		Per SqFt

Cost Approach				Manual : 01/2025			
Base Cost	111.53	Total Misc Impr	+	13,368			
Roofing Adj	+ 5.74	Garage Cost	+	32,088			
Subfloor Adj	+ -4.46	Total RCN	=	424,773			
Heat/Cool Adj	+ 16.31	Depreciation (8%)	-	33,982			
Plumbing Adj	+ 10.54	Lump Sums	+	0			
Basement Adj	+ 0.00	RCNLD	=	390,791			
Adj Base Cost	= 139.66	Lot Value	+	121,212			
Total Area	x 2,716	Indicated Value	=	512,003			
Adjusted Cost	= 379,317	Value Per SqFt		188.51			

Value Reconciliation			
Selected Approach	Cost Approach		
Improvements	390,791		
Lot Value	121,212		
Indicated Value	512,003	188.51	Per SqFt
Agland Value			
Site Improvements			
Total Value	512,003	188.51	Total Value Per SqFt

Miscellaneous Improvements								
Code	Description	Sketch ID	Size	Year	Units	Unit Cost	Depr	Value
PRCH	SLAB PORCH - COVERED	131196	21x18		378	31.69		11,979
PRCH	SLAB PORCH - COVERED	131197	7x6		42	33.06		1,389



Rogers

Assessment Property Record Card for Tax Year 2026

Data provided by LISA DELOZIER County Assessor

Date 04/18/2026

Time 09:07:58

Page 3

Sketch Image

660098455

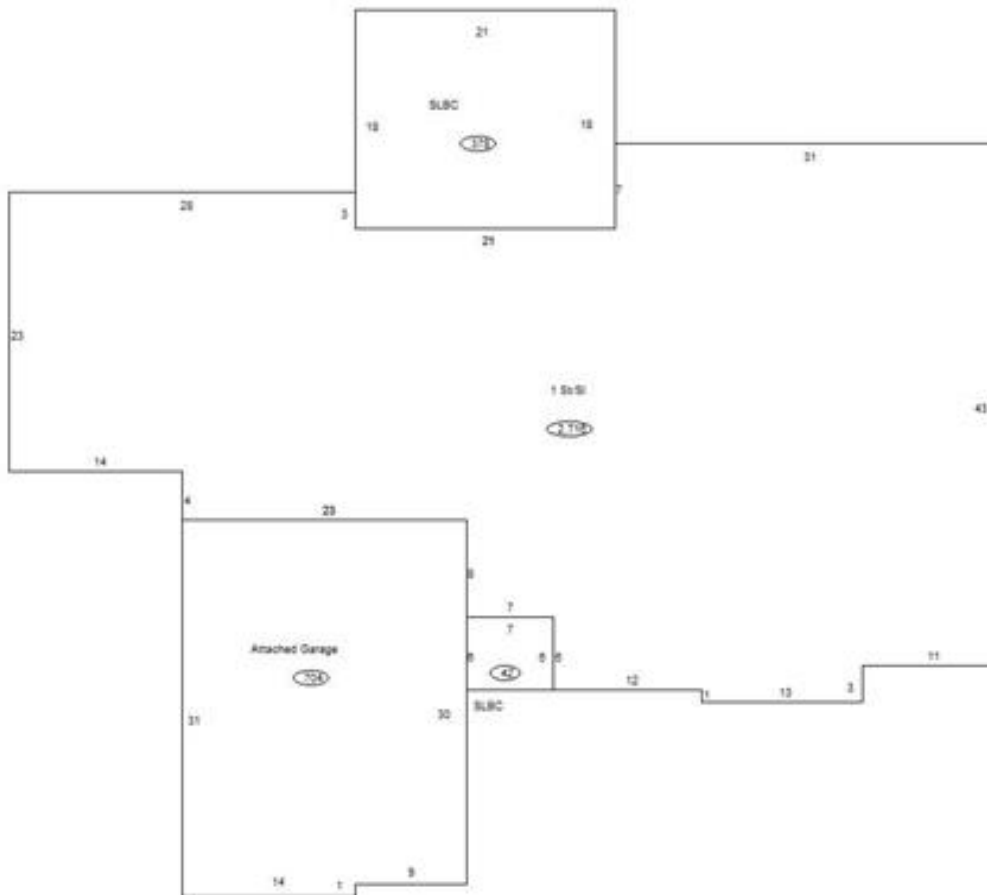

Sketch Vector Information

Sequence	Code	Type	Built Over	Scale	Section Label	Base Area	Multiplier	Total Area
1	R	1	Slab	10	1 St/SI	2,716	1.000	2,716
2	G	1		10	Attached Garage	704	1.000	704
3	M	PRCH		10	SLBC	378	1.000	378
4	M	PRCH		10	SLBC	42	1.000	42
Total Building Area						2,716		2,716