



Rogers

Assessment Property Record Card for Tax Year 2026

Data provided by LISA DELOZIER County Assessor

Date 04/18/2026
Time 09:10:32
Page 1

Assessment Data					Primary Image																																																																																												
Account 660098601 Parcel ID 21N14E-10-2-00460-002-0014 Cadastral ID 10-21-14-07430 Property Type REAL - Real Property Property Class URP VI Area 4 Tax Area 40 - OWASSO CITY Name ID 345903 MCGOWAN, ALEJANDRO KEITH 14606 E 114TH ST N OWASSO OK 74055-0000 Parcel Location Situs 14606 E 114TH ST N Subdivision LAKE VALLEY V PHASE III Lot/Block 0036 / 0002 Parcel Size 1 - Lots Sec/Twn/Rng 10 / 21 / 14 / 5 Neighborhood 1059 - R-V04-SW OWASSO School District S021 - OWASSO SCHOOLS																																																																																																	
Legal Description Lot/Long: 36.31876428 -95.81053931																																																																																																	
Building Permits					<table border="1"> <thead> <tr> <th>Number</th> <th>Description</th> <th>Opened</th> <th>Closed</th> <th>Amount</th> </tr> </thead> <tbody> <tr> <td>16-0123X</td> <td>R17-NEW 1798 SQ FT SFR</td> <td>02/2016</td> <td>07/2016</td> <td>130,790</td> </tr> </tbody> </table>					Number	Description	Opened	Closed	Amount	16-0123X	R17-NEW 1798 SQ FT SFR	02/2016	07/2016	130,790																																																																														
Number	Description	Opened	Closed	Amount																																																																																													
16-0123X	R17-NEW 1798 SQ FT SFR	02/2016	07/2016	130,790																																																																																													
Exemptions					Sale History																																																																																												
<table border="1"> <thead> <tr> <th>Code</th> <th>Type</th> <th>Active</th> <th>Maximum</th> <th>Exemption</th> </tr> </thead> <tbody> <tr> <td>HV</td> <td>Veteran</td> <td>No</td> <td>999,999</td> <td></td> </tr> <tr> <td>H</td> <td>Homestead</td> <td>No</td> <td>1,000</td> <td></td> </tr> </tbody> </table>					Code	Type	Active	Maximum	Exemption	HV	Veteran	No	999,999		H	Homestead	No	1,000		<table border="1"> <thead> <tr> <th>Bk/Pg</th> <th>Grantor</th> <th>Date</th> <th>Price</th> <th>Code</th> </tr> </thead> <tbody> <tr> <td>/</td> <td>MCGOWAN, GREGORY KEITH &</td> <td>11/19/2024</td> <td>0</td> <td>4</td> </tr> <tr> <td>2590/581</td> <td>MCGOWAN, GREGORY KEITH &</td> <td>10/26/2016</td> <td>0</td> <td>4</td> </tr> <tr> <td>2560/54</td> <td>SIMMONS HOMES RESIDENTIAL</td> <td>06/28/2016</td> <td>203,000</td> <td>YES</td> </tr> <tr> <td>2523/223</td> <td>LAKE VALLEY INVESTMENT</td> <td>12/18/2015</td> <td>1,680,000</td> <td>15</td> </tr> </tbody> </table>					Bk/Pg	Grantor	Date	Price	Code	/	MCGOWAN, GREGORY KEITH &	11/19/2024	0	4	2590/581	MCGOWAN, GREGORY KEITH &	10/26/2016	0	4	2560/54	SIMMONS HOMES RESIDENTIAL	06/28/2016	203,000	YES	2523/223	LAKE VALLEY INVESTMENT	12/18/2015	1,680,000	15																																																
Code	Type	Active	Maximum	Exemption																																																																																													
HV	Veteran	No	999,999																																																																																														
H	Homestead	No	1,000																																																																																														
Bk/Pg	Grantor	Date	Price	Code																																																																																													
/	MCGOWAN, GREGORY KEITH &	11/19/2024	0	4																																																																																													
2590/581	MCGOWAN, GREGORY KEITH &	10/26/2016	0	4																																																																																													
2560/54	SIMMONS HOMES RESIDENTIAL	06/28/2016	203,000	YES																																																																																													
2523/223	LAKE VALLEY INVESTMENT	12/18/2015	1,680,000	15																																																																																													
Parcel Valuation																																																																																																	
<table border="1"> <thead> <tr> <th>Source</th> <th>REAL</th> </tr> </thead> <tbody> <tr> <td>Remove Cap</td> <td>2017</td> </tr> <tr> <td>Year Frozen</td> <td></td> </tr> <tr> <td>Uncapped Value</td> <td>0</td> </tr> <tr> <td>TIF Project ID</td> <td>0</td> </tr> </tbody> </table>		Source	REAL	Remove Cap	2017	Year Frozen		Uncapped Value	0	TIF Project ID	0	<table border="1"> <thead> <tr> <th>Fair Cash</th> <th>Capped</th> <th>Asmnt Level</th> <th>Assessed</th> </tr> </thead> <tbody> <tr> <td>Land Value</td> <td>50,355</td> <td>48,874</td> <td>5,376</td> </tr> <tr> <td>Improvements</td> <td>236,088</td> <td>207,092</td> <td>22,780</td> </tr> <tr> <td>Mobile Home</td> <td>0</td> <td>0</td> <td>0</td> </tr> <tr> <td>Total Value</td> <td>286,443</td> <td>255,966</td> <td>28,156</td> </tr> </tbody> </table>			Fair Cash	Capped	Asmnt Level	Assessed	Land Value	50,355	48,874	5,376	Improvements	236,088	207,092	22,780	Mobile Home	0	0	0	Total Value	286,443	255,966	28,156	<table border="1"> <thead> <tr> <th>Levy Rate</th> <th>Current Tax</th> </tr> </thead> <tbody> <tr> <td>97.960</td> <td></td> </tr> <tr> <td>Assessed</td> <td>28,156</td> </tr> <tr> <td>Penalty</td> <td>0</td> </tr> <tr> <td>Exemption</td> <td>0</td> </tr> <tr> <td>Total Taxable</td> <td>28,156</td> </tr> </tbody> </table>		Levy Rate	Current Tax	97.960		Assessed	28,156	Penalty	0	Exemption	0	Total Taxable	28,156																																																	
Source	REAL																																																																																																
Remove Cap	2017																																																																																																
Year Frozen																																																																																																	
Uncapped Value	0																																																																																																
TIF Project ID	0																																																																																																
Fair Cash	Capped	Asmnt Level	Assessed																																																																																														
Land Value	50,355	48,874	5,376																																																																																														
Improvements	236,088	207,092	22,780																																																																																														
Mobile Home	0	0	0																																																																																														
Total Value	286,443	255,966	28,156																																																																																														
Levy Rate	Current Tax																																																																																																
97.960																																																																																																	
Assessed	28,156																																																																																																
Penalty	0																																																																																																
Exemption	0																																																																																																
Total Taxable	28,156																																																																																																
Assessment History																																																																																																	
<table border="1"> <thead> <tr> <th>Tax Year</th> <th>Statement Number</th> <th>Billed Owner</th> <th>Tax Area</th> <th>Total Value</th> <th>Exemptions</th> <th>Taxable Value</th> <th>Billed Tax</th> </tr> </thead> <tbody> <tr> <td>2025</td> <td>2025-660098601</td> <td>MCGOWAN, ALEJANDRO KEITH</td> <td>40</td> <td>279,195</td> <td>0</td> <td>26,815</td> <td>2,627.00</td> </tr> <tr> <td>2024</td> <td>2024-660098601</td> <td>MCGOWAN, GREGORY KEITH &</td> <td>40</td> <td>298,004</td> <td>25538</td> <td></td> <td>.00</td> </tr> <tr> <td>2023</td> <td>2023-660098601</td> <td>MCGOWAN, GREGORY KEITH &</td> <td>40</td> <td>250,324</td> <td>24795</td> <td></td> <td>.00</td> </tr> <tr> <td>2022</td> <td>2022-660098601</td> <td>MCGOWAN, GREGORY KEITH &</td> <td>40</td> <td>248,315</td> <td>1000</td> <td>23,073</td> <td>2,260.00</td> </tr> <tr> <td>2021</td> <td>2021-660098601</td> <td>MCGOWAN, GREGORY KEITH &</td> <td>40</td> <td>213,114</td> <td>1000</td> <td>22,371</td> <td>2,164.00</td> </tr> <tr> <td>2020</td> <td>2020-660098601</td> <td>MCGOWAN, GREGORY KEITH &</td> <td>40</td> <td>209,925</td> <td>1000</td> <td>21,691</td> <td>2,098.00</td> </tr> <tr> <td>2019</td> <td>2019-660098601</td> <td>MCGOWAN, GREGORY KEITH &</td> <td>40</td> <td>200,273</td> <td>1000</td> <td>21,030</td> <td>2,036.00</td> </tr> <tr> <td>2018</td> <td>2018-660098601</td> <td>MCGOWAN, GREGORY KEITH &</td> <td>40</td> <td>205,371</td> <td>1000</td> <td>21,591</td> <td>2,013.00</td> </tr> <tr> <td>2017</td> <td>2017-660098601</td> <td>MCGOWAN, GREGORY KEITH &</td> <td>40</td> <td>203,786</td> <td>1000</td> <td>21,416</td> <td>2,015.00</td> </tr> <tr> <td>2016</td> <td>2016-660098601</td> <td>MCGOWAN, GREGORY KEITH &</td> <td>40</td> <td>5,662</td> <td>0</td> <td>623</td> <td>59.00</td> </tr> </tbody> </table>										Tax Year	Statement Number	Billed Owner	Tax Area	Total Value	Exemptions	Taxable Value	Billed Tax	2025	2025-660098601	MCGOWAN, ALEJANDRO KEITH	40	279,195	0	26,815	2,627.00	2024	2024-660098601	MCGOWAN, GREGORY KEITH &	40	298,004	25538		.00	2023	2023-660098601	MCGOWAN, GREGORY KEITH &	40	250,324	24795		.00	2022	2022-660098601	MCGOWAN, GREGORY KEITH &	40	248,315	1000	23,073	2,260.00	2021	2021-660098601	MCGOWAN, GREGORY KEITH &	40	213,114	1000	22,371	2,164.00	2020	2020-660098601	MCGOWAN, GREGORY KEITH &	40	209,925	1000	21,691	2,098.00	2019	2019-660098601	MCGOWAN, GREGORY KEITH &	40	200,273	1000	21,030	2,036.00	2018	2018-660098601	MCGOWAN, GREGORY KEITH &	40	205,371	1000	21,591	2,013.00	2017	2017-660098601	MCGOWAN, GREGORY KEITH &	40	203,786	1000	21,416	2,015.00	2016	2016-660098601	MCGOWAN, GREGORY KEITH &	40	5,662	0	623	59.00
Tax Year	Statement Number	Billed Owner	Tax Area	Total Value	Exemptions	Taxable Value	Billed Tax																																																																																										
2025	2025-660098601	MCGOWAN, ALEJANDRO KEITH	40	279,195	0	26,815	2,627.00																																																																																										
2024	2024-660098601	MCGOWAN, GREGORY KEITH &	40	298,004	25538		.00																																																																																										
2023	2023-660098601	MCGOWAN, GREGORY KEITH &	40	250,324	24795		.00																																																																																										
2022	2022-660098601	MCGOWAN, GREGORY KEITH &	40	248,315	1000	23,073	2,260.00																																																																																										
2021	2021-660098601	MCGOWAN, GREGORY KEITH &	40	213,114	1000	22,371	2,164.00																																																																																										
2020	2020-660098601	MCGOWAN, GREGORY KEITH &	40	209,925	1000	21,691	2,098.00																																																																																										
2019	2019-660098601	MCGOWAN, GREGORY KEITH &	40	200,273	1000	21,030	2,036.00																																																																																										
2018	2018-660098601	MCGOWAN, GREGORY KEITH &	40	205,371	1000	21,591	2,013.00																																																																																										
2017	2017-660098601	MCGOWAN, GREGORY KEITH &	40	203,786	1000	21,416	2,015.00																																																																																										
2016	2016-660098601	MCGOWAN, GREGORY KEITH &	40	5,662	0	623	59.00																																																																																										



Rogers

Assessment Property Record Card for Tax Year 2026

Data provided by LISA DELOZIER County Assessor

Date 04/18/2026
 Time 09:10:33
 Page 2

Lot Data		Square-Foot - NBHD 1059 #1	
Lot Size	0	0	
Lot Count	1		
Units Buildable			
Non-Ag Acres	0.2181		
Topography			
Street Access			
Utilities			
Amenities			0
			0
Method	Square-Foot		
Base Lot Value	9,501.00 x 5.30 = 50,355		
Factor Value			
Adjustments	1.0000		
Lot Value	50,355		



\\tsclient\T\LOGAN\LOGAN RESIDENTIAL VI\2022-7-19\IMG_002: 7/19/2022

Residential Data	
Type	1 Single Family Residence
Condition	3 - Average
Quality	3 - Average
Architecture	
Style	100% One Story
Exterior Wall	95% Veneer, Masonry 5% Frame, Siding, Wood
Base/Total Area	1,725 / 1,725
Style	100% One Story
HVAC	100% Warmed & Cooled Air
Roof Cover	1 Composition Shingle
Area on Slab	1,725
Fixture/RghIn	11 /
Bed/F/H Bath	4 / 2.0 /
Basement Area	
Garage Type	598 Attached Garage - Unfinished
Remodel	
Year/Eff Age	2016 / 8

GRM Approach	
GRM Code	
Gross Rent	0.00
Indicated Value	

Multiple Regression			
MRA Code	1	Test	
Adusted R	0.8445		
Indicated Value	253,781	147.12	Per SqFt

Direct Comparables			
Selection Model	A	Adam Test	
Adjustment Model	1	2022 Residential	
Comparables	8		
Indicated Value	258,790		Per SqFt

Cost Approach		Manual : 01/2025	
Base Cost	110.49	Total Misc Impr	+ 6,041
Roofing Adj	+ 4.85	Garage Cost	+ 18,287
Subfloor Adj	+ -2.31	Total RCN	= 256,617
Heat/Cool Adj	+ 12.64	Depreciation (8%)	- 20,529
Plumbing Adj	+ 8.99	Lump Sums	+ 0
Basement Adj	+ 0.00	RCNLD	= 236,088
Adj Base Cost	= 134.66	Lot Value	+ 50,355
Total Area	x 1,725	Indicated Value	= 286,443
Adjusted Cost	= 232,289	Value Per SqFt	166.05

Value Reconciliation			
Selected Approach	Cost Approach		
Improvements	236,088		
Lot Value	50,355		
Indicated Value	286,443	166.05	Per SqFt
Agland Value			
Site Improvements			
Total Value	286,443	166.05	Total Value Per SqFt

Miscellaneous Improvements								
Code	Description	Sketch ID	Size	Year	Units	Unit Cost	Depr	Value
PRCH	SLAB PORCH - COVERED	128954	13x10		130	26.52		3,448
PRCH	SLAB PORCH - COVERED	128955	5x5		25	26.85		671
PRCH	SLAB PORCH - COVERED	128956	12x6		72	26.70		1,922



Rogers

Assessment Property Record Card for Tax Year 2026

Data provided by LISA DELOZIER County Assessor

Date 04/18/2026
 Time 09:10:33
 Page 3

Sketch Image

660098601

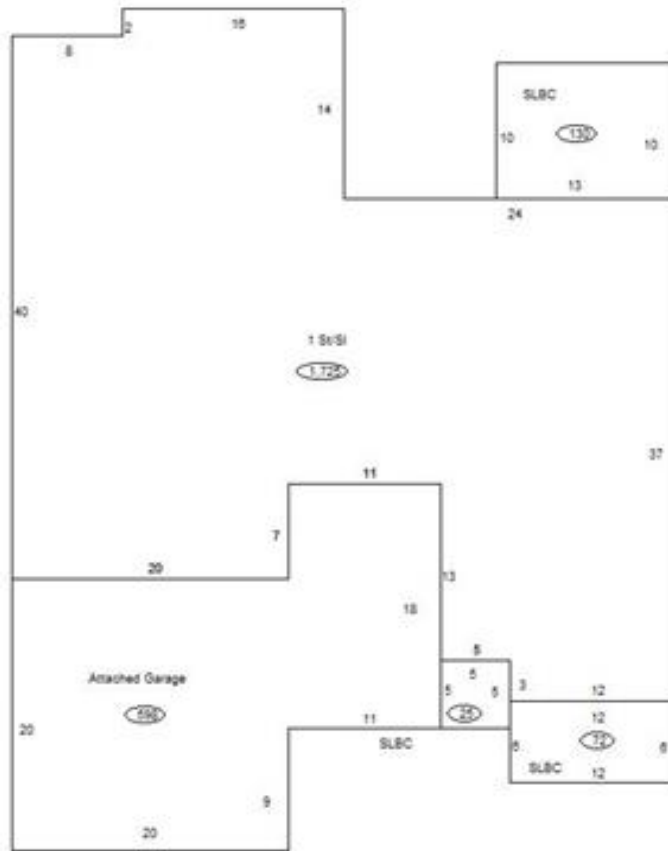

Sketch Vector Information

Sequence	Code	Type	Built Over	Scale	Section Label	Base Area	Multiplier	Total Area
1	R	1	Slab	10	1 St/SI	1,725	1.000	1,725
2	G	1		10	Attached Garage	598	1.000	598
3	M	PRCH		10	SLBC	130	1.000	130
4	M	PRCH		10	SLBC	25	1.000	25
5	M	PRCH		10	SLBC	72	1.000	72
Total Building Area						1,725		1,725