



# Rogers

## Assessment Property Record Card for Tax Year 2026

Data provided by LISA DELOZIER County Assessor

Date 04/18/2026  
 Time 09:12:46  
 Page 1

Assessment Data					Primary Image																																																																																												
<b>Account</b> 660098684 <b>Parcel ID</b> 21N14E-11-2-00649-004-0011 <b>Cadastral ID</b> 11-21-14-06800 <b>Property Type</b> REAL - Real Property <b>Property Class</b> RRP VI Area 4 <b>Tax Area</b> 3 - OWASSO RURAL/NO FIRE <b>Name ID</b> 327645 MADDEN, PAUL A & KIMBERLY L  11370 N 166TH E AVE OWASSO OK 74055-0000  <b>Parcel Location</b> <b>Situs</b> 11370 N 166TH E AVE <b>Subdivision</b> QUAILBROOK ESTATES PHASE 2 <b>Lot/Block</b> 0011 / 0004 <b>Parcel Size</b> 1 - Lots <b>Sec/Twn/Rng</b> 11 / 21 / 14 / 5 <b>Neighborhood</b> 1042 - R-V03-SW OWASSO <b>School District</b> S021 - OWASSO SCHOOLS																																																																																																	
<b>Legal Description</b> Lat/Long: 36.31947364 -95.78821807																																																																																																	
<b>Building Permits</b>					<table border="1"> <thead> <tr> <th>Number</th> <th>Description</th> <th>Opened</th> <th>Closed</th> <th>Amount</th> </tr> </thead> <tbody> <tr> <td>R18 000384</td> <td>R20- NEW 2468 SQ FT SFR</td> <td>12/2018</td> <td>05/2019</td> <td>146,100</td> </tr> </tbody> </table>					Number	Description	Opened	Closed	Amount	R18 000384	R20- NEW 2468 SQ FT SFR	12/2018	05/2019	146,100																																																																														
Number	Description	Opened	Closed	Amount																																																																																													
R18 000384	R20- NEW 2468 SQ FT SFR	12/2018	05/2019	146,100																																																																																													
<b>Exemptions</b>					<b>Sale History</b>																																																																																												
<table border="1"> <thead> <tr> <th>Code</th> <th>Type</th> <th>Active</th> <th>Maximum</th> <th>Exemption</th> </tr> </thead> <tbody> <tr> <td></td> <td></td> <td></td> <td></td> <td></td> </tr> </tbody> </table>					Code	Type	Active	Maximum	Exemption						<table border="1"> <thead> <tr> <th>Bk/Pg</th> <th>Grantor</th> <th>Date</th> <th>Price</th> <th>Code</th> </tr> </thead> <tbody> <tr> <td>/</td> <td>SIMMONS HOMES RESIDENTIAL</td> <td>05/17/2019</td> <td>321,500</td> <td>YES</td> </tr> <tr> <td>/</td> <td>K &amp; S DEVELOPMENTS INC</td> <td>01/16/2019</td> <td>55,000</td> <td>15</td> </tr> </tbody> </table>					Bk/Pg	Grantor	Date	Price	Code	/	SIMMONS HOMES RESIDENTIAL	05/17/2019	321,500	YES	/	K & S DEVELOPMENTS INC	01/16/2019	55,000	15																																																															
Code	Type	Active	Maximum	Exemption																																																																																													
Bk/Pg	Grantor	Date	Price	Code																																																																																													
/	SIMMONS HOMES RESIDENTIAL	05/17/2019	321,500	YES																																																																																													
/	K & S DEVELOPMENTS INC	01/16/2019	55,000	15																																																																																													
<b>Parcel Valuation</b>																																																																																																	
<table border="1"> <thead> <tr> <th>Source</th> <th>REAL</th> </tr> </thead> <tbody> <tr> <td>Remove Cap</td> <td>2020</td> </tr> </tbody> </table>		Source	REAL	Remove Cap	2020	<table border="1"> <thead> <tr> <th>Fair Cash</th> <th>Capped</th> <th>Asmnt Level</th> <th>Assessed</th> </tr> </thead> <tbody> <tr> <td>Land Value</td> <td>109,535</td> <td>62,774</td> <td>6,905</td> </tr> <tr> <td>Improvements</td> <td>359,431</td> <td>358,881</td> <td>39,477</td> </tr> <tr> <td>Mobile Home</td> <td>0</td> <td>0</td> <td>0</td> </tr> <tr> <td>Total Value</td> <td>468,966</td> <td>421,655</td> <td>46,382</td> </tr> </tbody> </table>			Fair Cash	Capped	Asmnt Level	Assessed	Land Value	109,535	62,774	6,905	Improvements	359,431	358,881	39,477	Mobile Home	0	0	0	Total Value	468,966	421,655	46,382	<table border="1"> <thead> <tr> <th>Levy Rate</th> <th>Current Tax</th> </tr> </thead> <tbody> <tr> <td>97.960</td> <td>4,543.58</td> </tr> <tr> <td>Assessed</td> <td>46,382</td> </tr> <tr> <td>Penalty</td> <td>0</td> </tr> <tr> <td>Exemption</td> <td>0</td> </tr> <tr> <td>Total Taxable</td> <td>46,382</td> </tr> </tbody> </table>		Levy Rate	Current Tax	97.960	4,543.58	Assessed	46,382	Penalty	0	Exemption	0	Total Taxable	46,382																																																							
Source	REAL																																																																																																
Remove Cap	2020																																																																																																
Fair Cash	Capped	Asmnt Level	Assessed																																																																																														
Land Value	109,535	62,774	6,905																																																																																														
Improvements	359,431	358,881	39,477																																																																																														
Mobile Home	0	0	0																																																																																														
Total Value	468,966	421,655	46,382																																																																																														
Levy Rate	Current Tax																																																																																																
97.960	4,543.58																																																																																																
Assessed	46,382																																																																																																
Penalty	0																																																																																																
Exemption	0																																																																																																
Total Taxable	46,382																																																																																																
<b>Assessment History</b>																																																																																																	
<table border="1"> <thead> <tr> <th>Tax Year</th> <th>Statement Number</th> <th>Billed Owner</th> <th>Tax Area</th> <th>Total Value</th> <th>Exemptions</th> <th>Taxable Value</th> <th>Billed Tax</th> </tr> </thead> <tbody> <tr> <td>2025</td> <td>2025-660098684</td> <td>MADDEN, PAUL A &amp;</td> <td>3</td> <td>455,236</td> <td>0</td> <td>44,173</td> <td>4,327.00</td> </tr> <tr> <td>2024</td> <td>2024-660098684</td> <td>MADDEN, PAUL A &amp;</td> <td>3</td> <td>425,725</td> <td>0</td> <td>42,070</td> <td>4,042.00</td> </tr> <tr> <td>2023</td> <td>2023-660098684</td> <td>MADDEN, PAUL A &amp;</td> <td>3</td> <td>375,925</td> <td>0</td> <td>40,067</td> <td>3,755.00</td> </tr> <tr> <td>2022</td> <td>2022-660098684</td> <td>MADDEN, PAUL A &amp;</td> <td>3</td> <td>364,793</td> <td>0</td> <td>37,938</td> <td>3,717.00</td> </tr> <tr> <td>2021</td> <td>2021-660098684</td> <td>MADDEN, PAUL A &amp;</td> <td>3</td> <td>328,470</td> <td>0</td> <td>36,132</td> <td>3,495.00</td> </tr> <tr> <td>2020</td> <td>2020-660098684</td> <td>MADDEN, PAUL A &amp;</td> <td>3</td> <td>323,359</td> <td>0</td> <td>35,569</td> <td>3,436.00</td> </tr> <tr> <td>2019</td> <td>2019-660098684</td> <td>MADDEN, PAUL A &amp;</td> <td>3</td> <td>13,964</td> <td>0</td> <td>1,536</td> <td>148.00</td> </tr> <tr> <td>2018</td> <td>2018-660098684</td> <td>K &amp; S DEVELOPMENTS INC</td> <td>3</td> <td>13,964</td> <td>0</td> <td>1,536</td> <td>143.00</td> </tr> <tr> <td>2017</td> <td>2017-660098684</td> <td>K &amp; S DEVELOPMENTS INC</td> <td>3</td> <td>13,964</td> <td>0</td> <td>1,536</td> <td>144.00</td> </tr> <tr> <td>2016</td> <td>2016-660098684</td> <td>K &amp; S DEVELOPMENTS INC</td> <td>3</td> <td>13,964</td> <td>0</td> <td>1,536</td> <td>145.00</td> </tr> </tbody> </table>										Tax Year	Statement Number	Billed Owner	Tax Area	Total Value	Exemptions	Taxable Value	Billed Tax	2025	2025-660098684	MADDEN, PAUL A &	3	455,236	0	44,173	4,327.00	2024	2024-660098684	MADDEN, PAUL A &	3	425,725	0	42,070	4,042.00	2023	2023-660098684	MADDEN, PAUL A &	3	375,925	0	40,067	3,755.00	2022	2022-660098684	MADDEN, PAUL A &	3	364,793	0	37,938	3,717.00	2021	2021-660098684	MADDEN, PAUL A &	3	328,470	0	36,132	3,495.00	2020	2020-660098684	MADDEN, PAUL A &	3	323,359	0	35,569	3,436.00	2019	2019-660098684	MADDEN, PAUL A &	3	13,964	0	1,536	148.00	2018	2018-660098684	K & S DEVELOPMENTS INC	3	13,964	0	1,536	143.00	2017	2017-660098684	K & S DEVELOPMENTS INC	3	13,964	0	1,536	144.00	2016	2016-660098684	K & S DEVELOPMENTS INC	3	13,964	0	1,536	145.00
Tax Year	Statement Number	Billed Owner	Tax Area	Total Value	Exemptions	Taxable Value	Billed Tax																																																																																										
2025	2025-660098684	MADDEN, PAUL A &	3	455,236	0	44,173	4,327.00																																																																																										
2024	2024-660098684	MADDEN, PAUL A &	3	425,725	0	42,070	4,042.00																																																																																										
2023	2023-660098684	MADDEN, PAUL A &	3	375,925	0	40,067	3,755.00																																																																																										
2022	2022-660098684	MADDEN, PAUL A &	3	364,793	0	37,938	3,717.00																																																																																										
2021	2021-660098684	MADDEN, PAUL A &	3	328,470	0	36,132	3,495.00																																																																																										
2020	2020-660098684	MADDEN, PAUL A &	3	323,359	0	35,569	3,436.00																																																																																										
2019	2019-660098684	MADDEN, PAUL A &	3	13,964	0	1,536	148.00																																																																																										
2018	2018-660098684	K & S DEVELOPMENTS INC	3	13,964	0	1,536	143.00																																																																																										
2017	2017-660098684	K & S DEVELOPMENTS INC	3	13,964	0	1,536	144.00																																																																																										
2016	2016-660098684	K & S DEVELOPMENTS INC	3	13,964	0	1,536	145.00																																																																																										



# Rogers

## Assessment Property Record Card for Tax Year 2026

Data provided by LISA DELOZIER County Assessor

Date 04/18/2026  
 Time 09:12:46  
 Page 2

Lot Data		Square-Foot - NBHD 1042 #1	
Lot Size	0	0	
Lot Count	1		
Units Buildable			
Non-Ag Acres	0.5971		
Topography			
Street Access			
Utilities			
Amenities		0	
		0	
Method	Square-Foot		
Base Lot Value	26,011.00 x 4.21 = 109,535		
Factor Value			
Adjustments	1.0000		
Lot Value	109,535		



\\tsclient\TCASEY\CASEY BOOTH RESIDENTIAL VI\2022-9-1\IM 9/2/2022

Residential Data	
Type	1 Single Family Residence
Condition	3 - Average
Quality	3.5 - Average
Architecture	
Style	100% One Story
Exterior Wall	95% Veneer, Masonry 5% Veneer, Stone
Base/Total Area	2,397 / 2,397
Style	100% One Story
HVAC	100% Warmed & Cooled Air
Roof Cover	1 Composition Shingle
Area on Slab	2,397
Fixture/RghIn	22 /
Bed/F/H Bath	4 / 3.0 /
Basement Area	
Garage Type	660 Attached Garage - Unfinished
Remodel	
Year/Eff Age	2019 / 5

GRM Approach	
GRM Code	
Gross Rent	0.00
Indicated Value	

Multiple Regression			
MRA Code	1	Test	
Adusted R	0.8445		
Indicated Value	346,959	144.75	Per SqFt

Direct Comparables			
Selection Model	A	Adam Test	
Adjustment Model	1	2022 Residential	
Comparables	3		
Indicated Value	375,220		Per SqFt

Cost Approach		Manual : 01/2025	
Base Cost	109,57	Total Misc Impr	+ 15,012
Roofing Adj	+ 5.20	Garage Cost	+ 24,869
Subfloor Adj	+ -3.40	Total RCN	= 376,132
Heat/Cool Adj	+ 14.47	Depreciation ( 5%)	- 18,807
Plumbing Adj	+ 14.44	Lump Sums	+ 0
Basement Adj	+ 0.00	RCNLD	= 357,325
Adj Base Cost	= 140.28	Lot Value	+ 109,535
Total Area	x 2,397	Indicated Value	= 466,860
Adjusted Cost	= 336,251	Value Per SqFt	194.77

Value Reconciliation			
Selected Approach	Cost Approach		
Improvements	357,325		
Lot Value	109,535		
Indicated Value	466,860	194.77	Per SqFt
Agland Value			
Site Improvements	2,106		
Total Value	468,966	195.65	Total Value Per SqFt

Miscellaneous Improvements								
Code	Description	Sketch ID	Size	Year	Units	Unit Cost	Depr	Value
FPR1	Fireplace - Residential 1 Story	0		1	1	6,429.63		6,430
PRCH	SLAB PORCH - COVERED	141205	15x10		150	29.00		4,350
PRCH	Slab Porch - Covered	141206	7x6		42	29.40		1,235
PATO	Slab Porch - Open	154904	20x15		300	9.99		2,997



**Rogers**  
**Assessment Property Record Card for Tax Year 2026**

Data provided by LISA DELOZIER County Assessor

Date 04/18/2026  
 Time 09:12:46  
 Page 3

Sketch Image

660098684

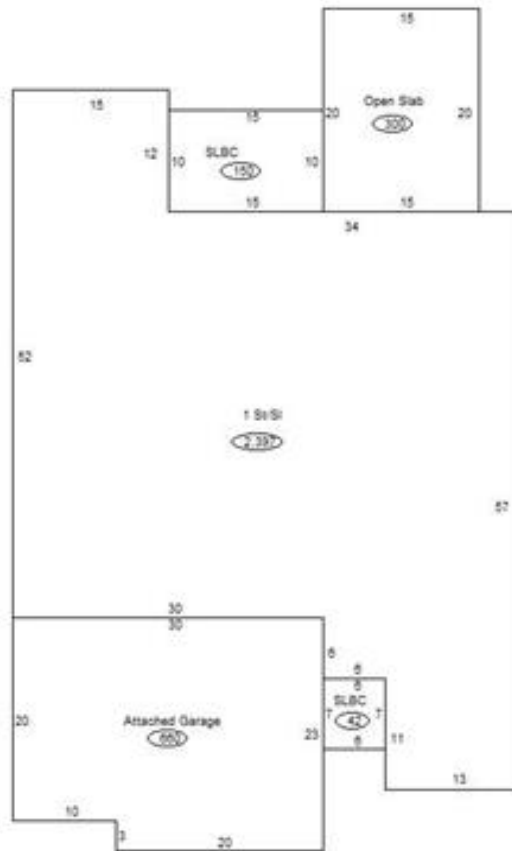

**Sketch Vector Information**

Sequence	Code	Type	Built Over	Scale	Section Label	Base Area	Multiplier	Total Area
1	R	1	Slab	13	1 St/SI	2,397	1.000	2,397
2	G	1		13	Attached Garage	660	1.000	660
3	M	PRCH		13	SLBC	150	1.000	150
4	M	PRCH		13	SLBC	42	1.000	42
5	M	PATO		13	Open Slab	300	1.000	300
<b>Total Building Area</b>						<b>2,397</b>		<b>2,397</b>



# Rogers

## Assessment Property Record Card for Tax Year 2026

Data provided by LISA DELOZIER County Assessor

Date 04/18/2026  
Time 09:12:46  
Page 4

660098684

### Outbuildings/Site Improvements

Building Image	Code	Description	Dimensions	Floor	Roofing	Total Units
	STA	STG AVG	20x15x0			300
	Qual	2	Cond 3	Year 2020	Eff Age	
<b>Valuation Summary</b>		<b>Modifier Total</b>		<b>RCN</b>	<b>Depr (0% Phys/ % Func)</b>	<b>RCNLD</b>
Base Cost (7.02 x 300)		2,106			2,106	2,106