



# Rogers

## Assessment Property Record Card for Tax Year 2026

Data provided by LISA DELOZIER County Assessor

Date 04/18/2026  
Time 09:12:53  
Page 1

Assessment Data					Primary Image																																																																																												
<b>Account</b> 660098688 <b>Parcel ID</b> 21N14E-11-2-00649-004-0015 <b>Cadastral ID</b> 11-21-14-06840 <b>Property Type</b> REAL - Real Property <b>Property Class</b> RRP VI Area 4 <b>Tax Area</b> 3 - OWASSO RURAL/NO FIRE <b>Name ID</b> 338675 MICHALEC, MICKEY JOE & JESSICA MARIE REVOCABLE LIVING TRUST 11315 N 166TH E AVE OWASSO OK 74055-0000																																																																																																	
<b>Parcel Location</b> <b>Situs</b> 11315 N 166TH E AVE <b>Subdivision</b> QUAILBROOK ESTATES PHASE 2 <b>Lot/Block</b> 0015 / 0004 <b>Parcel Size</b> 1 - Lots <b>Sec/Twn/Rng</b> 11 / 21 / 14 / 5 <b>Neighborhood</b> 1042 - R-V03-SW OWASSO <b>School District</b> S021 - OWASSO SCHOOLS																																																																																																	
<b>Legal Description</b> Lat/Long: 36.31909700 -95.78734898					<b>Building Permits</b> <table border="1"> <thead> <tr> <th>Number</th> <th>Description</th> <th>Opened</th> <th>Closed</th> <th>Amount</th> </tr> </thead> <tbody> <tr> <td>R2016 05 21</td> <td>R17-NEW 2953 SQ FT SFR</td> <td>05/2016</td> <td>11/2016</td> <td>174,720</td> </tr> </tbody> </table>					Number	Description	Opened	Closed	Amount	R2016 05 21	R17-NEW 2953 SQ FT SFR	05/2016	11/2016	174,720																																																																														
Number	Description	Opened	Closed	Amount																																																																																													
R2016 05 21	R17-NEW 2953 SQ FT SFR	05/2016	11/2016	174,720																																																																																													
<b>Exemptions</b> <table border="1"> <thead> <tr> <th>Code</th> <th>Type</th> <th>Active</th> <th>Maximum</th> <th>Exemption</th> </tr> </thead> <tbody> <tr> <td>H</td> <td>Homestead</td> <td>No</td> <td>1,000</td> <td></td> </tr> </tbody> </table>					Code	Type	Active	Maximum	Exemption	H	Homestead	No	1,000		<b>Sale History</b> <table border="1"> <thead> <tr> <th>Bk/Pg</th> <th>Grantor</th> <th>Date</th> <th>Price</th> <th>Code</th> </tr> </thead> <tbody> <tr> <td>/</td> <td>FORT, JUSTIN &amp; REAGAN</td> <td>06/06/2022</td> <td>488,500</td> <td>YES</td> </tr> <tr> <td>2588/510</td> <td>SIMMONS HOMES RESIDENTIAL</td> <td>10/27/2016</td> <td>360,000</td> <td>YES</td> </tr> <tr> <td>2562/835</td> <td>K &amp; S DEVELOPMENTS INC</td> <td>05/10/2016</td> <td>110,000</td> <td>WB</td> </tr> </tbody> </table>					Bk/Pg	Grantor	Date	Price	Code	/	FORT, JUSTIN & REAGAN	06/06/2022	488,500	YES	2588/510	SIMMONS HOMES RESIDENTIAL	10/27/2016	360,000	YES	2562/835	K & S DEVELOPMENTS INC	05/10/2016	110,000	WB																																																										
Code	Type	Active	Maximum	Exemption																																																																																													
H	Homestead	No	1,000																																																																																														
Bk/Pg	Grantor	Date	Price	Code																																																																																													
/	FORT, JUSTIN & REAGAN	06/06/2022	488,500	YES																																																																																													
2588/510	SIMMONS HOMES RESIDENTIAL	10/27/2016	360,000	YES																																																																																													
2562/835	K & S DEVELOPMENTS INC	05/10/2016	110,000	WB																																																																																													
<b>Parcel Valuation</b> <table border="1"> <thead> <tr> <th>Source</th> <th>REAL</th> <th>Fair Cash</th> <th>Capped</th> <th>Asmnt Level</th> <th>Assessed</th> <th>Levy Rate</th> <th>97.960</th> <th>Current Tax</th> </tr> </thead> <tbody> <tr> <td>Remove Cap</td> <td>2023</td> <td>Land Value 122,417</td> <td>89,988</td> <td>11%</td> <td>9,899</td> <td>Assessed</td> <td>52,463</td> <td>5,139.28</td> </tr> <tr> <td>Year Frozen</td> <td></td> <td>Improvements 386,947</td> <td>386,947</td> <td></td> <td>42,564</td> <td>Penalty</td> <td>0</td> <td></td> </tr> <tr> <td>Uncapped Value</td> <td>0</td> <td>Mobile Home 0</td> <td>0</td> <td></td> <td>0</td> <td>Exemption</td> <td>0</td> <td>0.00</td> </tr> <tr> <td>TIF Project ID</td> <td>0</td> <td>Total Value 509,364</td> <td>476,935</td> <td></td> <td>52,463</td> <td>Total Taxable</td> <td>52,463</td> <td>5,139.00</td> </tr> </tbody> </table>										Source	REAL	Fair Cash	Capped	Asmnt Level	Assessed	Levy Rate	97.960	Current Tax	Remove Cap	2023	Land Value 122,417	89,988	11%	9,899	Assessed	52,463	5,139.28	Year Frozen		Improvements 386,947	386,947		42,564	Penalty	0		Uncapped Value	0	Mobile Home 0	0		0	Exemption	0	0.00	TIF Project ID	0	Total Value 509,364	476,935		52,463	Total Taxable	52,463	5,139.00																																											
Source	REAL	Fair Cash	Capped	Asmnt Level	Assessed	Levy Rate	97.960	Current Tax																																																																																									
Remove Cap	2023	Land Value 122,417	89,988	11%	9,899	Assessed	52,463	5,139.28																																																																																									
Year Frozen		Improvements 386,947	386,947		42,564	Penalty	0																																																																																										
Uncapped Value	0	Mobile Home 0	0		0	Exemption	0	0.00																																																																																									
TIF Project ID	0	Total Value 509,364	476,935		52,463	Total Taxable	52,463	5,139.00																																																																																									
<b>Assessment History</b> <table border="1"> <thead> <tr> <th>Tax Year</th> <th>Statement Number</th> <th>Billed Owner</th> <th>Tax Area</th> <th>Total Value</th> <th>Exemptions</th> <th>Taxable Value</th> <th>Billed Tax</th> </tr> </thead> <tbody> <tr> <td>2025</td> <td>2025-660098688</td> <td>MICHALEC, MICKEY JOE &amp;</td> <td>3</td> <td>497,967</td> <td>0</td> <td>49,965</td> <td>4,895.00</td> </tr> <tr> <td>2024</td> <td>2024-660098688</td> <td>MICHALEC, MICKEY JOE &amp;</td> <td>3</td> <td>465,838</td> <td>0</td> <td>47,586</td> <td>4,572.00</td> </tr> <tr> <td>2023</td> <td>2023-660098688</td> <td>MICHALEC, MICKEY JOE &amp;</td> <td>3</td> <td>411,996</td> <td>0</td> <td>45,320</td> <td>4,247.00</td> </tr> <tr> <td>2022</td> <td>2022-660098688</td> <td>MICHALEC, MICKEY JOE &amp;</td> <td>3</td> <td>391,905</td> <td>1000</td> <td>38,874</td> <td>3,808.00</td> </tr> <tr> <td>2021</td> <td>2021-660098688</td> <td>FORT, JUSTIN &amp; REAGAN</td> <td>3</td> <td>354,368</td> <td>1000</td> <td>37,713</td> <td>3,648.00</td> </tr> <tr> <td>2020</td> <td>2020-660098688</td> <td>FORT, JUSTIN &amp; REAGAN</td> <td>3</td> <td>348,657</td> <td>1000</td> <td>36,586</td> <td>3,534.00</td> </tr> <tr> <td>2019</td> <td>2019-660098688</td> <td>FORT, JUSTIN &amp; REAGAN</td> <td>3</td> <td>331,735</td> <td>1000</td> <td>35,491</td> <td>3,431.00</td> </tr> <tr> <td>2018</td> <td>2018-660098688</td> <td>FORT, JUSTIN &amp; REAGAN</td> <td>3</td> <td>339,859</td> <td>1000</td> <td>36,384</td> <td>3,387.00</td> </tr> <tr> <td>2017</td> <td>2017-660098688</td> <td>FORT, JUSTIN &amp; REAGAN</td> <td>3</td> <td>362,639</td> <td>1000</td> <td>38,890</td> <td>3,658.00</td> </tr> <tr> <td>2016</td> <td>2016-660098688</td> <td>SIMMONS HOMES RESIDENTIAL</td> <td>3</td> <td>13,964</td> <td>0</td> <td>1,536</td> <td>145.00</td> </tr> </tbody> </table>										Tax Year	Statement Number	Billed Owner	Tax Area	Total Value	Exemptions	Taxable Value	Billed Tax	2025	2025-660098688	MICHALEC, MICKEY JOE &	3	497,967	0	49,965	4,895.00	2024	2024-660098688	MICHALEC, MICKEY JOE &	3	465,838	0	47,586	4,572.00	2023	2023-660098688	MICHALEC, MICKEY JOE &	3	411,996	0	45,320	4,247.00	2022	2022-660098688	MICHALEC, MICKEY JOE &	3	391,905	1000	38,874	3,808.00	2021	2021-660098688	FORT, JUSTIN & REAGAN	3	354,368	1000	37,713	3,648.00	2020	2020-660098688	FORT, JUSTIN & REAGAN	3	348,657	1000	36,586	3,534.00	2019	2019-660098688	FORT, JUSTIN & REAGAN	3	331,735	1000	35,491	3,431.00	2018	2018-660098688	FORT, JUSTIN & REAGAN	3	339,859	1000	36,384	3,387.00	2017	2017-660098688	FORT, JUSTIN & REAGAN	3	362,639	1000	38,890	3,658.00	2016	2016-660098688	SIMMONS HOMES RESIDENTIAL	3	13,964	0	1,536	145.00
Tax Year	Statement Number	Billed Owner	Tax Area	Total Value	Exemptions	Taxable Value	Billed Tax																																																																																										
2025	2025-660098688	MICHALEC, MICKEY JOE &	3	497,967	0	49,965	4,895.00																																																																																										
2024	2024-660098688	MICHALEC, MICKEY JOE &	3	465,838	0	47,586	4,572.00																																																																																										
2023	2023-660098688	MICHALEC, MICKEY JOE &	3	411,996	0	45,320	4,247.00																																																																																										
2022	2022-660098688	MICHALEC, MICKEY JOE &	3	391,905	1000	38,874	3,808.00																																																																																										
2021	2021-660098688	FORT, JUSTIN & REAGAN	3	354,368	1000	37,713	3,648.00																																																																																										
2020	2020-660098688	FORT, JUSTIN & REAGAN	3	348,657	1000	36,586	3,534.00																																																																																										
2019	2019-660098688	FORT, JUSTIN & REAGAN	3	331,735	1000	35,491	3,431.00																																																																																										
2018	2018-660098688	FORT, JUSTIN & REAGAN	3	339,859	1000	36,384	3,387.00																																																																																										
2017	2017-660098688	FORT, JUSTIN & REAGAN	3	362,639	1000	38,890	3,658.00																																																																																										
2016	2016-660098688	SIMMONS HOMES RESIDENTIAL	3	13,964	0	1,536	145.00																																																																																										



# Rogers

## Assessment Property Record Card for Tax Year 2026

Data provided by LISA DELOZIER County Assessor

Date 04/18/2026  
 Time 09:12:53  
 Page 2

Lot Data		Square-Foot - NBHD 1042 #1	
Lot Size	0	0	
Lot Count	1		
Units Buildable			
Non-Ag Acres	0.6674		
Topography			
Street Access			
Utilities			
Amenities		0	
		0	
Method	Square-Foot		
Base Lot Value	29,070.00 x 4.21 = 122,417		
Factor Value			
Adjustments	1.0000		
Lot Value	122,417		



\\tsclient\TCASEY\CASEY BOOTH RESIDENTIAL VI\2022-9-1\IM 9/2/2022

Residential Data	
Type	1 Single Family Residence
Condition	3 - Average
Quality	3.5 - Average
Architecture	
Style	100% One Story
Exterior Wall	95% Veneer, Masonry 5% Veneer, Stone
Base/Total Area	2,951 / 2,951
Style	100% One Story
HVAC	100% Warmed & Cooled Air
Roof Cover	1 Composition Shingle
Area on Slab	2,951
Fixture/RghIn	16 /
Bed/F/H Bath	4 / 3.0 / 1.0
Basement Area	
Garage Type	736 Attached Garage - Unfinished
Remodel	
Year/Eff Age	2016 / 8

GRM Approach	
GRM Code	
Gross Rent	0.00
Indicated Value	

Multiple Regression			
MRA Code	1	Test	
Adusted R	0.8445		
Indicated Value	392,572	133.03	Per SqFt

Direct Comparables			
Selection Model	A	Adam Test	
Adjustment Model	1	2022 Residential	
Comparables	4		
Indicated Value	445,520		Per SqFt

Cost Approach		Manual : 01/2025	
Base Cost	105.71	Total Misc Impr	+ 7,807
Roofing Adj	+ 5.03	Garage Cost	+ 27,387
Subfloor Adj	+ -3.22	Total RCN	= 420,595
Heat/Cool Adj	+ 14.47	Depreciation ( 8%)	- 33,648
Plumbing Adj	+ 8.61	Lump Sums	+ 0
Basement Adj	+ 0.00	RCNLD	= 386,947
Adj Base Cost	= 130.60	Lot Value	+ 122,417
Total Area	x 2,951	Indicated Value	= 509,364
Adjusted Cost	= 385,401	Value Per SqFt	172.61

Value Reconciliation			
Selected Approach	Cost Approach		
Improvements	386,947		
Lot Value	122,417		
Indicated Value	509,364	172.61	Per SqFt
Agland Value			
Site Improvements			
Total Value	509,364	172.61	Total Value Per SqFt

Miscellaneous Improvements								
Code	Description	Sketch ID	Size	Year	Units	Unit Cost	Depr	Value
PRCH	SLAB PORCH - COVERED	130809	18x7		126	29.10		3,667
PATO	SLAB PORCH - OPEN	130810	18x4		72	12.93		931
PRCH	SLAB PORCH - COVERED	130811	22x5		110	29.17		3,209



# Rogers

## Assessment Property Record Card for Tax Year 2026

Data provided by LISA DELOZIER County Assessor

Date 04/18/2026

Time 09:12:53

Page 3

Sketch Image

660098688

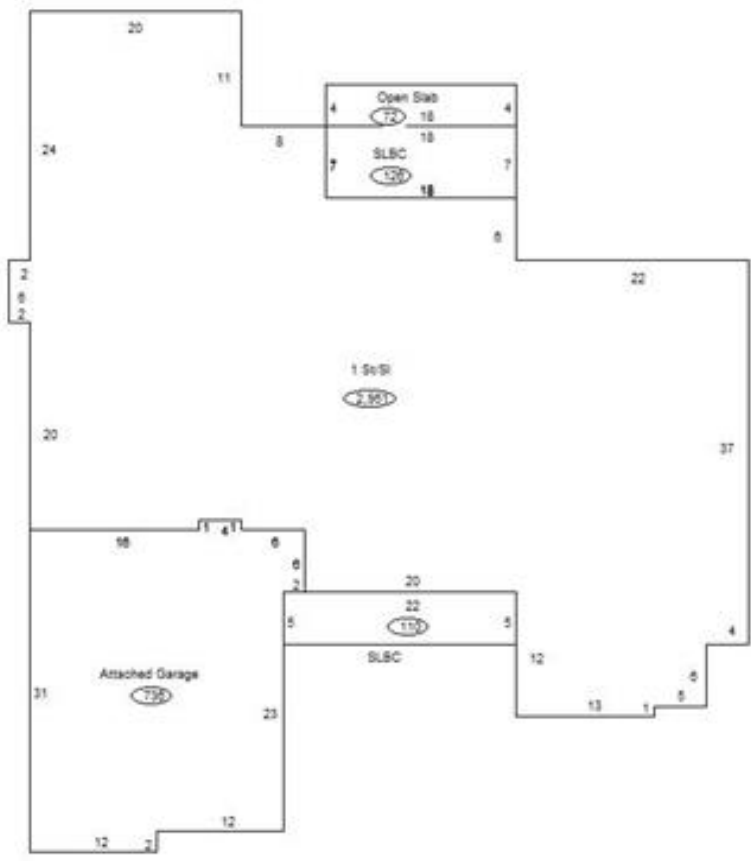

### Sketch Vector Information

Sequence	Code	Type	Built Over	Scale	Section Label	Base Area	Multiplier	Total Area
1	R	1	Slab	13	1 St/SI	2,951	1.000	2,951
2	G	1		13	Attached Garage	736	1.000	736
3	M	PRCH		13	SLBC	126	1.000	126
4	M	PATO		13	Open Slab	72	1.000	72
5	M	PRCH		13	SLBC	110	1.000	110
<b>Total Building Area</b>						2,951		2,951