



# Rogers

## Assessment Property Record Card for Tax Year 2026

Data provided by LISA DELOZIER County Assessor

Date 04/18/2026  
Time 09:14:05  
Page 1

Assessment Data					Primary Image																																																																																												
<b>Account</b> 660098817 <b>Parcel ID</b> 22N17E-26-4-00000-000-0002 <b>Cadastral ID</b> 26-22-17-00211 <b>Property Type</b> REAL - Real Property <b>Property Class</b> RR VI Area 2 <b>Tax Area</b> 94 - SEQUOYAH/TRI-DISTRICT FI <b>Name ID</b> 321966 RICE, KERY GLENN & KENZIE  20575 E 460 RD CLAREMORE OK 74019-0000  <b>Parcel Location</b> <b>Situs</b> 20575 E 460 RD <b>Subdivision</b> <b>Lot/Block</b> / <b>Parcel Size</b> 3.38 - Acres <b>Sec/Twn/Rng</b> 26 / 22 / 17 / 4 <b>Neighborhood</b> 4070 - FOYIL SEQUOYAH AREA <b>School District</b> S006 - SEQUOYAH SCHOOLS					<p>11/20/2020 11:00</p> <p>\\tsclient\TCASEY\CASEY BOOTH VISUAL INSPECTION\2020-1' 11/20/2020</p>																																																																																												
<b>Legal Description</b> Lat/Long: 36.35136768 -95.46148421 TR BEG SW/C SW SW SE; N01.0739W 163.10'; L CURVE RAD 11609.16' ARC LENGTH 563.86'; CHORD BEARING N48.5140E DIST 563.81'; S00 0739E 534.12'; N89.5913W 425.44' TO POB.																																																																																																	
<b>Exemptions</b> <table border="1"> <thead> <tr> <th>Code</th> <th>Type</th> <th>Active</th> <th>Maximum</th> <th>Exemption</th> </tr> </thead> <tbody> <tr> <td>H</td> <td>Homestead</td> <td>Yes</td> <td>1,000</td> <td>1,000</td> </tr> </tbody> </table>					Code	Type	Active	Maximum	Exemption	H	Homestead	Yes	1,000	1,000	<b>Building Permits</b> <table border="1"> <thead> <tr> <th>Number</th> <th>Description</th> <th>Opened</th> <th>Closed</th> <th>Amount</th> </tr> </thead> <tbody> <tr> <td></td> <td></td> <td></td> <td></td> <td></td> </tr> </tbody> </table>					Number	Description	Opened	Closed	Amount																																																																									
Code	Type	Active	Maximum	Exemption																																																																																													
H	Homestead	Yes	1,000	1,000																																																																																													
Number	Description	Opened	Closed	Amount																																																																																													
<b>Parcel Valuation</b> <table border="1"> <thead> <tr> <th>Source</th> <th>REAL</th> <th>Fair Cash</th> <th>Capped</th> <th>Asmnt Level</th> <th>Assessed</th> <th>Levy Rate</th> <th>98.320</th> <th>Current Tax</th> </tr> </thead> <tbody> <tr> <td>Remove Cap</td> <td>2018</td> <td>Land Value</td> <td>63,577</td> <td>51,798</td> <td>11%</td> <td>5,698</td> <td>Assessed</td> <td>11,118 1,093.12</td> </tr> <tr> <td>Year Frozen</td> <td>0</td> <td>Improvements</td> <td>49,275</td> <td>49,275</td> <td></td> <td>5,420</td> <td>Penalty</td> <td>0</td> </tr> <tr> <td>Uncapped Value</td> <td>0</td> <td>Mobile Home</td> <td>0</td> <td>0</td> <td></td> <td>0</td> <td>Exemption</td> <td>1,000 -88.00</td> </tr> <tr> <td>TIF Project ID</td> <td>0</td> <td>Total Value</td> <td>112,852</td> <td>101,073</td> <td></td> <td>11,118</td> <td>Total Taxable</td> <td>10,118 1,005.00</td> </tr> </tbody> </table>					Source	REAL	Fair Cash	Capped	Asmnt Level	Assessed	Levy Rate	98.320	Current Tax	Remove Cap	2018	Land Value	63,577	51,798	11%	5,698	Assessed	11,118 1,093.12	Year Frozen	0	Improvements	49,275	49,275		5,420	Penalty	0	Uncapped Value	0	Mobile Home	0	0		0	Exemption	1,000 -88.00	TIF Project ID	0	Total Value	112,852	101,073		11,118	Total Taxable	10,118 1,005.00	<b>Sale History</b> <table border="1"> <thead> <tr> <th>Bk/Pg</th> <th>Grantor</th> <th>Date</th> <th>Price</th> <th>Code</th> </tr> </thead> <tbody> <tr> <td>2647/612</td> <td>CLINTON, JOSEPH R &amp; CANDY J</td> <td>07/18/2017</td> <td>87,500</td> <td>4</td> </tr> <tr> <td>2509/374</td> <td>GOOCH, JOSEPH C &amp; CLAUDIA R</td> <td>10/30/2015</td> <td>32,500</td> <td>YES</td> </tr> </tbody> </table>					Bk/Pg	Grantor	Date	Price	Code	2647/612	CLINTON, JOSEPH R & CANDY J	07/18/2017	87,500	4	2509/374	GOOCH, JOSEPH C & CLAUDIA R	10/30/2015	32,500	YES																												
Source	REAL	Fair Cash	Capped	Asmnt Level	Assessed	Levy Rate	98.320	Current Tax																																																																																									
Remove Cap	2018	Land Value	63,577	51,798	11%	5,698	Assessed	11,118 1,093.12																																																																																									
Year Frozen	0	Improvements	49,275	49,275		5,420	Penalty	0																																																																																									
Uncapped Value	0	Mobile Home	0	0		0	Exemption	1,000 -88.00																																																																																									
TIF Project ID	0	Total Value	112,852	101,073		11,118	Total Taxable	10,118 1,005.00																																																																																									
Bk/Pg	Grantor	Date	Price	Code																																																																																													
2647/612	CLINTON, JOSEPH R & CANDY J	07/18/2017	87,500	4																																																																																													
2509/374	GOOCH, JOSEPH C & CLAUDIA R	10/30/2015	32,500	YES																																																																																													
<b>Assessment History</b> <table border="1"> <thead> <tr> <th>Tax Year</th> <th>Statement Number</th> <th>Billed Owner</th> <th>Tax Area</th> <th>Total Value</th> <th>Exemptions</th> <th>Taxable Value</th> <th>Billed Tax</th> </tr> </thead> <tbody> <tr> <td>2025</td> <td>2025-660098817</td> <td>RICE, KERY GLENN &amp;</td> <td>94</td> <td>109,792</td> <td>1000</td> <td>9,795</td> <td>973.00</td> </tr> <tr> <td>2024</td> <td>2024-660098817</td> <td>RICE, KERY GLENN &amp;</td> <td>94</td> <td>105,530</td> <td>1000</td> <td>9,480</td> <td>1,009.00</td> </tr> <tr> <td>2023</td> <td>2023-660098817</td> <td>RICE, KERY GLENN &amp;</td> <td>94</td> <td>92,498</td> <td>1000</td> <td>9,175</td> <td>996.00</td> </tr> <tr> <td>2022</td> <td>2022-660098817</td> <td>RICE, KERY GLENN &amp;</td> <td>94</td> <td>93,936</td> <td>1000</td> <td>9,030</td> <td>989.00</td> </tr> <tr> <td>2021</td> <td>2021-660098817</td> <td>RICE, KERY GLENN &amp;</td> <td>94</td> <td>96,841</td> <td>1000</td> <td>8,737</td> <td>927.00</td> </tr> <tr> <td>2020</td> <td>2020-660098817</td> <td>RICE, KERY GLENN &amp;</td> <td>94</td> <td>91,607</td> <td>1000</td> <td>8,454</td> <td>893.00</td> </tr> <tr> <td>2019</td> <td>2019-660098817</td> <td>RICE, KERY GLENN &amp;</td> <td>94</td> <td>83,441</td> <td>1000</td> <td>8,179</td> <td>852.00</td> </tr> <tr> <td>2018</td> <td>2018-660098817</td> <td>RICE, KERY GLENN &amp;</td> <td>94</td> <td>88,348</td> <td>0</td> <td>9,718</td> <td>1,007.00</td> </tr> <tr> <td>2017</td> <td>2017-660098817</td> <td>RICE, KERY GLENN &amp;</td> <td>94</td> <td>36,470</td> <td>0</td> <td>4,012</td> <td>410.00</td> </tr> <tr> <td>2016</td> <td>2016-660098817</td> <td>CLINTON, JOSEPH R &amp; CANDY J</td> <td>94</td> <td>36,607</td> <td>0</td> <td>4,027</td> <td>410.00</td> </tr> </tbody> </table>										Tax Year	Statement Number	Billed Owner	Tax Area	Total Value	Exemptions	Taxable Value	Billed Tax	2025	2025-660098817	RICE, KERY GLENN &	94	109,792	1000	9,795	973.00	2024	2024-660098817	RICE, KERY GLENN &	94	105,530	1000	9,480	1,009.00	2023	2023-660098817	RICE, KERY GLENN &	94	92,498	1000	9,175	996.00	2022	2022-660098817	RICE, KERY GLENN &	94	93,936	1000	9,030	989.00	2021	2021-660098817	RICE, KERY GLENN &	94	96,841	1000	8,737	927.00	2020	2020-660098817	RICE, KERY GLENN &	94	91,607	1000	8,454	893.00	2019	2019-660098817	RICE, KERY GLENN &	94	83,441	1000	8,179	852.00	2018	2018-660098817	RICE, KERY GLENN &	94	88,348	0	9,718	1,007.00	2017	2017-660098817	RICE, KERY GLENN &	94	36,470	0	4,012	410.00	2016	2016-660098817	CLINTON, JOSEPH R & CANDY J	94	36,607	0	4,027	410.00
Tax Year	Statement Number	Billed Owner	Tax Area	Total Value	Exemptions	Taxable Value	Billed Tax																																																																																										
2025	2025-660098817	RICE, KERY GLENN &	94	109,792	1000	9,795	973.00																																																																																										
2024	2024-660098817	RICE, KERY GLENN &	94	105,530	1000	9,480	1,009.00																																																																																										
2023	2023-660098817	RICE, KERY GLENN &	94	92,498	1000	9,175	996.00																																																																																										
2022	2022-660098817	RICE, KERY GLENN &	94	93,936	1000	9,030	989.00																																																																																										
2021	2021-660098817	RICE, KERY GLENN &	94	96,841	1000	8,737	927.00																																																																																										
2020	2020-660098817	RICE, KERY GLENN &	94	91,607	1000	8,454	893.00																																																																																										
2019	2019-660098817	RICE, KERY GLENN &	94	83,441	1000	8,179	852.00																																																																																										
2018	2018-660098817	RICE, KERY GLENN &	94	88,348	0	9,718	1,007.00																																																																																										
2017	2017-660098817	RICE, KERY GLENN &	94	36,470	0	4,012	410.00																																																																																										
2016	2016-660098817	CLINTON, JOSEPH R & CANDY J	94	36,607	0	4,027	410.00																																																																																										



# Rogers

## Assessment Property Record Card for Tax Year 2026

Data provided by LISA DELOZIER County Assessor

Date 04/18/2026  
 Time 09:14:05  
 Page 2

Lot Data		Square-Foot - NBHD 4070 #1	
Lot Size			
Lot Count			
Units Buildable			
Non-Ag Acres	3.8381		
Topography			
Street Access			
Utilities			
Amenities	LAND QUALITY	0	0
Method	Square-Foot		
Base Lot Value	167,186.00 x .38 = 63,577		
Factor Value			
Adjustments	1.0000		
Lot Value	63,577		



\\tsclient\TCASEY\CASEY BOOTH VISUAL INSPECTION\2020-1' 11/20/2020

Residential Data	
Type	1 Single Family Residence
Condition	3 - Average
Quality	2.5 - Fair
Architecture	TRAD TRADITIONAL
Style	100% One Story
Exterior Wall	100% Frame, Siding, Vinyl
Base/Total Area	1,431 / 1,431
Style	100% One Story
HVAC	100% Warmed & Cooled Air
Roof Cover	1 Composition Shingle
Area on Slab	1,431
Fixture/RghIn	4 /
Bed/F/H Bath	3 / 1.0 /
Basement Area	
Garage Type	
Remodel	
Year/Eff Age	1940 / 65

GRM Approach	
GRM Code	
Gross Rent	0.00
Indicated Value	

Multiple Regression	
MRA Code	1 Test
Adusted R	0.8445
Indicated Value	82,432 57.60 Per SqFt

Direct Comparables	
Selection Model	1 Res
Adjustment Model	A2 AO Test
Comparables	
Indicated Value	

Cost Approach				Manual : 01/2025	
Base Cost	92.05	Total Misc Impr	+	725	
Roofing Adj	+ 4.28	Garage Cost	+		
Subfloor Adj	+ -1.13	Total RCN	=	158,951	
Heat/Cool Adj	+ 11.47	Depreciation ( 69%)	-	109,676	
Plumbing Adj	+ 3.90	Lump Sums	+	0	
Basement Adj	+ 0.00	RCNLD	=	49,275	
Adj Base Cost	= 110.57	Lot Value	+	63,577	
Total Area	x 1,431	Indicated Value	=	112,852	
Adjusted Cost	= 158,226	Value Per SqFt		78.86	

Value Reconciliation	
Selected Approach	Cost Approach
Improvements	49,275
Lot Value	63,577
Indicated Value	112,852 78.86 Per SqFt
Agland Value	
Site Improvements	
Total Value	112,852 78.86 Total Value Per SqFt

Miscellaneous Improvements							
Code	Description	Sketch ID	Size	Year	Units	Unit Cost	Depr Value
PRCH	SLAB PORCH - COVERED	148520	6x5		30	24.17	725



# Rogers

## Assessment Property Record Card for Tax Year 2026

Data provided by LISA DELOZIER County Assessor

Date 04/18/2026

Time 09:14:05

Page 3

### Sketch Image

660098817

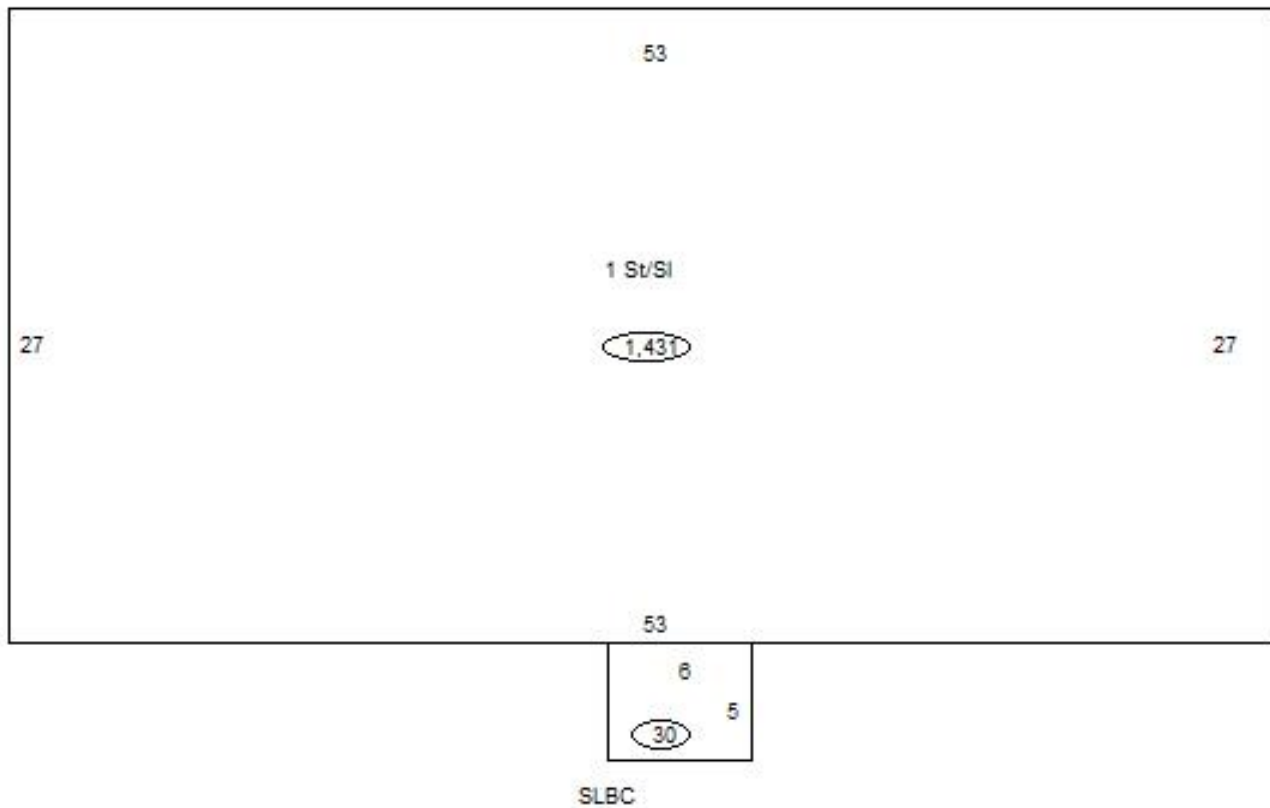

### Sketch Vector Information

Sequence	Code	Type	Built Over	Scale	Section Label	Base Area	Multiplier	Total Area
1	R	1	Slab	10	1 St/SI	1,431	1.000	1,431
2	M	PRCH		10	SLBC	30	1.000	30
<b>Total Building Area</b>						1,431		1,431



# Rogers

## Assessment Property Record Card for Tax Year 2026

Data provided by LISA DELOZIER County Assessor

Date 04/18/2026  
Time 09:14:05  
Page 4

660098817

### Outbuildings/Site Improvements

Building Image	Code	Description	Dimensions	Floor	Roofing	Total Units
	SHDS	Shed - Small	10x14x8	Plank	Formed Metal	140
	Qual	3	Cond 3	Year 2010	Eff Age 12	
<b>Valuation Summary</b>		<b>Modifier Total</b>		<b>RCN</b>	<b>Depr (100% Phys/ % Func) RCNLD</b>	
Base Cost (26.10 x 140)		3,654		3,654	3,654	