



Rogers

Assessment Property Record Card for Tax Year 2026

Data provided by LISA DELOZIER County Assessor

Date 04/18/2026
Time 09:15:01
Page 1

Assessment Data					Primary Image																																																																																												
Account 660098924 Parcel ID 000000-00-0-00412-004-0002 Cadastral ID 30-21-16-12160 Property Type REAL - Real Property Property Class URP VI Area 1 Tax Area 85 - CLRM SD-VERD TOWN/FIRE Name ID 319189 MILLS, EMMANUEL N 23215 S BESSIE BLVD CLAREMORE OK 74019-0000 Parcel Location Situs 23215 S BESSIE BLVD Subdivision KING RIDGE II Lot/Block 0002 / 0004 Parcel Size 1 - Lots Sec/Twn/Rng 30 / 21 / 16 / 5 Neighborhood 1166 - R-V01-SW CLAREMORE School District S001 - CLAREMORE SCHOOLS																																																																																																	
\\tsclient\T\TOMMY DUNLAP\New folder (159)\IMG_0032.JPG 3/24/2023																																																																																																	
Legal Description					Building Permits																																																																																												
Lat/Long: 36.27564481 -95.64627327 LOT 2 BLOCK 4 KING RIDGE II					<table border="1"> <thead> <tr> <th>Number</th> <th>Description</th> <th>Opened</th> <th>Closed</th> <th>Amount</th> </tr> </thead> <tbody> <tr> <td>R16-31</td> <td>R17-NEW 1356 SQ FT SFR</td> <td>05/2016</td> <td>09/2016</td> <td>90,000</td> </tr> </tbody> </table>					Number	Description	Opened	Closed	Amount	R16-31	R17-NEW 1356 SQ FT SFR	05/2016	09/2016	90,000																																																																														
Number	Description	Opened	Closed	Amount																																																																																													
R16-31	R17-NEW 1356 SQ FT SFR	05/2016	09/2016	90,000																																																																																													
Exemptions					Sale History																																																																																												
<table border="1"> <thead> <tr> <th>Code</th> <th>Type</th> <th>Active</th> <th>Maximum</th> <th>Exemption</th> </tr> </thead> <tbody> <tr> <td>H</td> <td>Homestead</td> <td>Yes</td> <td>1,000</td> <td>1,000</td> </tr> </tbody> </table>					Code	Type	Active	Maximum	Exemption	H	Homestead	Yes	1,000	1,000	<table border="1"> <thead> <tr> <th>Bk/Pg</th> <th>Grantor</th> <th>Date</th> <th>Price</th> <th>Code</th> </tr> </thead> <tbody> <tr> <td>2572/526</td> <td>RC VERDIGRIS LLC</td> <td>08/17/2016</td> <td>150,000</td> <td>YES</td> </tr> </tbody> </table>					Bk/Pg	Grantor	Date	Price	Code	2572/526	RC VERDIGRIS LLC	08/17/2016	150,000	YES																																																																				
Code	Type	Active	Maximum	Exemption																																																																																													
H	Homestead	Yes	1,000	1,000																																																																																													
Bk/Pg	Grantor	Date	Price	Code																																																																																													
2572/526	RC VERDIGRIS LLC	08/17/2016	150,000	YES																																																																																													
Parcel Valuation																																																																																																	
<table border="1"> <thead> <tr> <th>Source</th> <th>REAL</th> </tr> </thead> <tbody> <tr> <td>Remove Cap</td> <td>2017</td> </tr> <tr> <td>Year Frozen</td> <td></td> </tr> <tr> <td>Uncapped Value</td> <td>0</td> </tr> <tr> <td>TIF Project ID</td> <td>0</td> </tr> </tbody> </table>		Source	REAL	Remove Cap	2017	Year Frozen		Uncapped Value	0	TIF Project ID	0	<table border="1"> <thead> <tr> <th>Fair Cash</th> <th>Capped</th> <th>Asmnt Level</th> <th>Assessed</th> </tr> </thead> <tbody> <tr> <td>Land Value</td> <td>45,956</td> <td>26,585</td> <td>2,924</td> </tr> <tr> <td>Improvements</td> <td>173,906</td> <td>156,633</td> <td>17,230</td> </tr> <tr> <td>Mobile Home</td> <td>0</td> <td>0</td> <td>0</td> </tr> <tr> <td>Total Value</td> <td>219,862</td> <td>183,218</td> <td>20,154</td> </tr> </tbody> </table>			Fair Cash	Capped	Asmnt Level	Assessed	Land Value	45,956	26,585	2,924	Improvements	173,906	156,633	17,230	Mobile Home	0	0	0	Total Value	219,862	183,218	20,154	<table border="1"> <thead> <tr> <th>Levy Rate</th> <th>Current Tax</th> </tr> </thead> <tbody> <tr> <td>109.172</td> <td>2,200.25</td> </tr> <tr> <td>Assessed</td> <td>20,154</td> </tr> <tr> <td>Penalty</td> <td>0</td> </tr> <tr> <td>Exemption</td> <td>1,000</td> </tr> <tr> <td>Total Taxable</td> <td>19,154</td> </tr> </tbody> </table>		Levy Rate	Current Tax	109.172	2,200.25	Assessed	20,154	Penalty	0	Exemption	1,000	Total Taxable	19,154																																																	
Source	REAL																																																																																																
Remove Cap	2017																																																																																																
Year Frozen																																																																																																	
Uncapped Value	0																																																																																																
TIF Project ID	0																																																																																																
Fair Cash	Capped	Asmnt Level	Assessed																																																																																														
Land Value	45,956	26,585	2,924																																																																																														
Improvements	173,906	156,633	17,230																																																																																														
Mobile Home	0	0	0																																																																																														
Total Value	219,862	183,218	20,154																																																																																														
Levy Rate	Current Tax																																																																																																
109.172	2,200.25																																																																																																
Assessed	20,154																																																																																																
Penalty	0																																																																																																
Exemption	1,000																																																																																																
Total Taxable	19,154																																																																																																
Assessment History																																																																																																	
<table border="1"> <thead> <tr> <th>Tax Year</th> <th>Statement Number</th> <th>Billed Owner</th> <th>Tax Area</th> <th>Total Value</th> <th>Exemptions</th> <th>Taxable Value</th> <th>Billed Tax</th> </tr> </thead> <tbody> <tr><td>2025</td><td>2025-660098924</td><td>MILLS, EMMANUEL N</td><td>85</td><td>216,520</td><td>1000</td><td>18,567</td><td>2,044.00</td></tr> <tr><td>2024</td><td>2024-660098924</td><td>MILLS, EMMANUEL N</td><td>85</td><td>208,393</td><td>1000</td><td>17,997</td><td>1,859.00</td></tr> <tr><td>2023</td><td>2023-660098924</td><td>MILLS, EMMANUEL N</td><td>85</td><td>189,470</td><td>1000</td><td>17,444</td><td>1,788.00</td></tr> <tr><td>2022</td><td>2022-660098924</td><td>MILLS, EMMANUEL N</td><td>85</td><td>189,463</td><td>1000</td><td>16,907</td><td>1,749.00</td></tr> <tr><td>2021</td><td>2021-660098924</td><td>MILLS, EMMANUEL N</td><td>85</td><td>159,050</td><td>1000</td><td>16,385</td><td>1,626.00</td></tr> <tr><td>2020</td><td>2020-660098924</td><td>MILLS, EMMANUEL N</td><td>85</td><td>156,558</td><td>1000</td><td>15,879</td><td>1,628.00</td></tr> <tr><td>2019</td><td>2019-660098924</td><td>MILLS, EMMANUEL N</td><td>85</td><td>148,975</td><td>1000</td><td>15,387</td><td>1,594.00</td></tr> <tr><td>2018</td><td>2018-660098924</td><td>MILLS, EMMANUEL N</td><td>85</td><td>152,778</td><td>1000</td><td>15,806</td><td>1,633.00</td></tr> <tr><td>2017</td><td>2017-660098924</td><td>MILLS, EMMANUEL N</td><td>85</td><td>151,512</td><td>1000</td><td>15,666</td><td>1,609.00</td></tr> <tr><td>2016</td><td>2016-660098924</td><td>MILLS, EMMANUEL N</td><td>85</td><td>3,413</td><td>0</td><td>375</td><td>39.00</td></tr> </tbody> </table>										Tax Year	Statement Number	Billed Owner	Tax Area	Total Value	Exemptions	Taxable Value	Billed Tax	2025	2025-660098924	MILLS, EMMANUEL N	85	216,520	1000	18,567	2,044.00	2024	2024-660098924	MILLS, EMMANUEL N	85	208,393	1000	17,997	1,859.00	2023	2023-660098924	MILLS, EMMANUEL N	85	189,470	1000	17,444	1,788.00	2022	2022-660098924	MILLS, EMMANUEL N	85	189,463	1000	16,907	1,749.00	2021	2021-660098924	MILLS, EMMANUEL N	85	159,050	1000	16,385	1,626.00	2020	2020-660098924	MILLS, EMMANUEL N	85	156,558	1000	15,879	1,628.00	2019	2019-660098924	MILLS, EMMANUEL N	85	148,975	1000	15,387	1,594.00	2018	2018-660098924	MILLS, EMMANUEL N	85	152,778	1000	15,806	1,633.00	2017	2017-660098924	MILLS, EMMANUEL N	85	151,512	1000	15,666	1,609.00	2016	2016-660098924	MILLS, EMMANUEL N	85	3,413	0	375	39.00
Tax Year	Statement Number	Billed Owner	Tax Area	Total Value	Exemptions	Taxable Value	Billed Tax																																																																																										
2025	2025-660098924	MILLS, EMMANUEL N	85	216,520	1000	18,567	2,044.00																																																																																										
2024	2024-660098924	MILLS, EMMANUEL N	85	208,393	1000	17,997	1,859.00																																																																																										
2023	2023-660098924	MILLS, EMMANUEL N	85	189,470	1000	17,444	1,788.00																																																																																										
2022	2022-660098924	MILLS, EMMANUEL N	85	189,463	1000	16,907	1,749.00																																																																																										
2021	2021-660098924	MILLS, EMMANUEL N	85	159,050	1000	16,385	1,626.00																																																																																										
2020	2020-660098924	MILLS, EMMANUEL N	85	156,558	1000	15,879	1,628.00																																																																																										
2019	2019-660098924	MILLS, EMMANUEL N	85	148,975	1000	15,387	1,594.00																																																																																										
2018	2018-660098924	MILLS, EMMANUEL N	85	152,778	1000	15,806	1,633.00																																																																																										
2017	2017-660098924	MILLS, EMMANUEL N	85	151,512	1000	15,666	1,609.00																																																																																										
2016	2016-660098924	MILLS, EMMANUEL N	85	3,413	0	375	39.00																																																																																										



Rogers

Assessment Property Record Card for Tax Year 2026

Data provided by LISA DELOZIER County Assessor

Date 04/18/2026
 Time 09:15:01
 Page 2

Lot Data		Square-Foot - NBHD 1166 #1	
Lot Size	0	0	
Lot Count	1		
Units Buildable			
Non-Ag Acres	0.1969		
Topography			
Street Access			
Utilities			
Amenities	LAND QUALITY		0
			0
Method	Square-Foot		
Base Lot Value	8,578.00 x 5.36 = 45,956		
Factor Value			
Adjustments	1.0000		
Lot Value	45,956		



\\tsclient\T\TOMMY DUNLAP\New folder (159)\IMG_0032.JPG 3/24/2023

Residential Data	
Type	1 Single Family Residence
Condition	3 - Average
Quality	2.5 - Fair
Architecture	
Style	100% One Story
Exterior Wall	60% Veneer, Masonry 40% Frame, Siding, Vinyl
Base/Total Area	1,353 / 1,353
Style	100% One Story
HVAC	100% Warmed & Cooled Air
Roof Cover	1 Composition Shingle
Area on Slab	1,353
Fixture/RghIn	11 /
Bed/F/H Bath	3 / 2.0 /
Basement Area	
Garage Type	380 Attached Garage - Unfinished
Remodel	
Year/Eff Age	2016 / 8

GRM Approach

GRM Code	
Gross Rent	0.00
Indicated Value	

Multiple Regression

MRA Code	1	Test
Adjusted R	0.8445	
Indicated Value	190,313	140.66 Per SqFt

Direct Comparables

Selection Model	A	Adam Test
Adjustment Model	1	2022 Residential
Comparables	8	
Indicated Value	179,230	Per SqFt

Value Reconciliation

Selected Approach	Cost Approach		
Improvements	173,906		
Lot Value	45,956		
Indicated Value	219,862	162.50	Per SqFt
Agland Value			
Site Improvements			
Total Value	219,862	162.50	Total Value Per SqFt

Cost Approach		Manual : 01/2025	
Base Cost	105.54	Total Misc Impr	+ 2,836
Roofing Adj	+ 4.63	Garage Cost	+ 11,256
Subfloor Adj	+ -1.22	Total RCN	= 191,105
Heat/Cool Adj	+ 11.47	Depreciation (9%)	- 17,199
Plumbing Adj	+ 10.41	Lump Sums	+ 0
Basement Adj	+ 0.00	RCNLD	= 173,906
Adj Base Cost	= 130.83	Lot Value	+ 45,956
Total Area	x 1,353	Indicated Value	= 219,862
Adjusted Cost	= 177,013	Value Per SqFt	162.50

Miscellaneous Improvements

Code	Description	Sketch ID	Size	Year	Units	Unit Cost	Depr	Value
PRCH	SLAB PORCH - COVERED	129651	6x5		30	24.17		725
PRCH	SLAB PORCH - COVERED	129652	11x8		88	23.99		2,111



Rogers

Assessment Property Record Card for Tax Year 2026

Data provided by LISA DELOZIER County Assessor

Date 04/18/2026

Time 09:15:01

Page 3

Sketch Image

660098924

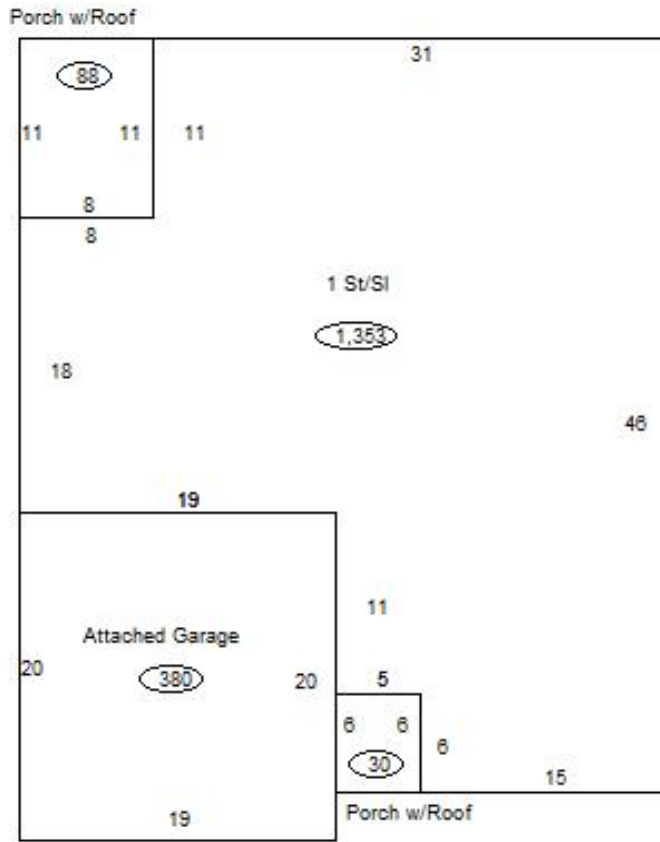

Sketch Vector Information

Sequence	Code	Type	Built Over	Scale	Section Label	Base Area	Multiplier	Total Area
1	R	1	Slab	13	1 St/Sl	1,353	1.000	1,353
2	G	1		13	Attached Garage	380	1.000	380
3	M	PRCH		13	SLBC	30	1.000	30
4	M	PRCH		13	SLBC	88	1.000	88
Total Building Area						1,353		1,353