



Rogers

Assessment Property Record Card for Tax Year 2026

Data provided by LISA DELOZIER County Assessor

Date 04/18/2026
 Time 09:19:15
 Page 1

Assessment Data					Primary Image																																																																																												
Account 660099454 Parcel ID 21N17E-35-3-00000-000-0099 Cadastral ID 35-21-17-00311 Property Type REAL - Real Property Property Class RA VI Area 3 Tax Area 95 - MAYES/TRI-DISTRICT FIRE Name ID 348596 BISWELL, JOHNNY L REVOC TRUST & JEFFREY TYLER SANDERS PO BOX 1233 CLAREMORE OK 74018-0000 Parcel Location Situs 24811 S 4230 RD Subdivision Lot/Block / Parcel Size 79.06 - Acres Sec/Twn/Rng 35 / 21 / 17 / 3 Neighborhood 2117 - UNPLATTED School District S032 - MAYES SCHOOLS																																																																																																	
Legal Description Lat/Long: 36.25113128 -95.46687216										Building Permits <table border="1"> <thead> <tr> <th>Number</th> <th>Description</th> <th>Opened</th> <th>Closed</th> <th>Amount</th> </tr> </thead> <tbody> <tr> <td>R17</td> <td>R17-SPLIT</td> <td>07/2016</td> <td>10/2016</td> <td></td> </tr> </tbody> </table>					Number	Description	Opened	Closed	Amount	R17	R17-SPLIT	07/2016	10/2016																																																																										
Number	Description	Opened	Closed	Amount																																																																																													
R17	R17-SPLIT	07/2016	10/2016																																																																																														
Exemptions <table border="1"> <thead> <tr> <th>Code</th> <th>Type</th> <th>Active</th> <th>Maximum</th> <th>Exemption</th> </tr> </thead> <tbody> <tr> <td>H</td> <td>Homestead</td> <td>No</td> <td>1,000</td> <td></td> </tr> </tbody> </table>					Code	Type	Active	Maximum	Exemption	H	Homestead	No	1,000		Sale History <table border="1"> <thead> <tr> <th>Bk/Pg</th> <th>Grantor</th> <th>Date</th> <th>Price</th> <th>Code</th> </tr> </thead> <tbody> <tr> <td>/</td> <td>BISWELL, BESSIE LLC &</td> <td>10/22/2025</td> <td></td> <td>4</td> </tr> <tr> <td>/</td> <td>ROUND, AMBER NICOLE</td> <td>03/22/2024</td> <td>650,000</td> <td>21</td> </tr> <tr> <td>2718/178</td> <td>COBLENTZ, AMBER NICOLE</td> <td>06/18/2018</td> <td>0</td> <td>4</td> </tr> <tr> <td>2548/928</td> <td>MOORE, ROGER P &</td> <td>05/12/2016</td> <td>240,000</td> <td>YES</td> </tr> </tbody> </table>					Bk/Pg	Grantor	Date	Price	Code	/	BISWELL, BESSIE LLC &	10/22/2025		4	/	ROUND, AMBER NICOLE	03/22/2024	650,000	21	2718/178	COBLENTZ, AMBER NICOLE	06/18/2018	0	4	2548/928	MOORE, ROGER P &	05/12/2016	240,000	YES																																																					
Code	Type	Active	Maximum	Exemption																																																																																													
H	Homestead	No	1,000																																																																																														
Bk/Pg	Grantor	Date	Price	Code																																																																																													
/	BISWELL, BESSIE LLC &	10/22/2025		4																																																																																													
/	ROUND, AMBER NICOLE	03/22/2024	650,000	21																																																																																													
2718/178	COBLENTZ, AMBER NICOLE	06/18/2018	0	4																																																																																													
2548/928	MOORE, ROGER P &	05/12/2016	240,000	YES																																																																																													
Parcel Valuation <table border="1"> <thead> <tr> <th>Source</th> <th>REAL</th> <th>Fair Cash</th> <th>Capped</th> <th>Asmnt Level</th> <th>Assessed</th> <th>Levy Rate</th> <th>97.300</th> <th>Current Tax</th> </tr> </thead> <tbody> <tr> <td>Remove Cap</td> <td>2025</td> <td>Land Value 5,476</td> <td>5,066</td> <td>11%</td> <td>557</td> <td>Assessed</td> <td>18,888</td> <td>1,837.80</td> </tr> <tr> <td>Year Frozen</td> <td>0</td> <td>Improvements 84,726</td> <td>71,487</td> <td></td> <td>7,863</td> <td>Penalty</td> <td>0</td> <td></td> </tr> <tr> <td>Uncapped Value</td> <td>0</td> <td>Mobile Home 95,164</td> <td>95,164</td> <td></td> <td>10,468</td> <td>Exemption</td> <td>0</td> <td>0.00</td> </tr> <tr> <td>TIF Project ID</td> <td>0</td> <td>Total Value 185,366</td> <td>171,717</td> <td></td> <td>18,888</td> <td>Total Taxable</td> <td>18,888</td> <td>1,838.00</td> </tr> </tbody> </table>										Source	REAL	Fair Cash	Capped	Asmnt Level	Assessed	Levy Rate	97.300	Current Tax	Remove Cap	2025	Land Value 5,476	5,066	11%	557	Assessed	18,888	1,837.80	Year Frozen	0	Improvements 84,726	71,487		7,863	Penalty	0		Uncapped Value	0	Mobile Home 95,164	95,164		10,468	Exemption	0	0.00	TIF Project ID	0	Total Value 185,366	171,717		18,888	Total Taxable	18,888	1,838.00																																											
Source	REAL	Fair Cash	Capped	Asmnt Level	Assessed	Levy Rate	97.300	Current Tax																																																																																									
Remove Cap	2025	Land Value 5,476	5,066	11%	557	Assessed	18,888	1,837.80																																																																																									
Year Frozen	0	Improvements 84,726	71,487		7,863	Penalty	0																																																																																										
Uncapped Value	0	Mobile Home 95,164	95,164		10,468	Exemption	0	0.00																																																																																									
TIF Project ID	0	Total Value 185,366	171,717		18,888	Total Taxable	18,888	1,838.00																																																																																									
Assessment History <table border="1"> <thead> <tr> <th>Tax Year</th> <th>Statement Number</th> <th>Billed Owner</th> <th>Tax Area</th> <th>Total Value</th> <th>Exemptions</th> <th>Taxable Value</th> <th>Billed Tax</th> </tr> </thead> <tbody> <tr> <td>2025</td> <td>2025-660099454</td> <td>BISWELL, BESSIE LLC &</td> <td>95</td> <td>166,716</td> <td>0</td> <td>18,339</td> <td>1,784.00</td> </tr> <tr> <td>2024</td> <td>2024-660099454</td> <td>BISWELL, BESSIE LLC &</td> <td>95</td> <td>153,312</td> <td>1000</td> <td>13,520</td> <td>1,416.00</td> </tr> <tr> <td>2023</td> <td>2023-660099454</td> <td>ROUND, AMBER NICOLE</td> <td>95</td> <td>144,980</td> <td>1000</td> <td>13,097</td> <td>1,398.00</td> </tr> <tr> <td>2022</td> <td>2022-660099454</td> <td>ROUND, AMBER NICOLE</td> <td>95</td> <td>139,770</td> <td>1000</td> <td>12,687</td> <td>1,329.00</td> </tr> <tr> <td>2021</td> <td>2021-660099454</td> <td>ROUND, AMBER NICOLE</td> <td>95</td> <td>120,803</td> <td>1000</td> <td>12,288</td> <td>1,341.00</td> </tr> <tr> <td>2020</td> <td>2020-660099454</td> <td>ROUND, AMBER NICOLE</td> <td>95</td> <td>118,885</td> <td>1000</td> <td>11,914</td> <td>1,204.00</td> </tr> <tr> <td>2019</td> <td>2019-660099454</td> <td>ROUND, AMBER NICOLE</td> <td>95</td> <td>113,983</td> <td>1000</td> <td>11,538</td> <td>1,150.00</td> </tr> <tr> <td>2018</td> <td>2018-660099454</td> <td>ROUND, AMBER NICOLE</td> <td>95</td> <td>115,636</td> <td>1000</td> <td>11,721</td> <td>1,153.00</td> </tr> <tr> <td>2017</td> <td>2017-660099454</td> <td>COBLENTZ, AMBER NICOLE</td> <td>95</td> <td>27,676</td> <td>0</td> <td>3,044</td> <td>301.00</td> </tr> <tr> <td>2016</td> <td>2016-660099454</td> <td>COBLENTZ, AMBER NICOLE</td> <td>95</td> <td>4,968</td> <td>0</td> <td>546</td> <td>54.00</td> </tr> </tbody> </table>										Tax Year	Statement Number	Billed Owner	Tax Area	Total Value	Exemptions	Taxable Value	Billed Tax	2025	2025-660099454	BISWELL, BESSIE LLC &	95	166,716	0	18,339	1,784.00	2024	2024-660099454	BISWELL, BESSIE LLC &	95	153,312	1000	13,520	1,416.00	2023	2023-660099454	ROUND, AMBER NICOLE	95	144,980	1000	13,097	1,398.00	2022	2022-660099454	ROUND, AMBER NICOLE	95	139,770	1000	12,687	1,329.00	2021	2021-660099454	ROUND, AMBER NICOLE	95	120,803	1000	12,288	1,341.00	2020	2020-660099454	ROUND, AMBER NICOLE	95	118,885	1000	11,914	1,204.00	2019	2019-660099454	ROUND, AMBER NICOLE	95	113,983	1000	11,538	1,150.00	2018	2018-660099454	ROUND, AMBER NICOLE	95	115,636	1000	11,721	1,153.00	2017	2017-660099454	COBLENTZ, AMBER NICOLE	95	27,676	0	3,044	301.00	2016	2016-660099454	COBLENTZ, AMBER NICOLE	95	4,968	0	546	54.00
Tax Year	Statement Number	Billed Owner	Tax Area	Total Value	Exemptions	Taxable Value	Billed Tax																																																																																										
2025	2025-660099454	BISWELL, BESSIE LLC &	95	166,716	0	18,339	1,784.00																																																																																										
2024	2024-660099454	BISWELL, BESSIE LLC &	95	153,312	1000	13,520	1,416.00																																																																																										
2023	2023-660099454	ROUND, AMBER NICOLE	95	144,980	1000	13,097	1,398.00																																																																																										
2022	2022-660099454	ROUND, AMBER NICOLE	95	139,770	1000	12,687	1,329.00																																																																																										
2021	2021-660099454	ROUND, AMBER NICOLE	95	120,803	1000	12,288	1,341.00																																																																																										
2020	2020-660099454	ROUND, AMBER NICOLE	95	118,885	1000	11,914	1,204.00																																																																																										
2019	2019-660099454	ROUND, AMBER NICOLE	95	113,983	1000	11,538	1,150.00																																																																																										
2018	2018-660099454	ROUND, AMBER NICOLE	95	115,636	1000	11,721	1,153.00																																																																																										
2017	2017-660099454	COBLENTZ, AMBER NICOLE	95	27,676	0	3,044	301.00																																																																																										
2016	2016-660099454	COBLENTZ, AMBER NICOLE	95	4,968	0	546	54.00																																																																																										



Rogers

Assessment Property Record Card for Tax Year 2026

Data provided by LISA DELOZIER County Assessor

Date 04/18/2026
 Time 09:19:16
 Page 2

Lot Data	Units-Buildable - UNPLATTED (UNITS BUILDABLE)		Primary Image					
Lot Size								
Lot Count								
Units Buildable								
Non-Ag Acres	0							
Topography								
Street Access								
Utilities								
Amenities	LAND QUALITY							
Method	Units-Buildable							
Base Lot Value								
Factor Value			660099454_001.JPG 12/15/2025					
Adjustments			GRM Approach					
Lot Value			GRM Code					
Residential Data			Gross Rent 0.00					
Type			Indicated Value					
Condition	-		Multiple Regression					
Quality	-		MRA Code					
Architecture			Adusted R					
Style			Indicated Value					
Exterior Wall			Direct Comparables					
Base/Total Area /			Selection Model 1 Res					
Style			Adjustment Model A2 AO Test					
HVAC			Comparables					
Roof Cover			Indicated Value					
Area on Slab			Value Reconciliation					
Fixture/RghIn /			Selected Approach Cost Approach					
Bed/F/H Bath / /			Improvements					
Basement Area			Lot Value					
Garage Type			Indicated Value 0.00 Per SqFt					
Remodel			Agland Value 5,476					
Year/Eff Age /			Site Improvements 78,031					
Cost Approach			Total Value 83,507 0.00 Total Value Per SqFt					
Manual : 01/2025								
Base Cost	0.00	Total Misc Impr	+		0			
Roofing Adj	+ 0.00	Garage Cost	+					
Subfloor Adj	+ 0.00	Total RCN	=		0			
Heat/Cool Adj	+ 0.00	Depreciation (0%)	-		0			
Plumbing Adj	+ 0.00	Lump Sums	+		0			
Basement Adj	+ 0.00	RCNLD	=					
Adj Base Cost	= 0.00	Lot Value	+					
Total Area	x	Indicated Value	=					
Adjusted Cost	= 0	Value Per SqFt			0.00			
Miscellaneous Improvements								
Code	Description	Sketch ID	Size	Year	Units	Unit Cost	Depr	Value



Rogers



Assessment Property Record Card for Tax Year 2026

Data provided by LISA DELOZIER County Assessor

Date 04/18/2026
 Time 09:19:16
 Page 3

660099454

Outbuildings/Site Improvements

Building Image	Code	Description	Dimensions	Floor	Roofing	Total Units
	BNGP	Barn - General Purpose	50x36x10	Gravel	Formed Metal	1,800
	Qual	3	Cond 3	Year 2016	Eff Age 8	
	Valuation Summary		Modifier Total	RCN	Depr (15% Phys/ % Func)	RCNLD
	Base Cost (22.20 x 1,800)	39,960		39,960	5,994	33,966
	UTIL	Utility Building	50x35x10	Concrete	Formed Metal	1,750
	Qual	2	Cond 3	Year 2016	Eff Age 8	
	Valuation Summary		Modifier Total	RCN	Depr (15% Phys/ % Func)	RCNLD
	Base Cost (28.49 x 1,750)	49,858		49,858	7,479	42,379
	SHDS	Shed - Small	10x16x8	Plank	Composition Shingle	160
	Qual	2	Cond 3	Year 2010	Eff Age 12	
	Valuation Summary		Modifier Total	RCN	Depr (46% Phys/ % Func)	RCNLD
	Base Cost (19.51 x 160)	3,122		3,122	1,436	1,686



Rogers

Assessment Property Record Card for Tax Year 2026

Data provided by LISA DELOZIER County Assessor

Date 04/18/2026
 Time 09:19:16
 Page 5

Sketch Image

660099454

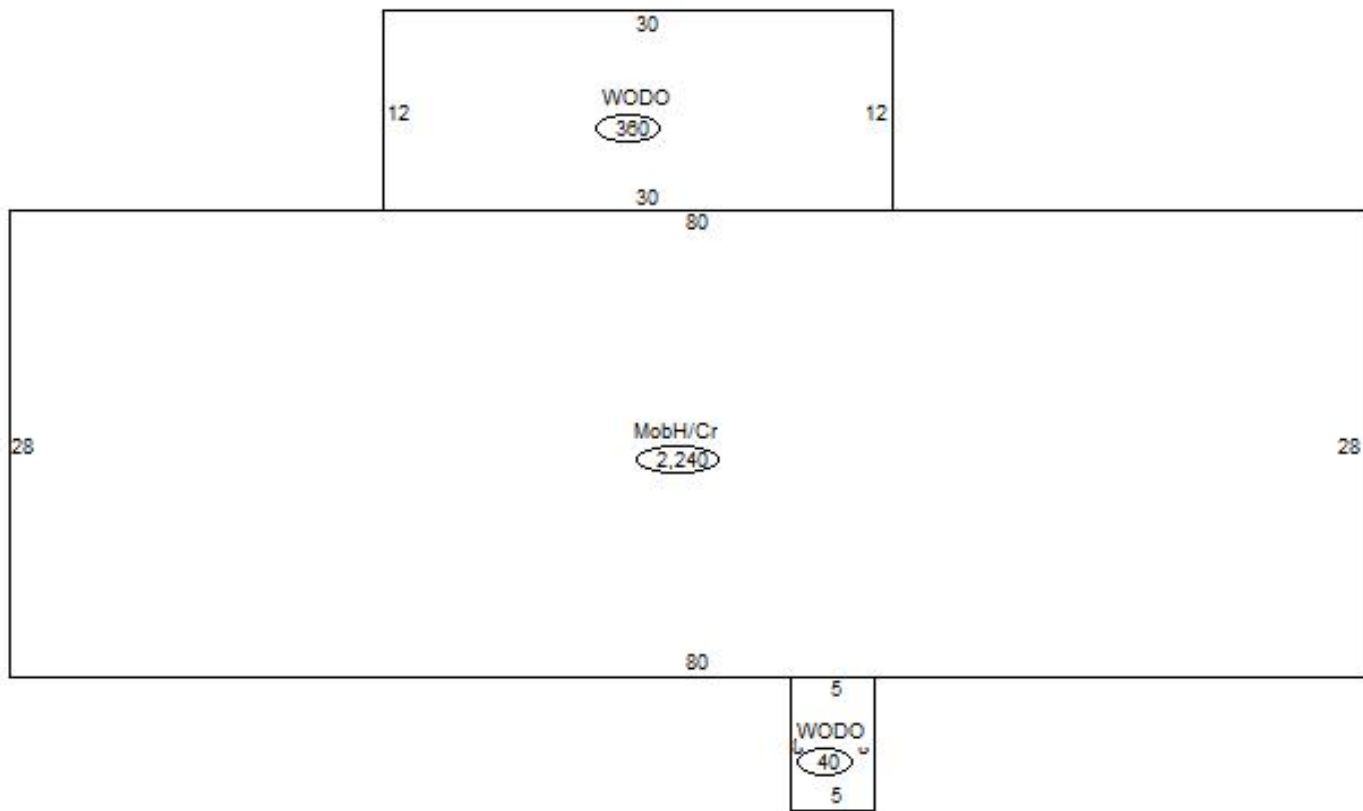

Sketch Vector Information

Sequence	Code	Type	Built Over	Scale	Section Label	Base Area	Multiplier	Total Area
1	R	14	Crawl	13	MobH/Cr	2,240	1.000	2,240
2	M	WODO		13	WODO	360	1.000	360
3	M	WODO		13	WODO	40	1.000	40
Total Building Area						2,240		2,240



Rogers

Assessment Property Record Card for Tax Year 2026

Data provided by LISA DELOZIER County Assessor

Date 04/18/2026
Time 09:19:16
Page 6

Agland Inventory

660099454

Soi	Description	Land Use	LPI	Adj Type	Adj Code	Acres	Use/Acre	Mkt/Acre	Use Value	Market Value
BR	BREAKS-ALLUVIAL LAND COMP	TMBR	30			12.565	54	54	679	679
CO	COLLINSVILLE STONY LOAM	TMBR	22			12.726	40	40	504	504
CO	COLLINSVILLE STONY LOAM	NTV PST	22			41.141	53	53	2,172	2,172
DBC	DENNIS-BATES COMPLEX 2-5%	IMP PST	60			12.628	168	168	2,121	2,121
IMP PST Totals						79.060			5,476	5,476
Total Agland						79.060			5,476	5,476