



Rogers

Assessment Property Record Card for Tax Year 2026

Data provided by LISA DELOZIER County Assessor

Date 04/18/2026
 Time 09:19:58
 Page 1

Assessment Data					Primary Image																																																																																												
Account 660099519 Parcel ID 22N16E-13-4-00000-000-0099 Cadastral ID 13-22-16-00310 Property Type REAL - Real Property Property Class RA VI Area 1 Tax Area 75 - SEQUOYAH/FOYIL FD Name ID 340035 PETTY, DAVID PAUL & COLLETTE DAWN 426514 E 260 RD CHELSEA OK 74016-0000 Parcel Location Situs 15550 S 4187 RD Subdivision Lot/Block / Parcel Size 10 - Acres Sec/Twn/Rng 13 / 22 / 16 / 4 Neighborhood 6050 - UNPLATTED School District S006 - SEQUOYAH SCHOOLS																																																																																																	
Legal Description Lat/Long: 36.38621038 -95.54877888																																																																																																	
NE NW SE					Building Permits																																																																																												
					<table border="1"> <thead> <tr> <th>Number</th> <th>Description</th> <th>Opened</th> <th>Closed</th> <th>Amount</th> </tr> </thead> <tbody> <tr> <td></td> <td></td> <td></td> <td></td> <td></td> </tr> </tbody> </table>					Number	Description	Opened	Closed	Amount																																																																																			
Number	Description	Opened	Closed	Amount																																																																																													
Exemptions					Sale History																																																																																												
<table border="1"> <thead> <tr> <th>Code</th> <th>Type</th> <th>Active</th> <th>Maximum</th> <th>Exemption</th> </tr> </thead> <tbody> <tr> <td>H</td> <td>Homestead</td> <td>No</td> <td>1,000</td> <td></td> </tr> </tbody> </table>					Code	Type	Active	Maximum	Exemption	H	Homestead	No	1,000		<table border="1"> <thead> <tr> <th>Bk/Pg</th> <th>Grantor</th> <th>Date</th> <th>Price</th> <th>Code</th> </tr> </thead> <tbody> <tr> <td>/</td> <td>CHAMBERS FAMILY REVOCABLE</td> <td>08/12/2022</td> <td>0</td> <td>4</td> </tr> <tr> <td>2558/850</td> <td>CHAMBERS, EARL E</td> <td>06/23/2016</td> <td>0</td> <td>4</td> </tr> </tbody> </table>					Bk/Pg	Grantor	Date	Price	Code	/	CHAMBERS FAMILY REVOCABLE	08/12/2022	0	4	2558/850	CHAMBERS, EARL E	06/23/2016	0	4																																																															
Code	Type	Active	Maximum	Exemption																																																																																													
H	Homestead	No	1,000																																																																																														
Bk/Pg	Grantor	Date	Price	Code																																																																																													
/	CHAMBERS FAMILY REVOCABLE	08/12/2022	0	4																																																																																													
2558/850	CHAMBERS, EARL E	06/23/2016	0	4																																																																																													
Parcel Valuation																																																																																																	
<table border="1"> <thead> <tr> <th>Source</th> <th>REAL</th> <th>Fair Cash</th> <th>Capped</th> <th>Asmnt Level</th> <th>Assessed</th> <th>Levy Rate</th> <th>101.310</th> <th>Current Tax</th> </tr> </thead> <tbody> <tr> <td>Remove Cap</td> <td>0</td> <td>Land Value 1,440</td> <td>1,440</td> <td>11%</td> <td>158</td> <td>Assessed</td> <td>21,697</td> <td>2,198.12</td> </tr> <tr> <td>Year Frozen</td> <td>0</td> <td>Improvements 250,376</td> <td>195,810</td> <td></td> <td>21,539</td> <td>Penalty</td> <td>0</td> <td></td> </tr> <tr> <td>Uncapped Value</td> <td>0</td> <td>Mobile Home 0</td> <td>0</td> <td></td> <td>0</td> <td>Exemption</td> <td>0</td> <td>0.00</td> </tr> <tr> <td>TIF Project ID</td> <td>0</td> <td>Total Value 251,816</td> <td>197,250</td> <td></td> <td>21,697</td> <td>Total Taxable</td> <td>21,697</td> <td>2,198.00</td> </tr> </tbody> </table>		Source	REAL	Fair Cash	Capped	Asmnt Level	Assessed	Levy Rate	101.310	Current Tax	Remove Cap	0	Land Value 1,440	1,440	11%	158	Assessed	21,697	2,198.12	Year Frozen	0	Improvements 250,376	195,810		21,539	Penalty	0		Uncapped Value	0	Mobile Home 0	0		0	Exemption	0	0.00	TIF Project ID	0	Total Value 251,816	197,250		21,697	Total Taxable	21,697	2,198.00																																																			
Source	REAL	Fair Cash	Capped	Asmnt Level	Assessed	Levy Rate	101.310	Current Tax																																																																																									
Remove Cap	0	Land Value 1,440	1,440	11%	158	Assessed	21,697	2,198.12																																																																																									
Year Frozen	0	Improvements 250,376	195,810		21,539	Penalty	0																																																																																										
Uncapped Value	0	Mobile Home 0	0		0	Exemption	0	0.00																																																																																									
TIF Project ID	0	Total Value 251,816	197,250		21,697	Total Taxable	21,697	2,198.00																																																																																									
Assessment History																																																																																																	
<table border="1"> <thead> <tr> <th>Tax Year</th> <th>Statement Number</th> <th>Billed Owner</th> <th>Tax Area</th> <th>Total Value</th> <th>Exemptions</th> <th>Taxable Value</th> <th>Billed Tax</th> </tr> </thead> <tbody> <tr> <td>2025</td> <td>2025-660099519</td> <td>PETTY, DAVID PAUL &</td> <td>75</td> <td>231,257</td> <td>0</td> <td>21,065</td> <td>2,134.00</td> </tr> <tr> <td>2024</td> <td>2024-660099519</td> <td>PETTY, DAVID PAUL &</td> <td>75</td> <td>219,842</td> <td>0</td> <td>20,452</td> <td>2,084.00</td> </tr> <tr> <td>2023</td> <td>2023-660099519</td> <td>PETTY, DAVID PAUL &</td> <td>75</td> <td>204,580</td> <td>0</td> <td>19,856</td> <td>2,068.00</td> </tr> <tr> <td>2022</td> <td>2022-660099519</td> <td>CHAMBERS, EARL EUGENE &</td> <td>75</td> <td>207,958</td> <td>0</td> <td>19,278</td> <td>2,049.00</td> </tr> <tr> <td>2021</td> <td>2021-660099519</td> <td>CHAMBERS, EARL EUGENE &</td> <td>75</td> <td>213,084</td> <td>1000</td> <td>17,716</td> <td>1,844.00</td> </tr> <tr> <td>2020</td> <td>2020-660099519</td> <td>CHAMBERS, EARL EUGENE &</td> <td>75</td> <td>209,138</td> <td>1000</td> <td>17,171</td> <td>1,854.00</td> </tr> <tr> <td>2019</td> <td>2019-660099519</td> <td>CHAMBERS, EARL EUGENE &</td> <td>75</td> <td>199,615</td> <td>1000</td> <td>16,642</td> <td>1,782.00</td> </tr> <tr> <td>2018</td> <td>2018-660099519</td> <td>CHAMBERS, EARL EUGENE &</td> <td>75</td> <td>208,694</td> <td>1000</td> <td>16,128</td> <td>1,737.00</td> </tr> <tr> <td>2017</td> <td>2017-660099519</td> <td>CHAMBERS, EARL EUGENE &</td> <td>75</td> <td>206,693</td> <td>1000</td> <td>15,629</td> <td>1,673.00</td> </tr> <tr> <td>2016</td> <td>2016-660099519</td> <td>CHAMBERS, EARL EUGENE &</td> <td>75</td> <td>200,588</td> <td>1000</td> <td>15,145</td> <td>1,619.00</td> </tr> </tbody> </table>										Tax Year	Statement Number	Billed Owner	Tax Area	Total Value	Exemptions	Taxable Value	Billed Tax	2025	2025-660099519	PETTY, DAVID PAUL &	75	231,257	0	21,065	2,134.00	2024	2024-660099519	PETTY, DAVID PAUL &	75	219,842	0	20,452	2,084.00	2023	2023-660099519	PETTY, DAVID PAUL &	75	204,580	0	19,856	2,068.00	2022	2022-660099519	CHAMBERS, EARL EUGENE &	75	207,958	0	19,278	2,049.00	2021	2021-660099519	CHAMBERS, EARL EUGENE &	75	213,084	1000	17,716	1,844.00	2020	2020-660099519	CHAMBERS, EARL EUGENE &	75	209,138	1000	17,171	1,854.00	2019	2019-660099519	CHAMBERS, EARL EUGENE &	75	199,615	1000	16,642	1,782.00	2018	2018-660099519	CHAMBERS, EARL EUGENE &	75	208,694	1000	16,128	1,737.00	2017	2017-660099519	CHAMBERS, EARL EUGENE &	75	206,693	1000	15,629	1,673.00	2016	2016-660099519	CHAMBERS, EARL EUGENE &	75	200,588	1000	15,145	1,619.00
Tax Year	Statement Number	Billed Owner	Tax Area	Total Value	Exemptions	Taxable Value	Billed Tax																																																																																										
2025	2025-660099519	PETTY, DAVID PAUL &	75	231,257	0	21,065	2,134.00																																																																																										
2024	2024-660099519	PETTY, DAVID PAUL &	75	219,842	0	20,452	2,084.00																																																																																										
2023	2023-660099519	PETTY, DAVID PAUL &	75	204,580	0	19,856	2,068.00																																																																																										
2022	2022-660099519	CHAMBERS, EARL EUGENE &	75	207,958	0	19,278	2,049.00																																																																																										
2021	2021-660099519	CHAMBERS, EARL EUGENE &	75	213,084	1000	17,716	1,844.00																																																																																										
2020	2020-660099519	CHAMBERS, EARL EUGENE &	75	209,138	1000	17,171	1,854.00																																																																																										
2019	2019-660099519	CHAMBERS, EARL EUGENE &	75	199,615	1000	16,642	1,782.00																																																																																										
2018	2018-660099519	CHAMBERS, EARL EUGENE &	75	208,694	1000	16,128	1,737.00																																																																																										
2017	2017-660099519	CHAMBERS, EARL EUGENE &	75	206,693	1000	15,629	1,673.00																																																																																										
2016	2016-660099519	CHAMBERS, EARL EUGENE &	75	200,588	1000	15,145	1,619.00																																																																																										



Rogers

Assessment Property Record Card for Tax Year 2026

Data provided by LISA DELOZIER County Assessor

Date 04/18/2026
Time 09:19:58
Page 2

Lot Data	Units-Buildable - UNPLATTED (UNITS BUILDABLE)	Primary Image
Lot Size		<p style="text-align: right; color: orange;">11/18/2022</p>
Lot Count		
Units Buildable		
Non-Ag Acres	0	
Topography		
Street Access		
Utilities		
Amenities	LAND QUALITY	
Method	Units-Buildable	
Base Lot Value		
Factor Value		\\tsclient\T\LOGAN\LOGAN RESIDENTIAL VI\2022-11-18\IMG_00. 11/21/2022
Adjustments		
Lot Value		

Residential Data	
Type	1 Single Family Residence
Condition	3 - Average
Quality	3.5 - Average
Architecture	
Style	100% One Story
Exterior Wall	100% Veneer, Stone
Base/Total Area	2,841 / 2,841
Style	100% One Story
HVAC	100% Warmed & Cooled Air
Roof Cover	1 Composition Shingle
Area on Slab	2,841
Fixture/RghIn	11 /
Bed/F/H Bath	3 / 2.0 /
Basement Area	
Garage Type	612 Attached Garage - Unfinished
Remodel	
Year/Eff Age	1981 / 34

Cost Approach		Manual : 01/2025	
Base Cost	111.33	Total Misc Impr	+ 28,009
Roofing Adj	+ 5.06	Garage Cost	+ 23,293
Subfloor Adj	+ -3.22	Total RCN	= 431,683
Heat/Cool Adj	+ 14.47	Depreciation (42%)	- 181,307
Plumbing Adj	+ 6.25	Lump Sums	+ 0
Basement Adj	+ 0.00	RCNLD	= 250,376
Adj Base Cost	= 133.89	Lot Value	+ 250,376
Total Area	x 2,841	Indicated Value	= 250,376
Adjusted Cost	= 380,381	Value Per SqFt	88.13

GRM Approach	
GRM Code	
Gross Rent	0.00
Indicated Value	

Multiple Regression
MRA Code
Adusted R
Indicated Value

Direct Comparables	
Selection Model	1 Res
Adjustment Model	A2 AO Test
Comparables	
Indicated Value	

Value Reconciliation			
Selected Approach	Cost Approach		
Improvements	250,376		
Lot Value			
Indicated Value	250,376	88.13	Per SqFt
Agland Value	1,440		
Site Improvements			
Total Value	251,816	88.64	Total Value Per SqFt

Miscellaneous Improvements								
Code	Description	Sketch ID	Size	Year	Units	Unit Cost	Depr	Value
FPR1	FIREPLACE - RESIDENTIAL 1 STORY	0		1	1	6,429.63		6,430
PRCH	SLAB PORCH - COVERED	32210	32x10		320	28.41		9,091
PRCH	SLAB PORCH - COVERED	32211	446		446	28.00		12,488



Rogers

Assessment Property Record Card for Tax Year 2026

Data provided by LISA DELOZIER County Assessor

Date 04/18/2026
 Time 09:19:58
 Page 3

Sketch Image

660099519

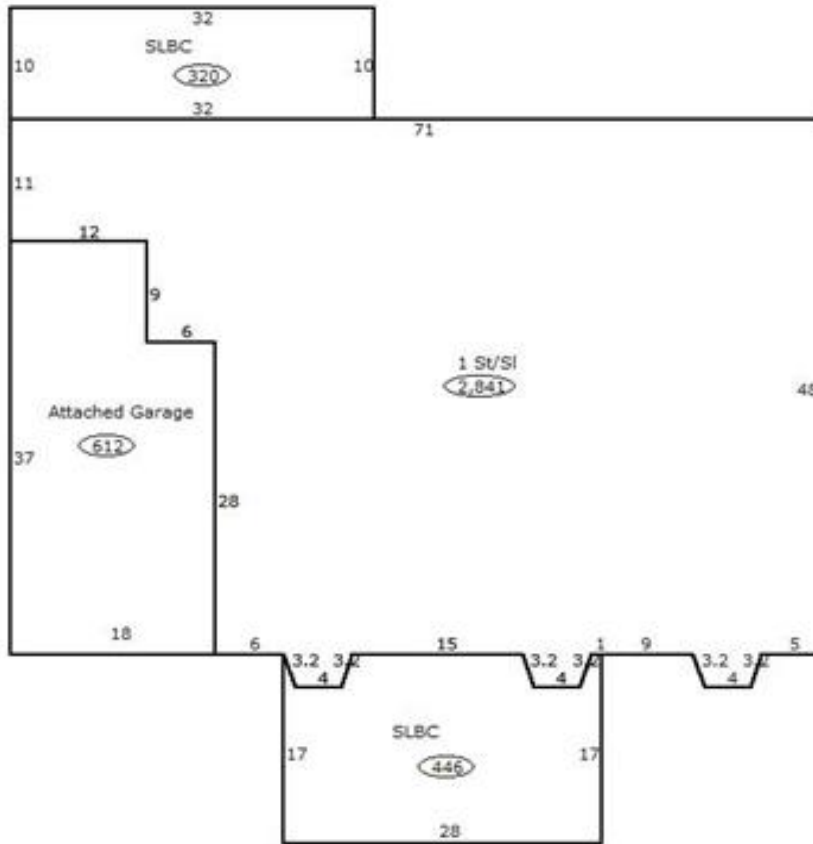

Sketch Vector Information

Sequence	Code	Type	Built Over	Scale	Section Label	Base Area	Multiplier	Total Area
1	R	1	Slab	13	1 St/SI	2,841	1.000	2,841
2	G	1		13	Attached Garage	612	1.000	612
3	M	PRCH		13	SLBC	320	1.000	320
4	M	PRCH		13	SLBC	446	1.000	446
Total Building Area						2,841		2,841



Rogers

Assessment Property Record Card for Tax Year 2026

Data provided by LISA DELOZIER County Assessor

Date 04/18/2026
Time 09:19:58
Page 4

Agland Inventory

660099519

Soi	Description	Land Use	LPI	Adj Type	Adj Code	Acres	Use/Acre	Mkt/Acre	Use Value	Market Value
DBC	DENNIS-BATES COMPLEX 2-5%	NTV PST	60			10.000	144	144	1,440	1,440
NTV PST Totals						10.000			1,440	1,440
Total Agland						10.000			1,440	1,440