



Rogers

Assessment Property Record Card for Tax Year 2026

Data provided by LISA DELOZIER County Assessor

Date 04/18/2026
 Time 09:21:03
 Page 1

Assessment Data					Primary Image																																																																																												
Account 660099632 Parcel ID 24N17E-24-4-00000-000-0099 Cadastral ID 24-24-17-00920 Property Type REAL - Real Property Property Class RA VI Area 2 Tax Area 14 - CHELSEA RURAL Name ID 319359 MCCLELAND, CODY W & HALEY H 21990 E HWY 28 CHELSEA OK 74016-0000 Parcel Location Situs 21710 E HWY 28 Subdivision Lot/Block / Parcel Size 2 - Acres Sec/Twn/Rng 24 / 24 / 17 / 4 Neighborhood 4060 - CHELSEA School District S003 - CHELSEA SCHOOLS					<p>\\tsclient\C\Users\rln\Pictures\2020-06-19\IMG_0006.JPG 7/2/2020</p>																																																																																												
Legal Description Lat/Long: 36.55339583 -95.43949892 TR IN NE NE DESC AS COMM NE/C NE; S88.3545W 926.55' TO POB; S01.3040E 220'; S88.3545W 396'; N01.3040W 220'; N88.3545E 396' TO POB.																																																																																																	
Exemptions <table border="1"> <thead> <tr> <th>Code</th> <th>Type</th> <th>Active</th> <th>Maximum</th> <th>Exemption</th> </tr> </thead> <tbody> <tr> <td>H</td> <td>Homestead</td> <td>Yes</td> <td>1,000</td> <td>1,000</td> </tr> </tbody> </table>					Code	Type	Active	Maximum	Exemption	H	Homestead	Yes	1,000	1,000	Building Permits <table border="1"> <thead> <tr> <th>Number</th> <th>Description</th> <th>Opened</th> <th>Closed</th> <th>Amount</th> </tr> </thead> <tbody> <tr> <td>R18</td> <td>R19-SPLIT</td> <td>10/2016</td> <td>07/2018</td> <td></td> </tr> </tbody> </table>					Number	Description	Opened	Closed	Amount	R18	R19-SPLIT	10/2016	07/2018																																																																					
Code	Type	Active	Maximum	Exemption																																																																																													
H	Homestead	Yes	1,000	1,000																																																																																													
Number	Description	Opened	Closed	Amount																																																																																													
R18	R19-SPLIT	10/2016	07/2018																																																																																														
Parcel Valuation <table border="1"> <thead> <tr> <th>Source</th> <th>REAL</th> <th>Fair Cash</th> <th>Capped</th> <th>Asmnt Level</th> <th>Assessed</th> <th>Levy Rate</th> <th>82.750</th> <th>Current Tax</th> </tr> </thead> <tbody> <tr> <td>Remove Cap</td> <td>0</td> <td>Land Value 288</td> <td>288</td> <td>11%</td> <td>32</td> <td>Assessed</td> <td>26,647</td> <td>2,205.04</td> </tr> <tr> <td>Year Frozen</td> <td>0</td> <td>Improvements 293,825</td> <td>241,959</td> <td></td> <td>26,615</td> <td>Penalty</td> <td>0</td> <td></td> </tr> <tr> <td>Uncapped Value</td> <td>0</td> <td>Mobile Home 0</td> <td>0</td> <td></td> <td>0</td> <td>Exemption</td> <td>1,000</td> <td>-83.00</td> </tr> <tr> <td>TIF Project ID</td> <td>0</td> <td>Total Value 294,113</td> <td>242,247</td> <td></td> <td>26,647</td> <td>Total Taxable</td> <td>25,647</td> <td>2,122.00</td> </tr> </tbody> </table>					Source	REAL	Fair Cash	Capped	Asmnt Level	Assessed	Levy Rate	82.750	Current Tax	Remove Cap	0	Land Value 288	288	11%	32	Assessed	26,647	2,205.04	Year Frozen	0	Improvements 293,825	241,959		26,615	Penalty	0		Uncapped Value	0	Mobile Home 0	0		0	Exemption	1,000	-83.00	TIF Project ID	0	Total Value 294,113	242,247		26,647	Total Taxable	25,647	2,122.00	Sale History <table border="1"> <thead> <tr> <th>Bk/Pg</th> <th>Grantor</th> <th>Date</th> <th>Price</th> <th>Code</th> </tr> </thead> <tbody> <tr> <td>/</td> <td>MCCLELAND, CODY W &</td> <td>09/24/2018</td> <td>0</td> <td>4</td> </tr> <tr> <td>2567/808</td> <td>DELOZIER, KENNETH W &</td> <td>07/31/2016</td> <td>0</td> <td>4</td> </tr> </tbody> </table>					Bk/Pg	Grantor	Date	Price	Code	/	MCCLELAND, CODY W &	09/24/2018	0	4	2567/808	DELOZIER, KENNETH W &	07/31/2016	0	4																												
Source	REAL	Fair Cash	Capped	Asmnt Level	Assessed	Levy Rate	82.750	Current Tax																																																																																									
Remove Cap	0	Land Value 288	288	11%	32	Assessed	26,647	2,205.04																																																																																									
Year Frozen	0	Improvements 293,825	241,959		26,615	Penalty	0																																																																																										
Uncapped Value	0	Mobile Home 0	0		0	Exemption	1,000	-83.00																																																																																									
TIF Project ID	0	Total Value 294,113	242,247		26,647	Total Taxable	25,647	2,122.00																																																																																									
Bk/Pg	Grantor	Date	Price	Code																																																																																													
/	MCCLELAND, CODY W &	09/24/2018	0	4																																																																																													
2567/808	DELOZIER, KENNETH W &	07/31/2016	0	4																																																																																													
Assessment History <table border="1"> <thead> <tr> <th>Tax Year</th> <th>Statement Number</th> <th>Billed Owner</th> <th>Tax Area</th> <th>Total Value</th> <th>Exemptions</th> <th>Taxable Value</th> <th>Billed Tax</th> </tr> </thead> <tbody> <tr><td>2025</td><td>2025-660099632</td><td>MCCLELAND, CODY W &</td><td>14</td><td>235,192</td><td>1000</td><td>24,871</td><td>2,058.00</td></tr> <tr><td>2024</td><td>2024-660099632</td><td>MCCLELAND, CODY W &</td><td>14</td><td>244,222</td><td>1000</td><td>25,865</td><td>2,183.00</td></tr> <tr><td>2023</td><td>2023-660099632</td><td>MCCLELAND, CODY W &</td><td>14</td><td>274,833</td><td>1000</td><td>25,686</td><td>2,189.00</td></tr> <tr><td>2022</td><td>2022-660099632</td><td>MCCLELAND, CODY W &</td><td>14</td><td>277,853</td><td>1000</td><td>24,909</td><td>2,108.00</td></tr> <tr><td>2021</td><td>2021-660099632</td><td>MCCLELAND, CODY W &</td><td>14</td><td>228,670</td><td>1000</td><td>24,154</td><td>2,047.00</td></tr> <tr><td>2020</td><td>2020-660099632</td><td>MCCLELAND, CODY W &</td><td>14</td><td>226,618</td><td>1000</td><td>23,691</td><td>2,009.00</td></tr> <tr><td>2019</td><td>2019-660099632</td><td>MCCLELAND, CODY W &</td><td>14</td><td>217,921</td><td>1000</td><td>22,972</td><td>1,973.00</td></tr> <tr><td>2018</td><td>2018-660099632</td><td>MCCLELAND, CODY W &</td><td>14</td><td>288</td><td>0</td><td>32</td><td>3.00</td></tr> <tr><td>2017</td><td>2017-660099632</td><td>MCCLELAND, CODY W &</td><td>14</td><td>288</td><td>0</td><td>32</td><td>3.00</td></tr> <tr><td>2016</td><td>2016-660099632</td><td>MCCLELAND, CODY W &</td><td>14</td><td>288</td><td>0</td><td>32</td><td>3.00</td></tr> </tbody> </table>										Tax Year	Statement Number	Billed Owner	Tax Area	Total Value	Exemptions	Taxable Value	Billed Tax	2025	2025-660099632	MCCLELAND, CODY W &	14	235,192	1000	24,871	2,058.00	2024	2024-660099632	MCCLELAND, CODY W &	14	244,222	1000	25,865	2,183.00	2023	2023-660099632	MCCLELAND, CODY W &	14	274,833	1000	25,686	2,189.00	2022	2022-660099632	MCCLELAND, CODY W &	14	277,853	1000	24,909	2,108.00	2021	2021-660099632	MCCLELAND, CODY W &	14	228,670	1000	24,154	2,047.00	2020	2020-660099632	MCCLELAND, CODY W &	14	226,618	1000	23,691	2,009.00	2019	2019-660099632	MCCLELAND, CODY W &	14	217,921	1000	22,972	1,973.00	2018	2018-660099632	MCCLELAND, CODY W &	14	288	0	32	3.00	2017	2017-660099632	MCCLELAND, CODY W &	14	288	0	32	3.00	2016	2016-660099632	MCCLELAND, CODY W &	14	288	0	32	3.00
Tax Year	Statement Number	Billed Owner	Tax Area	Total Value	Exemptions	Taxable Value	Billed Tax																																																																																										
2025	2025-660099632	MCCLELAND, CODY W &	14	235,192	1000	24,871	2,058.00																																																																																										
2024	2024-660099632	MCCLELAND, CODY W &	14	244,222	1000	25,865	2,183.00																																																																																										
2023	2023-660099632	MCCLELAND, CODY W &	14	274,833	1000	25,686	2,189.00																																																																																										
2022	2022-660099632	MCCLELAND, CODY W &	14	277,853	1000	24,909	2,108.00																																																																																										
2021	2021-660099632	MCCLELAND, CODY W &	14	228,670	1000	24,154	2,047.00																																																																																										
2020	2020-660099632	MCCLELAND, CODY W &	14	226,618	1000	23,691	2,009.00																																																																																										
2019	2019-660099632	MCCLELAND, CODY W &	14	217,921	1000	22,972	1,973.00																																																																																										
2018	2018-660099632	MCCLELAND, CODY W &	14	288	0	32	3.00																																																																																										
2017	2017-660099632	MCCLELAND, CODY W &	14	288	0	32	3.00																																																																																										
2016	2016-660099632	MCCLELAND, CODY W &	14	288	0	32	3.00																																																																																										



Rogers

Assessment Property Record Card for Tax Year 2026

Data provided by LISA DELOZIER County Assessor

Date 04/18/2026
 Time 09:21:03
 Page 2

Lot Data	Primary Image
Lot Size Lot Count Units Buildable Non-Ag Acres Topography Street Access Utilities Amenities LAND QUALITY Method Base Lot Value Factor Value Adjustments Lot Value	

Residential Data	
Type	1 Single Family Residence
Condition	3 - Average
Quality	3 - Average
Architecture	
Style	100% 1 1/2 Story Finished
Exterior Wall	100% Frame, Siding, Metal
Base/Total Area	1,280 / 2,560
Style	100% 1 1/2 Story Finished
HVAC	100% Warmed & Cooled Air
Roof Cover	4 Metal, Preformed
Area on Slab	1,280
Fixture/RghIn	11 /
Bed/F/H Bath	3 / 2.0 /
Basement Area	
Garage Type	1,120 Attached Garage - Unfinished
Remodel	
Year/Eff Age	2018 / 6

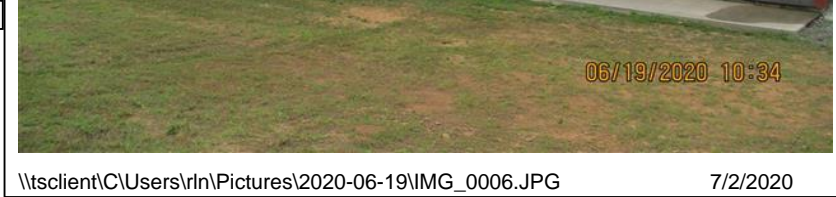

\\tsclient\C\Users\rln\Pictures\2020-06-19\IMG_0006.JPG 7/2/2020

GRM Approach	
GRM Code	
Gross Rent	0.00
Indicated Value	

Multiple Regression	
MRA Code	
Adusted R	
Indicated Value	

Direct Comparables	
Selection Model	1 Res
Adjustment Model	A2 AO Test
Comparables	
Indicated Value	

Cost Approach				Manual : 01/2025			
Base Cost	80.40	Total Misc Impr	+ 17,129	Roofing Adj	+ 2.85	Garage Cost	+ 32,698
Subfloor Adj	+ -1.13	Total RCN	= 306,979	Heat/Cool Adj	+ 12.39	Depreciation (6%)	- 18,419
Plumbing Adj	+ 5.94	Lump Sums	+ 0	Basement Adj	+ 0.00	RCNLD	= 288,560
Adj Base Cost	= 100.45	Lot Value	+ 288,560	Total Area	x 2,560	Indicated Value	= 288,560
Adjusted Cost	= 257,152	Value Per SqFt	112.72				

Value Reconciliation			
Selected Approach	Cost Approach		
Improvements	288,560		
Lot Value			
Indicated Value	288,560	112.72	Per SqFt
Agland Value	288		
Site Improvements	5,265		
Total Value	294,113	114.89	Total Value Per SqFt

Miscellaneous Improvements								
Code	Description	Sketch ID	Size	Year	Units	Unit Cost	Depr	Value
PATO	SLAB PORCH - OPEN	139255	30x12		360	8.54		3,074
PRCH	SLAB PORCH - COVERED	139256	30x12		360	25.28		9,101
PRCH	SLAB PORCH - COVERED	139257	16x12		192	25.80		4,954



Rogers

Assessment Property Record Card for Tax Year 2026

Data provided by LISA DELOZIER County Assessor

Date 04/18/2026

Time 09:21:04

Page 3

Sketch Image

660099632

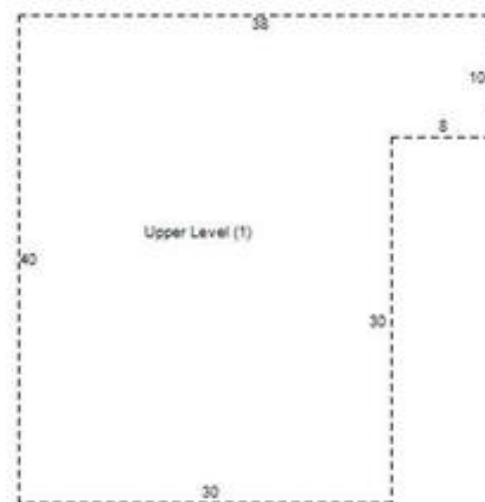
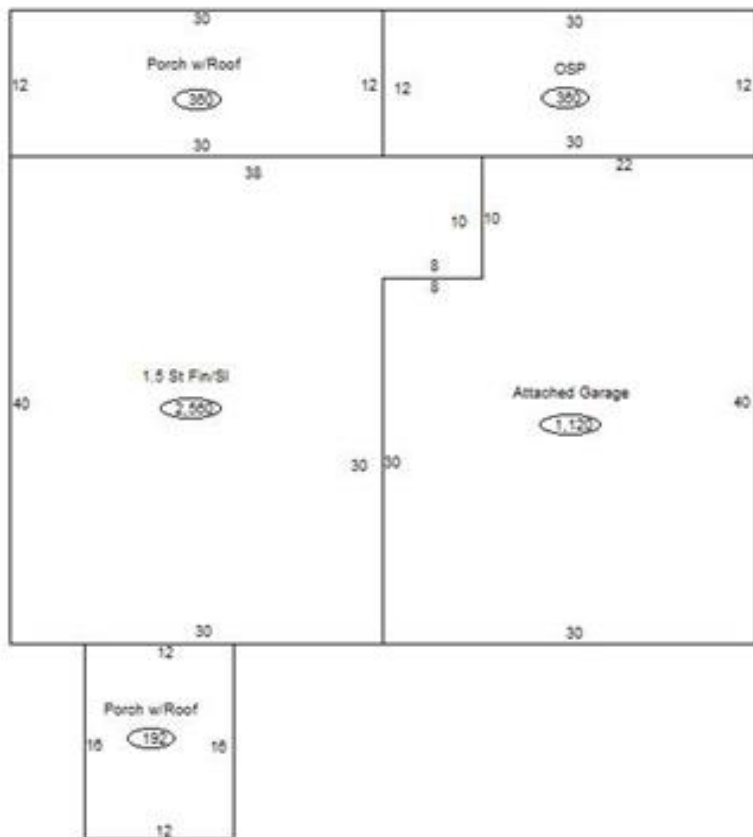

Sketch Vector Information

Sequence	Code	Type	Built Over	Scale	Section Label	Base Area	Multiplier	Total Area
1	R	5	Slab	13	1.5 St Fin/Sl	1,280	2.000	2,560
2	G	1		13	Attached Garage	1,120	1.000	1,120
3	M	PATO		13	Open Slab	360	1.000	360
4	M	PRCH		13	SLBC	360	1.000	360
5	M	PRCH		13	SLBC	192	1.000	192
6	U	^UL		13	Upper Level (1)	1,280	1.000	1,280
Total Building Area						1,280		2,560



Rogers

Assessment Property Record Card for Tax Year 2026

Data provided by LISA DELOZIER County Assessor

Date 04/18/2026
Time 09:21:04
Page 4

660099632

Outbuildings/Site Improvements

Building Image	Code	Description	Dimensions	Floor	Roofing	Total Units
	MS	MECH SHED	30x30x12			900
	Qual	3	Cond 3	Year	2024	Eff Age
		Valuation Summary	Modifier Total	RCN	Depr (0% Phys/ % Func)	RCNLD
		Base Cost (5.85 x 900)	5,265		5,265	5,265



Rogers

Assessment Property Record Card for Tax Year 2026

Data provided by LISA DELOZIER County Assessor

Date 04/18/2026
Time 09:21:04
Page 5

Agland Inventory

660099632

Soi	Description	Land Use	LPI	Adj Type	Adj Code	Acres	Use/Acre	Mkt/Acre	Use Value	Market Value
DBC	DENNIS-BATES COMPLEX 2-5%	NTV PST	60			2.000	144	144	288	288
NTV PST Totals						2.000			288	288
Total Agland						2.000			288	288