



Rogers

Assessment Property Record Card for Tax Year 2026

Data provided by LISA DELOZIER County Assessor

Date 04/18/2026
Time 09:22:23
Page 1

Assessment Data					Primary Image																																																																																				
Account 660099737 Parcel ID 000000-00-0-00299-002-0004 Cadastral ID 05-21-16-18040 Property Type REAL - Real Property Property Class URP VI Area 1 Tax Area 17 - CLAREMORE OT Name ID 326979 JONES, ROBERT & RICKY MOORE 1506 FOREST HILL DR CLAREMORE OK 74017-0000 Parcel Location Situs 01506 FOREST HILL DR Subdivision ESTATES AT FOREST PARK II Lot/Block 0004 / 0002 Parcel Size 1 - Lots Sec/Twn/Rng 5 / 21 / 16 / 5 Neighborhood 1154 - R-V01-NW CLAREMORE School District S001 - CLAREMORE SCHOOLS					<p>\\tsclient\T\LOGAN\LOGAN RESIDENTIAL VI\2023-4-5\IMG_0012. 4/5/2023</p>																																																																																				
Legal Description Lot/Long: 36.33599622 -95.62649033 LOT 4 BLOCK 2 ESTATES AT FOREST PARK PHASE II																																																																																									
Exemptions <table border="1"> <thead> <tr> <th>Code</th> <th>Type</th> <th>Active</th> <th>Maximum</th> <th>Exemption</th> </tr> </thead> <tbody> <tr> <td>H</td> <td>Homestead</td> <td>Yes</td> <td>1,000</td> <td>1,000</td> </tr> </tbody> </table>					Code	Type	Active	Maximum	Exemption	H	Homestead	Yes	1,000	1,000	Building Permits <table border="1"> <thead> <tr> <th>Number</th> <th>Description</th> <th>Opened</th> <th>Closed</th> <th>Amount</th> </tr> </thead> <tbody> <tr> <td>R18 0094</td> <td>R19- NEW 2419 SQ FT SFR</td> <td>03/2018</td> <td>10/2018</td> <td>200,000</td> </tr> </tbody> </table>					Number	Description	Opened	Closed	Amount	R18 0094	R19- NEW 2419 SQ FT SFR	03/2018	10/2018	200,000																																																												
Code	Type	Active	Maximum	Exemption																																																																																					
H	Homestead	Yes	1,000	1,000																																																																																					
Number	Description	Opened	Closed	Amount																																																																																					
R18 0094	R19- NEW 2419 SQ FT SFR	03/2018	10/2018	200,000																																																																																					
Parcel Valuation <table border="1"> <thead> <tr> <th>Source</th> <th>REAL</th> <th>Fair Cash</th> <th>Capped</th> <th>Asmnt Level</th> <th>Assessed</th> <th>Levy Rate</th> <th>92.430</th> <th>Current Tax</th> </tr> </thead> <tbody> <tr> <td>Remove Cap</td> <td>2020</td> <td>Land Value</td> <td>39,900</td> <td>32,030</td> <td>11%</td> <td>3,523</td> <td>Assessed</td> <td>40,344 3,729.00</td> </tr> <tr> <td>Year Frozen</td> <td></td> <td>Improvements</td> <td>358,133</td> <td>334,738</td> <td></td> <td>36,821</td> <td>Penalty</td> <td>0</td> </tr> <tr> <td>Uncapped Value</td> <td>0</td> <td>Mobile Home</td> <td>0</td> <td>0</td> <td></td> <td>0</td> <td>Exemption</td> <td>1,000 -92.00</td> </tr> <tr> <td>TIF Project ID</td> <td>0</td> <td>Total Value</td> <td>398,033</td> <td>366,768</td> <td></td> <td>40,344</td> <td>Total Taxable</td> <td>39,344 3,637.00</td> </tr> </tbody> </table>					Source	REAL	Fair Cash	Capped	Asmnt Level	Assessed	Levy Rate	92.430	Current Tax	Remove Cap	2020	Land Value	39,900	32,030	11%	3,523	Assessed	40,344 3,729.00	Year Frozen		Improvements	358,133	334,738		36,821	Penalty	0	Uncapped Value	0	Mobile Home	0	0		0	Exemption	1,000 -92.00	TIF Project ID	0	Total Value	398,033	366,768		40,344	Total Taxable	39,344 3,637.00	Sale History <table border="1"> <thead> <tr> <th>Bk/Pg</th> <th>Grantor</th> <th>Date</th> <th>Price</th> <th>Code</th> </tr> </thead> <tbody> <tr> <td>/</td> <td>EXECUTIVE HOMES LLC</td> <td>03/01/2019</td> <td>310,000</td> <td>YES</td> </tr> <tr> <td>2696/139</td> <td>NORTHLAKE ESTATES LLC</td> <td>03/01/2018</td> <td>262,000</td> <td>15</td> </tr> </tbody> </table>					Bk/Pg	Grantor	Date	Price	Code	/	EXECUTIVE HOMES LLC	03/01/2019	310,000	YES	2696/139	NORTHLAKE ESTATES LLC	03/01/2018	262,000	15																				
Source	REAL	Fair Cash	Capped	Asmnt Level	Assessed	Levy Rate	92.430	Current Tax																																																																																	
Remove Cap	2020	Land Value	39,900	32,030	11%	3,523	Assessed	40,344 3,729.00																																																																																	
Year Frozen		Improvements	358,133	334,738		36,821	Penalty	0																																																																																	
Uncapped Value	0	Mobile Home	0	0		0	Exemption	1,000 -92.00																																																																																	
TIF Project ID	0	Total Value	398,033	366,768		40,344	Total Taxable	39,344 3,637.00																																																																																	
Bk/Pg	Grantor	Date	Price	Code																																																																																					
/	EXECUTIVE HOMES LLC	03/01/2019	310,000	YES																																																																																					
2696/139	NORTHLAKE ESTATES LLC	03/01/2018	262,000	15																																																																																					
Assessment History <table border="1"> <thead> <tr> <th>Tax Year</th> <th>Statement Number</th> <th>Billed Owner</th> <th>Tax Area</th> <th>Total Value</th> <th>Exemptions</th> <th>Taxable Value</th> <th>Billed Tax</th> </tr> </thead> <tbody> <tr> <td>2025</td> <td>2025-660099737</td> <td>JONES, ROBERT &</td> <td>17</td> <td>383,625</td> <td>1000</td> <td>38,170</td> <td>3,528.00</td> </tr> <tr> <td>2024</td> <td>2024-660099737</td> <td>JONES, ROBERT &</td> <td>17</td> <td>395,524</td> <td>1000</td> <td>37,029</td> <td>3,422.00</td> </tr> <tr> <td>2023</td> <td>2023-660099737</td> <td>JONES, ROBERT &</td> <td>17</td> <td>375,832</td> <td>1000</td> <td>35,921</td> <td>3,290.00</td> </tr> <tr> <td>2022</td> <td>2022-660099737</td> <td>JONES, ROBERT &</td> <td>17</td> <td>358,029</td> <td>1000</td> <td>34,846</td> <td>3,226.00</td> </tr> <tr> <td>2021</td> <td>2021-660099737</td> <td>JONES, ROBERT &</td> <td>17</td> <td>316,379</td> <td>1000</td> <td>33,802</td> <td>2,985.00</td> </tr> <tr> <td>2020</td> <td>2020-660099737</td> <td>JONES, ROBERT &</td> <td>17</td> <td>310,483</td> <td>1000</td> <td>33,153</td> <td>3,036.00</td> </tr> <tr> <td>2019</td> <td>2019-660099737</td> <td>JONES, ROBERT &</td> <td>17</td> <td>144,861</td> <td>0</td> <td>15,935</td> <td>1,476.00</td> </tr> <tr> <td>2018</td> <td>2018-660099737</td> <td>EXECUTIVE HOMES LLC</td> <td>17</td> <td>4,773</td> <td>0</td> <td>525</td> <td>49.00</td> </tr> <tr> <td>2017</td> <td>2017-660099737</td> <td>NORTHLAKE ESTATES LLC</td> <td>17</td> <td>4,773</td> <td>0</td> <td>525</td> <td>48.00</td> </tr> </tbody> </table>										Tax Year	Statement Number	Billed Owner	Tax Area	Total Value	Exemptions	Taxable Value	Billed Tax	2025	2025-660099737	JONES, ROBERT &	17	383,625	1000	38,170	3,528.00	2024	2024-660099737	JONES, ROBERT &	17	395,524	1000	37,029	3,422.00	2023	2023-660099737	JONES, ROBERT &	17	375,832	1000	35,921	3,290.00	2022	2022-660099737	JONES, ROBERT &	17	358,029	1000	34,846	3,226.00	2021	2021-660099737	JONES, ROBERT &	17	316,379	1000	33,802	2,985.00	2020	2020-660099737	JONES, ROBERT &	17	310,483	1000	33,153	3,036.00	2019	2019-660099737	JONES, ROBERT &	17	144,861	0	15,935	1,476.00	2018	2018-660099737	EXECUTIVE HOMES LLC	17	4,773	0	525	49.00	2017	2017-660099737	NORTHLAKE ESTATES LLC	17	4,773	0	525	48.00
Tax Year	Statement Number	Billed Owner	Tax Area	Total Value	Exemptions	Taxable Value	Billed Tax																																																																																		
2025	2025-660099737	JONES, ROBERT &	17	383,625	1000	38,170	3,528.00																																																																																		
2024	2024-660099737	JONES, ROBERT &	17	395,524	1000	37,029	3,422.00																																																																																		
2023	2023-660099737	JONES, ROBERT &	17	375,832	1000	35,921	3,290.00																																																																																		
2022	2022-660099737	JONES, ROBERT &	17	358,029	1000	34,846	3,226.00																																																																																		
2021	2021-660099737	JONES, ROBERT &	17	316,379	1000	33,802	2,985.00																																																																																		
2020	2020-660099737	JONES, ROBERT &	17	310,483	1000	33,153	3,036.00																																																																																		
2019	2019-660099737	JONES, ROBERT &	17	144,861	0	15,935	1,476.00																																																																																		
2018	2018-660099737	EXECUTIVE HOMES LLC	17	4,773	0	525	49.00																																																																																		
2017	2017-660099737	NORTHLAKE ESTATES LLC	17	4,773	0	525	48.00																																																																																		



Rogers

Assessment Property Record Card for Tax Year 2026

Data provided by LISA DELOZIER County Assessor

Date 04/18/2026
Time 09:22:23
Page 2

Lot Data		Square-Foot - NBHD 1154 #1	
Lot Size	0	0	
Lot Count	1		
Units Buildable			
Non-Ag Acres	0.3053		
Topography			
Street Access			
Utilities			
Amenities	LOT SIZE ADJUSTMENT		0
			0
Method	Square-Foot		
Base Lot Value	13,300.00 x 3.00 = 39,900		
Factor Value			
Adjustments	1.0000		
Lot Value	39,900		



\\tsclient\T\LOGAN\LOGAN RESIDENTIAL VI\2023-4-5\IMG_0012. 4/5/2023

Residential Data	
Type	1 Single Family Residence
Condition	3 - Average
Quality	3.5 - Average
Architecture	
Style	100% One Story
Exterior Wall	80% Veneer, Masonry 20% Veneer, Stone
Base/Total Area	2,474 / 2,474
Style	100% One Story
HVAC	100% Warmed & Cooled Air
Roof Cover	1 Composition Shingle
Area on Slab	2,474
Fixture/RghIn	14 /
Bed/F/H Bath	4 / 2.0 / 1.0
Basement Area	
Garage Type	800 Attached Garage - Unfinished
Remodel	
Year/Eff Age	2018 / 6

GRM Approach	
GRM Code	
Gross Rent	0.00
Indicated Value	

Multiple Regression			
MRA Code	1	Test	
Adjusted R	0.8445		
Indicated Value	361,625	146.17	Per SqFt

Direct Comparables			
Selection Model	A	Adam Test	
Adjustment Model	1	2022 Residential	
Comparables	6		
Indicated Value	403,340		Per SqFt

Cost Approach		Manual : 01/2025	
Base Cost	109.92	Total Misc Impr	+ 16,691
Roofing Adj	+ 5.18	Garage Cost	+ 29,768
Subfloor Adj	+ -3.38	Total RCN	= 380,993
Heat/Cool Adj	+ 14.47	Depreciation (6%)	- 22,860
Plumbing Adj	+ 9.03	Lump Sums	+ 0
Basement Adj	+ 0.00	RCNLD	= 358,133
Adj Base Cost	= 135.22	Lot Value	+ 39,900
Total Area	x 2,474	Indicated Value	= 398,033
Adjusted Cost	= 334,534	Value Per SqFt	160.89

Value Reconciliation			
Selected Approach	Cost Approach		
Improvements	358,133		
Lot Value	39,900		
Indicated Value	398,033	160.89	Per SqFt
Agland Value			
Site Improvements			
Total Value	398,033	160.89	Total Value Per SqFt

Miscellaneous Improvements								
Code	Description	Sketch ID	Size	Year	Units	Unit Cost	Depr	Value
FPR1	FIREPLACE - RESIDENTIAL 1 STORY	0		1	1	6,429.63		6,430
PRCH	SLAB PORCH - COVERED	138897		324	324	28.40		9,202
PRCH	SLAB PORCH - COVERED	138898		6x6	36	29.42		1,059



Rogers

Assessment Property Record Card for Tax Year 2026

Data provided by LISA DELOZIER County Assessor

Date 04/18/2026

Time 09:22:23

Page 3

Sketch Image

660099737

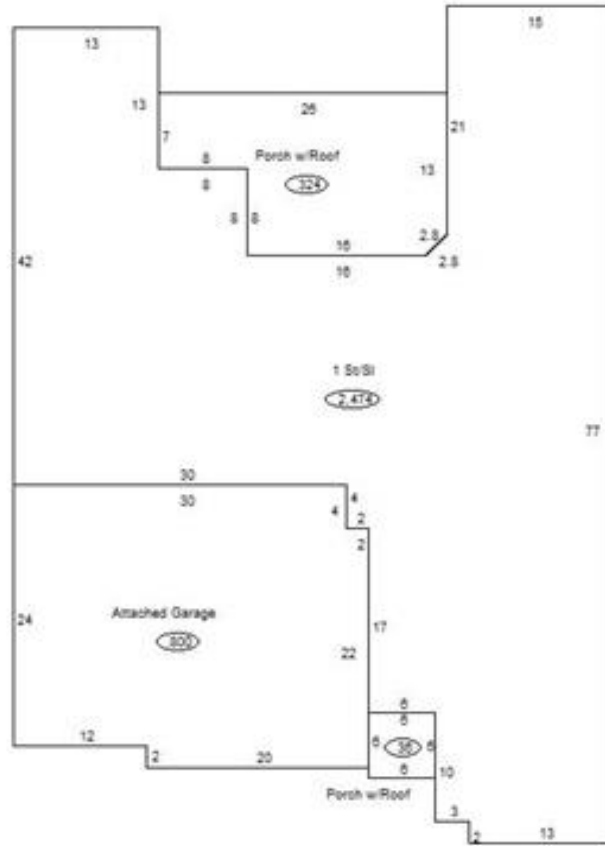

Sketch Vector Information

Sequence	Code	Type	Built Over	Scale	Section Label	Base Area	Multiplier	Total Area
1	R	1	Slab	13	1 St/SI	2,474	1.000	2,474
2	G	1		13	Attached Garage	800	1.000	800
3	M	PRCH		13	SLBC	324	1.000	324
4	M	PRCH		13	SLBC	36	1.000	36
Total Building Area						2,474		2,474