



# Rogers

## Assessment Property Record Card for Tax Year 2026

Data provided by LISA DELOZIER County Assessor

Date 04/18/2026  
 Time 09:22:26  
 Page 1

Assessment Data					Primary Image														
<b>Account</b> 660099739 <b>Parcel ID</b> 000000-00-0-00299-002-0006 <b>Cadastral ID</b> 05-21-16-18060 <b>Property Type</b> REAL - Real Property <b>Property Class</b> URP VI Area 1 <b>Tax Area</b> 17 - CLAREMORE OT <b>Name ID</b> 325607 STOKES, WILLIAM L & KATHY OAKLEY STOKES REVOCABLE LIVING TRUST  1602 FOREST HILL DR CLAREMORE OK 74017-0000  <b>Parcel Location</b> <b>Situs</b> 01602 FOREST HILL DR <b>Subdivision</b> ESTATES AT FOREST PARK II <b>Lot/Block</b> 0006 / 0002 <b>Parcel Size</b> 1 - Lots <b>Sec/Twn/Rng</b> 5 / 21 / 16 / 5 <b>Neighborhood</b> 1154 - R-V01-NW CLAREMORE <b>School District</b> S001 - CLAREMORE SCHOOLS					<p>\\tsclient\T\LOGAN\LOGAN RESIDENTIAL VI\2023-4-5\IMG_0014. 4/5/2023</p>														
<b>Legal Description</b> Lat/Long: 36.33595593 -95.62700355																			
LOT 6 BLOCK 2 ESTATES AT FOREST PARK PHASE II					<b>Building Permits</b> <table border="1"> <thead> <tr> <th>Number</th> <th>Description</th> <th>Opened</th> <th>Closed</th> <th>Amount</th> </tr> </thead> <tbody> <tr> <td>R18 0098</td> <td>R19- NEW SFR 2716 SQ FT</td> <td>03/2018</td> <td>10/2018</td> <td>210,000</td> </tr> </tbody> </table>					Number	Description	Opened	Closed	Amount	R18 0098	R19- NEW SFR 2716 SQ FT	03/2018	10/2018	210,000
Number	Description	Opened	Closed	Amount															
R18 0098	R19- NEW SFR 2716 SQ FT	03/2018	10/2018	210,000															
<b>Exemptions</b>					<b>Sale History</b>														
<b>Code</b>	<b>Type</b>	<b>Active</b>	<b>Maximum</b>	<b>Exemption</b>	<b>Bk/Pg</b>	<b>Grantor</b>	<b>Date</b>	<b>Price</b>	<b>Code</b>										
H	Homestead	Yes	1,000	1,000	/	EXECUTIVE HOMES LLC	09/10/2018	339,000	YES										
					2696/139	NORTHLAKE ESTATES LLC	03/01/2018	262,000	15										
<b>Parcel Valuation</b>																			
<b>Source</b>	<b>REAL</b>		<b>Fair Cash</b>	<b>Capped</b>	<b>Asmnt Level</b>	<b>Assessed</b>	<b>Levy Rate</b>	92.430	<b>Current Tax</b>										
Remove Cap	2019		Land Value	39,594	31,784	11%	3,496	Assessed	45,850	4,237.92									
Year Frozen			Improvements	402,372	385,038		42,354	Penalty	0										
Uncapped Value	0		Mobile Home	0	0		0	Exemption	1,000	-93.00									
TIF Project ID	0		<b>Total Value</b>	441,966	416,822		45,850	<b>Total Taxable</b>	44,850	4,145.00									
<b>Assessment History</b>																			
<b>Tax Year</b>	<b>Statement Number</b>	<b>Billed Owner</b>			<b>Tax Area</b>	<b>Total Value</b>	<b>Exemptions</b>	<b>Taxable Value</b>	<b>Billed Tax</b>										
2025	2025-660099739	STOKES, WILLIAM L & KATHY OAKLEY STOKES			17	426,157	1000	43,515	4,022.00										
2024	2024-660099739	STOKES, WILLIAM L & KATHY OAKLEY STOKES			17	441,098	1000	42,218	3,902.00										
2023	2023-660099739	STOKES, WILLIAM L & KATHY OAKLEY STOKES			17	406,910	1000	40,960	3,752.00										
2022	2022-660099739	STOKES, WILLIAM L &			17	389,508	1000	39,737	3,678.00										
2021	2021-660099739	STOKES, WILLIAM L &			17	363,275	1000	38,551	3,404.00										
2020	2020-660099739	STOKES, WILLIAM L &			17	357,002	1000	37,399	3,425.00										
2019	2019-660099739	STOKES, WILLIAM L &			17	338,918	0	37,281	3,453.00										
2018	2018-660099739	STOKES, WILLIAM L &			17	4,773	0	525	49.00										
2017	2017-660099739	NORTHLAKE ESTATES LLC			17	4,773	0	525	48.00										



# Rogers

## Assessment Property Record Card for Tax Year 2026

Data provided by LISA DELOZIER County Assessor

Date 04/18/2026  
Time 09:22:26  
Page 2

Lot Data		Square-Foot - NBHD 1154 #1	
Lot Size	0	0	
Lot Count	1		
Units Buildable			
Non-Ag Acres	0.303		
Topography			
Street Access			
Utilities			
Amenities	LOT SIZE ADJUSTMENT	0	0
Method	Square-Foot		
Base Lot Value	13,198.00 x 3.00 =	39,594	
Factor Value			
Adjustments	1.0000		
Lot Value	39,594		



\\tsclient\T\LOGAN\LOGAN RESIDENTIAL VI\2023-4-5\IMG\_0014. 4/5/2023

Residential Data	
Type	1 Single Family Residence
Condition	3 - Average
Quality	4 - Good
Architecture	
Style	100% One Story
Exterior Wall	90% Veneer, Masonry 10% Veneer, Stone
Base/Total Area	2,755 / 2,755
Style	100% One Story
HVAC	100% Warmed & Cooled Air
Roof Cover	1 Composition Shingle
Area on Slab	2,755
Fixture/RghIn	14 /
Bed/F/H Bath	4 / 2.0 / 1.0
Basement Area	
Garage Type	653 Attached Garage - Unfinished
Remodel	
Year/Eff Age	2018 / 6

GRM Approach	
GRM Code	
Gross Rent	0.00
Indicated Value	

Multiple Regression			
MRA Code	1	Test	
Adusted R	0.8445		
Indicated Value	406,423	147.52	Per SqFt

Direct Comparables			
Selection Model	A	Adam Test	
Adjustment Model	1	2022 Residential	
Comparables	6		
Indicated Value	434,550		Per SqFt

Cost Approach				Manual : 01/2025			
Base Cost	111.37	Total Misc Impr	+	17,395			
Roofing Adj	+ 5.73	Garage Cost	+	30,084			
Subfloor Adj	+ -4.42	Total RCN	=	428,055			
Heat/Cool Adj	+ 16.31	Depreciation ( 6%)	-	25,683			
Plumbing Adj	+ 9.15	Lump Sums	+	0			
Basement Adj	+ 0.00	RCNLD	=	402,372			
Adj Base Cost	= 138.14	Lot Value	+	39,594			
Total Area	x 2,755	Indicated Value	=	441,966			
Adjusted Cost	= 380,576	Value Per SqFt		160.42			

Value Reconciliation			
Selected Approach	Cost Approach		
Improvements	402,372		
Lot Value	39,594		
Indicated Value	441,966	160.42	Per SqFt
Agland Value			
Site Improvements			
Total Value	441,966	160.42	Total Value Per SqFt

Miscellaneous Improvements								
Code	Description	Sketch ID	Size	Year	Units	Unit Cost	Depr	Value
FPR1	FIREPLACE - RESIDENTIAL 1 STORY	0		1	1	7,243.87		7,244
PRCH	SLAB PORCH - COVERED	138901	20x14		280	32.00		8,960
PRCH	SLAB PORCH - COVERED	138902	6x6		36	33.08		1,191



**Rogers**  
**Assessment Property Record Card for Tax Year 2026**

Data provided by LISA DELOZIER County Assessor

Date 04/18/2026  
 Time 09:22:26  
 Page 3

**Sketch Image**

660099739

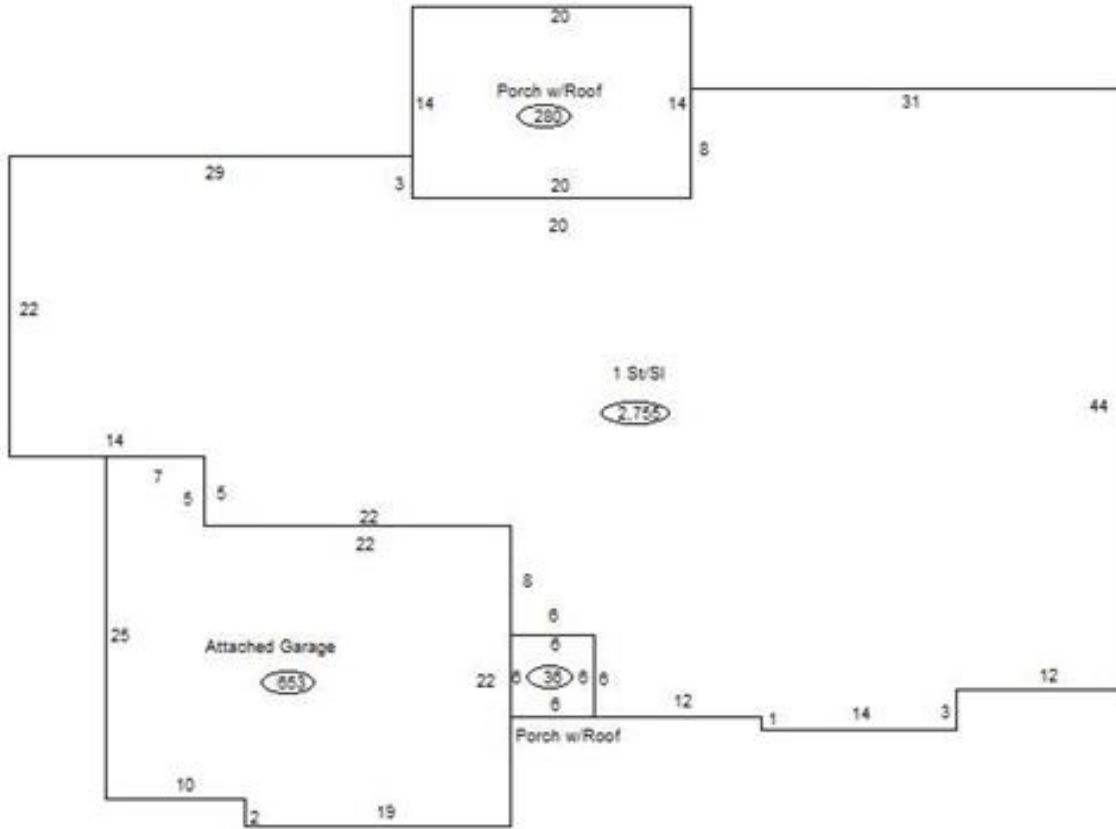

**Sketch Vector Information**

Sequence	Code	Type	Built Over	Scale	Section Label	Base Area	Multiplier	Total Area
1	R	1	Slab	13	1 St/Sl	2,755	1.000	2,755
2	G	1		13	Attached Garage	653	1.000	653
3	M	PRCH		13	SLBC	280	1.000	280
4	M	PRCH		13	SLBC	36	1.000	36
<b>Total Building Area</b>						<b>2,755</b>		<b>2,755</b>