



Rogers

Assessment Property Record Card for Tax Year 2026

Data provided by LISA DELOZIER County Assessor

Date 04/18/2026
 Time 09:23:10
 Page 1

Assessment Data					Primary Image																																																																																				
Account 660099764 Parcel ID 0000000-00-000374-001-0018 Cadastral ID 02-20-14-00580 Property Type REAL - Real Property Property Class RRP VI Area 3 Tax Area 3 - OWASSO RURAL/NO FIRE Name ID 323453 HACKER, DARREN & JORDAN 6221 N PEPPER JADE LOOP OWASSO OK 74055-0000 Parcel Location Situs 06221 N PEPPER JADE LOOP Subdivision HIGHLAND POINTE AT STONE CANYON PHASE II Lot/Block 0018 / 0001 Parcel Size 1 - Lots Sec/Twn/Rng 2 / 20 / 14 / 5 Neighborhood 1041 - R-V01,4-SW OWASSO School District S021 - OWASSO SCHOOLS					 <p>\\tsclient\T\LOGAN\LOGAN RESIDENTIAL VI\2021-7-30\IMG_003; 7/30/2021</p>																																																																																				
Legal Description Lat/Long: 36.24479889 -95.78580201 LOT 18 BLOCK 1 HIGHLAND POINTE AT STONE CANYON PHASE II																																																																																									
					Building Permits <table border="1"> <thead> <tr> <th>Number</th> <th>Description</th> <th>Opened</th> <th>Closed</th> <th>Amount</th> </tr> </thead> <tbody> <tr> <td>R23 080</td> <td>R24 NEW RMA 289 SQ FT</td> <td>03/2023</td> <td>07/2023</td> <td>15,000</td> </tr> <tr> <td>R19 000331</td> <td>R21- NEW 3940 SQ FT SFR</td> <td>09/2019</td> <td>08/2020</td> <td>556,582</td> </tr> </tbody> </table>					Number	Description	Opened	Closed	Amount	R23 080	R24 NEW RMA 289 SQ FT	03/2023	07/2023	15,000	R19 000331	R21- NEW 3940 SQ FT SFR	09/2019	08/2020	556,582																																																																	
Number	Description	Opened	Closed	Amount																																																																																					
R23 080	R24 NEW RMA 289 SQ FT	03/2023	07/2023	15,000																																																																																					
R19 000331	R21- NEW 3940 SQ FT SFR	09/2019	08/2020	556,582																																																																																					
Exemptions <table border="1"> <thead> <tr> <th>Code</th> <th>Type</th> <th>Active</th> <th>Maximum</th> <th>Exemption</th> </tr> </thead> <tbody> <tr> <td>H</td> <td>Homestead</td> <td>Yes</td> <td>1,000</td> <td>1,000</td> </tr> </tbody> </table>					Code	Type	Active	Maximum	Exemption	H	Homestead	Yes	1,000	1,000	Sale History <table border="1"> <thead> <tr> <th>Bk/Pg</th> <th>Grantor</th> <th>Date</th> <th>Price</th> <th>Code</th> </tr> </thead> <tbody> <tr> <td>/</td> <td>HACKER, DARREN & JORDAN</td> <td>07/16/2018</td> <td>0</td> <td>4</td> </tr> <tr> <td>2681/840</td> <td>C.A.B.O. DEVELOPMENT COMPANY LI</td> <td>12/15/2017</td> <td>105,000</td> <td>YES</td> </tr> </tbody> </table>					Bk/Pg	Grantor	Date	Price	Code	/	HACKER, DARREN & JORDAN	07/16/2018	0	4	2681/840	C.A.B.O. DEVELOPMENT COMPANY LI	12/15/2017	105,000	YES																																																							
Code	Type	Active	Maximum	Exemption																																																																																					
H	Homestead	Yes	1,000	1,000																																																																																					
Bk/Pg	Grantor	Date	Price	Code																																																																																					
/	HACKER, DARREN & JORDAN	07/16/2018	0	4																																																																																					
2681/840	C.A.B.O. DEVELOPMENT COMPANY LI	12/15/2017	105,000	YES																																																																																					
Parcel Valuation <table border="1"> <thead> <tr> <th>Source</th> <th>REAL</th> <th>Fair Cash</th> <th>Capped</th> <th>Asmnt Level</th> <th>Assessed</th> <th>Levy Rate</th> <th>97.960</th> <th>Current Tax</th> </tr> </thead> <tbody> <tr> <td>Remove Cap</td> <td>2018</td> <td>Land Value 259,826</td> <td>137,165</td> <td>11%</td> <td>15,088</td> <td>Assessed</td> <td>80,292</td> <td>7,865.40</td> </tr> <tr> <td>Year Frozen</td> <td></td> <td>Improvements 637,817</td> <td>592,760</td> <td></td> <td>65,204</td> <td>Penalty</td> <td>0</td> <td></td> </tr> <tr> <td>Uncapped Value</td> <td>0</td> <td>Mobile Home 0</td> <td>0</td> <td></td> <td>0</td> <td>Exemption</td> <td>1,000</td> <td>-98.00</td> </tr> <tr> <td>TIF Project ID</td> <td>0</td> <td>Total Value 897,643</td> <td>729,925</td> <td></td> <td>80,292</td> <td>Total Taxable</td> <td>79,292</td> <td>7,767.00</td> </tr> </tbody> </table>										Source	REAL	Fair Cash	Capped	Asmnt Level	Assessed	Levy Rate	97.960	Current Tax	Remove Cap	2018	Land Value 259,826	137,165	11%	15,088	Assessed	80,292	7,865.40	Year Frozen		Improvements 637,817	592,760		65,204	Penalty	0		Uncapped Value	0	Mobile Home 0	0		0	Exemption	1,000	-98.00	TIF Project ID	0	Total Value 897,643	729,925		80,292	Total Taxable	79,292	7,767.00																																			
Source	REAL	Fair Cash	Capped	Asmnt Level	Assessed	Levy Rate	97.960	Current Tax																																																																																	
Remove Cap	2018	Land Value 259,826	137,165	11%	15,088	Assessed	80,292	7,865.40																																																																																	
Year Frozen		Improvements 637,817	592,760		65,204	Penalty	0																																																																																		
Uncapped Value	0	Mobile Home 0	0		0	Exemption	1,000	-98.00																																																																																	
TIF Project ID	0	Total Value 897,643	729,925		80,292	Total Taxable	79,292	7,767.00																																																																																	
Assessment History <table border="1"> <thead> <tr> <th>Tax Year</th> <th>Statement Number</th> <th>Billed Owner</th> <th>Tax Area</th> <th>Total Value</th> <th>Exemptions</th> <th>Taxable Value</th> <th>Billed Tax</th> </tr> </thead> <tbody> <tr> <td>2025</td> <td>2025-660099764</td> <td>HACKER, DARREN & JORDAN</td> <td>3</td> <td>868,281</td> <td>1000</td> <td>76,954</td> <td>7,538.00</td> </tr> <tr> <td>2024</td> <td>2024-660099764</td> <td>HACKER, DARREN & JORDAN</td> <td>3</td> <td>908,806</td> <td>1000</td> <td>74,683</td> <td>7,175.00</td> </tr> <tr> <td>2023</td> <td>2023-660099764</td> <td>HACKER, DARREN & JORDAN</td> <td>3</td> <td>705,135</td> <td>1000</td> <td>69,330</td> <td>6,497.00</td> </tr> <tr> <td>2022</td> <td>2022-660099764</td> <td>HACKER, DARREN & JORDAN</td> <td>3</td> <td>678,727</td> <td>1000</td> <td>67,281</td> <td>6,592.00</td> </tr> <tr> <td>2021</td> <td>2021-660099764</td> <td>HACKER, DARREN & JORDAN</td> <td>3</td> <td>602,657</td> <td>1000</td> <td>65,292</td> <td>6,316.00</td> </tr> <tr> <td>2020</td> <td>2020-660099764</td> <td>HACKER, DARREN & JORDAN</td> <td>3</td> <td>105,000</td> <td>0</td> <td>11,550</td> <td>1,116.00</td> </tr> <tr> <td>2019</td> <td>2019-660099764</td> <td>HACKER, DARREN & ELISE</td> <td>3</td> <td>105,000</td> <td>0</td> <td>11,550</td> <td>1,117.00</td> </tr> <tr> <td>2018</td> <td>2018-660099764</td> <td>HACKER, DARREN & ELISE</td> <td>3</td> <td>105,000</td> <td>0</td> <td>11,550</td> <td>1,075.00</td> </tr> <tr> <td>2017</td> <td>2017-660099764</td> <td>C.A.B.O. DEVELOPMENT COMPANY LLC</td> <td>3</td> <td>9,258</td> <td>0</td> <td>1,018</td> <td>96.00</td> </tr> </tbody> </table>										Tax Year	Statement Number	Billed Owner	Tax Area	Total Value	Exemptions	Taxable Value	Billed Tax	2025	2025-660099764	HACKER, DARREN & JORDAN	3	868,281	1000	76,954	7,538.00	2024	2024-660099764	HACKER, DARREN & JORDAN	3	908,806	1000	74,683	7,175.00	2023	2023-660099764	HACKER, DARREN & JORDAN	3	705,135	1000	69,330	6,497.00	2022	2022-660099764	HACKER, DARREN & JORDAN	3	678,727	1000	67,281	6,592.00	2021	2021-660099764	HACKER, DARREN & JORDAN	3	602,657	1000	65,292	6,316.00	2020	2020-660099764	HACKER, DARREN & JORDAN	3	105,000	0	11,550	1,116.00	2019	2019-660099764	HACKER, DARREN & ELISE	3	105,000	0	11,550	1,117.00	2018	2018-660099764	HACKER, DARREN & ELISE	3	105,000	0	11,550	1,075.00	2017	2017-660099764	C.A.B.O. DEVELOPMENT COMPANY LLC	3	9,258	0	1,018	96.00
Tax Year	Statement Number	Billed Owner	Tax Area	Total Value	Exemptions	Taxable Value	Billed Tax																																																																																		
2025	2025-660099764	HACKER, DARREN & JORDAN	3	868,281	1000	76,954	7,538.00																																																																																		
2024	2024-660099764	HACKER, DARREN & JORDAN	3	908,806	1000	74,683	7,175.00																																																																																		
2023	2023-660099764	HACKER, DARREN & JORDAN	3	705,135	1000	69,330	6,497.00																																																																																		
2022	2022-660099764	HACKER, DARREN & JORDAN	3	678,727	1000	67,281	6,592.00																																																																																		
2021	2021-660099764	HACKER, DARREN & JORDAN	3	602,657	1000	65,292	6,316.00																																																																																		
2020	2020-660099764	HACKER, DARREN & JORDAN	3	105,000	0	11,550	1,116.00																																																																																		
2019	2019-660099764	HACKER, DARREN & ELISE	3	105,000	0	11,550	1,117.00																																																																																		
2018	2018-660099764	HACKER, DARREN & ELISE	3	105,000	0	11,550	1,075.00																																																																																		
2017	2017-660099764	C.A.B.O. DEVELOPMENT COMPANY LLC	3	9,258	0	1,018	96.00																																																																																		



Rogers

Assessment Property Record Card for Tax Year 2026

Data provided by LISA DELOZIER County Assessor

Date 04/18/2026
Time 09:23:10
Page 2

Lot Data		Square-Foot - NBHD 1041 #1	
Lot Size	0	0	
Lot Count	1		
Units Buildable			
Non-Ag Acres	1.4211		
Topography			
Street Access			
Utilities			
Amenities	LOT TYPE		0
	GATED		0
Method	Square-Foot		
Base Lot Value	61,902.00 x 3.62 = 224,375		
Factor Value			
Adjustments	1.1580		
Lot Value	259,826		



\\tsclient\T\LOGAN\LOGAN RESIDENTIAL VI\2021-7-30\IMG_003; 7/30/2021

Residential Data	
Type	1 Single Family Residence
Condition	5 - Very Good
Quality	5 - Very Good
Architecture	TRAD TRADITIONAL
Style	100% 1 1/2 Story Finished
Exterior Wall	90% Veneer, Masonry 10% Frame, Siding, Wood
Base/Total Area	3,077 / 4,243
Style	100% 1 1/2 Story Finished
HVAC	100% Warmed & Cooled Air
Roof Cover	1 Composition Shingle
Area on Slab	3,077
Fixture/RghIn	17 /
Bed/F/H Bath	5 / 4.0 /
Basement Area	
Garage Type	1,112 Attached Garage - Finished 4 Stalls
Remodel	
Year/Eff Age	2020 / 5

GRM Approach	
GRM Code	
Gross Rent	0.00
Indicated Value	

Multiple Regression			
MRA Code	AO3	Residential	
Adusted R	0.8747		
Indicated Value	816,809	192.51	Per SqFt

Direct Comparables	
Selection Model	A Adam Test
Adjustment Model	1 2022 Residential
Comparables	6
Indicated Value	913,980 Per SqFt

Cost Approach		Manual : 01/2025	
Base Cost	107.44	Total Misc Impr	+ 25,079
Roofing Adj	+ 4.61	Garage Cost	+ 71,635
Subfloor Adj	+ -3.16	Total RCN	= 671,386
Heat/Cool Adj	+ 18.45	Depreciation (5%)	- 33,569
Plumbing Adj	+ 8.10	Lump Sums	+ 0
Basement Adj	+ 0.00	RCNLD	= 637,817
Adj Base Cost	= 135.44	Lot Value	+ 259,826
Total Area	x 4,243	Indicated Value	= 897,643
Adjusted Cost	= 574,672	Value Per SqFt	211.56

Value Reconciliation			
Selected Approach	Cost Approach		
Improvements	637,817		
Lot Value	259,826		
Indicated Value	897,643	211.56	Per SqFt
Agland Value			
Site Improvements			
Total Value	897,643	211.56	Total Value Per SqFt

Miscellaneous Improvements								
Code	Description	Sketch ID	Size	Year	Units	Unit Cost	Depr	Value
FPR1	FIREPLACE - RESIDENTIAL 1 STORY	0		1	1	8,198.48		8,198
PRCH	SLAB PORCH - COVERED	146868	9x7		63	37.12		2,339
PATO	SLAB PORCH - OPEN	146869	9x7		63	16.05		1,011
PRCH	SLAB PORCH - COVERED	146870	19x13		247	36.12		8,922
PATO	SLAB PORCH - OPEN	146871	322		322	12.32		3,967
PATO	SLAB PORCH - OPEN	146872	40		40	16.05		642



Rogers

Assessment Property Record Card for Tax Year 2026

Data provided by LISA DELOZIER County Assessor

Date 04/18/2026

Time 09:23:11

Page 3

Sketch Image

660099764

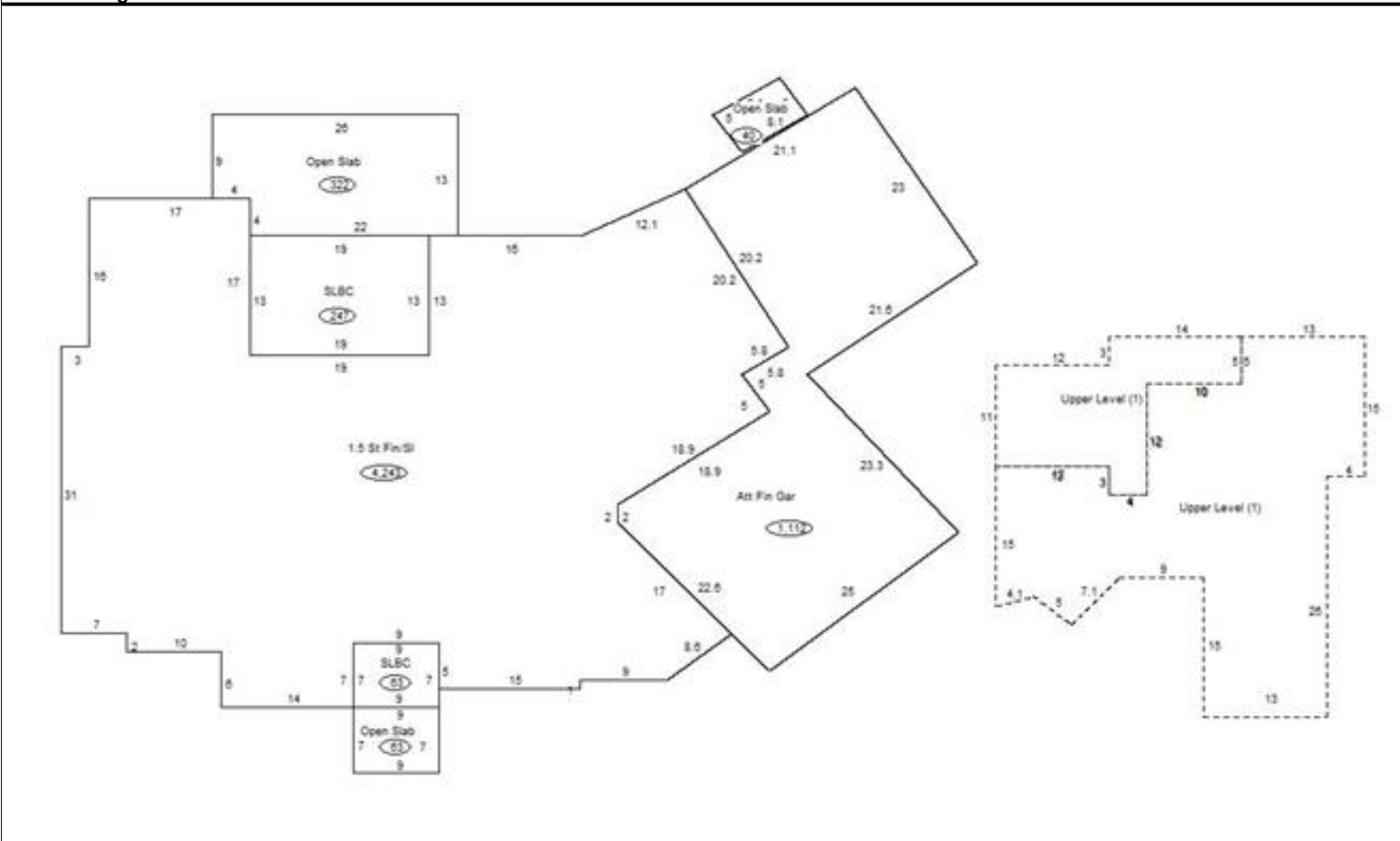

Sketch Vector Information

Sequence	Code	Type	Built Over	Scale	Section Label	Base Area	Multiplier	Total Area
1	R	5	Slab	13	1.5 St Fin/SI	3,077	1.379	4,243
2	G	5		13	Att Fin Gar	1,112	1.000	1,112
3	M	PRCH		13	SLBC	63	1.000	63
4	M	PATO		13	Open Slab	63	1.000	63
5	M	PRCH		13	SLBC	247	1.000	247
6	M	PATO		13	Open Slab	322	1.000	322
7	M	PATO		13	Open Slab	40	1.000	40
8	U	^UL		13	Upper Level (1)	916	1.000	916
9	U	^UL		13	Upper Level (1)	250	1.000	250
Total Building Area						3,077		4,243