



Rogers

Assessment Property Record Card for Tax Year 2026

Data provided by LISA DELOZIER County Assessor

Date 04/18/2026
Time 09:25:41
Page 1

Assessment Data					Primary Image																																																																																				
Account 660099860 Parcel ID 22N16E-25-1-00000-000-0099 Cadastral ID 25-22-16-01010 Property Type REAL - Real Property Property Class RR VI Area 1 Tax Area 94 - SEQUOYAH/TRI-DISTRICT FI Name ID 340618 BRAND, AMBER M & KENNETH M 15820 E 450 RD CLAREMORE OK 74017-0000 Parcel Location Situs 15820 E 450 RD Subdivision Lot/Block / Parcel Size 1.49 - Acres Sec/Twn/Rng 25 / 22 / 16 / 1 Neighborhood 2116 - UNPLATTED School District S006 - SEQUOYAH SCHOOLS					<p>\\tsclient\T\LOGAN\LOGAN RESIDENTIAL VI\2022-12-27\IMG_001 12/27/2022</p>																																																																																				
Legal Description Lat/Long: 36.36501427 -95.54602742 NE NW NE NE LESS E 50' & LESS S 98.40'																																																																																									
Exemptions <table border="1"> <thead> <tr> <th>Code</th> <th>Type</th> <th>Active</th> <th>Maximum</th> <th>Exemption</th> </tr> </thead> <tbody> <tr> <td>H</td> <td>Homestead</td> <td>Yes</td> <td>1,000</td> <td>1,000</td> </tr> </tbody> </table>					Code	Type	Active	Maximum	Exemption	H	Homestead	Yes	1,000	1,000	Building Permits <table border="1"> <thead> <tr> <th>Number</th> <th>Description</th> <th>Opened</th> <th>Closed</th> <th>Amount</th> </tr> </thead> <tbody> <tr> <td></td> <td></td> <td></td> <td></td> <td></td> </tr> </tbody> </table>					Number	Description	Opened	Closed	Amount																																																																	
Code	Type	Active	Maximum	Exemption																																																																																					
H	Homestead	Yes	1,000	1,000																																																																																					
Number	Description	Opened	Closed	Amount																																																																																					
Parcel Valuation <table border="1"> <thead> <tr> <th>Source</th> <th>REAL</th> <th>Fair Cash</th> <th>Capped</th> <th>Asmnt Level</th> <th>Assessed</th> <th>Levy Rate</th> <th>98.320</th> <th>Current Tax</th> </tr> </thead> <tbody> <tr> <td>Remove Cap</td> <td>2023</td> <td>Land Value</td> <td>67,499</td> <td>39,611</td> <td>11%</td> <td>4,357</td> <td>Assessed</td> <td>13,805</td> </tr> <tr> <td>Year Frozen</td> <td>2005</td> <td>Improvements</td> <td>85,893</td> <td>85,893</td> <td></td> <td>9,448</td> <td>Penalty</td> <td>0</td> </tr> <tr> <td>Uncapped Value</td> <td>0</td> <td>Mobile Home</td> <td>0</td> <td>0</td> <td></td> <td>0</td> <td>Exemption</td> <td>1,000</td> </tr> <tr> <td>TIF Project ID</td> <td>0</td> <td>Total Value</td> <td>153,392</td> <td>125,504</td> <td></td> <td>13,805</td> <td>Total Taxable</td> <td>12,805</td> </tr> <tr> <td></td> <td></td> <td></td> <td></td> <td></td> <td></td> <td></td> <td></td> <td>1,269.00</td> </tr> </tbody> </table>					Source	REAL	Fair Cash	Capped	Asmnt Level	Assessed	Levy Rate	98.320	Current Tax	Remove Cap	2023	Land Value	67,499	39,611	11%	4,357	Assessed	13,805	Year Frozen	2005	Improvements	85,893	85,893		9,448	Penalty	0	Uncapped Value	0	Mobile Home	0	0		0	Exemption	1,000	TIF Project ID	0	Total Value	153,392	125,504		13,805	Total Taxable	12,805									1,269.00	Sale History <table border="1"> <thead> <tr> <th>Bk/Pg</th> <th>Grantor</th> <th>Date</th> <th>Price</th> <th>Code</th> </tr> </thead> <tbody> <tr> <td>/</td> <td>QUALITY MD PROPERTIES LLC</td> <td>12/16/2022</td> <td>195,000</td> <td>YES</td> </tr> <tr> <td>2610/312</td> <td>DUDLEY, MATTHEW & BROOKE</td> <td>02/06/2017</td> <td>0</td> <td>4</td> </tr> <tr> <td>2582/818</td> <td>FROMAN, KEVIN & RONI</td> <td>10/06/2016</td> <td>112,000</td> <td>YES</td> </tr> </tbody> </table>					Bk/Pg	Grantor	Date	Price	Code	/	QUALITY MD PROPERTIES LLC	12/16/2022	195,000	YES	2610/312	DUDLEY, MATTHEW & BROOKE	02/06/2017	0	4	2582/818	FROMAN, KEVIN & RONI	10/06/2016	112,000	YES						
Source	REAL	Fair Cash	Capped	Asmnt Level	Assessed	Levy Rate	98.320	Current Tax																																																																																	
Remove Cap	2023	Land Value	67,499	39,611	11%	4,357	Assessed	13,805																																																																																	
Year Frozen	2005	Improvements	85,893	85,893		9,448	Penalty	0																																																																																	
Uncapped Value	0	Mobile Home	0	0		0	Exemption	1,000																																																																																	
TIF Project ID	0	Total Value	153,392	125,504		13,805	Total Taxable	12,805																																																																																	
								1,269.00																																																																																	
Bk/Pg	Grantor	Date	Price	Code																																																																																					
/	QUALITY MD PROPERTIES LLC	12/16/2022	195,000	YES																																																																																					
2610/312	DUDLEY, MATTHEW & BROOKE	02/06/2017	0	4																																																																																					
2582/818	FROMAN, KEVIN & RONI	10/06/2016	112,000	YES																																																																																					
Assessment History <table border="1"> <thead> <tr> <th>Tax Year</th> <th>Statement Number</th> <th>Billed Owner</th> <th>Tax Area</th> <th>Total Value</th> <th>Exemptions</th> <th>Taxable Value</th> <th>Billed Tax</th> </tr> </thead> <tbody> <tr> <td>2025</td> <td>2025-660099860</td> <td>BRAND, AMBER M & KENNETH M</td> <td>94</td> <td>138,444</td> <td>0</td> <td>13,404</td> <td>1,318.00</td> </tr> <tr> <td>2024</td> <td>2024-660099860</td> <td>BRAND, AMBER M &</td> <td>94</td> <td>144,729</td> <td>0</td> <td>12,765</td> <td>1,336.00</td> </tr> <tr> <td>2023</td> <td>2023-660099860</td> <td>BRAND, AMBER M &</td> <td>94</td> <td>110,521</td> <td>0</td> <td>12,157</td> <td>1,299.00</td> </tr> <tr> <td>2022</td> <td>2022-660099860</td> <td>QUALITY MD PROPERTIES LLC</td> <td>94</td> <td>110,593</td> <td>0</td> <td>12,165</td> <td>1,312.00</td> </tr> <tr> <td>2021</td> <td>2021-660099860</td> <td>QUALITY MD PROPERTIES LLC</td> <td>94</td> <td>115,828</td> <td>0</td> <td>12,741</td> <td>1,328.00</td> </tr> <tr> <td>2020</td> <td>2020-660099860</td> <td>QUALITY MD PROPERTIES LLC</td> <td>94</td> <td>116,541</td> <td>0</td> <td>12,819</td> <td>1,334.00</td> </tr> <tr> <td>2019</td> <td>2019-660099860</td> <td>QUALITY MD PROPERTIES LLC</td> <td>94</td> <td>111,493</td> <td>0</td> <td>12,265</td> <td>1,257.00</td> </tr> <tr> <td>2018</td> <td>2018-660099860</td> <td>QUALITY MD PROPERTIES LLC</td> <td>94</td> <td>115,951</td> <td>0</td> <td>12,755</td> <td>1,322.00</td> </tr> <tr> <td>2017</td> <td>2017-660099860</td> <td>QUALITY MD PROPERTIES LLC</td> <td>94</td> <td>115,102</td> <td>0</td> <td>12,662</td> <td>1,295.00</td> </tr> </tbody> </table>										Tax Year	Statement Number	Billed Owner	Tax Area	Total Value	Exemptions	Taxable Value	Billed Tax	2025	2025-660099860	BRAND, AMBER M & KENNETH M	94	138,444	0	13,404	1,318.00	2024	2024-660099860	BRAND, AMBER M &	94	144,729	0	12,765	1,336.00	2023	2023-660099860	BRAND, AMBER M &	94	110,521	0	12,157	1,299.00	2022	2022-660099860	QUALITY MD PROPERTIES LLC	94	110,593	0	12,165	1,312.00	2021	2021-660099860	QUALITY MD PROPERTIES LLC	94	115,828	0	12,741	1,328.00	2020	2020-660099860	QUALITY MD PROPERTIES LLC	94	116,541	0	12,819	1,334.00	2019	2019-660099860	QUALITY MD PROPERTIES LLC	94	111,493	0	12,265	1,257.00	2018	2018-660099860	QUALITY MD PROPERTIES LLC	94	115,951	0	12,755	1,322.00	2017	2017-660099860	QUALITY MD PROPERTIES LLC	94	115,102	0	12,662	1,295.00
Tax Year	Statement Number	Billed Owner	Tax Area	Total Value	Exemptions	Taxable Value	Billed Tax																																																																																		
2025	2025-660099860	BRAND, AMBER M & KENNETH M	94	138,444	0	13,404	1,318.00																																																																																		
2024	2024-660099860	BRAND, AMBER M &	94	144,729	0	12,765	1,336.00																																																																																		
2023	2023-660099860	BRAND, AMBER M &	94	110,521	0	12,157	1,299.00																																																																																		
2022	2022-660099860	QUALITY MD PROPERTIES LLC	94	110,593	0	12,165	1,312.00																																																																																		
2021	2021-660099860	QUALITY MD PROPERTIES LLC	94	115,828	0	12,741	1,328.00																																																																																		
2020	2020-660099860	QUALITY MD PROPERTIES LLC	94	116,541	0	12,819	1,334.00																																																																																		
2019	2019-660099860	QUALITY MD PROPERTIES LLC	94	111,493	0	12,265	1,257.00																																																																																		
2018	2018-660099860	QUALITY MD PROPERTIES LLC	94	115,951	0	12,755	1,322.00																																																																																		
2017	2017-660099860	QUALITY MD PROPERTIES LLC	94	115,102	0	12,662	1,295.00																																																																																		



Rogers

Assessment Property Record Card for Tax Year 2026

Data provided by LISA DELOZIER County Assessor

Date 04/18/2026
Time 09:25:41
Page 2

Lot Data		Square-Foot - NBHD 2116 #1	
Lot Size	0	0	
Lot Count	0		
Units Buildable	1		
Non-Ag Acres	1.4698		
Topography			
Street Access			
Utilities			
Amenities	LAND QUALITY		0
			0
Method	Square-Foot		
Base Lot Value	64,026.00 x .74 = 47,338		
Factor Value			
Adjustments	1.4259		
Lot Value	67,499		



\\tsclient\T\LOGAN\LOGAN RESIDENTIAL VI\2022-12-27\IMG_001 12/27/2022

Residential Data	
Type	1 Single Family Residence
Condition	3 - Average
Quality	2.5 - Fair
Architecture	
Style	100% One Story
Exterior Wall	100% Veneer, Masonry
Base/Total Area	1,149 / 1,149
Style	100% One Story
HVAC	100% Warmed & Cooled Air
Roof Cover	1 Composition Shingle
Area on Slab	0
Fixture/RghIn	8 /
Bed/F/H Bath	3 / 2.0 /
Basement Area	
Garage Type	504 Attached Garage - Unfinished
Remodel	
Year/Eff Age	1968 / 44

GRM Approach	
GRM Code	
Gross Rent	0.00
Indicated Value	

Multiple Regression			
MRA Code	1	Test	
Adusted R	0.8445		
Indicated Value	131,525	114.47	Per SqFt

Direct Comparables	
Selection Model	A Adam Test
Adjustment Model	NewTest
Comparables	
Indicated Value	

Cost Approach		Manual : 01/2025	
Base Cost	109.21	Total Misc Impr	+ 9,375
Roofing Adj	+ 4.61	Garage Cost	+ 13,810
Subfloor Adj	+ 1.19	Total RCN	= 178,943
Heat/Cool Adj	+ 11.47	Depreciation (52%)	- 93,050
Plumbing Adj	+ 9.08	Lump Sums	+ 0
Basement Adj	+ 0.00	RCNLD	= 85,893
Adj Base Cost	= 135.56	Lot Value	+ 67,499
Total Area	x 1,149	Indicated Value	= 153,392
Adjusted Cost	= 155,758	Value Per SqFt	133.50

Value Reconciliation			
Selected Approach	Cost Approach		
Improvements	85,893		
Lot Value	67,499		
Indicated Value	153,392	133.50	Per SqFt
Agland Value			
Site Improvements			
Total Value	153,392	133.50	Total Value Per SqFt

Miscellaneous Improvements								
Code	Description	Sketch ID	Size	Year	Units	Unit Cost	Depr	Value
FPR1	FIREPLACE - RESIDENTIAL 1 STORY	0		1	1	5,095.98		5,096
PRCH	SLAB PORCH - COVERED	51340	12x6		72	24.04		1,731
PATO	SLAB PORCH - OPEN	51341	19x16		304	8.38		2,548



Rogers

Assessment Property Record Card for Tax Year 2026

Data provided by LISA DELOZIER County Assessor

Date 04/18/2026

Time 09:25:41

Page 3

Sketch Image

660099860

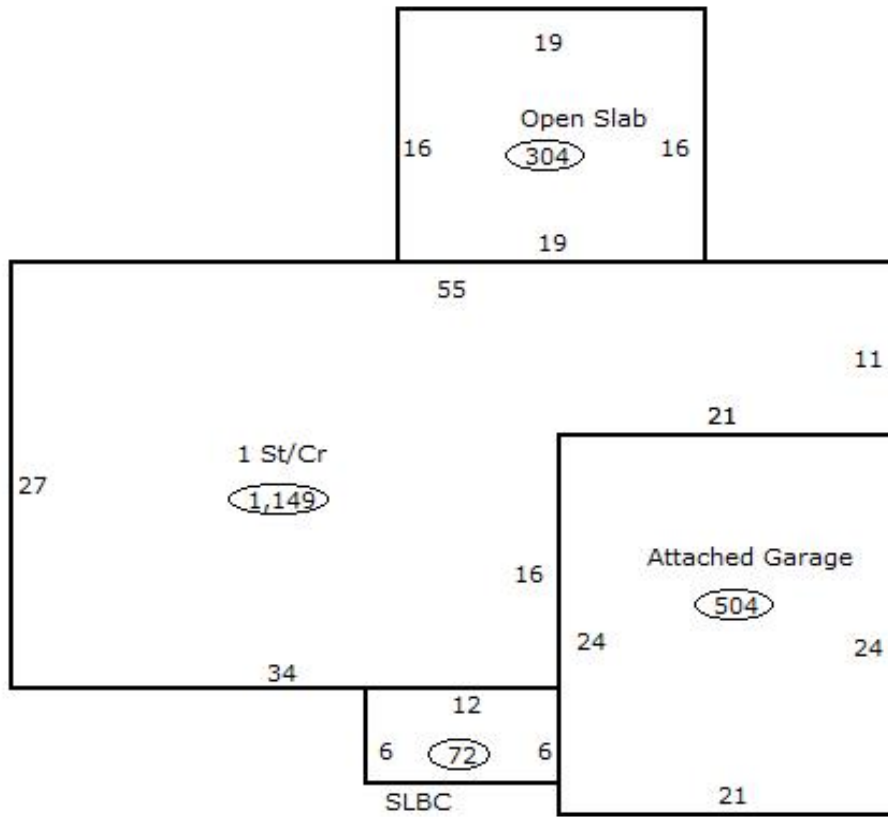

Sketch Vector Information

Sequence	Code	Type	Built Over	Scale	Section Label	Base Area	Multiplier	Total Area
1	R	1	Crawl	13	1 St/Cr	1,149	1.000	1,149
2	G	1		13	Attached Garage	504	1.000	504
3	M	PRCH		13	SLBC	72	1.000	72
4	M	PATO		13	Open Slab	304	1.000	304
Total Building Area						1,149		1,149