



Rogers

Assessment Property Record Card for Tax Year 2026

Data provided by LISA DELOZIER County Assessor

Date 04/18/2026
 Time 09:26:37
 Page 1

Assessment Data					Primary Image																																																																																				
Account 660099960 Parcel ID 21N15E-33-2-00000-000-0099 Cadastral ID 33-21-15-00420 Property Type REAL - Real Property Property Class RA VI Area 4 Tax Area 4 - VERDIGRIS/VERD FIRE Name ID 237164 COLLINS, CLAYTON M-TRUST T JOHN TREADWELL & RACHELLE RENFROW & ROBERT C BREITENSTEIN-TRUSTEES 8992 E 560 RD CLAREMORE OK 74019-0000 Parcel Location Situs 06405 E 525 RD Subdivision Lot/Block / Parcel Size 10.97 - Acres Sec/Twn/Rng 33 / 21 / 15 / 2 Neighborhood 6090 - UNPLATTED School District S008 - VERDIGRIS SCHOOLS																																																																																									
Legal Description Lat/Long: 36.25803097 -95.71726670																																																																																									
Legal Description TR DESC 2023-001915 AS W 165' N2 SE NW & S2 SE NW LESS E 761 97' THEREOF.					Building Permits <table border="1"> <thead> <tr> <th>Number</th> <th>Description</th> <th>Opened</th> <th>Closed</th> <th>Amount</th> </tr> </thead> <tbody> <tr> <td>S23 S24 SPLIT</td> <td></td> <td>03/2023</td> <td>05/2023</td> <td></td> </tr> </tbody> </table>					Number	Description	Opened	Closed	Amount	S23 S24 SPLIT		03/2023	05/2023																																																																							
Number	Description	Opened	Closed	Amount																																																																																					
S23 S24 SPLIT		03/2023	05/2023																																																																																						
Exemptions <table border="1"> <thead> <tr> <th>Code</th> <th>Type</th> <th>Active</th> <th>Maximum</th> <th>Exemption</th> </tr> </thead> <tbody> <tr> <td></td> <td></td> <td></td> <td></td> <td></td> </tr> </tbody> </table>					Code	Type	Active	Maximum	Exemption						Sale History <table border="1"> <thead> <tr> <th>Bk/Pg</th> <th>Grantor</th> <th>Date</th> <th>Price</th> <th>Code</th> </tr> </thead> <tbody> <tr> <td>/</td> <td>COLLINS, CLAYTON M</td> <td>02/14/2023</td> <td>0</td> <td>4</td> </tr> <tr> <td>/</td> <td>COLLINS, CLAYTON M</td> <td>01/23/2023</td> <td>0</td> <td>4</td> </tr> <tr> <td>2593/949</td> <td>COLLINS, JACK R & LOIS I &</td> <td>11/21/2016</td> <td>0</td> <td>4</td> </tr> </tbody> </table>					Bk/Pg	Grantor	Date	Price	Code	/	COLLINS, CLAYTON M	02/14/2023	0	4	/	COLLINS, CLAYTON M	01/23/2023	0	4	2593/949	COLLINS, JACK R & LOIS I &	11/21/2016	0	4																																																		
Code	Type	Active	Maximum	Exemption																																																																																					
Bk/Pg	Grantor	Date	Price	Code																																																																																					
/	COLLINS, CLAYTON M	02/14/2023	0	4																																																																																					
/	COLLINS, CLAYTON M	01/23/2023	0	4																																																																																					
2593/949	COLLINS, JACK R & LOIS I &	11/21/2016	0	4																																																																																					
Parcel Valuation <table border="1"> <thead> <tr> <th>Source</th> <th>REAL</th> <th>Fair Cash</th> <th>Capped</th> <th>Asmnt Level</th> <th>Assessed</th> <th>Levy Rate</th> <th>104.132</th> <th>Current Tax</th> </tr> </thead> <tbody> <tr> <td>Remove Cap</td> <td>0</td> <td>Land Value 2,130</td> <td>2,130</td> <td>11%</td> <td>234</td> <td>Assessed</td> <td>9,627</td> <td>1,002.48</td> </tr> <tr> <td>Year Frozen</td> <td>0</td> <td>Improvements 92,796</td> <td>85,392</td> <td></td> <td>9,393</td> <td>Penalty</td> <td>0</td> <td></td> </tr> <tr> <td>Uncapped Value</td> <td>0</td> <td>Mobile Home 0</td> <td>0</td> <td></td> <td>0</td> <td>Exemption</td> <td>0</td> <td>0.00</td> </tr> <tr> <td>TIF Project ID</td> <td>0</td> <td>Total Value 94,926</td> <td>87,522</td> <td></td> <td>9,627</td> <td>Total Taxable</td> <td>9,627</td> <td>1,002.00</td> </tr> </tbody> </table>										Source	REAL	Fair Cash	Capped	Asmnt Level	Assessed	Levy Rate	104.132	Current Tax	Remove Cap	0	Land Value 2,130	2,130	11%	234	Assessed	9,627	1,002.48	Year Frozen	0	Improvements 92,796	85,392		9,393	Penalty	0		Uncapped Value	0	Mobile Home 0	0		0	Exemption	0	0.00	TIF Project ID	0	Total Value 94,926	87,522		9,627	Total Taxable	9,627	1,002.00																																			
Source	REAL	Fair Cash	Capped	Asmnt Level	Assessed	Levy Rate	104.132	Current Tax																																																																																	
Remove Cap	0	Land Value 2,130	2,130	11%	234	Assessed	9,627	1,002.48																																																																																	
Year Frozen	0	Improvements 92,796	85,392		9,393	Penalty	0																																																																																		
Uncapped Value	0	Mobile Home 0	0		0	Exemption	0	0.00																																																																																	
TIF Project ID	0	Total Value 94,926	87,522		9,627	Total Taxable	9,627	1,002.00																																																																																	
Assessment History <table border="1"> <thead> <tr> <th>Tax Year</th> <th>Statement Number</th> <th>Billed Owner</th> <th>Tax Area</th> <th>Total Value</th> <th>Exemptions</th> <th>Taxable Value</th> <th>Billed Tax</th> </tr> </thead> <tbody> <tr> <td>2025</td> <td>2025-660099960</td> <td>COLLINS, CLAYTON M</td> <td>4</td> <td>90,087</td> <td>0</td> <td>9,347</td> <td>973.00</td> </tr> <tr> <td>2024</td> <td>2024-660099960</td> <td>COLLINS, CLAYTON M</td> <td>4</td> <td>85,750</td> <td>0</td> <td>9,075</td> <td>869.00</td> </tr> <tr> <td>2023</td> <td>2023-660099960</td> <td>COLLINS, CLAYTON M</td> <td>4</td> <td>80,097</td> <td>0</td> <td>8,811</td> <td>832.00</td> </tr> <tr> <td>2022</td> <td>2022-660099960</td> <td>COLLINS, CLAYTON M</td> <td>4</td> <td>90,210</td> <td>0</td> <td>9,923</td> <td>953.00</td> </tr> <tr> <td>2021</td> <td>2021-660099960</td> <td>COLLINS, CLAYTON M</td> <td>4</td> <td>88,034</td> <td>0</td> <td>9,683</td> <td>906.00</td> </tr> <tr> <td>2020</td> <td>2020-660099960</td> <td>COLLINS, CLAYTON M</td> <td>4</td> <td>92,928</td> <td>0</td> <td>9,974</td> <td>936.00</td> </tr> <tr> <td>2019</td> <td>2019-660099960</td> <td>COLLINS, CLAYTON M</td> <td>4</td> <td>88,034</td> <td>0</td> <td>9,683</td> <td>923.00</td> </tr> <tr> <td>2018</td> <td>2018-660099960</td> <td>COLLINS, CLAYTON M</td> <td>4</td> <td>97,119</td> <td>0</td> <td>10,683</td> <td>1,018.00</td> </tr> <tr> <td>2017</td> <td>2017-660099960</td> <td>COLLINS, CLAYTON M</td> <td>4</td> <td>96,177</td> <td>0</td> <td>10,579</td> <td>1,011.00</td> </tr> </tbody> </table>										Tax Year	Statement Number	Billed Owner	Tax Area	Total Value	Exemptions	Taxable Value	Billed Tax	2025	2025-660099960	COLLINS, CLAYTON M	4	90,087	0	9,347	973.00	2024	2024-660099960	COLLINS, CLAYTON M	4	85,750	0	9,075	869.00	2023	2023-660099960	COLLINS, CLAYTON M	4	80,097	0	8,811	832.00	2022	2022-660099960	COLLINS, CLAYTON M	4	90,210	0	9,923	953.00	2021	2021-660099960	COLLINS, CLAYTON M	4	88,034	0	9,683	906.00	2020	2020-660099960	COLLINS, CLAYTON M	4	92,928	0	9,974	936.00	2019	2019-660099960	COLLINS, CLAYTON M	4	88,034	0	9,683	923.00	2018	2018-660099960	COLLINS, CLAYTON M	4	97,119	0	10,683	1,018.00	2017	2017-660099960	COLLINS, CLAYTON M	4	96,177	0	10,579	1,011.00
Tax Year	Statement Number	Billed Owner	Tax Area	Total Value	Exemptions	Taxable Value	Billed Tax																																																																																		
2025	2025-660099960	COLLINS, CLAYTON M	4	90,087	0	9,347	973.00																																																																																		
2024	2024-660099960	COLLINS, CLAYTON M	4	85,750	0	9,075	869.00																																																																																		
2023	2023-660099960	COLLINS, CLAYTON M	4	80,097	0	8,811	832.00																																																																																		
2022	2022-660099960	COLLINS, CLAYTON M	4	90,210	0	9,923	953.00																																																																																		
2021	2021-660099960	COLLINS, CLAYTON M	4	88,034	0	9,683	906.00																																																																																		
2020	2020-660099960	COLLINS, CLAYTON M	4	92,928	0	9,974	936.00																																																																																		
2019	2019-660099960	COLLINS, CLAYTON M	4	88,034	0	9,683	923.00																																																																																		
2018	2018-660099960	COLLINS, CLAYTON M	4	97,119	0	10,683	1,018.00																																																																																		
2017	2017-660099960	COLLINS, CLAYTON M	4	96,177	0	10,579	1,011.00																																																																																		



Rogers

Assessment Property Record Card for Tax Year 2026

Data provided by LISA DELOZIER County Assessor

Date 04/18/2026
 Time 09:26:37
 Page 2

Lot Data		Units-Buildable - UNPLATTED (UNITS BUILDABLE)
Lot Size		
Lot Count	0	
Units Buildable	0	
Non-Ag Acres	0	
Topography		
Street Access		
Utilities		
Amenities	LAND QUALITY	
Method	Units-Buildable	
Base Lot Value		
Factor Value		
Adjustments		
Lot Value		



\\tsclient\C\Users\Randy Necessary\Pictures\101_0707\IMG_0031. 7/7/2022

Residential Data	
Type	1 Single Family Residence
Condition	3 - Average
Quality	2.5 - Fair
Architecture	
Style	100% One Story
Exterior Wall	100% Frame, Siding, Vinyl
Base/Total Area	1,882 / 1,882
Style	100% One Story
HVAC	100% Warmed & Cooled Air
Roof Cover	1 Composition Shingle
Area on Slab	1,882
Fixture/RghIn	11 /
Bed/F/H Bath	4 / 2.0 /
Basement Area	
Garage Type	528 Attached Garage - Unfinished
Remodel	RMA -
Year/Eff Age	1950 / 57

GRM Approach

GRM Code	
Gross Rent	0.00
Indicated Value	

Multiple Regression

MRA Code	
Adjusted R	
Indicated Value	

Direct Comparables

Selection Model	1 Res
Adjustment Model	A2 AO Test
Comparables	
Indicated Value	

Value Reconciliation

Selected Approach	Cost Approach		
Improvements	92,796		
Lot Value			
Indicated Value	92,796	49.31	Per SqFt
Agland Value	2,130		
Site Improvements			
Total Value	94,926	50.44	Total Value Per SqFt

Cost Approach Manual : 01/2025

Base Cost	93.04	Total Misc Impr	+	13,106
Roofing Adj	+ 4.32	Garage Cost	+	14,325
Subfloor Adj	+ -1.13	Total RCN	=	244,200
Heat/Cool Adj	+ 11.47	Depreciation (62%)	-	151,404
Plumbing Adj	+ 7.48	Lump Sums	+	0
Basement Adj	+ 0.00	RCNLD	=	92,796
Adj Base Cost	= 115.18	Lot Value	+	
Total Area	x 1,882	Indicated Value	=	92,796
Adjusted Cost	= 216,769	Value Per SqFt		49.31

Miscellaneous Improvements

Code	Description	Sketch ID	Size	Year	Units	Unit Cost	Depr	Value
PRCH	SLAB PORCH - COVERED	68152	20x6		120	23.88		2,866
PRCH	SLAB PORCH - COVERED	68153	446		446	22.96		10,240



Rogers

Assessment Property Record Card for Tax Year 2026

Data provided by LISA DELOZIER County Assessor

Date 04/18/2026

Time 09:26:37

Page 3

Sketch Image

660099960

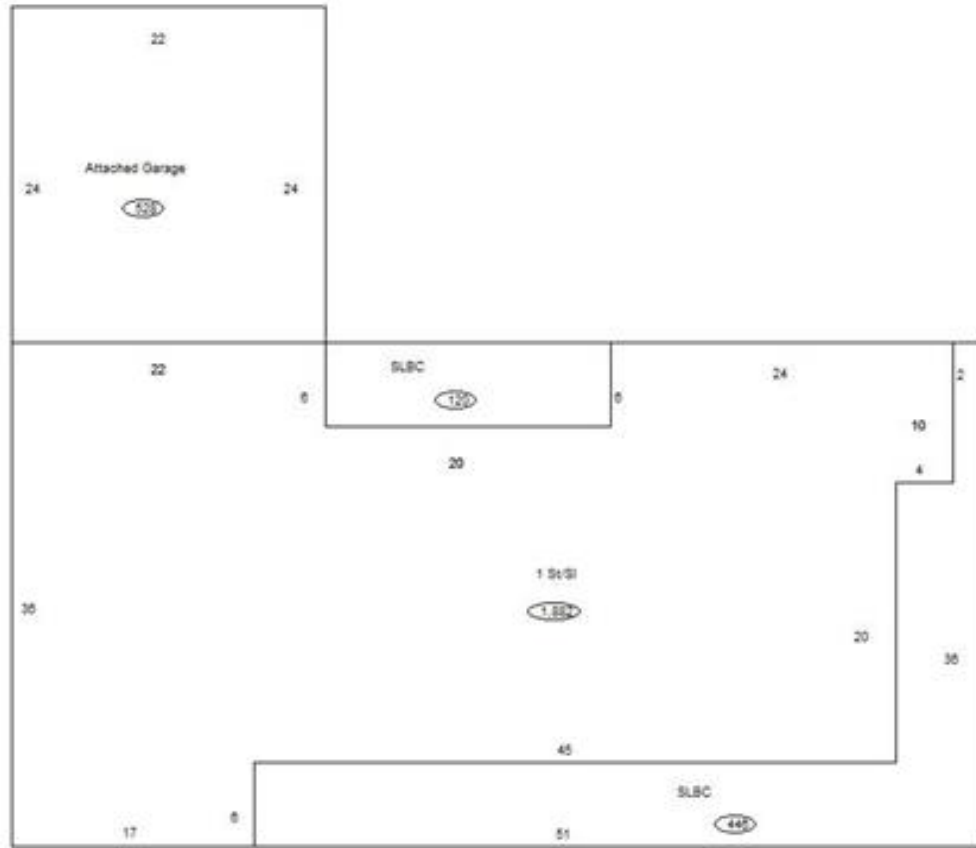

Sketch Vector Information

Sequence	Code	Type	Built Over	Scale	Section Label	Base Area	Multiplier	Total Area
1	R	1	Slab	10	1 St/SI	1,882	1.000	1,882
2	G	1		10	Attached Garage	528	1.000	528
3	M	PRCH		10	SLBC	120	1.000	120
4	M	PRCH		10	SLBC	446	1.000	446
Total Building Area						1,882		1,882



Rogers

Assessment Property Record Card for Tax Year 2026

Data provided by LISA DELOZIER County Assessor

Date 04/18/2026
Time 09:26:37
Page 4

Agland Inventory

660099960

Soi	Description	Land Use	LPI	Adj Type	Adj Code	Acres	Use/Acre	Mkt/Acre	Use Value	Market Value
RVC	RIVERTON GRAVELLY LOAM 3-	TMBR	61			1.040	110	110	114	114
TMBR Totals						1.040			114	114
CHB	CHOTEAU SILT LOAM 1-3% SL	NTV PST	80			6.500	192	192	1,248	1,248
NTV PST Totals						6.500			1,248	1,248
CHB	CHOTEAU SILT LOAM 1-3% SL	IMP PST	80			3.430	224	224	768	768
IMP PST Totals						3.430			768	768
Total Agland						10.970			2,130	2,130