



# Rogers

## Assessment Property Record Card for Tax Year 2026

Data provided by LISA DELOZIER County Assessor

Date 04/18/2026  
Time 09:28:56  
Page 1

Assessment Data				Primary Image															
Account	660100203			<p>\\tsclient\T\LOGAN\LOGAN RESIDENTIAL VI\2022-9-6\IMG_0050. 9/7/2022</p>															
Parcel ID	21N14E-15-2-00000-000-0099																		
Cadastral ID	15-21-14-00824																		
Property Type	REAL - Real Property																		
Property Class	UR	VI Area	4																
Tax Area	40 - OWASSO CITY																		
Name ID	321347																		
NEWMAN, ERIC S																			
10910 E 118TH ST N COLLINSVILLE OK 74021-0000																			
Parcel Location																			
Situs	14506 E 106TH ST N																		
Subdivision																			
Lot/Block	/	Parcel Size	2.44 - Acres																
Sec/Twn/Rng	15 / 21 / 14 / 2																		
Neighborhood	6110 - UNPLATTED																		
School District	S021 - OWASSO SCHOOLS																		
Legal Description				Building Permits															
Lat/Long: 36.30679167 -95.81020246				<table border="1"> <thead> <tr> <th>Number</th> <th>Description</th> <th>Opened</th> <th>Closed</th> <th>Amount</th> </tr> </thead> <tbody> <tr> <td>18 0705 X</td> <td>R20- NEW 2528 SQ FT SFR</td> <td>08/2018</td> <td>12/2019</td> <td>161,700</td> </tr> </tbody> </table>						Number	Description	Opened	Closed	Amount	18 0705 X	R20- NEW 2528 SQ FT SFR	08/2018	12/2019	161,700
Number	Description	Opened	Closed	Amount															
18 0705 X	R20- NEW 2528 SQ FT SFR	08/2018	12/2019	161,700															
TR DESC 2627-217 AS COMM NW/C SEC; S89.5934E 538'; S00.0026W 50' TO POB; S89.5934E 206.22'; S03.5849W 374.61'; S83.1728W 409 65'; N27.5206E 107.44'; N44.1731E 252.60'; N00.0026E 145.80' TO POB.																			
Exemptions				Sale History															
Code	Type	Active	Maximum	Exemption	Bk/Pg	Grantor	Date	Price	Code										
					2631/712	SMITH, WARREN STANLEY II & JULIE	04/21/2017	50,000	YES										
					2627/215	SMITH, WARREN STANLEY II & JULIE	04/17/2017	0	4										
Parcel Valuation																			
Source	REAL		Fair Cash	Capped	Asmnt Level	Assessed	Levy Rate	97.960	Current Tax										
Remove Cap	2018		Land Value	49,201	11%	5,412	Assessed	46,982	4,602.36										
Year Frozen			Improvements	398,436		41,570	Penalty	0											
Uncapped Value	0		Mobile Home	0		0	Exemption	0	0.00										
TIF Project ID	0		Total Value	447,637	427,107	46,982	Total Taxable	46,982	4,602.00										
Assessment History																			
Tax Year	Statement Number	Billed Owner		Tax Area	Total Value	Exemptions	Taxable Value	Billed Tax											
2025	2025-660100203	NEWMAN, ERIC S		40	406,769	0	44,744	4,383.00											
2024	2024-660100203	NEWMAN, ERIC S		40	431,613	0	44,366	4,262.00											
2023	2023-660100203	NEWMAN, ERIC S		40	384,123	0	42,253	3,960.00											
2022	2022-660100203	NEWMAN, ERIC S		40	385,027	0	40,668	3,984.00											
2021	2021-660100203	NEWMAN, ERIC S		40	352,099	0	38,731	3,747.00											
2020	2020-660100203	NEWMAN, ERIC S		40	346,561	0	37,478	3,625.00											
2019	2019-660100203	NEWMAN, ERIC S		40	51,840	0	5,702	552.00											
2018	2018-660100203	NEWMAN, ERIC S		40	51,840	0	5,702	532.00											
2017	2017-660100203	NEWMAN, ERIC S		40	683	0	75	7.00											



# Rogers

## Assessment Property Record Card for Tax Year 2026

Data provided by LISA DELOZIER County Assessor

Date 04/18/2026  
 Time 09:28:56  
 Page 2

Lot Data		Square-Foot - NBHD 6110 #1	
Lot Size			
Lot Count			
Units Buildable			
Non-Ag Acres	2.5983		
Topography			
Street Access			
Utilities			
Amenities	LAND QUALITY	0	0
Method	Square-Foot		
Base Lot Value	113,183.00 x .43 = 49,201		
Factor Value			
Adjustments	1.0000		
Lot Value	49,201		



\\tsclient\T\LOGAN\LOGAN RESIDENTIAL VI\2022-9-6\IMG\_0050. 9/7/2022

Residential Data	
Type	1 Single Family Residence
Condition	3 - Average
Quality	4 - Good
Architecture	
Style	100% 1 1/2 Story Finished
Exterior Wall	100% Frame, Siding, Wood
Base/Total Area	1,445 / 3,405
Style	100% 1 1/2 Story Finished
HVAC	100% Warmed & Cooled Air
Roof Cover	1 Composition Shingle
Area on Slab	1,445
Fixture/RghIn	14 /
Bed/F/H Bath	4 / 2.0 / 1.0
Basement Area	
Garage Type	
Remodel	
Year/Eff Age	2019 / 5

GRM Approach	
GRM Code	
Gross Rent	0.00
Indicated Value	

Multiple Regression			
MRA Code	1	Test	
Adusted R	0.8445		
Indicated Value	414,217	121.65	Per SqFt

Direct Comparables	
Selection Model	1 Res
Adjustment Model	A2 AO Test
Comparables	
Indicated Value	

Cost Approach				Manual : 01/2025			
Base Cost	89.40	Total Misc Impr	+ 13,591				
Roofing Adj	+ 2.64	Garage Cost	+ 0				
Subfloor Adj	+ -2.03	Total RCN	= 400,774				
Heat/Cool Adj	+ 16.31	Depreciation ( 5%)	- 20,039				
Plumbing Adj	+ 7.39	Lump Sums	+ 17,701				
Basement Adj	+ 0.00	RCNLD	= 398,436				
Adj Base Cost	= 113.71	Lot Value	+ 49,201				
Total Area	x 3,405	Indicated Value	= 447,637				
Adjusted Cost	= 387,183	Value Per SqFt	131.46				

Value Reconciliation			
Selected Approach	Cost Approach		
Improvements	398,436		
Lot Value	49,201		
Indicated Value	447,637	131.46	Per SqFt
Agland Value			
Site Improvements			
Total Value	447,637	131.46	Total Value Per SqFt

Miscellaneous Improvements								
Code	Description	Sketch ID	Size	Year	Units	Unit Cost	Depr	Value
PATO	SLAB PORCH - OPEN	144532	13x4		52	14.39		748
PRCH	SLAB PORCH - COVERED	144533	14x4		56	33.02		1,849
PATO	SLAB PORCH - OPEN	144534	13x4		52	14.39		748
BALW	BALCONY - WOOD	144535	13x4		52	35.19		1,830
BALW	BALCONY - WOOD	144536	451		451	35.19		15,871
CPDT	CARPORT - DETACHED	144537	36x20		720	14.23		10,246



# Rogers

## Assessment Property Record Card for Tax Year 2026

Data provided by LISA DELOZIER County Assessor

Date 04/18/2026

Time 09:28:56

Page 3

### Sketch Image

660100203

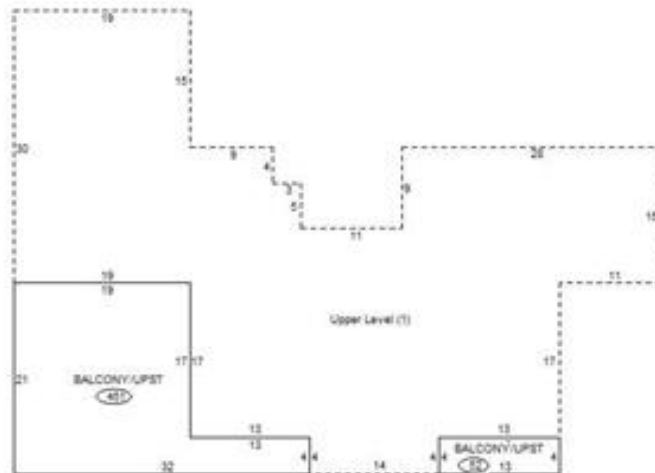
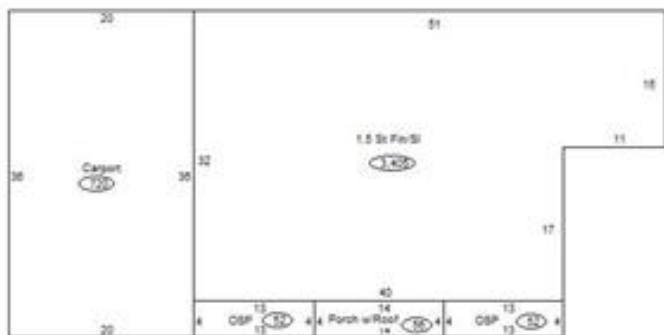

### Sketch Vector Information

Sequence	Code	Type	Built Over	Scale	Section Label	Base Area	Multiplier	Total Area
1	R	5	Slab	13	1.5 St Fin/Sl	1,445	2.356	3,405
2	U	^UL		13	Upper Level (1)	1,960	1.000	1,960
3	M	PATO		13	Open Slab	52	1.000	52
4	M	PRCH		13	SLBC	56	1.000	56
5	M	PATO		13	Open Slab	52	1.000	52
6	M	BALW		13	Balcony	52	1.000	52
7	M	BALW		13	Balcony	451	1.000	451
8	M	CPDT		13	Carport	720	1.000	720
<b>Total Building Area</b>						<b>1,445</b>		<b>3,405</b>