



Rogers

Assessment Property Record Card for Tax Year 2026

Data provided by LISA DELOZIER County Assessor

Date 04/18/2026
Time 09:29:43
Page 1

Assessment Data					Primary Image																																																																												
Account 660100253 Parcel ID 00000-00-0-000172-005-0005 Cadastral ID 35-23-14-01980 Property Type REAL - Real Property Property Class RRP VI Area 2 Tax Area 10 - OOLOGAH RURAL/NW FIRE Name ID 328001 ROSIERE, BRANDON & NATALIE 2871 CROSSCREEK DR OOLOGAH OK 74053-0000 Parcel Location Situs 02871 CROSSCREEK DR Subdivision CLEAR CREEK AT WOODSIDE PHASE IV Lot/Block 0005 / 0005 Parcel Size 1 - Lots Sec/Twn/Rng 35 / 23 / 14 / 5 Neighborhood 1021 - R-V02-NW OOLOGAH School District S004 - OOLOGAH SCHOOLS																																																																																	
Legal Description Lot/Long: 36.43223189 -95.77949056																																																																																	
Building Permits					<table border="1"> <thead> <tr> <th>Number</th> <th>Description</th> <th>Opened</th> <th>Closed</th> <th>Amount</th> </tr> </thead> <tbody> <tr> <td>P20 000061</td> <td>R22- NEW POOL</td> <td>10/2020</td> <td>07/2021</td> <td>40,500</td> </tr> <tr> <td>R19</td> <td>R19- NEW SFR PER MRTGE INFO</td> <td>04/2018</td> <td>12/2018</td> <td>278,800</td> </tr> </tbody> </table>					Number	Description	Opened	Closed	Amount	P20 000061	R22- NEW POOL	10/2020	07/2021	40,500	R19	R19- NEW SFR PER MRTGE INFO	04/2018	12/2018	278,800																																																									
Number	Description	Opened	Closed	Amount																																																																													
P20 000061	R22- NEW POOL	10/2020	07/2021	40,500																																																																													
R19	R19- NEW SFR PER MRTGE INFO	04/2018	12/2018	278,800																																																																													
Exemptions					Sale History																																																																												
<table border="1"> <thead> <tr> <th>Code</th> <th>Type</th> <th>Active</th> <th>Maximum</th> <th>Exemption</th> </tr> </thead> <tbody> <tr> <td>H</td> <td>Homestead</td> <td>Yes</td> <td>1,000</td> <td>1,000</td> </tr> </tbody> </table>					Code	Type	Active	Maximum	Exemption	H	Homestead	Yes	1,000	1,000	<table border="1"> <thead> <tr> <th>Bk/Pg</th> <th>Grantor</th> <th>Date</th> <th>Price</th> <th>Code</th> </tr> </thead> <tbody> <tr> <td>/</td> <td>ROD HENRY CONSTRUCTION INC</td> <td>06/24/2019</td> <td>315,000</td> <td>YES</td> </tr> <tr> <td>2701/670</td> <td>DOUBLE H PROPERTIES LLC</td> <td>03/30/2018</td> <td>43,000</td> <td>15</td> </tr> </tbody> </table>					Bk/Pg	Grantor	Date	Price	Code	/	ROD HENRY CONSTRUCTION INC	06/24/2019	315,000	YES	2701/670	DOUBLE H PROPERTIES LLC	03/30/2018	43,000	15																																															
Code	Type	Active	Maximum	Exemption																																																																													
H	Homestead	Yes	1,000	1,000																																																																													
Bk/Pg	Grantor	Date	Price	Code																																																																													
/	ROD HENRY CONSTRUCTION INC	06/24/2019	315,000	YES																																																																													
2701/670	DOUBLE H PROPERTIES LLC	03/30/2018	43,000	15																																																																													
Parcel Valuation																																																																																	
<table border="1"> <thead> <tr> <th>Source</th> <th>REAL</th> </tr> </thead> <tbody> <tr> <td>Remove Cap</td> <td>2020</td> </tr> <tr> <td>Year Frozen</td> <td></td> </tr> <tr> <td>Uncapped Value</td> <td>0</td> </tr> <tr> <td>TIF Project ID</td> <td>0</td> </tr> </tbody> </table>		Source	REAL	Remove Cap	2020	Year Frozen		Uncapped Value	0	TIF Project ID	0	<table border="1"> <thead> <tr> <th>Fair Cash</th> <th>Capped</th> <th>Asmnt Level</th> <th>Assessed</th> </tr> </thead> <tbody> <tr> <td>Land Value</td> <td>82,797</td> <td>52,291</td> <td>5,752</td> </tr> <tr> <td>Improvements</td> <td>331,173</td> <td>330,750</td> <td>36,383</td> </tr> <tr> <td>Mobile Home</td> <td>0</td> <td>0</td> <td>0</td> </tr> <tr> <td>Total Value</td> <td>413,970</td> <td>383,041</td> <td>42,135</td> </tr> </tbody> </table>			Fair Cash	Capped	Asmnt Level	Assessed	Land Value	82,797	52,291	5,752	Improvements	331,173	330,750	36,383	Mobile Home	0	0	0	Total Value	413,970	383,041	42,135	<table border="1"> <thead> <tr> <th>Levy Rate</th> <th>Current Tax</th> </tr> </thead> <tbody> <tr> <td>108.182</td> <td>4,558.23</td> </tr> <tr> <td>Assessed</td> <td>42,135</td> </tr> <tr> <td>Penalty</td> <td>0</td> </tr> <tr> <td>Exemption</td> <td>1,000</td> </tr> <tr> <td>Total Taxable</td> <td>41,135</td> </tr> </tbody> </table>		Levy Rate	Current Tax	108.182	4,558.23	Assessed	42,135	Penalty	0	Exemption	1,000	Total Taxable	41,135																																	
Source	REAL																																																																																
Remove Cap	2020																																																																																
Year Frozen																																																																																	
Uncapped Value	0																																																																																
TIF Project ID	0																																																																																
Fair Cash	Capped	Asmnt Level	Assessed																																																																														
Land Value	82,797	52,291	5,752																																																																														
Improvements	331,173	330,750	36,383																																																																														
Mobile Home	0	0	0																																																																														
Total Value	413,970	383,041	42,135																																																																														
Levy Rate	Current Tax																																																																																
108.182	4,558.23																																																																																
Assessed	42,135																																																																																
Penalty	0																																																																																
Exemption	1,000																																																																																
Total Taxable	41,135																																																																																
Assessment History																																																																																	
<table border="1"> <thead> <tr> <th>Tax Year</th> <th>Statement Number</th> <th>Billed Owner</th> <th>Tax Area</th> <th>Total Value</th> <th>Exemptions</th> <th>Taxable Value</th> <th>Billed Tax</th> </tr> </thead> <tbody> <tr> <td>2025</td> <td>2025-660100253</td> <td>ROSIERE, BRANDON & NATALIE</td> <td>10</td> <td>404,078</td> <td>1000</td> <td>39,907</td> <td>4,331.00</td> </tr> <tr> <td>2024</td> <td>2024-660100253</td> <td>ROSIERE, BRANDON & NATALIE</td> <td>10</td> <td>407,566</td> <td>1000</td> <td>38,716</td> <td>4,068.00</td> </tr> <tr> <td>2023</td> <td>2023-660100253</td> <td>ROSIERE, BRANDON & NATALIE</td> <td>10</td> <td>363,404</td> <td>1000</td> <td>37,559</td> <td>3,920.00</td> </tr> <tr> <td>2022</td> <td>2022-660100253</td> <td>ROSIERE, BRANDON & NATALIE</td> <td>10</td> <td>354,607</td> <td>1000</td> <td>36,436</td> <td>3,785.00</td> </tr> <tr> <td>2021</td> <td>2021-660100253</td> <td>ROSIERE, BRANDON & NATALIE</td> <td>10</td> <td>317,796</td> <td>1000</td> <td>33,958</td> <td>3,553.00</td> </tr> <tr> <td>2020</td> <td>2020-660100253</td> <td>ROSIERE, BRANDON & NATALIE</td> <td>10</td> <td>315,527</td> <td>0</td> <td>34,708</td> <td>3,672.00</td> </tr> <tr> <td>2019</td> <td>2019-660100253</td> <td>ROSIERE, BRANDON & NATALIE</td> <td>10</td> <td>153,476</td> <td>0</td> <td>16,882</td> <td>1,752.00</td> </tr> <tr> <td>2018</td> <td>2018-660100253</td> <td>ROD HENRY CONSTRUCTION INC</td> <td>10</td> <td>7,199</td> <td>0</td> <td>792</td> <td>85.00</td> </tr> </tbody> </table>										Tax Year	Statement Number	Billed Owner	Tax Area	Total Value	Exemptions	Taxable Value	Billed Tax	2025	2025-660100253	ROSIERE, BRANDON & NATALIE	10	404,078	1000	39,907	4,331.00	2024	2024-660100253	ROSIERE, BRANDON & NATALIE	10	407,566	1000	38,716	4,068.00	2023	2023-660100253	ROSIERE, BRANDON & NATALIE	10	363,404	1000	37,559	3,920.00	2022	2022-660100253	ROSIERE, BRANDON & NATALIE	10	354,607	1000	36,436	3,785.00	2021	2021-660100253	ROSIERE, BRANDON & NATALIE	10	317,796	1000	33,958	3,553.00	2020	2020-660100253	ROSIERE, BRANDON & NATALIE	10	315,527	0	34,708	3,672.00	2019	2019-660100253	ROSIERE, BRANDON & NATALIE	10	153,476	0	16,882	1,752.00	2018	2018-660100253	ROD HENRY CONSTRUCTION INC	10	7,199	0	792	85.00
Tax Year	Statement Number	Billed Owner	Tax Area	Total Value	Exemptions	Taxable Value	Billed Tax																																																																										
2025	2025-660100253	ROSIERE, BRANDON & NATALIE	10	404,078	1000	39,907	4,331.00																																																																										
2024	2024-660100253	ROSIERE, BRANDON & NATALIE	10	407,566	1000	38,716	4,068.00																																																																										
2023	2023-660100253	ROSIERE, BRANDON & NATALIE	10	363,404	1000	37,559	3,920.00																																																																										
2022	2022-660100253	ROSIERE, BRANDON & NATALIE	10	354,607	1000	36,436	3,785.00																																																																										
2021	2021-660100253	ROSIERE, BRANDON & NATALIE	10	317,796	1000	33,958	3,553.00																																																																										
2020	2020-660100253	ROSIERE, BRANDON & NATALIE	10	315,527	0	34,708	3,672.00																																																																										
2019	2019-660100253	ROSIERE, BRANDON & NATALIE	10	153,476	0	16,882	1,752.00																																																																										
2018	2018-660100253	ROD HENRY CONSTRUCTION INC	10	7,199	0	792	85.00																																																																										



Rogers

Assessment Property Record Card for Tax Year 2026

Data provided by LISA DELOZIER County Assessor

Date 04/18/2026
 Time 09:29:43
 Page 2

Lot Data		Square-Foot - NBHD 1021 #1	
Lot Size	0	0	
Lot Count	1		
Units Buildable			
Non-Ag Acres	1.2015		
Topography			
Street Access			
Utilities			
Amenities	LAND QUALITY		0
			0
Method	Square-Foot		
Base Lot Value	52,337.00 x 1.58 = 82,797		
Factor Value			
Adjustments	1.0000		
Lot Value	82,797		



660100253_004.JPG 6/17/2024

Residential Data

Type	1 Single Family Residence
Condition	3 - Average
Quality	3 - Average
Architecture	
Style	100% One Story
Exterior Wall	100% Veneer, Masonry
Base/Total Area	2,261 / 2,261
Style	100% One Story
HVAC	100% Warmed & Cooled Air
Roof Cover	1 Composition Shingle
Area on Slab	2,261
Fixture/RghIn	14 /
Bed/F/H Bath	4 / 2.0 / 1.0
Basement Area	
Garage Type	807 Attached Garage - Unfinished
Remodel	
Year/Eff Age	2018 / 6

GRM Approach

GRM Code	
Gross Rent	0.00
Indicated Value	

Multiple Regression

MRA Code	1 Test
Adusted R	0.8445
Indicated Value	335,966 148.59 Per SqFt

Direct Comparables

Selection Model	A Adam Test
Adjustment Model	1 2022 Residential
Comparables	
Indicated Value	

Cost Approach Manual : 01/2025

Base Cost	104.73	Total Misc Impr	+	16,993
Roofing Adj	+ 4.57	Garage Cost	+	24,041
Subfloor Adj	+ -2.19	Total RCN	=	331,301
Heat/Cool Adj	+ 12.64	Depreciation (6%)	-	19,878
Plumbing Adj	+ 8.63	Lump Sums	+	0
Basement Adj	+ 0.00	RCNLD	=	311,423
Adj Base Cost	= 128.38	Lot Value	+	82,797
Total Area	x 2,261	Indicated Value	=	394,220
Adjusted Cost	= 290,267	Value Per SqFt		174.36

Value Reconciliation

Selected Approach	Cost Approach
Improvements	311,423
Lot Value	82,797
Indicated Value	394,220 174.36 Per SqFt
Agland Value	
Site Improvements	19,750
Total Value	413,970 183.09 Total Value Per SqFt

Miscellaneous Improvements

Code	Description	Sketch ID	Size	Year	Units	Unit Cost	Depr	Value
FPR1	FIREPLACE - RESIDENTIAL 1 STORY	0		1	1	5,615.40		5,615
PRCH	SLAB PORCH - COVERED	139586		332	332	25.89		8,595
PRCH	SLAB PORCH - COVERED	139587		60	60	26.74		1,604
PRCH	SLAB PORCH - COVERED	139588		11x4	44	26.79		1,179



Rogers

Assessment Property Record Card for Tax Year 2026

Data provided by LISA DELOZIER County Assessor

Date 04/18/2026
 Time 09:29:43
 Page 3

Sketch Image

660100253

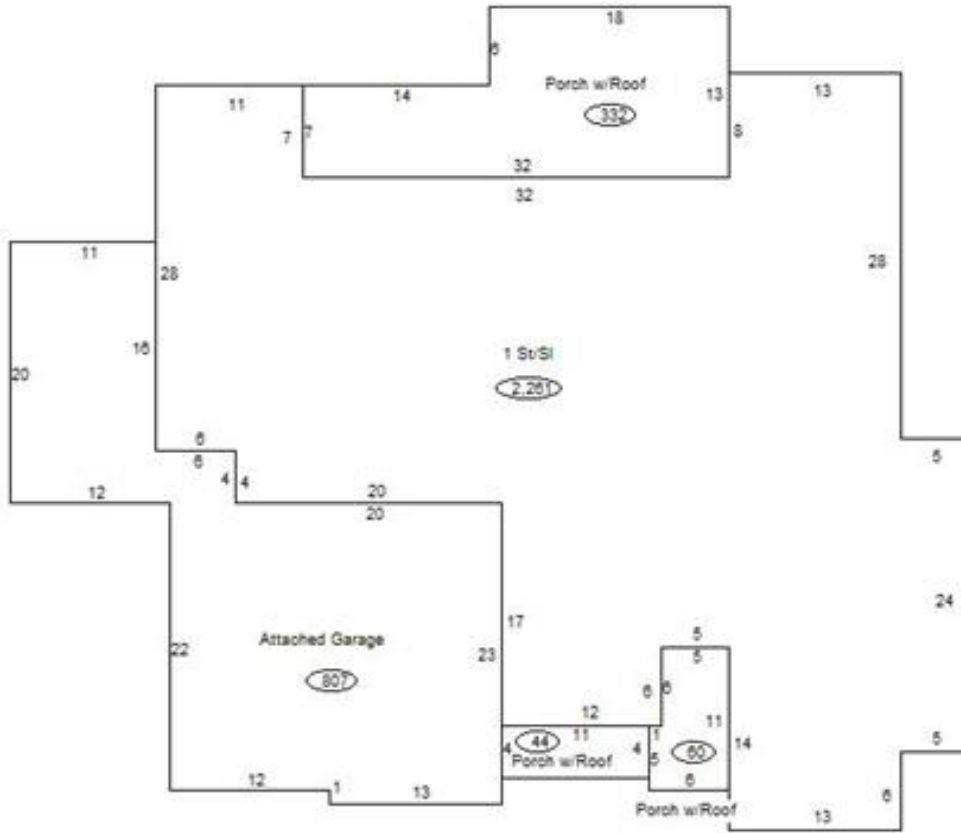

Sketch Vector Information

Sequence	Code	Type	Built Over	Scale	Section Label	Base Area	Multiplier	Total Area
1	R	1	Slab	13	1 St/Sl	2,261	1.000	2,261
2	G	1		13	Attached Garage	807	1.000	807
3	M	PRCH		13	SLBC	332	1.000	332
4	M	PRCH		13	SLBC	60	1.000	60
5	M	PRCH		13	SLBC	44	1.000	44
Total Building Area						2,261		2,261



Rogers

Assessment Property Record Card for Tax Year 2026

Data provided by LISA DELOZIER County Assessor

Date 04/18/2026
Time 09:29:43
Page 4

660100253

Outbuildings/Site Improvements

Building Image	Code	Description	Dimensions	Floor	Roofing	Total Units
	SV	SWIM VINYL	0x0x0			1
	Qual	3	Cond 3	Year 2021	Eff Age 4	
Valuation Summary		Modifier Total		RCN	Depr (21% Phys/ % Func)	RCNLD
Base Cost (25,000.00 x 1)		25,000		25,000	5,250	19,750