



# Rogers

## Assessment Property Record Card for Tax Year 2026

Data provided by LISA DELOZIER County Assessor

Date 04/18/2026  
Time 09:30:01  
Page 1

Assessment Data					Primary Image																																																																																				
<b>Account</b> 660100274 <b>Parcel ID</b> 22N16E-05-4-00000-000-0005 <b>Cadastral ID</b> 05-22-16-03801 <b>Property Type</b> REAL - Real Property <b>Property Class</b> RR VI Area 1 <b>Tax Area</b> 11 - SEQUOYAH/NW FIRE <b>Name ID</b> 333617 SILVA, GABRIELLE  13950 S 4150 RD CLAREMORE OK 74017-0000  <b>Parcel Location</b> <b>Situs</b> 13950 S 4150 RD <b>Subdivision</b> <b>Lot/Block</b> / <b>Parcel Size</b> 1.88 - Acres <b>Sec/Twn/Rng</b> 5 / 22 / 16 / 4 <b>Neighborhood</b> 6030 - UNPLATTED <b>School District</b> S006 - SEQUOYAH SCHOOLS																																																																																									
<b>Legal Description</b> Lat/Long: 36.40991563 -95.61579815 E 495' S2 N2 SE SE SE																																																																																									
<b>Exemptions</b> <table border="1"> <thead> <tr> <th>Code</th> <th>Type</th> <th>Active</th> <th>Maximum</th> <th>Exemption</th> </tr> </thead> <tbody> <tr> <td>H</td> <td>Homestead</td> <td>Yes</td> <td>1,000</td> <td>1,000</td> </tr> </tbody> </table>					Code	Type	Active	Maximum	Exemption	H	Homestead	Yes	1,000	1,000	<b>Building Permits</b> <table border="1"> <thead> <tr> <th>Number</th> <th>Description</th> <th>Opened</th> <th>Closed</th> <th>Amount</th> </tr> </thead> <tbody> <tr> <td></td> <td></td> <td></td> <td></td> <td></td> </tr> </tbody> </table>					Number	Description	Opened	Closed	Amount																																																																	
Code	Type	Active	Maximum	Exemption																																																																																					
H	Homestead	Yes	1,000	1,000																																																																																					
Number	Description	Opened	Closed	Amount																																																																																					
<b>Parcel Valuation</b> <table border="1"> <thead> <tr> <th>Source</th> <th>REAL</th> <th>Fair Cash</th> <th>Capped</th> <th>Asmnt Level</th> <th>Assessed</th> <th>Levy Rate</th> <th>102.332</th> <th>Current Tax</th> </tr> </thead> <tbody> <tr> <td>Remove Cap</td> <td>2022</td> <td>Land Value</td> <td>65,570</td> <td>43,280</td> <td>11%</td> <td>4,761</td> <td>Assessed</td> <td>24,641 2,521.55</td> </tr> <tr> <td>Year Frozen</td> <td></td> <td>Improvements</td> <td>190,004</td> <td>180,728</td> <td></td> <td>19,880</td> <td>Penalty</td> <td>0</td> </tr> <tr> <td>Uncapped Value</td> <td>0</td> <td>Mobile Home</td> <td>0</td> <td>0</td> <td></td> <td>0</td> <td>Exemption</td> <td>1,000 -89.00</td> </tr> <tr> <td>TIF Project ID</td> <td>0</td> <td>Total Value</td> <td>255,574</td> <td>224,008</td> <td></td> <td>24,641</td> <td>Total Taxable</td> <td>23,641 2,433.00</td> </tr> </tbody> </table>					Source	REAL	Fair Cash	Capped	Asmnt Level	Assessed	Levy Rate	102.332	Current Tax	Remove Cap	2022	Land Value	65,570	43,280	11%	4,761	Assessed	24,641 2,521.55	Year Frozen		Improvements	190,004	180,728		19,880	Penalty	0	Uncapped Value	0	Mobile Home	0	0		0	Exemption	1,000 -89.00	TIF Project ID	0	Total Value	255,574	224,008		24,641	Total Taxable	23,641 2,433.00	<b>Sale History</b> <table border="1"> <thead> <tr> <th>Bk/Pg</th> <th>Grantor</th> <th>Date</th> <th>Price</th> <th>Code</th> </tr> </thead> <tbody> <tr> <td>/</td> <td>WILLIAMS, CODIE</td> <td>02/19/2021</td> <td>205,000</td> <td>YES</td> </tr> <tr> <td>/</td> <td>WHITWELL, JOHN D</td> <td>07/11/2019</td> <td>177,000</td> <td>YES</td> </tr> <tr> <td>2618/405</td> <td>SEPTEMBER SIX LLC</td> <td>03/10/2017</td> <td>153,000</td> <td>YES</td> </tr> </tbody> </table>					Bk/Pg	Grantor	Date	Price	Code	/	WILLIAMS, CODIE	02/19/2021	205,000	YES	/	WHITWELL, JOHN D	07/11/2019	177,000	YES	2618/405	SEPTEMBER SIX LLC	03/10/2017	153,000	YES															
Source	REAL	Fair Cash	Capped	Asmnt Level	Assessed	Levy Rate	102.332	Current Tax																																																																																	
Remove Cap	2022	Land Value	65,570	43,280	11%	4,761	Assessed	24,641 2,521.55																																																																																	
Year Frozen		Improvements	190,004	180,728		19,880	Penalty	0																																																																																	
Uncapped Value	0	Mobile Home	0	0		0	Exemption	1,000 -89.00																																																																																	
TIF Project ID	0	Total Value	255,574	224,008		24,641	Total Taxable	23,641 2,433.00																																																																																	
Bk/Pg	Grantor	Date	Price	Code																																																																																					
/	WILLIAMS, CODIE	02/19/2021	205,000	YES																																																																																					
/	WHITWELL, JOHN D	07/11/2019	177,000	YES																																																																																					
2618/405	SEPTEMBER SIX LLC	03/10/2017	153,000	YES																																																																																					
<b>Assessment History</b> <table border="1"> <thead> <tr> <th>Tax Year</th> <th>Statement Number</th> <th>Billed Owner</th> <th>Tax Area</th> <th>Total Value</th> <th>Exemptions</th> <th>Taxable Value</th> <th>Billed Tax</th> </tr> </thead> <tbody> <tr> <td>2025</td> <td>2025-660100274</td> <td>SILVA, GABRIELLE</td> <td>11</td> <td>251,807</td> <td>1000</td> <td>22,923</td> <td>2,360.00</td> </tr> <tr> <td>2024</td> <td>2024-660100274</td> <td>SILVA, GABRIELLE</td> <td>11</td> <td>265,266</td> <td>1000</td> <td>22,226</td> <td>2,296.00</td> </tr> <tr> <td>2023</td> <td>2023-660100274</td> <td>SILVA, GABRIELLE</td> <td>11</td> <td>205,000</td> <td>1000</td> <td>21,550</td> <td>2,272.00</td> </tr> <tr> <td>2022</td> <td>2022-660100274</td> <td>SILVA, GABRIELLE</td> <td>11</td> <td>205,114</td> <td>1000</td> <td>21,562</td> <td>2,288.00</td> </tr> <tr> <td>2021</td> <td>2021-660100274</td> <td>SILVA, GABRIELLE</td> <td>11</td> <td>182,386</td> <td>0</td> <td>20,062</td> <td>2,042.00</td> </tr> <tr> <td>2020</td> <td>2020-660100274</td> <td>WILLIAMS, CODIE</td> <td>11</td> <td>175,604</td> <td>0</td> <td>19,317</td> <td>2,030.00</td> </tr> <tr> <td>2019</td> <td>2019-660100274</td> <td>WILLIAMS, CODIE</td> <td>11</td> <td>151,583</td> <td>0</td> <td>16,674</td> <td>1,728.00</td> </tr> <tr> <td>2018</td> <td>2018-660100274</td> <td>WHITWELL, JOHN D</td> <td>11</td> <td>155,479</td> <td>0</td> <td>17,103</td> <td>1,792.00</td> </tr> <tr> <td>2017</td> <td>2017-660100274</td> <td>WHITWELL, JOHN D</td> <td>11</td> <td>56,305</td> <td>0</td> <td>6,193</td> <td>634.00</td> </tr> </tbody> </table>										Tax Year	Statement Number	Billed Owner	Tax Area	Total Value	Exemptions	Taxable Value	Billed Tax	2025	2025-660100274	SILVA, GABRIELLE	11	251,807	1000	22,923	2,360.00	2024	2024-660100274	SILVA, GABRIELLE	11	265,266	1000	22,226	2,296.00	2023	2023-660100274	SILVA, GABRIELLE	11	205,000	1000	21,550	2,272.00	2022	2022-660100274	SILVA, GABRIELLE	11	205,114	1000	21,562	2,288.00	2021	2021-660100274	SILVA, GABRIELLE	11	182,386	0	20,062	2,042.00	2020	2020-660100274	WILLIAMS, CODIE	11	175,604	0	19,317	2,030.00	2019	2019-660100274	WILLIAMS, CODIE	11	151,583	0	16,674	1,728.00	2018	2018-660100274	WHITWELL, JOHN D	11	155,479	0	17,103	1,792.00	2017	2017-660100274	WHITWELL, JOHN D	11	56,305	0	6,193	634.00
Tax Year	Statement Number	Billed Owner	Tax Area	Total Value	Exemptions	Taxable Value	Billed Tax																																																																																		
2025	2025-660100274	SILVA, GABRIELLE	11	251,807	1000	22,923	2,360.00																																																																																		
2024	2024-660100274	SILVA, GABRIELLE	11	265,266	1000	22,226	2,296.00																																																																																		
2023	2023-660100274	SILVA, GABRIELLE	11	205,000	1000	21,550	2,272.00																																																																																		
2022	2022-660100274	SILVA, GABRIELLE	11	205,114	1000	21,562	2,288.00																																																																																		
2021	2021-660100274	SILVA, GABRIELLE	11	182,386	0	20,062	2,042.00																																																																																		
2020	2020-660100274	WILLIAMS, CODIE	11	175,604	0	19,317	2,030.00																																																																																		
2019	2019-660100274	WILLIAMS, CODIE	11	151,583	0	16,674	1,728.00																																																																																		
2018	2018-660100274	WHITWELL, JOHN D	11	155,479	0	17,103	1,792.00																																																																																		
2017	2017-660100274	WHITWELL, JOHN D	11	56,305	0	6,193	634.00																																																																																		



# Rogers

## Assessment Property Record Card for Tax Year 2026

Data provided by LISA DELOZIER County Assessor

Date 04/18/2026  
Time 09:30:01  
Page 2

Lot Data		Square-Foot - UNPLATTED (ACRES)		Primary Image				
Lot Size								
Lot Count								
Units Buildable								
Non-Ag Acres	1.8823							
Topography								
Street Access								
Utilities								
Amenities	LAND QUALITY		0					
			0					
Method	Square-Foot							
Base Lot Value	81,995.00 x .80 = 65,570							
Factor Value								
Adjustments	1.0000							
Lot Value	65,570							
<b>Residential Data</b>				\\tsclient\T\LOGAN\LOGAN RESIDENTIAL VI\2022-11-2\IMG_001! 11/2/2022				
Type	1 Single Family Residence			<b>GRM Approach</b>				
Condition	3 - Average			GRM Code				
Quality	2.5 - Fair			Gross Rent 0.00				
Architecture				Indicated Value				
Style	100% One Story			<b>Multiple Regression</b>				
Exterior Wall	100% Veneer, Masonry			MRA Code 1 Test				
Base/Total Area	1,459 / 1,459			Adusted R 0.8445				
Style	100% One Story			Indicated Value 201,463 138.08 Per SqFt				
HVAC	100% Warmed & Cooled Air			<b>Direct Comparables</b>				
Roof Cover	1 Composition Shingle			Selection Model 1 Res				
Area on Slab	1,459			Adjustment Model A2 AO Test				
Fixture/RghIn	11 /			Comparables				
Bed/F/H Bath	3 / 2.0 /			Indicated Value				
Basement Area				<b>Value Reconciliation</b>				
Garage Type	432 Attached Garage - Unfinished			Selected Approach Cost Approach				
Remodel				Improvements 190,004				
Year/Eff Age	2016 / 8			Lot Value 65,570				
<b>Cost Approach</b>		<b>Manual : 01/2025</b>						
Base Cost	107.69	Total Misc Impr	+	3,597				
Roofing Adj	+ 4.55	Garage Cost	+	12,334				
Subfloor Adj	+ -1.18	Total RCN	=	208,796				
Heat/Cool Adj	+ 11.47	Depreciation ( 9%)	-	18,792				
Plumbing Adj	+ 9.66	Lump Sums	+	0				
Basement Adj	+ 0.00	RCNLD	=	190,004				
Adj Base Cost	= 132.19	Lot Value	+	65,570				
Total Area	x 1,459	Indicated Value	=	255,574				
Adjusted Cost	= 192,865	Value Per SqFt		175.17				
<b>Miscellaneous Improvements</b>								
Code	Description	Sketch ID	Size	Year	Units	Unit Cost	Depr	Value
PRCH	SLAB PORCH - COVERED	130620	12x9		108	23.92		2,583
PRCH	SLAB PORCH - COVERED	130621	7x6		42	24.14		1,014



# Rogers

## Assessment Property Record Card for Tax Year 2026

Data provided by LISA DELOZIER County Assessor

Date 04/18/2026

Time 09:30:01

Page 3

Sketch Image

660100274

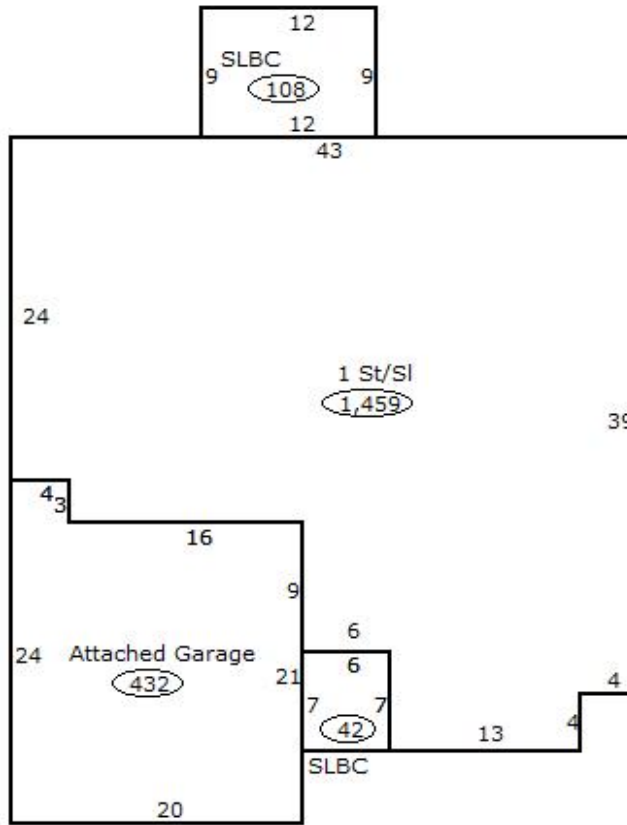

### Sketch Vector Information

Sequence	Code	Type	Built Over	Scale	Section Label	Base Area	Multiplier	Total Area
1	R	1	Slab	13	1 St/Sl	1,459	1.000	1,459
2	G	1		13	Attached Garage	432	1.000	432
3	M	PRCH		13	SLBC	108	1.000	108
4	M	PRCH		13	SLBC	42	1.000	42
<b>Total Building Area</b>						1,459		1,459