



Rogers

Assessment Property Record Card for Tax Year 2026

Data provided by LISA DELOZIER County Assessor

Date 04/18/2026
Time 09:31:38
Page 1

Assessment Data					Primary Image																																																																																				
Account 660100383 Parcel ID 23N17E-30-2-00000-000-0003 Cadastral ID 30-23-17-02614 Property Type REAL - Real Property Property Class RA VI Area 2 Tax Area 70 - FOYIL RURAL/FOYIL FIRE Name ID 321905 ARNETTE, BRANDON & VICTORIA 16122 E 390 RD CLAREMORE OK 74017-0000 Parcel Location Situs 16122 E 390 RD Subdivision Lot/Block / Parcel Size 1.36 - Acres Sec/Twn/Rng 30 / 23 / 17 / 2 Neighborhood 4070 - FOYIL SEQUOYAH AREA School District S007 - FOYIL SCHOOLS																																																																																									
Legal Description Lat/Long: 36.45212728 -95.53997158																																																																																									
TR DESC AS COMM NW/C NW NW; N88.5156E 808.47' TO POB; N88 5156E 311'; S01.0804E 190'; S88.5156W 311'; N01.0804W 190' TO POB.					Building Permits <table border="1"> <thead> <tr> <th>Number</th> <th>Description</th> <th>Opened</th> <th>Closed</th> <th>Amount</th> </tr> </thead> <tbody> <tr> <td> </td> <td> </td> <td> </td> <td> </td> <td> </td> </tr> </tbody> </table>					Number	Description	Opened	Closed	Amount																																																																											
Number	Description	Opened	Closed	Amount																																																																																					
Exemptions <table border="1"> <thead> <tr> <th>Code</th> <th>Type</th> <th>Active</th> <th>Maximum</th> <th>Exemption</th> </tr> </thead> <tbody> <tr> <td>H</td> <td>Homestead</td> <td>Yes</td> <td>1,000</td> <td>1,000</td> </tr> </tbody> </table>					Code	Type	Active	Maximum	Exemption	H	Homestead	Yes	1,000	1,000	Sale History <table border="1"> <thead> <tr> <th>Bk/Pg</th> <th>Grantor</th> <th>Date</th> <th>Price</th> <th>Code</th> </tr> </thead> <tbody> <tr> <td>2638/785</td> <td>ARNETTE, JEFFREY M & VIRGINIA K</td> <td>06/07/2017</td> <td>0</td> <td>4</td> </tr> </tbody> </table>					Bk/Pg	Grantor	Date	Price	Code	2638/785	ARNETTE, JEFFREY M & VIRGINIA K	06/07/2017	0	4																																																												
Code	Type	Active	Maximum	Exemption																																																																																					
H	Homestead	Yes	1,000	1,000																																																																																					
Bk/Pg	Grantor	Date	Price	Code																																																																																					
2638/785	ARNETTE, JEFFREY M & VIRGINIA K	06/07/2017	0	4																																																																																					
Parcel Valuation <table border="1"> <thead> <tr> <th>Source</th> <th>REAL</th> <th>Fair Cash</th> <th>Capped</th> <th>Asmnt Level</th> <th>Assessed</th> <th>Levy Rate</th> <th>101.660</th> <th>Current Tax</th> </tr> </thead> <tbody> <tr> <td>Remove Cap</td> <td>0</td> <td>Land Value 166</td> <td>84</td> <td>11%</td> <td>9</td> <td>Assessed</td> <td>12,762</td> <td>1,297.38</td> </tr> <tr> <td>Year Frozen</td> <td> </td> <td>Improvements 134,766</td> <td>115,940</td> <td> </td> <td>12,753</td> <td>Penalty</td> <td>0</td> <td> </td> </tr> <tr> <td>Uncapped Value</td> <td>0</td> <td>Mobile Home 0</td> <td>0</td> <td> </td> <td>0</td> <td>Exemption</td> <td>1,000</td> <td>-88.00</td> </tr> <tr> <td>TIF Project ID</td> <td>0</td> <td>Total Value 134,932</td> <td>116,024</td> <td> </td> <td>12,762</td> <td>Total Taxable</td> <td>11,762</td> <td>1,209.00</td> </tr> </tbody> </table>										Source	REAL	Fair Cash	Capped	Asmnt Level	Assessed	Levy Rate	101.660	Current Tax	Remove Cap	0	Land Value 166	84	11%	9	Assessed	12,762	1,297.38	Year Frozen		Improvements 134,766	115,940		12,753	Penalty	0		Uncapped Value	0	Mobile Home 0	0		0	Exemption	1,000	-88.00	TIF Project ID	0	Total Value 134,932	116,024		12,762	Total Taxable	11,762	1,209.00																																			
Source	REAL	Fair Cash	Capped	Asmnt Level	Assessed	Levy Rate	101.660	Current Tax																																																																																	
Remove Cap	0	Land Value 166	84	11%	9	Assessed	12,762	1,297.38																																																																																	
Year Frozen		Improvements 134,766	115,940		12,753	Penalty	0																																																																																		
Uncapped Value	0	Mobile Home 0	0		0	Exemption	1,000	-88.00																																																																																	
TIF Project ID	0	Total Value 134,932	116,024		12,762	Total Taxable	11,762	1,209.00																																																																																	
Assessment History <table border="1"> <thead> <tr> <th>Tax Year</th> <th>Statement Number</th> <th>Billed Owner</th> <th>Tax Area</th> <th>Total Value</th> <th>Exemptions</th> <th>Taxable Value</th> <th>Billed Tax</th> </tr> </thead> <tbody> <tr> <td>2025</td> <td>2025-660100383</td> <td>ARNETTE, BRANDON & VICTORIA</td> <td>70</td> <td>142,167</td> <td>1000</td> <td>11,391</td> <td>1,171.00</td> </tr> <tr> <td>2024</td> <td>2024-660100383</td> <td>ARNETTE, BRANDON & VICTORIA</td> <td>70</td> <td>70,919</td> <td>0</td> <td>5,897</td> <td>615.00</td> </tr> <tr> <td>2023</td> <td>2023-660100383</td> <td>ARNETTE, BRANDON & VICTORIA</td> <td>70</td> <td>58,146</td> <td>0</td> <td>5,725</td> <td>597.00</td> </tr> <tr> <td>2022</td> <td>2022-660100383</td> <td>ARNETTE, BRANDON & VICTORIA</td> <td>70</td> <td>58,992</td> <td>0</td> <td>5,558</td> <td>582.00</td> </tr> <tr> <td>2021</td> <td>2021-660100383</td> <td>ARNETTE, BRANDON & VICTORIA</td> <td>70</td> <td>56,111</td> <td>0</td> <td>5,396</td> <td>549.00</td> </tr> <tr> <td>2020</td> <td>2020-660100383</td> <td>ARNETTE, BRANDON & VICTORIA</td> <td>70</td> <td>51,586</td> <td>0</td> <td>5,239</td> <td>555.00</td> </tr> <tr> <td>2019</td> <td>2019-660100383</td> <td>ARNETTE, BRANDON & VICTORIA</td> <td>70</td> <td>46,243</td> <td>0</td> <td>5,086</td> <td>540.00</td> </tr> <tr> <td>2018</td> <td>2018-660100383</td> <td>ARNETTE, BRANDON & VICTORIA</td> <td>70</td> <td>54,416</td> <td>0</td> <td>5,985</td> <td>624.00</td> </tr> <tr> <td>2017</td> <td>2017-660100383</td> <td>ARNETTE, BRANDON & VICTORIA</td> <td>70</td> <td>53,893</td> <td>0</td> <td>5,928</td> <td>620.00</td> </tr> </tbody> </table>										Tax Year	Statement Number	Billed Owner	Tax Area	Total Value	Exemptions	Taxable Value	Billed Tax	2025	2025-660100383	ARNETTE, BRANDON & VICTORIA	70	142,167	1000	11,391	1,171.00	2024	2024-660100383	ARNETTE, BRANDON & VICTORIA	70	70,919	0	5,897	615.00	2023	2023-660100383	ARNETTE, BRANDON & VICTORIA	70	58,146	0	5,725	597.00	2022	2022-660100383	ARNETTE, BRANDON & VICTORIA	70	58,992	0	5,558	582.00	2021	2021-660100383	ARNETTE, BRANDON & VICTORIA	70	56,111	0	5,396	549.00	2020	2020-660100383	ARNETTE, BRANDON & VICTORIA	70	51,586	0	5,239	555.00	2019	2019-660100383	ARNETTE, BRANDON & VICTORIA	70	46,243	0	5,086	540.00	2018	2018-660100383	ARNETTE, BRANDON & VICTORIA	70	54,416	0	5,985	624.00	2017	2017-660100383	ARNETTE, BRANDON & VICTORIA	70	53,893	0	5,928	620.00
Tax Year	Statement Number	Billed Owner	Tax Area	Total Value	Exemptions	Taxable Value	Billed Tax																																																																																		
2025	2025-660100383	ARNETTE, BRANDON & VICTORIA	70	142,167	1000	11,391	1,171.00																																																																																		
2024	2024-660100383	ARNETTE, BRANDON & VICTORIA	70	70,919	0	5,897	615.00																																																																																		
2023	2023-660100383	ARNETTE, BRANDON & VICTORIA	70	58,146	0	5,725	597.00																																																																																		
2022	2022-660100383	ARNETTE, BRANDON & VICTORIA	70	58,992	0	5,558	582.00																																																																																		
2021	2021-660100383	ARNETTE, BRANDON & VICTORIA	70	56,111	0	5,396	549.00																																																																																		
2020	2020-660100383	ARNETTE, BRANDON & VICTORIA	70	51,586	0	5,239	555.00																																																																																		
2019	2019-660100383	ARNETTE, BRANDON & VICTORIA	70	46,243	0	5,086	540.00																																																																																		
2018	2018-660100383	ARNETTE, BRANDON & VICTORIA	70	54,416	0	5,985	624.00																																																																																		
2017	2017-660100383	ARNETTE, BRANDON & VICTORIA	70	53,893	0	5,928	620.00																																																																																		



Rogers

Assessment Property Record Card for Tax Year 2026

Data provided by LISA DELOZIER County Assessor

Date 04/18/2026

Time 09:31:38

Page 3

Sketch Image

660100383

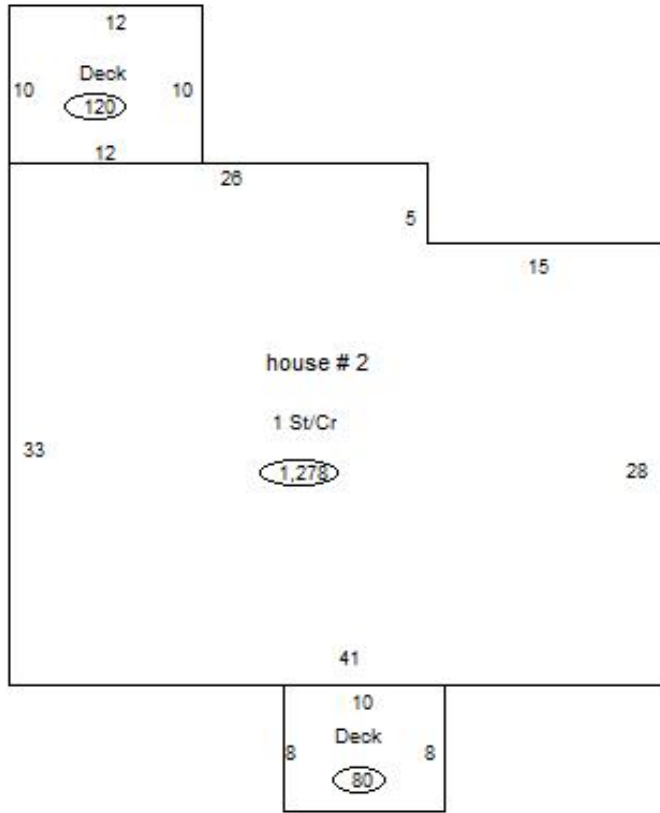

Sketch Vector Information

Sequence	Code	Type	Built Over	Scale	Section Label	Base Area	Multiplier	Total Area
1	R	1	Crawl	13	1 St/Cr	1,278	1.000	1,278
2	N	0		13	house # 2		0.000	
3	M	WODO		13	WODO	80	1.000	80
4	M	WODO		13	WODO	120	1.000	120
Total Building Area						1,278		1,278



Rogers

Assessment Property Record Card for Tax Year 2026

Data provided by LISA DELOZIER County Assessor

Date 04/18/2026
Time 09:31:38
Page 4

660100383

Outbuildings/Site Improvements

Building Image	Code	Description	Dimensions	Floor	Roofing	Total Units
	UTIL	Utility Building	60x40x10	Concrete	Formed Metal	2,400
	Qual 3	Cond 3	Year 2021	Eff Age 4		

Valuation Summary	Modifier Total	RCN	Depr (7% Phys/ % Func)	RCNLD	
Base Cost (26.21 x 2,400)	62,904		62,904	4,403	58,501



SHDS	Shed - Small	8x8x6	Plank	Composition Shingle	64
Qual 3	Cond 2	Year 2000	Eff Age 26		

Valuation Summary	Modifier Total	RCN	Depr (70% Phys/ 100% Func)	RCNLD
Base Cost (32.15 x 64)	2,058		2,058	2,058



Rogers

Assessment Property Record Card for Tax Year 2026

Data provided by LISA DELOZIER County Assessor

Date 04/18/2026
Time 09:31:38
Page 5

Agland Inventory

660100383

Soi	Description	Land Use	LPI	Adj Type	Adj Code	Acres	Use/Acre	Mkt/Acre	Use Value	Market Value
BC	BATES-COLLINSVILLE COMPLE	NTV PST	51			1.360	122	122	166	166
NTV PST Totals						1.360			166	166
Total Agland						1.360			166	166