



Rogers

Assessment Property Record Card for Tax Year 2026

Data provided by LISA DELOZIER County Assessor

Date 04/18/2026
Time 09:38:55
Page 1

Assessment Data					Primary Image																																																																				
Account 660101264 Parcel ID 000000000-1010196-001-0001 Cadastral ID 27-21-14-05000 Property Type REAL - Real Property Property Class RRP VI Area 4 Tax Area 3 - OWASSO RURAL/NO FIRE Name ID 336456 MORRIS, WESLEY DEAN & DONNELLA SUE 8515 N 154TH E AVE OWASSO OK 74055-0000 Parcel Location Situs 08515 N 154TH E AVE Subdivision HOMESTEAD Lot/Block 0001 / 0001 Parcel Size 1 - Lots Sec/Twn/Rng 27 / 21 / 14 / 5 Neighborhood 1011 - R-V04 SW OWASSO School District S021 - OWASSO SCHOOLS																																																																									
Legal Description Lot/Long: 36.27817542 -95.80127021																																																																									
Building Permits					<table border="1"> <thead> <tr> <th>Number</th> <th>Description</th> <th>Opened</th> <th>Closed</th> <th>Amount</th> </tr> </thead> <tbody> <tr> <td>R21</td> <td>R22- POSS NEW SFR</td> <td>03/2021</td> <td>01/2022</td> <td>316,507</td> </tr> </tbody> </table>					Number	Description	Opened	Closed	Amount	R21	R22- POSS NEW SFR	03/2021	01/2022	316,507																																																						
Number	Description	Opened	Closed	Amount																																																																					
R21	R22- POSS NEW SFR	03/2021	01/2022	316,507																																																																					
Exemptions					Sale History																																																																				
<table border="1"> <thead> <tr> <th>Code</th> <th>Type</th> <th>Active</th> <th>Maximum</th> <th>Exemption</th> </tr> </thead> <tbody> <tr> <td>H</td> <td>Homestead</td> <td>Yes</td> <td>1,000</td> <td>1,000</td> </tr> </tbody> </table>					Code	Type	Active	Maximum	Exemption	H	Homestead	Yes	1,000	1,000	<table border="1"> <thead> <tr> <th>Bk/Pg</th> <th>Grantor</th> <th>Date</th> <th>Price</th> <th>Code</th> </tr> </thead> <tbody> <tr> <td>/</td> <td>DENHAM HOMES LLC</td> <td>10/13/2021</td> <td>414,000</td> <td>YES</td> </tr> <tr> <td>/</td> <td>SOC'S DEVELOPMENT LLC</td> <td>01/28/2021</td> <td>68,000</td> <td>15</td> </tr> </tbody> </table>					Bk/Pg	Grantor	Date	Price	Code	/	DENHAM HOMES LLC	10/13/2021	414,000	YES	/	SOC'S DEVELOPMENT LLC	01/28/2021	68,000	15																																							
Code	Type	Active	Maximum	Exemption																																																																					
H	Homestead	Yes	1,000	1,000																																																																					
Bk/Pg	Grantor	Date	Price	Code																																																																					
/	DENHAM HOMES LLC	10/13/2021	414,000	YES																																																																					
/	SOC'S DEVELOPMENT LLC	01/28/2021	68,000	15																																																																					
Parcel Valuation																																																																									
<table border="1"> <thead> <tr> <th>Source</th> <th>REAL</th> </tr> </thead> <tbody> <tr> <td>Remove Cap</td> <td>2022</td> </tr> </tbody> </table>		Source	REAL	Remove Cap	2022	<table border="1"> <thead> <tr> <th>Fair Cash</th> <th>Capped</th> <th>Asmnt Level</th> <th>Assessed</th> </tr> </thead> <tbody> <tr> <td>Land Value</td> <td>77,450</td> <td>76,818</td> <td>11%</td> <td>8,450</td> </tr> <tr> <td>Improvements</td> <td>458,885</td> <td>375,570</td> <td></td> <td>41,313</td> </tr> <tr> <td>Mobile Home</td> <td>0</td> <td>0</td> <td></td> <td>0</td> </tr> <tr> <td>Total Value</td> <td>536,335</td> <td>452,388</td> <td></td> <td>49,763</td> </tr> </tbody> </table>			Fair Cash	Capped	Asmnt Level	Assessed	Land Value	77,450	76,818	11%	8,450	Improvements	458,885	375,570		41,313	Mobile Home	0	0		0	Total Value	536,335	452,388		49,763	<table border="1"> <thead> <tr> <th>Levy Rate</th> <th>Current Tax</th> </tr> </thead> <tbody> <tr> <td>97.960</td> <td>4,874.78</td> </tr> <tr> <td>Assessed</td> <td>49,763</td> </tr> <tr> <td>Penalty</td> <td>0</td> </tr> <tr> <td>Exemption</td> <td>1,000</td> </tr> <tr> <td>Total Taxable</td> <td>48,763</td> </tr> </tbody> </table>		Levy Rate	Current Tax	97.960	4,874.78	Assessed	49,763	Penalty	0	Exemption	1,000	Total Taxable	48,763																											
Source	REAL																																																																								
Remove Cap	2022																																																																								
Fair Cash	Capped	Asmnt Level	Assessed																																																																						
Land Value	77,450	76,818	11%	8,450																																																																					
Improvements	458,885	375,570		41,313																																																																					
Mobile Home	0	0		0																																																																					
Total Value	536,335	452,388		49,763																																																																					
Levy Rate	Current Tax																																																																								
97.960	4,874.78																																																																								
Assessed	49,763																																																																								
Penalty	0																																																																								
Exemption	1,000																																																																								
Total Taxable	48,763																																																																								
Assessment History																																																																									
<table border="1"> <thead> <tr> <th>Tax Year</th> <th>Statement Number</th> <th>Billed Owner</th> <th>Tax Area</th> <th>Total Value</th> <th>Exemptions</th> <th>Taxable Value</th> <th>Billed Tax</th> </tr> </thead> <tbody> <tr> <td>2025</td> <td>2025-660101264</td> <td>MORRIS, WESLEY DEAN &</td> <td>3</td> <td>518,856</td> <td>1000</td> <td>47,313</td> <td>4,635.00</td> </tr> <tr> <td>2024</td> <td>2024-660101264</td> <td>MORRIS, WESLEY DEAN &</td> <td>3</td> <td>618,190</td> <td>1000</td> <td>45,906</td> <td>4,410.00</td> </tr> <tr> <td>2023</td> <td>2023-660101264</td> <td>MORRIS, WESLEY DEAN &</td> <td>3</td> <td>414,000</td> <td>1000</td> <td>44,540</td> <td>4,174.00</td> </tr> <tr> <td>2022</td> <td>2022-660101264</td> <td>MORRIS, WESLEY DEAN &</td> <td>3</td> <td>414,000</td> <td>1000</td> <td>44,540</td> <td>4,364.00</td> </tr> <tr> <td>2021</td> <td>2021-660101264</td> <td>DENHAM HOMES LLC</td> <td>3</td> <td>863</td> <td>0</td> <td>95</td> <td>9.00</td> </tr> <tr> <td>2020</td> <td>2020-660101264</td> <td>SOC'S DEVELOPMENT LLC</td> <td>3</td> <td>863</td> <td>0</td> <td>95</td> <td>9.00</td> </tr> <tr> <td>2019</td> <td>2019-660101264</td> <td>SOC'S DEVELOPMENT LLC</td> <td>3</td> <td>863</td> <td>0</td> <td>95</td> <td>9.00</td> </tr> </tbody> </table>										Tax Year	Statement Number	Billed Owner	Tax Area	Total Value	Exemptions	Taxable Value	Billed Tax	2025	2025-660101264	MORRIS, WESLEY DEAN &	3	518,856	1000	47,313	4,635.00	2024	2024-660101264	MORRIS, WESLEY DEAN &	3	618,190	1000	45,906	4,410.00	2023	2023-660101264	MORRIS, WESLEY DEAN &	3	414,000	1000	44,540	4,174.00	2022	2022-660101264	MORRIS, WESLEY DEAN &	3	414,000	1000	44,540	4,364.00	2021	2021-660101264	DENHAM HOMES LLC	3	863	0	95	9.00	2020	2020-660101264	SOC'S DEVELOPMENT LLC	3	863	0	95	9.00	2019	2019-660101264	SOC'S DEVELOPMENT LLC	3	863	0	95	9.00
Tax Year	Statement Number	Billed Owner	Tax Area	Total Value	Exemptions	Taxable Value	Billed Tax																																																																		
2025	2025-660101264	MORRIS, WESLEY DEAN &	3	518,856	1000	47,313	4,635.00																																																																		
2024	2024-660101264	MORRIS, WESLEY DEAN &	3	618,190	1000	45,906	4,410.00																																																																		
2023	2023-660101264	MORRIS, WESLEY DEAN &	3	414,000	1000	44,540	4,174.00																																																																		
2022	2022-660101264	MORRIS, WESLEY DEAN &	3	414,000	1000	44,540	4,364.00																																																																		
2021	2021-660101264	DENHAM HOMES LLC	3	863	0	95	9.00																																																																		
2020	2020-660101264	SOC'S DEVELOPMENT LLC	3	863	0	95	9.00																																																																		
2019	2019-660101264	SOC'S DEVELOPMENT LLC	3	863	0	95	9.00																																																																		



Rogers

Assessment Property Record Card for Tax Year 2026

Data provided by LISA DELOZIER County Assessor

Date 04/18/2026
Time 09:38:55
Page 2

Lot Data		Square-Foot - NBHD 1011 #1	
Lot Size	0	0	
Lot Count	1		
Units Buildable			
Non-Ag Acres	0.6585		
Topography			
Street Access			
Utilities			
Amenities	LAND QUALITY		0
			0
Method	Square-Foot		
Base Lot Value	28,685.00 x 2.70 = 77,450		
Factor Value			
Adjustments	1.0000		
Lot Value	77,450		



\\tsclient\TCASEY\CASEY BOOTH RESIDENTIAL VI\2022-7-26\ 7/26/2022

Residential Data	
Type	1 Single Family Residence
Condition	3 - Average
Quality	4 - Good
Architecture	
Style	100% One Story
Exterior Wall	100% Veneer, Masonry
Base/Total Area	2,815 / 2,815
Style	100% One Story
HVAC	100% Warmed & Cooled Air
Roof Cover	1 Composition Shingle
Area on Slab	2,815
Fixture/RghIn	/
Bed/F/H Bath	4 / 3.0 /
Basement Area	
Garage Type	1,207 Attached Garage - Finished
Remodel	
Year/Eff Age	2021 / 4

GRM Approach	
GRM Code	
Gross Rent	0.00
Indicated Value	

Multiple Regression			
MRA Code	1	Test	
Adjusted R	0.8445		
Indicated Value	469,451	166.77	Per SqFt

Direct Comparables			
Selection Model	A	Adam Test	
Adjustment Model	1	2022 Residential	
Comparables	8		
Indicated Value	565,600		Per SqFt

Cost Approach		Manual : 01/2025	
Base Cost	110.28	Total Misc Impr	+ 29,206
Roofing Adj	+ 5.70	Garage Cost	+ 68,690
Subfloor Adj	+ -4.37	Total RCN	= 478,005
Heat/Cool Adj	+ 16.31	Depreciation (4%)	- 19,120
Plumbing Adj	+ 7.11	Lump Sums	+ 0
Basement Adj	+ 0.00	RCNLD	= 458,885
Adj Base Cost	= 135.03	Lot Value	+ 77,450
Total Area	x 2,815	Indicated Value	= 536,335
Adjusted Cost	= 380,109	Value Per SqFt	190.53

Value Reconciliation			
Selected Approach	Cost Approach		
Improvements	458,885		
Lot Value	77,450		
Indicated Value	536,335	190.53	Per SqFt
Agland Value			
Site Improvements			
Total Value	536,335	190.53	Total Value Per SqFt

Miscellaneous Improvements								
Code	Description	Sketch ID	Size	Year	Units	Unit Cost	Depr	Value
PRCH	Slab Porch - Covered	153017	137		137	32.65		4,473
PRCH	Slab Porch - Covered	153018	562		562	31.12		17,489
FPR1	Fireplace - Residential 1 Story			1	1	7,243.87		7,244



Rogers
Assessment Property Record Card for Tax Year 2026

Data provided by LISA DELOZIER County Assessor

Date 04/18/2026
 Time 09:38:55
 Page 3

Sketch Image

660101264

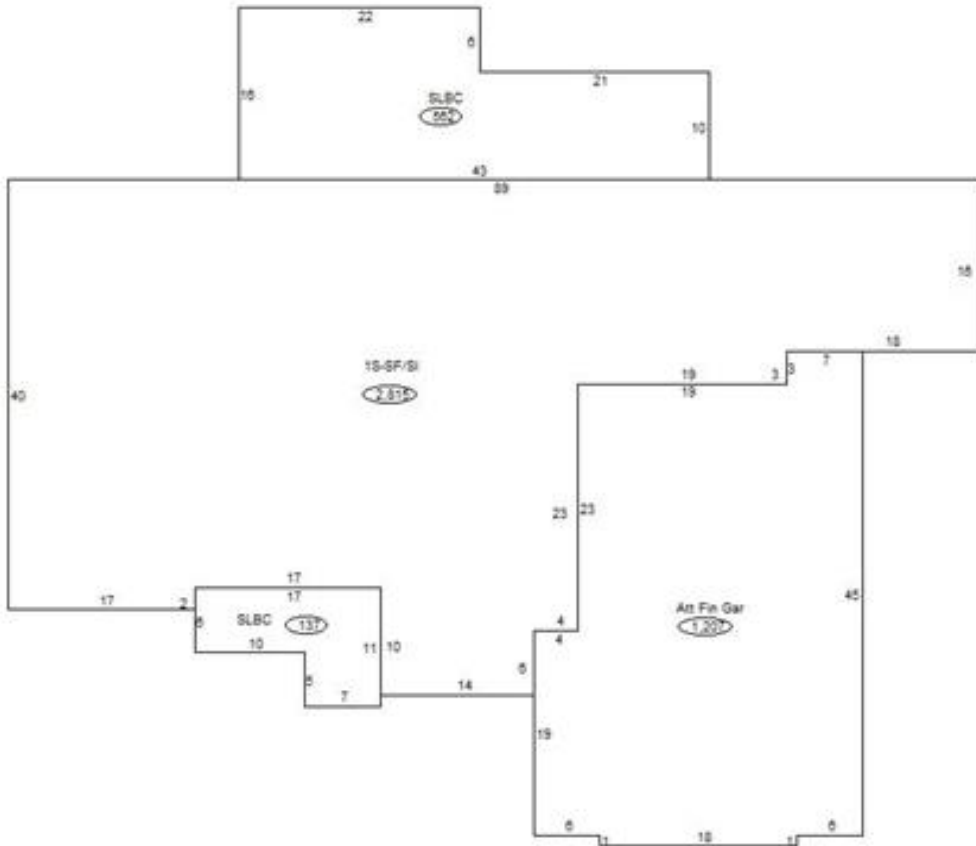

Sketch Vector Information

Sequence	Code	Type	Built Over	Scale	Section Label	Base Area	Multiplier	Total Area
1	R	1	Slab	13	1S-SF/SI	2,815	1.000	2,815
2	G	5		13	Att Fin Gar	1,207	1.000	1,207
3	M	PRCH		13	SLBC	137	1.000	137
4	M	PRCH		13	SLBC	562	1.000	562
Total Building Area						2,815		2,815