



# Rogers

## Assessment Property Record Card for Tax Year 2026

Data provided by LISA DELOZIER County Assessor

Date 04/18/2026  
Time 09:39:59  
Page 1

Assessment Data				Primary Image						
<b>Account</b>	660101299									
<b>Parcel ID</b>	000000000-1010196-008-0005									
<b>Cadastral ID</b>	27-21-14-05350									
<b>Property Type</b>	REAL - Real Property									
<b>Property Class</b>	RRP	VI Area	4							
<b>Tax Area</b>	3 - OWASSO RURAL/NO FIRE									
<b>Name ID</b>	333839									
WHITE, ROY ANTHONY & BILLIE LEE										
8212 N 150TH E AVE OWASSO OK 74055-0000										
<b>Parcel Location</b>										
<b>Situs</b>	08212 N 150TH E AVE									
<b>Subdivision</b>	HOMESTEAD									
<b>Lot/Block</b>	0005 / 0008	<b>Parcel Size</b>	1 - Lots							
<b>Sec/Twn/Rng</b>	27 / 21 / 14 / 5									
<b>Neighborhood</b>	1011 - R-V04 SW OWASSO									
<b>School District</b>	S021 - OWASSO SCHOOLS									
<b>Legal Description</b> Lat/Long: 36.27271515 -95.80771147				<b>Building Permits</b>						
LOT 5 BLOCK 8 HOMESTEAD				<b>Number</b>	<b>Description</b>	<b>Opened</b>	<b>Closed</b>	<b>Amount</b>		
				R20 000441	R22- NEW 3000 SQ FT SFR	10/2020	03/2021	180,000		
<b>Exemptions</b>				<b>Sale History</b>						
<b>Code</b>	<b>Type</b>	<b>Active</b>	<b>Maximum</b>	<b>Exemption</b>	<b>Bk/Pg</b>	<b>Grantor</b>	<b>Date</b>	<b>Price</b>	<b>Code</b>	
					/	DENHAM HOMES LLC	03/04/2021	385,500	YES	
					/	SOC'S DEVELOPMENT LLC	09/24/2020	72,500	15	
<b>Parcel Valuation</b>										
<b>Source</b>	REAL		<b>Fair Cash</b>	<b>Capped</b>	<b>Asmnt Level</b>	<b>Assessed</b>	<b>Levy Rate</b>	97.960	<b>Current Tax</b>	
<b>Remove Cap</b>	2022		<b>Land Value</b>	68,472	68,472	11%	7,532	<b>Assessed</b>	49,089	4,808.76
<b>Year Frozen</b>			<b>Improvements</b>	432,333	377,791		41,557	<b>Penalty</b>	0	
<b>Uncapped Value</b>	0		<b>Mobile Home</b>	0	0		0	<b>Exemption</b>	0	0.00
<b>TIF Project ID</b>	0		<b>Total Value</b>	500,805	446,263		49,089	<b>Total Taxable</b>	49,089	4,809.00
<b>Assessment History</b>										
<b>Tax Year</b>	<b>Statement Number</b>	<b>Billed Owner</b>			<b>Tax Area</b>	<b>Total Value</b>	<b>Exemptions</b>	<b>Taxable Value</b>	<b>Billed Tax</b>	
2025	2025-660101299	WHITE, ROY ANTHONY &			3	484,434	0	46,751	4,580.00	
2024	2024-660101299	WHITE, ROY ANTHONY &			3	603,348	0	44,525	4,278.00	
2023	2023-660101299	WHITE, ROY ANTHONY &			3	385,500	0	42,405	3,974.00	
2022	2022-660101299	WHITE, ROY ANTHONY &			3	385,500	0	42,405	4,154.00	
2021	2021-660101299	WHITE, ROY ANTHONY &			3	72,502	0	7,975	772.00	
2020	2020-660101299	SOC'S DEVELOPMENT LLC			3	863	0	95	9.00	
2019	2019-660101299	SOC'S DEVELOPMENT LLC			3	863	0	95	9.00	



# Rogers

## Assessment Property Record Card for Tax Year 2026

Data provided by LISA DELOZIER County Assessor

Date 04/18/2026  
 Time 09:39:59  
 Page 2

Lot Data		Square-Foot - NBHD 1011 #1	
Lot Size	0	0	
Lot Count	1		
Units Buildable			
Non-Ag Acres	0.5822		
Topography			
Street Access			
Utilities			
Amenities	LAND QUALITY		0
			0
Method	Square-Foot		
Base Lot Value	25,360.00 x 2.70 = 68,472		
Factor Value			
Adjustments	1.0000		
Lot Value	68,472		



\\tsclient\TCASEY\CASEY BOOTH RESIDENTIAL VI\2022-7-26\ 7/26/2022

Residential Data	
Type	1 Single Family Residence
Condition	3 - Average
Quality	3.5 - Average
Architecture	
Style	100% One Story
Exterior Wall	100% Veneer, Masonry
Base/Total Area	3,013 / 3,013
Style	100% One Story
HVAC	100% Warmed & Cooled Air
Roof Cover	1 Composition Shingle
Area on Slab	3,013
Fixture/RghIn	14 /
Bed/F/H Bath	4 / 3.0 /
Basement Area	
Garage Type	1,158 Attached Garage - Unfinished
Remodel	
Year/Eff Age	2021 / 4

### GRM Approach

GRM Code	
Gross Rent	0.00
Indicated Value	

### Multiple Regression

MRA Code	1	Test
Adjusted R	0.8445	
Indicated Value	447,539	148.54 Per SqFt

### Direct Comparables

Selection Model	A	Adam Test
Adjustment Model	1	2022 Residential
Comparables	8	
Indicated Value	580,980	Per SqFt

### Value Reconciliation

Selected Approach	Cost Approach		
Improvements	432,333		
Lot Value	68,472		
Indicated Value	500,805	166.21	Per SqFt
Agland Value			
Site Improvements			
Total Value	500,805	166.21	Total Value Per SqFt

Cost Approach		Manual : 01/2025	
Base Cost	105.12	Total Misc Impr	+ 19,214
Roofing Adj	+ 5.00	Garage Cost	+ 43,089
Subfloor Adj	+ -3.22	Total RCN	= 450,347
Heat/Cool Adj	+ 14.47	Depreciation ( 4%)	- 18,014
Plumbing Adj	+ 7.42	Lump Sums	+ 0
Basement Adj	+ 0.00	RCNLD	= 432,333
Adj Base Cost	= 128.79	Lot Value	+ 68,472
Total Area	x 3,013	Indicated Value	= 500,805
Adjusted Cost	= 388,044	Value Per SqFt	166.21

### Miscellaneous Improvements

Code	Description	Sketch ID	Size	Year	Units	Unit Cost	Depr	Value
PRCH	SLAB PORCH - COVERED	149837	560		560	27.71		15,518
PRCH	SLAB PORCH - COVERED	149838	127		127	29.10		3,696



# Rogers

## Assessment Property Record Card for Tax Year 2026

Data provided by LISA DELOZIER County Assessor

Date 04/18/2026

Time 09:39:59

Page 3

### Sketch Image

660101299

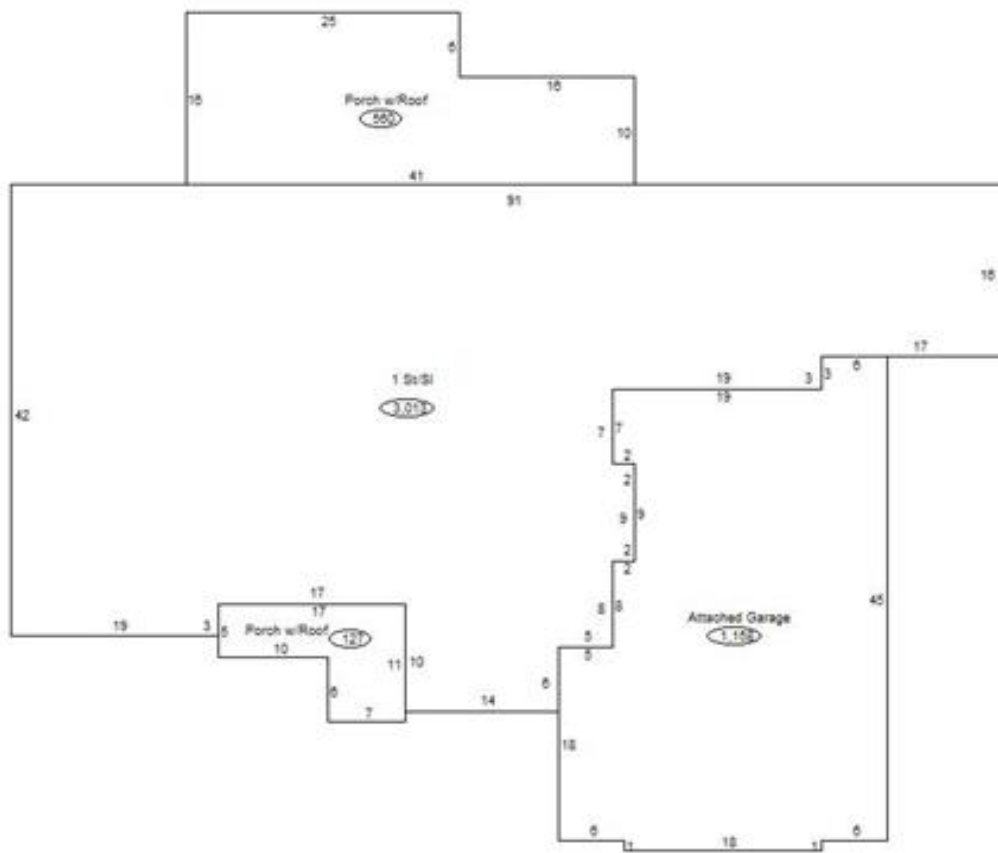

### Sketch Vector Information

Sequence	Code	Type	Built Over	Scale	Section Label	Base Area	Multiplier	Total Area
1	R	1	Slab	13	1 St/Sl	3,013	1.000	3,013
2	G	1		13	Attached Garage	1,158	1.000	1,158
3	M	PRCH		13	SLBC	560	1.000	560
4	M	PRCH		13	SLBC	127	1.000	127
<b>Total Building Area</b>						3,013		3,013