



# Rogers

## Assessment Property Record Card for Tax Year 2026

Data provided by LISA DELOZIER County Assessor

Date 04/18/2026  
Time 09:41:05  
Page 1

Assessment Data					Primary Image																																																																				
<b>Account</b> 660101335 <b>Parcel ID</b> 000000000-1010196-012-0010 <b>Cadastral ID</b> 27-21-14-05710 <b>Property Type</b> REAL - Real Property <b>Property Class</b> RRP VI Area 4 <b>Tax Area</b> 3 - OWASSO RURAL/NO FIRE <b>Name ID</b> 340522 CHAMBERLAIN, MICHAEL G & VICKIE L & THE FLOYD & LESSIE CHAMBERLAIN REVOCABLE TRUST 15403 E 83RD ST N OWASSO OK 74055-0000																																																																									
<b>Parcel Location</b> <b>Situs</b> 15403 E 83RD ST N <b>Subdivision</b> HOMESTEAD <b>Lot/Block</b> 0010 / 0012 <b>Parcel Size</b> 1 - Lots <b>Sec/Twn/Rng</b> 27 / 21 / 14 / 5 <b>Neighborhood</b> 1011 - R-V04 SW OWASSO <b>School District</b> S021 - OWASSO SCHOOLS																																																																									
<b>Legal Description</b> Lot/Long: 36.27463729 -95.80161881					<b>Building Permits</b> <table border="1"> <thead> <tr> <th>Number</th> <th>Description</th> <th>Opened</th> <th>Closed</th> <th>Amount</th> </tr> </thead> <tbody> <tr> <td>R18 000105</td> <td>R19- NEW 3100 SQ FT SFR</td> <td>05/2018</td> <td>09/2018</td> <td>275,000</td> </tr> </tbody> </table>					Number	Description	Opened	Closed	Amount	R18 000105	R19- NEW 3100 SQ FT SFR	05/2018	09/2018	275,000																																																						
Number	Description	Opened	Closed	Amount																																																																					
R18 000105	R19- NEW 3100 SQ FT SFR	05/2018	09/2018	275,000																																																																					
<b>Exemptions</b> <table border="1"> <thead> <tr> <th>Code</th> <th>Type</th> <th>Active</th> <th>Maximum</th> <th>Exemption</th> </tr> </thead> <tbody> <tr> <td>H</td> <td>Homestead</td> <td>No</td> <td>1,000</td> <td></td> </tr> </tbody> </table>					Code	Type	Active	Maximum	Exemption	H	Homestead	No	1,000		<b>Sale History</b> <table border="1"> <thead> <tr> <th>Bk/Pg</th> <th>Grantor</th> <th>Date</th> <th>Price</th> <th>Code</th> </tr> </thead> <tbody> <tr> <td>/</td> <td>CRAIN, BRIAN R &amp;</td> <td>12/29/2022</td> <td>482,500</td> <td>YES</td> </tr> <tr> <td>/</td> <td>DENHAM HOMES LLC</td> <td>10/23/2018</td> <td>332,000</td> <td>YES</td> </tr> <tr> <td>2706/70</td> <td>SOC'S DEVELOPMENT LLC</td> <td>04/16/2018</td> <td>67,500</td> <td>15</td> </tr> </tbody> </table>					Bk/Pg	Grantor	Date	Price	Code	/	CRAIN, BRIAN R &	12/29/2022	482,500	YES	/	DENHAM HOMES LLC	10/23/2018	332,000	YES	2706/70	SOC'S DEVELOPMENT LLC	04/16/2018	67,500	15																																		
Code	Type	Active	Maximum	Exemption																																																																					
H	Homestead	No	1,000																																																																						
Bk/Pg	Grantor	Date	Price	Code																																																																					
/	CRAIN, BRIAN R &	12/29/2022	482,500	YES																																																																					
/	DENHAM HOMES LLC	10/23/2018	332,000	YES																																																																					
2706/70	SOC'S DEVELOPMENT LLC	04/16/2018	67,500	15																																																																					
<b>Parcel Valuation</b> <table border="1"> <thead> <tr> <th>Source</th> <th>REAL</th> <th>Fair Cash</th> <th>Capped</th> <th>Asmnt Level</th> <th>Assessed</th> <th>Levy Rate</th> <th>97.960</th> <th>Current Tax</th> </tr> </thead> <tbody> <tr> <td>Remove Cap</td> <td>2023</td> <td>Land Value</td> <td>67,592</td> <td>67,592</td> <td>11%</td> <td>7,435</td> <td>Assessed</td> <td>49,591 4,857.93</td> </tr> <tr> <td>Year Frozen</td> <td></td> <td>Improvements</td> <td>383,238</td> <td>383,238</td> <td></td> <td>42,156</td> <td>Penalty</td> <td>0</td> </tr> <tr> <td>Uncapped Value</td> <td>0</td> <td>Mobile Home</td> <td>0</td> <td>0</td> <td></td> <td>0</td> <td>Exemption</td> <td>0 0.00</td> </tr> <tr> <td>TIF Project ID</td> <td>0</td> <td>Total Value</td> <td>450,830</td> <td>450,830</td> <td></td> <td>49,591</td> <td>Total Taxable</td> <td>49,591 4,858.00</td> </tr> </tbody> </table>										Source	REAL	Fair Cash	Capped	Asmnt Level	Assessed	Levy Rate	97.960	Current Tax	Remove Cap	2023	Land Value	67,592	67,592	11%	7,435	Assessed	49,591 4,857.93	Year Frozen		Improvements	383,238	383,238		42,156	Penalty	0	Uncapped Value	0	Mobile Home	0	0		0	Exemption	0 0.00	TIF Project ID	0	Total Value	450,830	450,830		49,591	Total Taxable	49,591 4,858.00																			
Source	REAL	Fair Cash	Capped	Asmnt Level	Assessed	Levy Rate	97.960	Current Tax																																																																	
Remove Cap	2023	Land Value	67,592	67,592	11%	7,435	Assessed	49,591 4,857.93																																																																	
Year Frozen		Improvements	383,238	383,238		42,156	Penalty	0																																																																	
Uncapped Value	0	Mobile Home	0	0		0	Exemption	0 0.00																																																																	
TIF Project ID	0	Total Value	450,830	450,830		49,591	Total Taxable	49,591 4,858.00																																																																	
<b>Assessment History</b> <table border="1"> <thead> <tr> <th>Tax Year</th> <th>Statement Number</th> <th>Billed Owner</th> <th>Tax Area</th> <th>Total Value</th> <th>Exemptions</th> <th>Taxable Value</th> <th>Billed Tax</th> </tr> </thead> <tbody> <tr> <td>2025</td> <td>2025-660101335</td> <td>CHAMBERLAIN, MICHAEL G &amp;</td> <td>3</td> <td>433,288</td> <td>0</td> <td>47,451</td> <td>4,648.00</td> </tr> <tr> <td>2024</td> <td>2024-660101335</td> <td>CHAMBERLAIN, MICHAEL G &amp;</td> <td>3</td> <td>526,222</td> <td>0</td> <td>45,191</td> <td>4,341.00</td> </tr> <tr> <td>2023</td> <td>2023-660101335</td> <td>CHAMBERLAIN, MICHAEL G &amp;</td> <td>3</td> <td>391,265</td> <td>0</td> <td>43,039</td> <td>4,033.00</td> </tr> <tr> <td>2022</td> <td>2022-660101335</td> <td>CRAIN, BRIAN R &amp;</td> <td>3</td> <td>373,480</td> <td>1000</td> <td>35,385</td> <td>3,467.00</td> </tr> <tr> <td>2021</td> <td>2021-660101335</td> <td>CRAIN, BRIAN R &amp;</td> <td>3</td> <td>321,141</td> <td>1000</td> <td>34,326</td> <td>3,321.00</td> </tr> <tr> <td>2020</td> <td>2020-660101335</td> <td>CRAIN, BRIAN R &amp;</td> <td>3</td> <td>335,839</td> <td>1000</td> <td>35,942</td> <td>3,472.00</td> </tr> <tr> <td>2019</td> <td>2019-660101335</td> <td>CRAIN, BRIAN R &amp;</td> <td>3</td> <td>333,736</td> <td>1000</td> <td>35,711</td> <td>3,452.00</td> </tr> </tbody> </table>										Tax Year	Statement Number	Billed Owner	Tax Area	Total Value	Exemptions	Taxable Value	Billed Tax	2025	2025-660101335	CHAMBERLAIN, MICHAEL G &	3	433,288	0	47,451	4,648.00	2024	2024-660101335	CHAMBERLAIN, MICHAEL G &	3	526,222	0	45,191	4,341.00	2023	2023-660101335	CHAMBERLAIN, MICHAEL G &	3	391,265	0	43,039	4,033.00	2022	2022-660101335	CRAIN, BRIAN R &	3	373,480	1000	35,385	3,467.00	2021	2021-660101335	CRAIN, BRIAN R &	3	321,141	1000	34,326	3,321.00	2020	2020-660101335	CRAIN, BRIAN R &	3	335,839	1000	35,942	3,472.00	2019	2019-660101335	CRAIN, BRIAN R &	3	333,736	1000	35,711	3,452.00
Tax Year	Statement Number	Billed Owner	Tax Area	Total Value	Exemptions	Taxable Value	Billed Tax																																																																		
2025	2025-660101335	CHAMBERLAIN, MICHAEL G &	3	433,288	0	47,451	4,648.00																																																																		
2024	2024-660101335	CHAMBERLAIN, MICHAEL G &	3	526,222	0	45,191	4,341.00																																																																		
2023	2023-660101335	CHAMBERLAIN, MICHAEL G &	3	391,265	0	43,039	4,033.00																																																																		
2022	2022-660101335	CRAIN, BRIAN R &	3	373,480	1000	35,385	3,467.00																																																																		
2021	2021-660101335	CRAIN, BRIAN R &	3	321,141	1000	34,326	3,321.00																																																																		
2020	2020-660101335	CRAIN, BRIAN R &	3	335,839	1000	35,942	3,472.00																																																																		
2019	2019-660101335	CRAIN, BRIAN R &	3	333,736	1000	35,711	3,452.00																																																																		



# Rogers

## Assessment Property Record Card for Tax Year 2026

Data provided by LISA DELOZIER County Assessor

Date 04/18/2026  
Time 09:41:06  
Page 2

Lot Data		Square-Foot - NBHD 1011 #1	
Lot Size	0	0	
Lot Count	1		
Units Buildable			
Non-Ag Acres	0.5747		
Topography			
Street Access			
Utilities			
Amenities	LAND QUALITY		0
			0
Method	Square-Foot		
Base Lot Value	25,034.00 x 2.70 = 67,592		
Factor Value			
Adjustments	1.0000		
Lot Value	67,592		



\\tsclient\TCASEY\CASEY BOOTH RESIDENTIAL VI\2022-7-26\ 7/26/2022

Residential Data	
Type	1 Single Family Residence
Condition	3 - Average
Quality	4 - Good
Architecture	
Style	100% One Story
Exterior Wall	80% Veneer, Masonry 20% Veneer, Stone
Base/Total Area	2,486 / 2,486
Style	100% One Story
HVAC	100% Warmed & Cooled Air
Roof Cover	1 Composition Shingle
Area on Slab	2,486
Fixture/RghIn	14 /
Bed/F/H Bath	3 / 3.0 /
Basement Area	
Garage Type	865 Attached Garage - Unfinished
Remodel	
Year/Eff Age	2018 / 6

### GRM Approach

GRM Code	
Gross Rent	0.00
Indicated Value	

### Multiple Regression

MRA Code	1 Test
Adusted R	0.8445
Indicated Value	398,966 160.49 Per SqFt

### Direct Comparables

Selection Model	A Adam Test
Adjustment Model	1 2022 Residential
Comparables	2
Indicated Value	488,790 Per SqFt

### Value Reconciliation

Selected Approach	Cost Approach
Improvements	383,238
Lot Value	67,592
Indicated Value	450,830 181.35 Per SqFt
Agland Value	
Site Improvements	
Total Value	450,830 181.35 Total Value Per SqFt

### Cost Approach Manual : 01/2025

Base Cost	114.24	Total Misc Impr	+	15,649
Roofing Adj	+ 5.82	Garage Cost	+	39,288
Subfloor Adj	+ -4.60	Total RCN	=	407,700
Heat/Cool Adj	+ 16.31	Depreciation ( 6%)	-	24,462
Plumbing Adj	+ 10.13	Lump Sums	+	0
Basement Adj	+ 0.00	RCNLD	=	383,238
Adj Base Cost	= 141.90	Lot Value	+	67,592
Total Area	x 2,486	Indicated Value	=	450,830
Adjusted Cost	= 352,763	Value Per SqFt		181.35

### Miscellaneous Improvements

Code	Description	Sketch ID	Size	Year	Units	Unit Cost	Depr	Value
PRCH	SLAB PORCH - COVERED	138824	17x10		170	32.44		5,515
PATO	SLAB PORCH - OPEN	138825	10x3		30	14.39		432
PATO	SLAB PORCH - OPEN	138826	17x6		102	14.36		1,465
PRCH	SLAB PORCH - COVERED	138828	6x5		30	33.10		993
FPR1	FIREPLACE - RESIDENTIAL 1 STORY			1	1	7,243.87		7,244



# Rogers

## Assessment Property Record Card for Tax Year 2026

Data provided by LISA DELOZIER County Assessor

Date 04/18/2026  
 Time 09:41:06  
 Page 3

Sketch Image

660101335

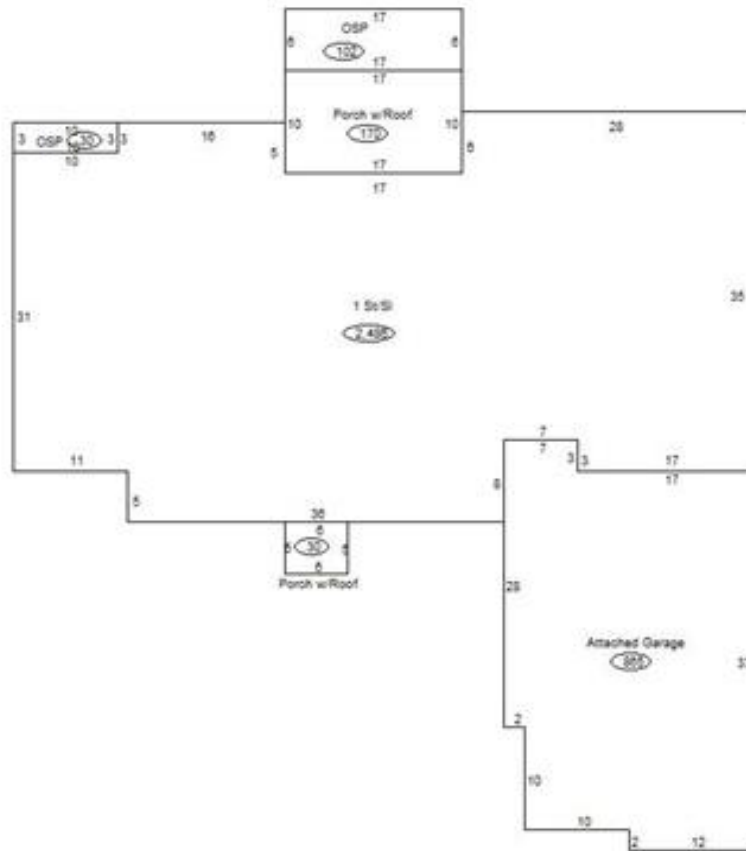

### Sketch Vector Information

Sequence	Code	Type	Built Over	Scale	Section Label	Base Area	Multiplier	Total Area
1	R	1	Slab	13	1 St/Sl	2,486	1.000	2,486
2	M	PRCH		13	SLBC	170	1.000	170
3	M	PATO		13	Open Slab	30	1.000	30
4	M	PATO		13	Open Slab	102	1.000	102
5	G	1		13	Attached Garage	865	1.000	865
6	M	PRCH		13	SLBC	30	1.000	30
<b>Total Building Area</b>						<b>2,486</b>		<b>2,486</b>