



Rogers

Assessment Property Record Card for Tax Year 2026

Data provided by LISA DELOZIER County Assessor

Date 04/18/2026
Time 09:41:38
Page 1

Assessment Data					Primary Image																																																																				
Account 660101354 Parcel ID 000000000-1010196-013-0017 Cadastral ID 27-21-14-05900 Property Type REAL - Real Property Property Class RRP VI Area 4 Tax Area 3 - OWASSO RURAL/NO FIRE Name ID 330549 HOFFPAUIR, GUILFRED RYAN III & SARA BETH 15408 E 82ND ST N OWASSO OK 74055-0000 Parcel Location Situs 15408 E 82ND ST N Subdivision HOMESTEAD Lot/Block 0017 / 0013 Parcel Size 1 - Lots Sec/Twn/Rng 27 / 21 / 14 / 5 Neighborhood 1011 - R-V04 SW OWASSO School District S021 - OWASSO SCHOOLS																																																																									
Legal Description Lot/Long: 36.27156138 -95.80145895																																																																									
Building Permits					<table border="1"> <thead> <tr> <th>Number</th> <th>Description</th> <th>Opened</th> <th>Closed</th> <th>Amount</th> </tr> </thead> <tbody> <tr> <td>R19 000301</td> <td>R21- NEW 2500 SQ FT SFR</td> <td>08/2019</td> <td>03/2020</td> <td>200,000</td> </tr> </tbody> </table>					Number	Description	Opened	Closed	Amount	R19 000301	R21- NEW 2500 SQ FT SFR	08/2019	03/2020	200,000																																																						
Number	Description	Opened	Closed	Amount																																																																					
R19 000301	R21- NEW 2500 SQ FT SFR	08/2019	03/2020	200,000																																																																					
Exemptions					Sale History																																																																				
<table border="1"> <thead> <tr> <th>Code</th> <th>Type</th> <th>Active</th> <th>Maximum</th> <th>Exemption</th> </tr> </thead> <tbody> <tr> <td>H</td> <td>Homestead</td> <td>Yes</td> <td>1,000</td> <td>1,000</td> </tr> </tbody> </table>					Code	Type	Active	Maximum	Exemption	H	Homestead	Yes	1,000	1,000	<table border="1"> <thead> <tr> <th>Bk/Pg</th> <th>Grantor</th> <th>Date</th> <th>Price</th> <th>Code</th> </tr> </thead> <tbody> <tr> <td>/</td> <td>DENHAM HOMES LLC</td> <td>04/09/2020</td> <td>364,000</td> <td>YES</td> </tr> <tr> <td>/</td> <td>SOC'S DEVELOPMENT LLC</td> <td>08/16/2019</td> <td>65,500</td> <td>15</td> </tr> </tbody> </table>					Bk/Pg	Grantor	Date	Price	Code	/	DENHAM HOMES LLC	04/09/2020	364,000	YES	/	SOC'S DEVELOPMENT LLC	08/16/2019	65,500	15																																							
Code	Type	Active	Maximum	Exemption																																																																					
H	Homestead	Yes	1,000	1,000																																																																					
Bk/Pg	Grantor	Date	Price	Code																																																																					
/	DENHAM HOMES LLC	04/09/2020	364,000	YES																																																																					
/	SOC'S DEVELOPMENT LLC	08/16/2019	65,500	15																																																																					
Parcel Valuation																																																																									
<table border="1"> <thead> <tr> <th>Source</th> <th>REAL</th> </tr> </thead> <tbody> <tr> <td>Remove Cap</td> <td>2021</td> </tr> </tbody> </table>		Source	REAL	Remove Cap	2021	<table border="1"> <thead> <tr> <th>Fair Cash</th> <th>Capped</th> </tr> </thead> <tbody> <tr> <td>Land Value</td> <td>66,282</td> </tr> <tr> <td>Improvements</td> <td>401,159</td> </tr> <tr> <td>Mobile Home</td> <td>0</td> </tr> <tr> <td>Total Value</td> <td>467,441</td> </tr> </tbody> </table>		Fair Cash	Capped	Land Value	66,282	Improvements	401,159	Mobile Home	0	Total Value	467,441	<table border="1"> <thead> <tr> <th>Asmnt Level</th> <th>Assessed</th> </tr> </thead> <tbody> <tr> <td>11%</td> <td>7,232</td> </tr> <tr> <td></td> <td>39,585</td> </tr> <tr> <td></td> <td>0</td> </tr> <tr> <td></td> <td>46,817</td> </tr> </tbody> </table>		Asmnt Level	Assessed	11%	7,232		39,585		0		46,817	<table border="1"> <thead> <tr> <th>Levy Rate</th> <th>Current Tax</th> </tr> </thead> <tbody> <tr> <td>97.960</td> <td>4,586.19</td> </tr> <tr> <td></td> <td>0</td> </tr> <tr> <td></td> <td>1,000</td> </tr> <tr> <td></td> <td>45,817</td> </tr> </tbody> </table>		Levy Rate	Current Tax	97.960	4,586.19		0		1,000		45,817																																
Source	REAL																																																																								
Remove Cap	2021																																																																								
Fair Cash	Capped																																																																								
Land Value	66,282																																																																								
Improvements	401,159																																																																								
Mobile Home	0																																																																								
Total Value	467,441																																																																								
Asmnt Level	Assessed																																																																								
11%	7,232																																																																								
	39,585																																																																								
	0																																																																								
	46,817																																																																								
Levy Rate	Current Tax																																																																								
97.960	4,586.19																																																																								
	0																																																																								
	1,000																																																																								
	45,817																																																																								
Assessment History																																																																									
<table border="1"> <thead> <tr> <th>Tax Year</th> <th>Statement Number</th> <th>Billed Owner</th> <th>Tax Area</th> <th>Total Value</th> <th>Exemptions</th> <th>Taxable Value</th> <th>Billed Tax</th> </tr> </thead> <tbody> <tr> <td>2025</td> <td>2025-660101354</td> <td>HOFFPAUIR, GUILFRED RYAN III &</td> <td>3</td> <td>452,144</td> <td>1000</td> <td>44,454</td> <td>4,355.00</td> </tr> <tr> <td>2024</td> <td>2024-660101354</td> <td>HOFFPAUIR, GUILFRED RYAN III &</td> <td>3</td> <td>543,830</td> <td>1000</td> <td>43,130</td> <td>4,143.00</td> </tr> <tr> <td>2023</td> <td>2023-660101354</td> <td>HOFFPAUIR, GUILFRED RYAN III &</td> <td>3</td> <td>426,066</td> <td>1000</td> <td>41,844</td> <td>3,921.00</td> </tr> <tr> <td>2022</td> <td>2022-660101354</td> <td>HOFFPAUIR, GUILFRED RYAN III &</td> <td>3</td> <td>415,801</td> <td>1000</td> <td>40,597</td> <td>3,977.00</td> </tr> <tr> <td>2021</td> <td>2021-660101354</td> <td>HOFFPAUIR, GUILFRED RYAN III &</td> <td>3</td> <td>367,137</td> <td>0</td> <td>40,385</td> <td>3,907.00</td> </tr> <tr> <td>2020</td> <td>2020-660101354</td> <td>HOFFPAUIR, GUILFRED RYAN III &</td> <td>3</td> <td>67,500</td> <td>0</td> <td>7,425</td> <td>717.00</td> </tr> <tr> <td>2019</td> <td>2019-660101354</td> <td>DENHAM HOMES LLC</td> <td>3</td> <td>863</td> <td>0</td> <td>95</td> <td>9.00</td> </tr> </tbody> </table>										Tax Year	Statement Number	Billed Owner	Tax Area	Total Value	Exemptions	Taxable Value	Billed Tax	2025	2025-660101354	HOFFPAUIR, GUILFRED RYAN III &	3	452,144	1000	44,454	4,355.00	2024	2024-660101354	HOFFPAUIR, GUILFRED RYAN III &	3	543,830	1000	43,130	4,143.00	2023	2023-660101354	HOFFPAUIR, GUILFRED RYAN III &	3	426,066	1000	41,844	3,921.00	2022	2022-660101354	HOFFPAUIR, GUILFRED RYAN III &	3	415,801	1000	40,597	3,977.00	2021	2021-660101354	HOFFPAUIR, GUILFRED RYAN III &	3	367,137	0	40,385	3,907.00	2020	2020-660101354	HOFFPAUIR, GUILFRED RYAN III &	3	67,500	0	7,425	717.00	2019	2019-660101354	DENHAM HOMES LLC	3	863	0	95	9.00
Tax Year	Statement Number	Billed Owner	Tax Area	Total Value	Exemptions	Taxable Value	Billed Tax																																																																		
2025	2025-660101354	HOFFPAUIR, GUILFRED RYAN III &	3	452,144	1000	44,454	4,355.00																																																																		
2024	2024-660101354	HOFFPAUIR, GUILFRED RYAN III &	3	543,830	1000	43,130	4,143.00																																																																		
2023	2023-660101354	HOFFPAUIR, GUILFRED RYAN III &	3	426,066	1000	41,844	3,921.00																																																																		
2022	2022-660101354	HOFFPAUIR, GUILFRED RYAN III &	3	415,801	1000	40,597	3,977.00																																																																		
2021	2021-660101354	HOFFPAUIR, GUILFRED RYAN III &	3	367,137	0	40,385	3,907.00																																																																		
2020	2020-660101354	HOFFPAUIR, GUILFRED RYAN III &	3	67,500	0	7,425	717.00																																																																		
2019	2019-660101354	DENHAM HOMES LLC	3	863	0	95	9.00																																																																		



Rogers

Assessment Property Record Card for Tax Year 2026

Data provided by LISA DELOZIER County Assessor

Date 04/18/2026
 Time 09:41:38
 Page 2

Lot Data		Square-Foot - NBHD 1011 #1	
Lot Size	0	0	
Lot Count	1		
Units Buildable			
Non-Ag Acres	0.5636		
Topography			
Street Access			
Utilities			
Amenities	LAND QUALITY		0
			0
Method	Square-Foot		
Base Lot Value	24,549.00 x 2.70 = 66,282		
Factor Value			
Adjustments	1.0000		
Lot Value	66,282		



\\tsclient\TCASEY\CASEY BOOTH RESIDENTIAL VI\2022-7-26\ 7/26/2022

Residential Data	
Type	1 Single Family Residence
Condition	3 - Average
Quality	3.5 - Average
Architecture	
Style	100% One Story
Exterior Wall	95% Veneer, Masonry 5% Veneer, Stone
Base/Total Area	2,691 / 2,691
Style	100% One Story
HVAC	100% Warmed & Cooled Air
Roof Cover	1 Composition Shingle
Area on Slab	2,691
Fixture/RghIn	11 /
Bed/F/H Bath	4 / 3.0 /
Basement Area	
Garage Type	1,208 Attached Garage - Unfinished
Remodel	
Year/Eff Age	2020 / 5

GRM Approach

GRM Code	
Gross Rent	0.00
Indicated Value	

Multiple Regression

MRA Code	1	Test
Adjusted R	0.8445	
Indicated Value	421,604	156.67 Per SqFt

Direct Comparables

Selection Model	A	Adam Test
Adjustment Model	1	2022 Residential
Comparables	6	
Indicated Value	557,340	Per SqFt

Value Reconciliation

Selected Approach	Cost Approach		
Improvements	401,159		
Lot Value	66,282		
Indicated Value	467,441	173.71	Per SqFt
Agland Value			
Site Improvements			
Total Value	467,441	173.71	Total Value Per SqFt

Cost Approach Manual : 01/2025

Base Cost	107.57	Total Misc Impr	+	26,228
Roofing Adj	+ 5.11	Garage Cost	+	44,950
Subfloor Adj	+ -3.29	Total RCN	=	422,273
Heat/Cool Adj	+ 14.47	Depreciation (5%)	-	21,114
Plumbing Adj	+ 6.61	Lump Sums	+	0
Basement Adj	+ 0.00	RCNLD	=	401,159
Adj Base Cost	= 130.47	Lot Value	+	66,282
Total Area	x 2,691	Indicated Value	=	467,441
Adjusted Cost	= 351,095	Value Per SqFt		173.71

Miscellaneous Improvements

Code	Description	Sketch ID	Size	Year	Units	Unit Cost	Depr	Value
PRCH	SLAB PORCH - COVERED	145489	532		532	27.76		14,768
PRCH	SLAB PORCH - COVERED	145490	174		174	28.91		5,030
FPR1	FIREPLACE - RESIDENTIAL 1 STORY		1		1	6,429.63		6,430



Rogers
Assessment Property Record Card for Tax Year 2026

Data provided by LISA DELOZIER County Assessor

Date 04/18/2026
 Time 09:41:38
 Page 3

Sketch Image

660101354

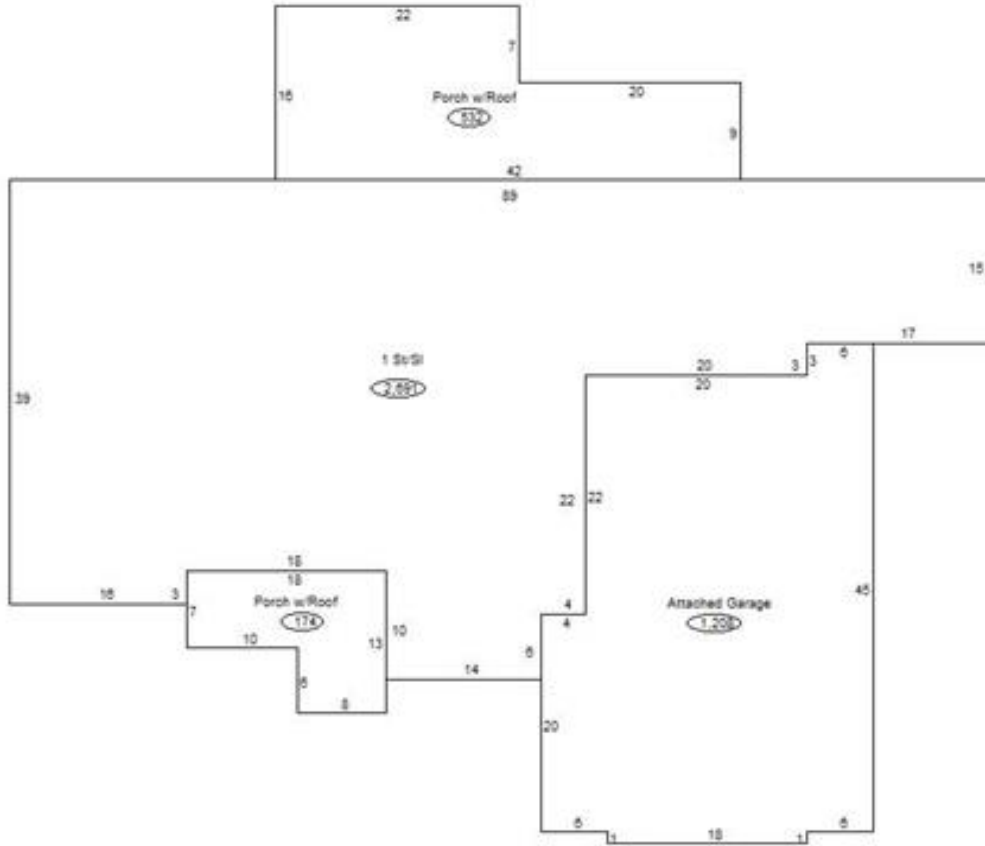

Sketch Vector Information

Sequence	Code	Type	Built Over	Scale	Section Label	Base Area	Multiplier	Total Area
1	R	1	Slab	13	1 St/Sl	2,691	1.000	2,691
2	G	1		13	Attached Garage	1,208	1.000	1,208
3	M	PRCH		13	SLBC	532	1.000	532
4	M	PRCH		13	SLBC	174	1.000	174
Total Building Area						2,691		2,691