



# Rogers

## Assessment Property Record Card for Tax Year 2026

Data provided by LISA DELOZIER County Assessor

Date 04/18/2026  
 Time 09:41:59  
 Page 1

Assessment Data					Primary Image																																																																				
<b>Account</b> 660101365 <b>Parcel ID</b> 000000000-1010196-014-0010 <b>Cadastral ID</b> 27-21-14-06010 <b>Property Type</b> REAL - Real Property <b>Property Class</b> RRP VI Area 4 <b>Tax Area</b> 3 - OWASSO RURAL/NO FIRE <b>Name ID</b> 339582 STEPHENS, PHILLIP A & CARLA A  15214 E 83RD ST N OWASSO OK 74055-0000  <b>Parcel Location</b> <b>Situs</b> 15214 E 83RD ST N <b>Subdivision</b> HOMESTEAD <b>Lot/Block</b> 0010 / 0014 <b>Parcel Size</b> 1 - Lots <b>Sec/Twn/Rng</b> 27 / 21 / 14 / 5 <b>Neighborhood</b> 1011 - R-V04 SW OWASSO <b>School District</b> S021 - OWASSO SCHOOLS																																																																									
<b>Legal Description</b> Lot/Long: 36.27393590 -95.80306205																																																																									
<b>Building Permits</b>					<table border="1"> <thead> <tr> <th>Number</th> <th>Description</th> <th>Opened</th> <th>Closed</th> <th>Amount</th> </tr> </thead> <tbody> <tr> <td>R18 000178</td> <td>R19- NEW 2793 SQ FT SFR</td> <td>07/2018</td> <td>12/2018</td> <td>280,000</td> </tr> </tbody> </table>					Number	Description	Opened	Closed	Amount	R18 000178	R19- NEW 2793 SQ FT SFR	07/2018	12/2018	280,000																																																						
Number	Description	Opened	Closed	Amount																																																																					
R18 000178	R19- NEW 2793 SQ FT SFR	07/2018	12/2018	280,000																																																																					
<b>Exemptions</b>					<b>Sale History</b>																																																																				
<table border="1"> <thead> <tr> <th>Code</th> <th>Type</th> <th>Active</th> <th>Maximum</th> <th>Exemption</th> </tr> </thead> <tbody> <tr> <td>H</td> <td>Homestead</td> <td>Yes</td> <td>1,000</td> <td>1,000</td> </tr> </tbody> </table>					Code	Type	Active	Maximum	Exemption	H	Homestead	Yes	1,000	1,000	<table border="1"> <thead> <tr> <th>Bk/Pg</th> <th>Grantor</th> <th>Date</th> <th>Price</th> <th>Code</th> </tr> </thead> <tbody> <tr> <td>/</td> <td>LANGLEY, BRADLEY &amp; CHARITY</td> <td>09/07/2022</td> <td>525,000</td> <td>YES</td> </tr> <tr> <td>/</td> <td>OVERLAND HOMES LLC</td> <td>03/31/2020</td> <td>355,000</td> <td>YES</td> </tr> <tr> <td>2720/947</td> <td>SOC'S DEVELOPMENT LLC</td> <td>06/27/2018</td> <td>65,000</td> <td>15</td> </tr> </tbody> </table>					Bk/Pg	Grantor	Date	Price	Code	/	LANGLEY, BRADLEY & CHARITY	09/07/2022	525,000	YES	/	OVERLAND HOMES LLC	03/31/2020	355,000	YES	2720/947	SOC'S DEVELOPMENT LLC	06/27/2018	65,000	15																																		
Code	Type	Active	Maximum	Exemption																																																																					
H	Homestead	Yes	1,000	1,000																																																																					
Bk/Pg	Grantor	Date	Price	Code																																																																					
/	LANGLEY, BRADLEY & CHARITY	09/07/2022	525,000	YES																																																																					
/	OVERLAND HOMES LLC	03/31/2020	355,000	YES																																																																					
2720/947	SOC'S DEVELOPMENT LLC	06/27/2018	65,000	15																																																																					
<b>Parcel Valuation</b>																																																																									
<table border="1"> <thead> <tr> <th>Source</th> <th>REAL</th> </tr> </thead> <tbody> <tr> <td>Remove Cap</td> <td>2023</td> </tr> </tbody> </table>		Source	REAL	Remove Cap	2023	<table border="1"> <thead> <tr> <th>Fair Cash</th> <th>Capped</th> </tr> </thead> <tbody> <tr> <td>Land Value</td> <td>134,999</td> </tr> <tr> <td>Improvements</td> <td>413,725</td> </tr> <tr> <td>Mobile Home</td> <td>0</td> </tr> <tr> <td>Total Value</td> <td>548,724</td> </tr> </tbody> </table>		Fair Cash	Capped	Land Value	134,999	Improvements	413,725	Mobile Home	0	Total Value	548,724	<table border="1"> <thead> <tr> <th>Asmnt Level</th> <th>Assessed</th> </tr> </thead> <tbody> <tr> <td>11%</td> <td>14,729</td> </tr> <tr> <td></td> <td>409,338</td> </tr> <tr> <td></td> <td>45,027</td> </tr> <tr> <td></td> <td>0</td> </tr> <tr> <td></td> <td>59,756</td> </tr> </tbody> </table>		Asmnt Level	Assessed	11%	14,729		409,338		45,027		0		59,756	<table border="1"> <thead> <tr> <th>Levy Rate</th> <th>Current Tax</th> </tr> </thead> <tbody> <tr> <td>97.960</td> <td>5,853.70</td> </tr> <tr> <td>Assessed</td> <td>59,756</td> </tr> <tr> <td>Penalty</td> <td>0</td> </tr> <tr> <td>Exemption</td> <td>1,000</td> </tr> <tr> <td>Total Taxable</td> <td>58,756</td> </tr> </tbody> </table>		Levy Rate	Current Tax	97.960	5,853.70	Assessed	59,756	Penalty	0	Exemption	1,000	Total Taxable	58,756																												
Source	REAL																																																																								
Remove Cap	2023																																																																								
Fair Cash	Capped																																																																								
Land Value	134,999																																																																								
Improvements	413,725																																																																								
Mobile Home	0																																																																								
Total Value	548,724																																																																								
Asmnt Level	Assessed																																																																								
11%	14,729																																																																								
	409,338																																																																								
	45,027																																																																								
	0																																																																								
	59,756																																																																								
Levy Rate	Current Tax																																																																								
97.960	5,853.70																																																																								
Assessed	59,756																																																																								
Penalty	0																																																																								
Exemption	1,000																																																																								
Total Taxable	58,756																																																																								
<b>Assessment History</b>																																																																									
<table border="1"> <thead> <tr> <th>Tax Year</th> <th>Statement Number</th> <th>Billed Owner</th> <th>Tax Area</th> <th>Total Value</th> <th>Exemptions</th> <th>Taxable Value</th> <th>Billed Tax</th> </tr> </thead> <tbody> <tr> <td>2025</td> <td>2025-660101365</td> <td>STEPHENS, PHILLIP A &amp;</td> <td>3</td> <td>527,416</td> <td>1000</td> <td>57,016</td> <td>5,585.00</td> </tr> <tr> <td>2024</td> <td>2024-660101365</td> <td>STEPHENS, PHILLIP A &amp;</td> <td>3</td> <td>571,619</td> <td>1000</td> <td>58,483</td> <td>5,618.00</td> </tr> <tr> <td>2023</td> <td>2023-660101365</td> <td>STEPHENS, PHILLIP A &amp;</td> <td>3</td> <td>525,000</td> <td>1000</td> <td>56,750</td> <td>5,318.00</td> </tr> <tr> <td>2022</td> <td>2022-660101365</td> <td>STEPHENS, PHILLIP A &amp;</td> <td>3</td> <td>405,556</td> <td>0</td> <td>41,275</td> <td>4,044.00</td> </tr> <tr> <td>2021</td> <td>2021-660101365</td> <td>LANGLEY, BRADLEY &amp; CHARITY</td> <td>3</td> <td>357,360</td> <td>0</td> <td>39,310</td> <td>3,803.00</td> </tr> <tr> <td>2020</td> <td>2020-660101365</td> <td>LANGLEY, BRADLEY &amp; CHARITY</td> <td>3</td> <td>201,541</td> <td>0</td> <td>22,170</td> <td>2,142.00</td> </tr> <tr> <td>2019</td> <td>2019-660101365</td> <td>OVERLAND HOMES LLC</td> <td>3</td> <td>200,482</td> <td>0</td> <td>22,053</td> <td>2,132.00</td> </tr> </tbody> </table>										Tax Year	Statement Number	Billed Owner	Tax Area	Total Value	Exemptions	Taxable Value	Billed Tax	2025	2025-660101365	STEPHENS, PHILLIP A &	3	527,416	1000	57,016	5,585.00	2024	2024-660101365	STEPHENS, PHILLIP A &	3	571,619	1000	58,483	5,618.00	2023	2023-660101365	STEPHENS, PHILLIP A &	3	525,000	1000	56,750	5,318.00	2022	2022-660101365	STEPHENS, PHILLIP A &	3	405,556	0	41,275	4,044.00	2021	2021-660101365	LANGLEY, BRADLEY & CHARITY	3	357,360	0	39,310	3,803.00	2020	2020-660101365	LANGLEY, BRADLEY & CHARITY	3	201,541	0	22,170	2,142.00	2019	2019-660101365	OVERLAND HOMES LLC	3	200,482	0	22,053	2,132.00
Tax Year	Statement Number	Billed Owner	Tax Area	Total Value	Exemptions	Taxable Value	Billed Tax																																																																		
2025	2025-660101365	STEPHENS, PHILLIP A &	3	527,416	1000	57,016	5,585.00																																																																		
2024	2024-660101365	STEPHENS, PHILLIP A &	3	571,619	1000	58,483	5,618.00																																																																		
2023	2023-660101365	STEPHENS, PHILLIP A &	3	525,000	1000	56,750	5,318.00																																																																		
2022	2022-660101365	STEPHENS, PHILLIP A &	3	405,556	0	41,275	4,044.00																																																																		
2021	2021-660101365	LANGLEY, BRADLEY & CHARITY	3	357,360	0	39,310	3,803.00																																																																		
2020	2020-660101365	LANGLEY, BRADLEY & CHARITY	3	201,541	0	22,170	2,142.00																																																																		
2019	2019-660101365	OVERLAND HOMES LLC	3	200,482	0	22,053	2,132.00																																																																		



# Rogers

## Assessment Property Record Card for Tax Year 2026

Data provided by LISA DELOZIER County Assessor

Date 04/18/2026  
 Time 09:41:59  
 Page 2

Lot Data		Square-Foot - NBHD 1011 #1	
Lot Size	0	0	
Lot Count	1		
Units Buildable			
Non-Ag Acres	0.6615		
Topography			
Street Access			
Utilities			
Amenities	LAND QUALITY		0
			0
Method	Square-Foot		
Base Lot Value	28,816.00 x 2.70 = 77,803		
Factor Value			
Adjustments	1.7351		
Lot Value	134,999		



\\tsclient\TCASEY\CASEY BOOTH RESIDENTIAL VI\2022-7-26\ 7/26/2022

Residential Data	
Type	1 Single Family Residence
Condition	3 - Average
Quality	4 - Good
Architecture	
Style	100% One Story
Exterior Wall	90% Veneer, Masonry 10% Veneer, Stone
Base/Total Area	2,847 / 2,847
Style	100% One Story
HVAC	100% Warmed & Cooled Air
Roof Cover	1 Composition Shingle
Area on Slab	2,847
Fixture/RghIn	14 /
Bed/F/H Bath	4 / 3.0 /
Basement Area	
Garage Type	716 Attached Garage - Unfinished
Remodel	
Year/Eff Age	2018 / 6

GRM Approach	
GRM Code	
Gross Rent	0.00
Indicated Value	

Multiple Regression			
MRA Code	1	Test	
Adjusted R	0.8445		
Indicated Value	421,083	147.90	Per SqFt

Direct Comparables			
Selection Model	A	Adam Test	
Adjustment Model	1	2022 Residential	
Comparables	5		
Indicated Value	536,100		Per SqFt

Cost Approach		Manual : 01/2025	
Base Cost	110.63	Total Misc Impr	+ 17,232
Roofing Adj	+ 5.69	Garage Cost	+ 32,549
Subfloor Adj	+ -4.37	Total RCN	= 440,133
Heat/Cool Adj	+ 16.31	Depreciation ( 6%)	- 26,408
Plumbing Adj	+ 8.85	Lump Sums	+ 0
Basement Adj	+ 0.00	RCNLD	= 413,725
Adj Base Cost	= 137.11	Lot Value	+ 134,999
Total Area	x 2,847	Indicated Value	= 548,724
Adjusted Cost	= 390,352	Value Per SqFt	192.74

Value Reconciliation			
Selected Approach	Cost Approach		
Improvements	413,725		
Lot Value	134,999		
Indicated Value	548,724	192.74	Per SqFt
Agland Value			
Site Improvements			
Total Value	548,724	192.74	Total Value Per SqFt

Miscellaneous Improvements								
Code	Description	Sketch ID	Size	Year	Units	Unit Cost	Depr	Value
PRCH	SLAB PORCH - COVERED	139729	20x13		260	32.06		8,336
PRCH	SLAB PORCH - COVERED	139730	10x5		50	33.03		1,652
FPR1	FIREPLACE - RESIDENTIAL 1 STORY			1	1	7,243.87		7,244



# Rogers

## Assessment Property Record Card for Tax Year 2026

Data provided by LISA DELOZIER County Assessor

Date 04/18/2026

Time 09:42:00

Page 3

Sketch Image

660101365

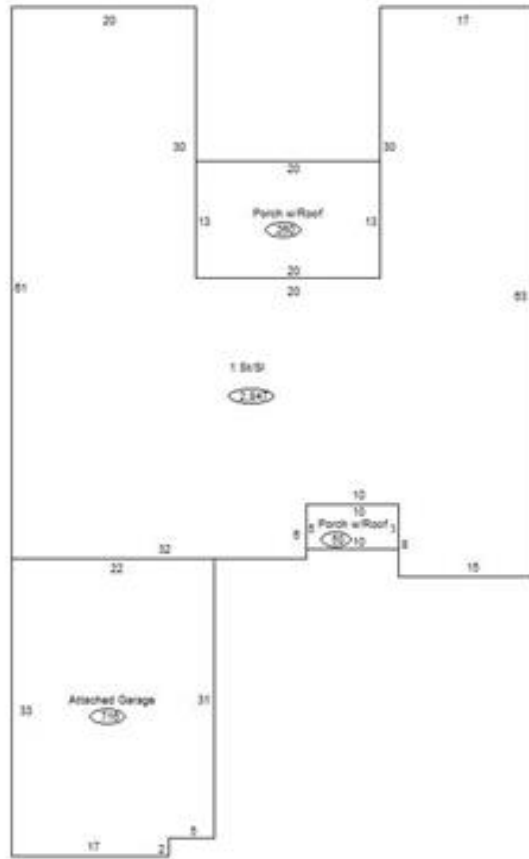

### Sketch Vector Information

Sequence	Code	Type	Built Over	Scale	Section Label	Base Area	Multiplier	Total Area
1	R	1	Slab	13	1 St/SI	2,847	1.000	2,847
2	M	PRCH		13	SLBC	260	1.000	260
3	M	PRCH		13	SLBC	50	1.000	50
4	G	1		13	Attached Garage	716	1.000	716
<b>Total Building Area</b>						<b>2,847</b>		<b>2,847</b>