



# Rogers

## Assessment Property Record Card for Tax Year 2026

Data provided by LISA DELOZIER County Assessor

Date 04/18/2026  
Time 09:42:03  
Page 1

Assessment Data					Primary Image																																																																				
<b>Account</b> 660101367 <b>Parcel ID</b> 000000000-1010196-014-0012 <b>Cadastral ID</b> 27-21-14-06030 <b>Property Type</b> REAL - Real Property <b>Property Class</b> RRP VI Area 4 <b>Tax Area</b> 3 - OWASSO RURAL/NO FIRE <b>Name ID</b> 330997 YANEZ, SARAH BETH & JAVIER  8232 N 154TH E AVE OWASSO OK 74055-0000  <b>Parcel Location</b> <b>Situs</b> 08232 N 154TH E AVE <b>Subdivision</b> HOMESTEAD <b>Lot/Block</b> 0012 / 0014 <b>Parcel Size</b> 1 - Lots <b>Sec/Twn/Rng</b> 27 / 21 / 14 / 5 <b>Neighborhood</b> 1011 - R-V04 SW OWASSO <b>School District</b> S021 - OWASSO SCHOOLS																																																																									
<b>Legal Description</b> Lot/Long: 36.27368673 -95.80238677										\\tsclient\TCASEY\CASEY BOOTH RESIDENTIAL VI\2022-7-26\ 7/26/2022																																																															
<b>Legal Description</b> LOT 12 BLOCK 14 HOMESTEAD					<b>Building Permits</b> <table border="1"> <thead> <tr> <th>Number</th> <th>Description</th> <th>Opened</th> <th>Closed</th> <th>Amount</th> </tr> </thead> <tbody> <tr> <td>R19 000012</td> <td>R20- NEW 3654 SQ FT SFR</td> <td>01/2019</td> <td>09/2019</td> <td>267,000</td> </tr> </tbody> </table>					Number	Description	Opened	Closed	Amount	R19 000012	R20- NEW 3654 SQ FT SFR	01/2019	09/2019	267,000																																																						
Number	Description	Opened	Closed	Amount																																																																					
R19 000012	R20- NEW 3654 SQ FT SFR	01/2019	09/2019	267,000																																																																					
<b>Exemptions</b> <table border="1"> <thead> <tr> <th>Code</th> <th>Type</th> <th>Active</th> <th>Maximum</th> <th>Exemption</th> </tr> </thead> <tbody> <tr> <td>H</td> <td>Homestead</td> <td>Yes</td> <td>1,000</td> <td>1,000</td> </tr> </tbody> </table>					Code	Type	Active	Maximum	Exemption	H	Homestead	Yes	1,000	1,000	<b>Sale History</b> <table border="1"> <thead> <tr> <th>Bk/Pg</th> <th>Grantor</th> <th>Date</th> <th>Price</th> <th>Code</th> </tr> </thead> <tbody> <tr> <td>/</td> <td>BREWSTER &amp; CO INC</td> <td>05/26/2020</td> <td>413,000</td> <td>YES</td> </tr> <tr> <td>2720/60</td> <td>SOC'S DEVELOPMENT LLC</td> <td>06/08/2018</td> <td>65,000</td> <td>15</td> </tr> </tbody> </table>					Bk/Pg	Grantor	Date	Price	Code	/	BREWSTER & CO INC	05/26/2020	413,000	YES	2720/60	SOC'S DEVELOPMENT LLC	06/08/2018	65,000	15																																							
Code	Type	Active	Maximum	Exemption																																																																					
H	Homestead	Yes	1,000	1,000																																																																					
Bk/Pg	Grantor	Date	Price	Code																																																																					
/	BREWSTER & CO INC	05/26/2020	413,000	YES																																																																					
2720/60	SOC'S DEVELOPMENT LLC	06/08/2018	65,000	15																																																																					
<b>Parcel Valuation</b> <table border="1"> <thead> <tr> <th>Source</th> <th>REAL</th> <th>Fair Cash</th> <th>Capped</th> <th>Asmnt Level</th> <th>Assessed</th> <th>Levy Rate</th> <th>97.960</th> <th>Current Tax</th> </tr> </thead> <tbody> <tr> <td>Remove Cap</td> <td>2021</td> <td>Land Value 84,305</td> <td>81,584</td> <td>11%</td> <td>8,974</td> <td>Assessed</td> <td>52,417</td> <td>5,134.77</td> </tr> <tr> <td>Year Frozen</td> <td></td> <td>Improvements 446,808</td> <td>394,940</td> <td></td> <td>43,443</td> <td>Penalty</td> <td>0</td> <td></td> </tr> <tr> <td>Uncapped Value</td> <td>0</td> <td>Mobile Home 0</td> <td>0</td> <td></td> <td>0</td> <td>Exemption</td> <td>1,000</td> <td>-98.00</td> </tr> <tr> <td>TIF Project ID</td> <td>0</td> <td>Total Value 531,113</td> <td>476,524</td> <td></td> <td>52,417</td> <td>Total Taxable</td> <td>51,417</td> <td>5,037.00</td> </tr> </tbody> </table>										Source	REAL	Fair Cash	Capped	Asmnt Level	Assessed	Levy Rate	97.960	Current Tax	Remove Cap	2021	Land Value 84,305	81,584	11%	8,974	Assessed	52,417	5,134.77	Year Frozen		Improvements 446,808	394,940		43,443	Penalty	0		Uncapped Value	0	Mobile Home 0	0		0	Exemption	1,000	-98.00	TIF Project ID	0	Total Value 531,113	476,524		52,417	Total Taxable	51,417	5,037.00																			
Source	REAL	Fair Cash	Capped	Asmnt Level	Assessed	Levy Rate	97.960	Current Tax																																																																	
Remove Cap	2021	Land Value 84,305	81,584	11%	8,974	Assessed	52,417	5,134.77																																																																	
Year Frozen		Improvements 446,808	394,940		43,443	Penalty	0																																																																		
Uncapped Value	0	Mobile Home 0	0		0	Exemption	1,000	-98.00																																																																	
TIF Project ID	0	Total Value 531,113	476,524		52,417	Total Taxable	51,417	5,037.00																																																																	
<b>Assessment History</b> <table border="1"> <thead> <tr> <th>Tax Year</th> <th>Statement Number</th> <th>Billed Owner</th> <th>Tax Area</th> <th>Total Value</th> <th>Exemptions</th> <th>Taxable Value</th> <th>Billed Tax</th> </tr> </thead> <tbody> <tr> <td>2025</td> <td>2025-660101367</td> <td>YANEZ, SARAH BETH &amp;</td> <td>3</td> <td>510,503</td> <td>1000</td> <td>49,891</td> <td>4,887.00</td> </tr> <tr> <td>2024</td> <td>2024-660101367</td> <td>YANEZ, SARAH BETH &amp;</td> <td>3</td> <td>654,713</td> <td>1000</td> <td>48,409</td> <td>4,651.00</td> </tr> <tr> <td>2023</td> <td>2023-660101367</td> <td>YANEZ, SARAH BETH &amp;</td> <td>3</td> <td>494,915</td> <td>1000</td> <td>46,969</td> <td>4,401.00</td> </tr> <tr> <td>2022</td> <td>2022-660101367</td> <td>YANEZ, SARAH BETH &amp;</td> <td>3</td> <td>483,115</td> <td>1000</td> <td>45,573</td> <td>4,465.00</td> </tr> <tr> <td>2021</td> <td>2021-660101367</td> <td>YANEZ, SARAH BETH &amp;</td> <td>3</td> <td>411,056</td> <td>1000</td> <td>44,216</td> <td>4,277.00</td> </tr> <tr> <td>2020</td> <td>2020-660101367</td> <td>YANEZ, SARAH BETH &amp;</td> <td>3</td> <td>208,119</td> <td>0</td> <td>22,893</td> <td>2,211.00</td> </tr> <tr> <td>2019</td> <td>2019-660101367</td> <td>BREWSTER &amp; CO INC</td> <td>3</td> <td>67,500</td> <td>0</td> <td>7,425</td> <td>718.00</td> </tr> </tbody> </table>										Tax Year	Statement Number	Billed Owner	Tax Area	Total Value	Exemptions	Taxable Value	Billed Tax	2025	2025-660101367	YANEZ, SARAH BETH &	3	510,503	1000	49,891	4,887.00	2024	2024-660101367	YANEZ, SARAH BETH &	3	654,713	1000	48,409	4,651.00	2023	2023-660101367	YANEZ, SARAH BETH &	3	494,915	1000	46,969	4,401.00	2022	2022-660101367	YANEZ, SARAH BETH &	3	483,115	1000	45,573	4,465.00	2021	2021-660101367	YANEZ, SARAH BETH &	3	411,056	1000	44,216	4,277.00	2020	2020-660101367	YANEZ, SARAH BETH &	3	208,119	0	22,893	2,211.00	2019	2019-660101367	BREWSTER & CO INC	3	67,500	0	7,425	718.00
Tax Year	Statement Number	Billed Owner	Tax Area	Total Value	Exemptions	Taxable Value	Billed Tax																																																																		
2025	2025-660101367	YANEZ, SARAH BETH &	3	510,503	1000	49,891	4,887.00																																																																		
2024	2024-660101367	YANEZ, SARAH BETH &	3	654,713	1000	48,409	4,651.00																																																																		
2023	2023-660101367	YANEZ, SARAH BETH &	3	494,915	1000	46,969	4,401.00																																																																		
2022	2022-660101367	YANEZ, SARAH BETH &	3	483,115	1000	45,573	4,465.00																																																																		
2021	2021-660101367	YANEZ, SARAH BETH &	3	411,056	1000	44,216	4,277.00																																																																		
2020	2020-660101367	YANEZ, SARAH BETH &	3	208,119	0	22,893	2,211.00																																																																		
2019	2019-660101367	BREWSTER & CO INC	3	67,500	0	7,425	718.00																																																																		



# Rogers

## Assessment Property Record Card for Tax Year 2026

Data provided by LISA DELOZIER County Assessor

Date 04/18/2026  
Time 09:42:03  
Page 2

Lot Data		Square-Foot - NBHD 1011 #1	
Lot Size	0	0	
Lot Count	1		
Units Buildable			
Non-Ag Acres	0.7168		
Topography			
Street Access			
Utilities			
Amenities	LAND QUALITY		0
			0
Method	Square-Foot		
Base Lot Value	31,224.00 x 2.70 = 84,305		
Factor Value			
Adjustments	1.0000		
Lot Value	84,305		



\\tsclient\TCASEY\CASEY BOOTH RESIDENTIAL VI\2022-7-26\ 7/26/2022

Residential Data	
Type	1 Single Family Residence
Condition	3 - Average
Quality	3.5 - Average
Architecture	
Style	100% 1 1/2 Story Finished
Exterior Wall	95% Veneer, Masonry 5% Veneer, Stone
Base/Total Area	2,734 / 3,543
Style	100% 1 1/2 Story Finished
HVAC	100% Warmed & Cooled Air
Roof Cover	1 Composition Shingle
Area on Slab	2,734
Fixture/RghIn	20 /
Bed/F/H Bath	4 / 2.0 / 1.0
Basement Area	
Garage Type	700 Attached Garage - Unfinished
Remodel	
Year/Eff Age	2019 / 5

### GRM Approach

GRM Code	
Gross Rent	0.00
Indicated Value	

### Multiple Regression

MRA Code	1 Test
Adusted R	0.8445
Indicated Value	446,851 126.12 Per SqFt

### Direct Comparables

Selection Model	A Adam Test
Adjustment Model	1 2022 Residential
Comparables	7
Indicated Value	613,280 Per SqFt

### Value Reconciliation

Selected Approach	Cost Approach
Improvements	446,808
Lot Value	84,305
Indicated Value	531,113 149.90 Per SqFt
Agland Value	
Site Improvements	
Total Value	531,113 149.90 Total Value Per SqFt

Cost Approach		Manual : 01/2025	
Base Cost	96.23	Total Misc Impr	+ 15,391
Roofing Adj	+ 3.93	Garage Cost	+ 26,159
Subfloor Adj	+ -2.52	Total RCN	= 470,324
Heat/Cool Adj	+ 14.47	Depreciation ( 5%)	- 23,516
Plumbing Adj	+ 8.91	Lump Sums	+ 0
Basement Adj	+ 0.00	RCNLD	= 446,808
Adj Base Cost	= 121.02	Lot Value	+ 84,305
Total Area	x 3,543	Indicated Value	= 531,113
Adjusted Cost	= 428,774	Value Per SqFt	149.90

### Miscellaneous Improvements

Code	Description	Sketch ID	Size	Year	Units	Unit Cost	Depr	Value
PRCH	SLAB PORCH - COVERED	142640	17x14		238	28.67		6,823
PATO	SLAB PORCH - OPEN	142641	9x4		36	12.93		465
PRCH	SLAB PORCH - COVERED	142642	57		57	29.35		1,673
FPR1	FIREPLACE - RESIDENTIAL 1 STORY		1		1	6,429.63		6,430



# Rogers

## Assessment Property Record Card for Tax Year 2026

Data provided by LISA DELOZIER County Assessor

Date 04/18/2026

Time 09:42:03

Page 3

### Sketch Image

660101367

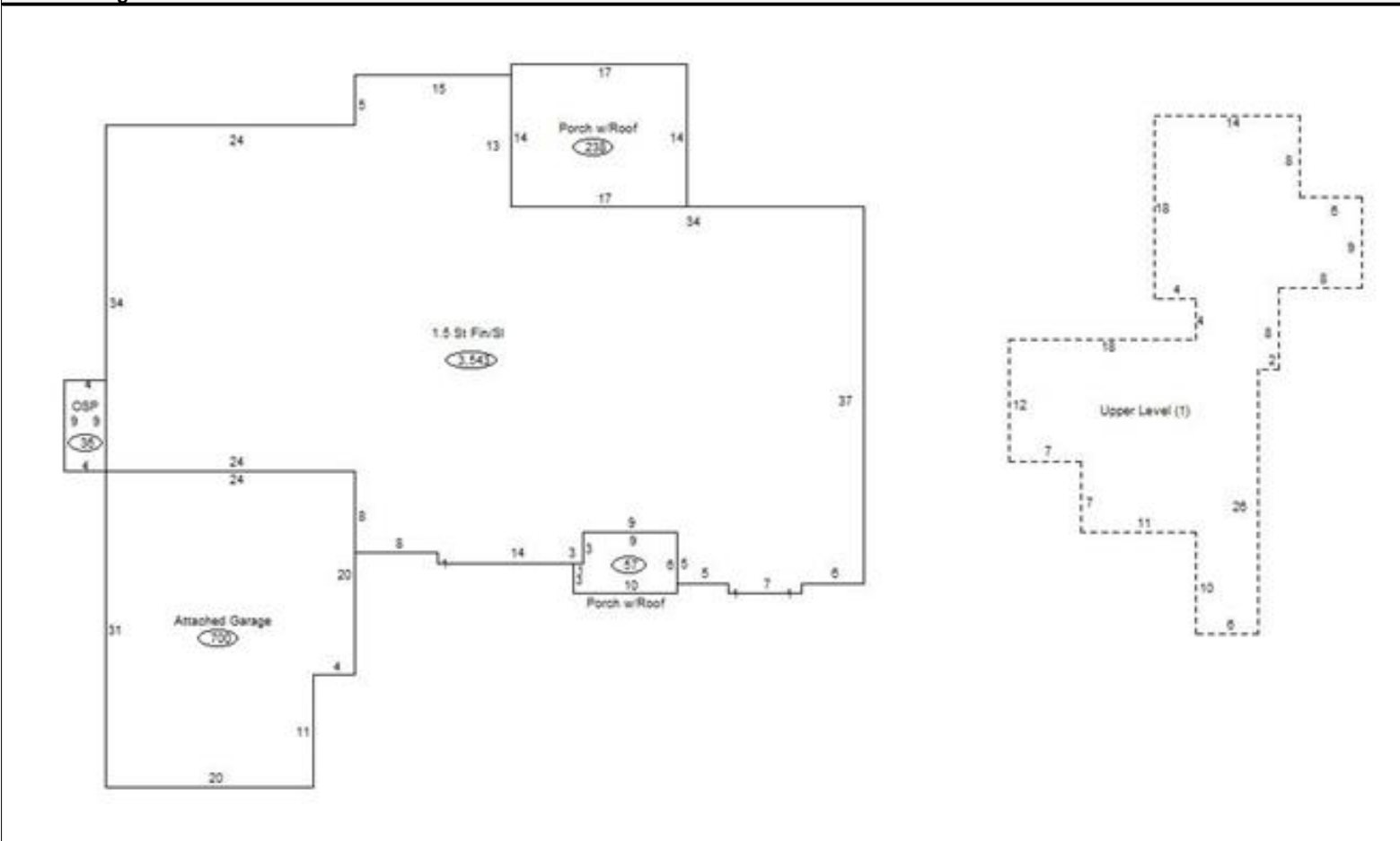

### Sketch Vector Information

Sequence	Code	Type	Built Over	Scale	Section Label	Base Area	Multiplier	Total Area
1	R	5	Slab	13	1.5 St Fin/Sl	2,734	1.296	3,543
2	U	^UL		13	Upper Level (1)	809	1.000	809
3	G	1		13	Attached Garage	700	1.000	700
4	M	PRCH		13	SLBC	238	1.000	238
5	M	PATO		13	Open Slab	36	1.000	36
6	M	PRCH		13	SLBC	57	1.000	57
<b>Total Building Area</b>						<b>2,734</b>		<b>3,543</b>