



Rogers

Assessment Property Record Card for Tax Year 2026

Data provided by LISA DELOZIER County Assessor

Date 04/18/2026
Time 09:42:34
Page 1

Assessment Data					Primary Image																																																																				
Account 660101384 Parcel ID 000000000-1010196-015-0011 Cadastral ID 27-21-14-06200 Property Type REAL - Real Property Property Class RRP VI Area 4 Tax Area 3 - OWASSO RURAL/NO FIRE Name ID 330255 HARTMAN, STEPHEN 15022 E 82ND ST N OWASSO OK 74055-0000 Parcel Location Situs 15022 E 82ND ST N Subdivision HOMESTEAD Lot/Block 0011 / 0015 Parcel Size 1 - Lots Sec/Twn/Rng 27 / 21 / 14 / 5 Neighborhood 1011 - R-V04 SW OWASSO School District S021 - OWASSO SCHOOLS																																																																									
Legal Description Lot/Long: 36.27155099 -95.80555456																																																																									
Building Permits					\\tsclient\TCASEY\CASEY BOOTH RESIDENTIAL VI\2022-7-26\ 7/26/2022																																																																				
Exemptions					Sale History																																																																				
<table border="1"> <thead> <tr> <th>Code</th> <th>Type</th> <th>Active</th> <th>Maximum</th> <th>Exemption</th> </tr> </thead> <tbody> <tr> <td>HV</td> <td>Veteran</td> <td>Yes</td> <td>999,999</td> <td>51,238</td> </tr> </tbody> </table>					Code	Type	Active	Maximum	Exemption	HV	Veteran	Yes	999,999	51,238	<table border="1"> <thead> <tr> <th>Number</th> <th>Description</th> <th>Opened</th> <th>Closed</th> <th>Amount</th> </tr> </thead> <tbody> <tr> <td>R19 000292</td> <td>R21- NEW 2795 SQ FT SFR</td> <td>08/2019</td> <td>03/2020</td> <td>200,000</td> </tr> </tbody> </table>					Number	Description	Opened	Closed	Amount	R19 000292	R21- NEW 2795 SQ FT SFR	08/2019	03/2020	200,000																																												
Code	Type	Active	Maximum	Exemption																																																																					
HV	Veteran	Yes	999,999	51,238																																																																					
Number	Description	Opened	Closed	Amount																																																																					
R19 000292	R21- NEW 2795 SQ FT SFR	08/2019	03/2020	200,000																																																																					
Parcel Valuation					<table border="1"> <thead> <tr> <th>Source</th> <th>REAL</th> <th>Fair Cash</th> <th>Capped</th> <th>Asmnt Level</th> <th>Assessed</th> <th>Levy Rate</th> <th>97.960</th> <th>Current Tax</th> </tr> </thead> <tbody> <tr> <td>Remove Cap</td> <td>2021</td> <td>Land Value 75,881</td> <td>75,262</td> <td>11%</td> <td>8,279</td> <td>Assessed</td> <td>51,238</td> <td>5,019.27</td> </tr> <tr> <td>Year Frozen</td> <td></td> <td>Improvements 391,096</td> <td>390,535</td> <td></td> <td>42,959</td> <td>Penalty</td> <td>0</td> <td></td> </tr> <tr> <td>Uncapped Value</td> <td>0</td> <td>Mobile Home 0</td> <td>0</td> <td></td> <td>0</td> <td>Exemption</td> <td>51,238</td> <td>-5,019.00</td> </tr> <tr> <td>TIF Project ID</td> <td>0</td> <td>Total Value 466,977</td> <td>465,797</td> <td></td> <td>51,238</td> <td>Total Taxable</td> <td>0</td> <td>0.00</td> </tr> </tbody> </table>					Source	REAL	Fair Cash	Capped	Asmnt Level	Assessed	Levy Rate	97.960	Current Tax	Remove Cap	2021	Land Value 75,881	75,262	11%	8,279	Assessed	51,238	5,019.27	Year Frozen		Improvements 391,096	390,535		42,959	Penalty	0		Uncapped Value	0	Mobile Home 0	0		0	Exemption	51,238	-5,019.00	TIF Project ID	0	Total Value 466,977	465,797		51,238	Total Taxable	0	0.00																			
Source	REAL	Fair Cash	Capped	Asmnt Level	Assessed	Levy Rate	97.960	Current Tax																																																																	
Remove Cap	2021	Land Value 75,881	75,262	11%	8,279	Assessed	51,238	5,019.27																																																																	
Year Frozen		Improvements 391,096	390,535		42,959	Penalty	0																																																																		
Uncapped Value	0	Mobile Home 0	0		0	Exemption	51,238	-5,019.00																																																																	
TIF Project ID	0	Total Value 466,977	465,797		51,238	Total Taxable	0	0.00																																																																	
Assessment History					<table border="1"> <thead> <tr> <th>Tax Year</th> <th>Statement Number</th> <th>Billed Owner</th> <th>Tax Area</th> <th>Total Value</th> <th>Exemptions</th> <th>Taxable Value</th> <th>Billed Tax</th> </tr> </thead> <tbody> <tr> <td>2025</td> <td>2025-660101384</td> <td>HARTMAN, STEPHEN</td> <td>3</td> <td>452,231</td> <td>49746</td> <td></td> <td>.00</td> </tr> <tr> <td>2024</td> <td>2024-660101384</td> <td>HARTMAN, STEPHEN</td> <td>3</td> <td>579,183</td> <td>48937</td> <td></td> <td>.00</td> </tr> <tr> <td>2023</td> <td>2023-660101384</td> <td>HARTMAN, STEPHEN</td> <td>3</td> <td>454,636</td> <td>47512</td> <td></td> <td>.00</td> </tr> <tr> <td>2022</td> <td>2022-660101384</td> <td>HARTMAN, STEPHEN</td> <td>3</td> <td>448,598</td> <td>46128</td> <td></td> <td>.00</td> </tr> <tr> <td>2021</td> <td>2021-660101384</td> <td>HARTMAN, STEPHEN</td> <td>3</td> <td>407,132</td> <td>44785</td> <td></td> <td>.00</td> </tr> <tr> <td>2020</td> <td>2020-660101384</td> <td>HARTMAN, STEPHEN</td> <td>3</td> <td>77,625</td> <td>0</td> <td>8,539</td> <td>825.00</td> </tr> <tr> <td>2019</td> <td>2019-660101384</td> <td>BRAVO CONSTRUCTION &</td> <td>3</td> <td>863</td> <td>0</td> <td>95</td> <td>9.00</td> </tr> </tbody> </table>					Tax Year	Statement Number	Billed Owner	Tax Area	Total Value	Exemptions	Taxable Value	Billed Tax	2025	2025-660101384	HARTMAN, STEPHEN	3	452,231	49746		.00	2024	2024-660101384	HARTMAN, STEPHEN	3	579,183	48937		.00	2023	2023-660101384	HARTMAN, STEPHEN	3	454,636	47512		.00	2022	2022-660101384	HARTMAN, STEPHEN	3	448,598	46128		.00	2021	2021-660101384	HARTMAN, STEPHEN	3	407,132	44785		.00	2020	2020-660101384	HARTMAN, STEPHEN	3	77,625	0	8,539	825.00	2019	2019-660101384	BRAVO CONSTRUCTION &	3	863	0	95	9.00
Tax Year	Statement Number	Billed Owner	Tax Area	Total Value	Exemptions	Taxable Value	Billed Tax																																																																		
2025	2025-660101384	HARTMAN, STEPHEN	3	452,231	49746		.00																																																																		
2024	2024-660101384	HARTMAN, STEPHEN	3	579,183	48937		.00																																																																		
2023	2023-660101384	HARTMAN, STEPHEN	3	454,636	47512		.00																																																																		
2022	2022-660101384	HARTMAN, STEPHEN	3	448,598	46128		.00																																																																		
2021	2021-660101384	HARTMAN, STEPHEN	3	407,132	44785		.00																																																																		
2020	2020-660101384	HARTMAN, STEPHEN	3	77,625	0	8,539	825.00																																																																		
2019	2019-660101384	BRAVO CONSTRUCTION &	3	863	0	95	9.00																																																																		



Rogers

Assessment Property Record Card for Tax Year 2026

Data provided by LISA DELOZIER County Assessor

Date 04/18/2026
Time 09:42:34
Page 2

Lot Data	Square-Foot - NBHD 1011 #1	Primary Image
Lot Size	0 0	
Lot Count	1	
Units Buildable		
Non-Ag Acres	0.6452	
Topography		
Street Access		
Utilities		
Amenities	LAND QUALITY 0	
	0	
Method	Square-Foot	
Base Lot Value	28,104.00 x 2.70 = 75,881	
Factor Value		
Adjustments	1.0000	
Lot Value	75,881	

Residential Data	
Type	1 Single Family Residence
Condition	3 - Average
Quality	3.5 - Average
Architecture	
Style	100% One Story
Exterior Wall	100% Veneer, Masonry
Base/Total Area	2,693 / 2,693
Style	100% One Story
HVAC	100% Warmed & Cooled Air
Roof Cover	1 Composition Shingle
Area on Slab	2,693
Fixture/RghIn	16 /
Bed/F/H Bath	4 / 3.0 / 1.0
Basement Area	
Garage Type	880 Attached Garage - Unfinished
Remodel	
Year/Eff Age	2020 / 5



GRM Approach	
GRM Code	
Gross Rent	0.00
Indicated Value	

Multiple Regression			
MRA Code	1	Test	
Adusted R	0.8445		
Indicated Value	392,463	145.73	Per SqFt

Direct Comparables			
Selection Model	A	Adam Test	
Adjustment Model	1	2022 Residential	
Comparables	6		
Indicated Value	544,070		Per SqFt

Cost Approach				Manual : 01/2025			
Base Cost	107.29	Total Misc Impr	+	20,685			
Roofing Adj	+ 5.11	Garage Cost	+	32,745			
Subfloor Adj	+ -3.29	Total RCN	=	411,680			
Heat/Cool Adj	+ 14.47	Depreciation (5%)	-	20,584			
Plumbing Adj	+ 9.45	Lump Sums	+	0			
Basement Adj	+ 0.00	RCNLD	=	391,096			
Adj Base Cost	= 133.03	Lot Value	+	75,881			
Total Area	x 2,693	Indicated Value	=	466,977			
Adjusted Cost	= 358,250	Value Per SqFt		173.40			

Value Reconciliation			
Selected Approach	Cost Approach		
Improvements	391,096		
Lot Value	75,881		
Indicated Value	466,977	173.40	Per SqFt
Agland Value			
Site Improvements			
Total Value	466,977	173.40	Total Value Per SqFt

Miscellaneous Improvements								
Code	Description	Sketch ID	Size	Year	Units	Unit Cost	Depr	Value
PRCH	SLAB PORCH - COVERED	145494	356		356	28.30		10,075
PRCH	SLAB PORCH - COVERED	145496	144		144	29.03		4,180
FPR1	FIREPLACE - RESIDENTIAL 1 STORY		1		1	6,429.63		6,430
SHLT	STORM SHELTER		1	2020	1	0.00		



Rogers

Assessment Property Record Card for Tax Year 2026

Data provided by LISA DELOZIER County Assessor

Date 04/18/2026
 Time 09:42:34
 Page 3

Sketch Image

660101384

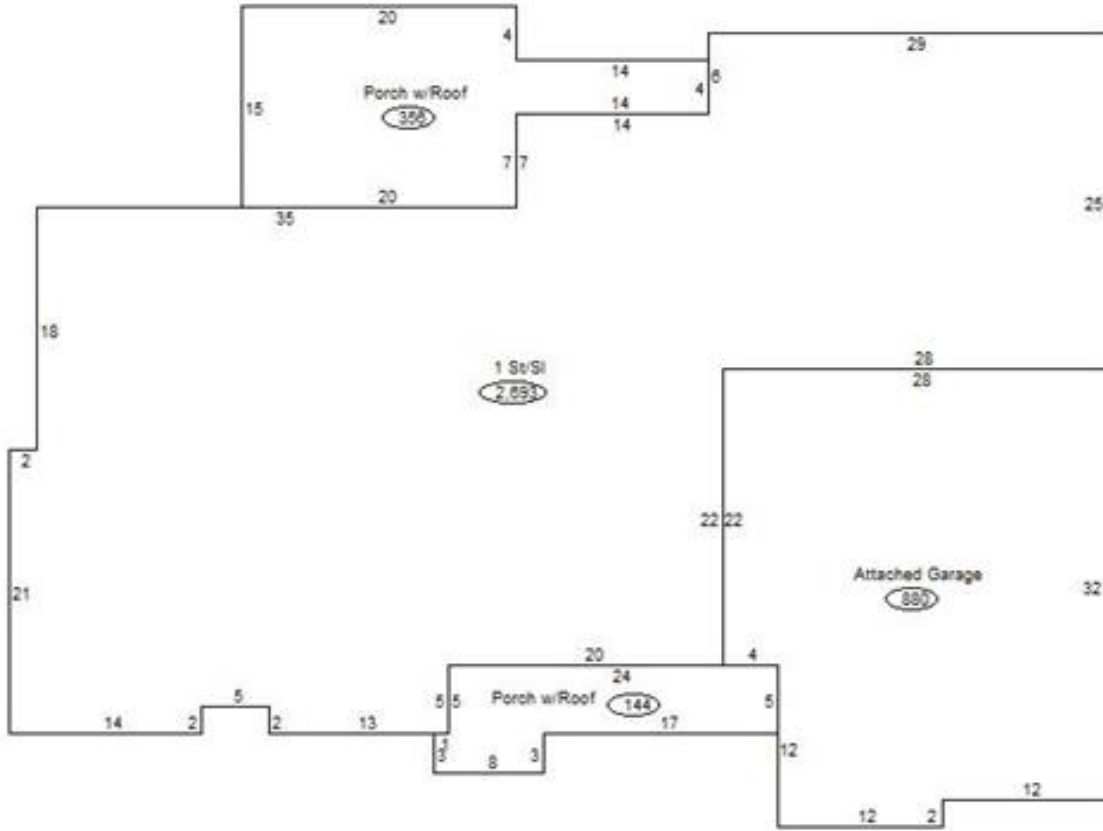

Sketch Vector Information

Sequence	Code	Type	Built Over	Scale	Section Label	Base Area	Multiplier	Total Area
1	G	1		13	Attached Garage	880	1.000	880
2	M	PRCH		13	SLBC	356	1.000	356
3	R	1	Slab	13	1 St/Sl	2,693	1.000	2,693
4	M	PRCH		13	SLBC	144	1.000	144
Total Building Area						2,693		2,693