



# Rogers

## Assessment Property Record Card for Tax Year 2026

Data provided by LISA DELOZIER County Assessor

Date 04/18/2026  
Time 09:45:44  
Page 1

Assessment Data					Primary Image																																																																				
<b>Account</b> 660101653 <b>Parcel ID</b> 000000000-0000415-004-0002 <b>Cadastral ID</b> 30-21-16-12910 <b>Property Type</b> REAL - Real Property <b>Property Class</b> URP VI Area 1 <b>Tax Area</b> 85 - CLRM SD-VERD TOWN/FIRE <b>Name ID</b> 329275 BORDEAUX, TRAVIS J & JENNIFER L  10224 E KATHY ST CLAREMORE OK 74019-0000  <b>Parcel Location</b> <b>Situs</b> 10224 E KATHY ST <b>Subdivision</b> KING RIDGE III <b>Lot/Block</b> 0002 / 0004 <b>Parcel Size</b> 1 - Lots <b>Sec/Twn/Rng</b> 30 / 21 / 16 / 5 <b>Neighborhood</b> 1109 - R-V03-SW VERDIGRIS <b>School District</b> S001 - CLAREMORE SCHOOLS																																																																									
<b>Legal Description</b> Lot/Long: 36.27183710 -95.64718621																																																																									
<b>Building Permits</b>					<table border="1"> <thead> <tr> <th>Number</th> <th>Description</th> <th>Opened</th> <th>Closed</th> <th>Amount</th> </tr> </thead> <tbody> <tr> <td>R19 53</td> <td>R20- NEW 1559 SQ FT SFR</td> <td>07/2019</td> <td>12/2019</td> <td>100,000</td> </tr> </tbody> </table>					Number	Description	Opened	Closed	Amount	R19 53	R20- NEW 1559 SQ FT SFR	07/2019	12/2019	100,000																																																						
Number	Description	Opened	Closed	Amount																																																																					
R19 53	R20- NEW 1559 SQ FT SFR	07/2019	12/2019	100,000																																																																					
<b>Exemptions</b>					<b>Sale History</b>																																																																				
<table border="1"> <thead> <tr> <th>Code</th> <th>Type</th> <th>Active</th> <th>Maximum</th> <th>Exemption</th> </tr> </thead> <tbody> <tr> <td>H</td> <td>Homestead</td> <td>Yes</td> <td>1,000</td> <td>1,000</td> </tr> </tbody> </table>					Code	Type	Active	Maximum	Exemption	H	Homestead	Yes	1,000	1,000	<table border="1"> <thead> <tr> <th>Bk/Pg</th> <th>Grantor</th> <th>Date</th> <th>Price</th> <th>Code</th> </tr> </thead> <tbody> <tr> <td>/</td> <td>RC VERDIGRIS LLC</td> <td>10/31/2019</td> <td>155,500</td> <td>YES</td> </tr> <tr> <td>/</td> <td>RC VERDIGRIS LAND, LLC</td> <td>07/25/2018</td> <td>0</td> <td>WB</td> </tr> </tbody> </table>					Bk/Pg	Grantor	Date	Price	Code	/	RC VERDIGRIS LLC	10/31/2019	155,500	YES	/	RC VERDIGRIS LAND, LLC	07/25/2018	0	WB																																							
Code	Type	Active	Maximum	Exemption																																																																					
H	Homestead	Yes	1,000	1,000																																																																					
Bk/Pg	Grantor	Date	Price	Code																																																																					
/	RC VERDIGRIS LLC	10/31/2019	155,500	YES																																																																					
/	RC VERDIGRIS LAND, LLC	07/25/2018	0	WB																																																																					
<b>Parcel Valuation</b>																																																																									
<table border="1"> <thead> <tr> <th>Source</th> <th>REAL</th> </tr> </thead> <tbody> <tr> <td>Remove Cap</td> <td>2020</td> </tr> <tr> <td>Year Frozen</td> <td></td> </tr> <tr> <td>Uncapped Value</td> <td>0</td> </tr> <tr> <td>TIF Project ID</td> <td>0</td> </tr> </tbody> </table>		Source	REAL	Remove Cap	2020	Year Frozen		Uncapped Value	0	TIF Project ID	0	<table border="1"> <thead> <tr> <th>Fair Cash</th> <th>Capped</th> <th>Asmnt Level</th> <th>Assessed</th> </tr> </thead> <tbody> <tr> <td>Land Value</td> <td>39,746</td> <td>28,185</td> <td>3,100</td> </tr> <tr> <td>Improvements</td> <td>195,274</td> <td>163,249</td> <td>17,957</td> </tr> <tr> <td>Mobile Home</td> <td>0</td> <td>0</td> <td>0</td> </tr> <tr> <td>Total Value</td> <td>235,020</td> <td>191,434</td> <td>21,057</td> </tr> </tbody> </table>			Fair Cash	Capped	Asmnt Level	Assessed	Land Value	39,746	28,185	3,100	Improvements	195,274	163,249	17,957	Mobile Home	0	0	0	Total Value	235,020	191,434	21,057	<table border="1"> <thead> <tr> <th>Levy Rate</th> <th>Current Tax</th> </tr> </thead> <tbody> <tr> <td>109.172</td> <td>2,298.83</td> </tr> <tr> <td>Assessed</td> <td>21,057</td> </tr> <tr> <td>Penalty</td> <td>0</td> </tr> <tr> <td>Exemption</td> <td>1,000</td> </tr> <tr> <td>Total Taxable</td> <td>20,057</td> </tr> <tr> <td></td> <td>-92.00</td> </tr> <tr> <td></td> <td>2,207.00</td> </tr> </tbody> </table>		Levy Rate	Current Tax	109.172	2,298.83	Assessed	21,057	Penalty	0	Exemption	1,000	Total Taxable	20,057		-92.00		2,207.00																					
Source	REAL																																																																								
Remove Cap	2020																																																																								
Year Frozen																																																																									
Uncapped Value	0																																																																								
TIF Project ID	0																																																																								
Fair Cash	Capped	Asmnt Level	Assessed																																																																						
Land Value	39,746	28,185	3,100																																																																						
Improvements	195,274	163,249	17,957																																																																						
Mobile Home	0	0	0																																																																						
Total Value	235,020	191,434	21,057																																																																						
Levy Rate	Current Tax																																																																								
109.172	2,298.83																																																																								
Assessed	21,057																																																																								
Penalty	0																																																																								
Exemption	1,000																																																																								
Total Taxable	20,057																																																																								
	-92.00																																																																								
	2,207.00																																																																								
<b>Assessment History</b>																																																																									
<table border="1"> <thead> <tr> <th>Tax Year</th> <th>Statement Number</th> <th>Billed Owner</th> <th>Tax Area</th> <th>Total Value</th> <th>Exemptions</th> <th>Taxable Value</th> <th>Billed Tax</th> </tr> </thead> <tbody> <tr> <td>2025</td> <td>2025-660101653</td> <td>BORDEAUX, TRAVIS J &amp;</td> <td>85</td> <td>227,191</td> <td>1000</td> <td>19,444</td> <td>2,139.00</td> </tr> <tr> <td>2024</td> <td>2024-660101653</td> <td>BORDEAUX, TRAVIS J &amp;</td> <td>85</td> <td>227,821</td> <td>1000</td> <td>18,849</td> <td>1,946.00</td> </tr> <tr> <td>2023</td> <td>2023-660101653</td> <td>BORDEAUX, TRAVIS J &amp;</td> <td>85</td> <td>197,921</td> <td>1000</td> <td>18,271</td> <td>1,873.00</td> </tr> <tr> <td>2022</td> <td>2022-660101653</td> <td>BORDEAUX, TRAVIS J &amp;</td> <td>85</td> <td>199,738</td> <td>1000</td> <td>17,710</td> <td>1,832.00</td> </tr> <tr> <td>2021</td> <td>2021-660101653</td> <td>BORDEAUX, TRAVIS J &amp;</td> <td>85</td> <td>165,135</td> <td>1000</td> <td>17,165</td> <td>1,703.00</td> </tr> <tr> <td>2020</td> <td>2020-660101653</td> <td>BORDEAUX, TRAVIS J &amp;</td> <td>85</td> <td>162,586</td> <td>1000</td> <td>16,884</td> <td>1,730.00</td> </tr> <tr> <td>2019</td> <td>2019-660101653</td> <td>RC VERDIGRIS LLC</td> <td>85</td> <td>3,987</td> <td>0</td> <td>439</td> <td>46.00</td> </tr> </tbody> </table>										Tax Year	Statement Number	Billed Owner	Tax Area	Total Value	Exemptions	Taxable Value	Billed Tax	2025	2025-660101653	BORDEAUX, TRAVIS J &	85	227,191	1000	19,444	2,139.00	2024	2024-660101653	BORDEAUX, TRAVIS J &	85	227,821	1000	18,849	1,946.00	2023	2023-660101653	BORDEAUX, TRAVIS J &	85	197,921	1000	18,271	1,873.00	2022	2022-660101653	BORDEAUX, TRAVIS J &	85	199,738	1000	17,710	1,832.00	2021	2021-660101653	BORDEAUX, TRAVIS J &	85	165,135	1000	17,165	1,703.00	2020	2020-660101653	BORDEAUX, TRAVIS J &	85	162,586	1000	16,884	1,730.00	2019	2019-660101653	RC VERDIGRIS LLC	85	3,987	0	439	46.00
Tax Year	Statement Number	Billed Owner	Tax Area	Total Value	Exemptions	Taxable Value	Billed Tax																																																																		
2025	2025-660101653	BORDEAUX, TRAVIS J &	85	227,191	1000	19,444	2,139.00																																																																		
2024	2024-660101653	BORDEAUX, TRAVIS J &	85	227,821	1000	18,849	1,946.00																																																																		
2023	2023-660101653	BORDEAUX, TRAVIS J &	85	197,921	1000	18,271	1,873.00																																																																		
2022	2022-660101653	BORDEAUX, TRAVIS J &	85	199,738	1000	17,710	1,832.00																																																																		
2021	2021-660101653	BORDEAUX, TRAVIS J &	85	165,135	1000	17,165	1,703.00																																																																		
2020	2020-660101653	BORDEAUX, TRAVIS J &	85	162,586	1000	16,884	1,730.00																																																																		
2019	2019-660101653	RC VERDIGRIS LLC	85	3,987	0	439	46.00																																																																		



# Rogers

## Assessment Property Record Card for Tax Year 2026

Data provided by LISA DELOZIER County Assessor

Date 04/18/2026  
Time 09:45:45  
Page 2

Lot Data		Square-Foot - NBHD 1109 #1	
Lot Size	0	0	
Lot Count	1		
Units Buildable			
Non-Ag Acres	0.2054		
Topography			
Street Access			
Utilities			
Amenities			0
			0
Method	Square-Foot		
Base Lot Value	8,945.00 x 5.55 = 49,683		
Factor Value			
Adjustments	0.8000		
Lot Value	39,746		



\\tsclient\T\TOMMY DUNLAP\New folder (161)\IMG\_0057.JPG 3/29/2023

Residential Data	
Type	1 Single Family Residence
Condition	3 - Average
Quality	2.5 - Fair
Architecture	
Style	100% One Story
Exterior Wall	80% Frame, Siding, Vinyl 20% Veneer, Masonry
Base/Total Area	1,567 / 1,567
Style	100% One Story
HVAC	100% Warmed & Cooled Air
Roof Cover	1 Composition Shingle
Area on Slab	1,567
Fixture/RghIn	11 /
Bed/F/H Bath	4 / 2.0 /
Basement Area	
Garage Type	389 Attached Garage - Unfinished
Remodel	
Year/Eff Age	2019 / 5

GRM Approach	
GRM Code	
Gross Rent	0.00
Indicated Value	

Multiple Regression			
MRA Code	1	Test	
Adusted R	0.8445		
Indicated Value	210,898	134.59	Per SqFt

Direct Comparables			
Selection Model	A	Adam Test	
Adjustment Model	1	2022 Residential	
Comparables	8		
Indicated Value	195,590		Per SqFt

Cost Approach				Manual : 01/2025			
Base Cost	98.37	Total Misc Impr	+	2,699			
Roofing Adj	+ 4.47	Garage Cost	+	11,460			
Subfloor Adj	+ -1.15	Total RCN	=	205,552			
Heat/Cool Adj	+ 11.47	Depreciation ( 5%)	-	10,278			
Plumbing Adj	+ 8.98	Lump Sums	+	0			
Basement Adj	+ 0.00	RCNLD	=	195,274			
Adj Base Cost	= 122.14	Lot Value	+	39,746			
Total Area	x 1,567	Indicated Value	=	235,020			
Adjusted Cost	= 191,393	Value Per SqFt		149.98			

Value Reconciliation			
Selected Approach	Cost Approach		
Improvements	195,274		
Lot Value	39,746		
Indicated Value	235,020	149.98	Per SqFt
Agland Value			
Site Improvements			
Total Value	235,020	149.98	Total Value Per SqFt

Miscellaneous Improvements								
Code	Description	Sketch ID	Size	Year	Units	Unit Cost	Depr	Value
PATO	SLAB PORCH - OPEN	143192	14x7		98	10.86		1,064
PRCH	SLAB PORCH - COVERED	143193	68		68	24.05		1,635



# Rogers

## Assessment Property Record Card for Tax Year 2026

Data provided by LISA DELOZIER County Assessor

Date 04/18/2026

Time 09:45:45

Page 3

### Sketch Image

660101653

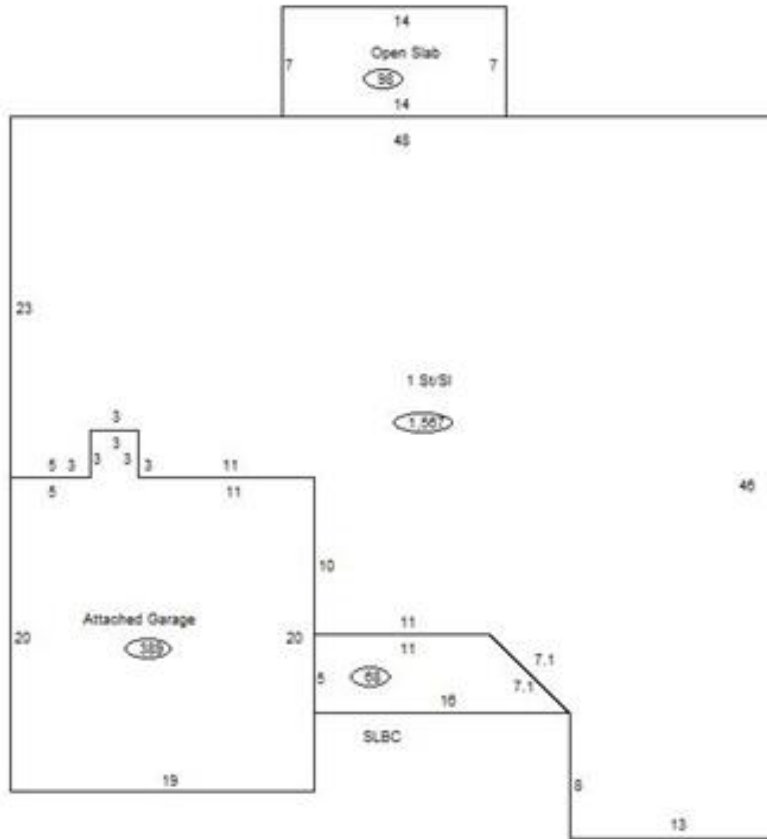

### Sketch Vector Information

Sequence	Code	Type	Built Over	Scale	Section Label	Base Area	Multiplier	Total Area
1	R	1	Slab	10	1 St/SI	1,567	1.000	1,567
2	G	1		10	Attached Garage	389	1.000	389
3	M	PATO		10	Open Slab	98	1.000	98
4	M	PRCH		10	SLBC	68	1.000	68
<b>Total Building Area</b>						<b>1,567</b>		<b>1,567</b>