



Rogers

Assessment Property Record Card for Tax Year 2026

Data provided by LISA DELOZIER County Assessor

Date 04/18/2026
Time 09:45:55
Page 1

Assessment Data					Primary Image																																																																				
Account 660101659 Parcel ID 000000000-0000415-004-0008 Cadastral ID 30-21-16-12970 Property Type REAL - Real Property Property Class URP VI Area 1 Tax Area 85 - CLRM SD-VERD TOWN/FIRE Name ID 328357 RUSH, HUNTER MASON 10118 E KATHY ST CLAREMORE OK 74019-0000 Parcel Location Situs 10118 E KATHY ST Subdivision KING RIDGE III Lot/Block 0008 / 0004 Parcel Size 1 - Lots Sec/Twn/Rng 30 / 21 / 16 / 5 Neighborhood 1109 - R-V03-SW VERDIGRIS School District S001 - CLAREMORE SCHOOLS																																																																									
Legal Description Lot/Long: 36.27199867 -95.64856202																																																																									
Building Permits					<table border="1"> <thead> <tr> <th>Number</th> <th>Description</th> <th>Opened</th> <th>Closed</th> <th>Amount</th> </tr> </thead> <tbody> <tr> <td>R19 27</td> <td>R20- NEW 1243 SQ FT SFR</td> <td>04/2019</td> <td>09/2019</td> <td>100,000</td> </tr> </tbody> </table>					Number	Description	Opened	Closed	Amount	R19 27	R20- NEW 1243 SQ FT SFR	04/2019	09/2019	100,000																																																						
Number	Description	Opened	Closed	Amount																																																																					
R19 27	R20- NEW 1243 SQ FT SFR	04/2019	09/2019	100,000																																																																					
Exemptions					Sale History																																																																				
<table border="1"> <thead> <tr> <th>Code</th> <th>Type</th> <th>Active</th> <th>Maximum</th> <th>Exemption</th> </tr> </thead> <tbody> <tr> <td>H</td> <td>Homestead</td> <td>Yes</td> <td>1,000</td> <td>1,000</td> </tr> </tbody> </table>					Code	Type	Active	Maximum	Exemption	H	Homestead	Yes	1,000	1,000	<table border="1"> <thead> <tr> <th>Bk/Pg</th> <th>Grantor</th> <th>Date</th> <th>Price</th> <th>Code</th> </tr> </thead> <tbody> <tr> <td>/</td> <td>RC VERDIGRIS LLC</td> <td>07/31/2019</td> <td>147,500</td> <td>YES</td> </tr> <tr> <td>/</td> <td>RC VERDIGRIS LAND, LLC</td> <td>07/25/2018</td> <td>0</td> <td>WB</td> </tr> </tbody> </table>					Bk/Pg	Grantor	Date	Price	Code	/	RC VERDIGRIS LLC	07/31/2019	147,500	YES	/	RC VERDIGRIS LAND, LLC	07/25/2018	0	WB																																							
Code	Type	Active	Maximum	Exemption																																																																					
H	Homestead	Yes	1,000	1,000																																																																					
Bk/Pg	Grantor	Date	Price	Code																																																																					
/	RC VERDIGRIS LLC	07/31/2019	147,500	YES																																																																					
/	RC VERDIGRIS LAND, LLC	07/25/2018	0	WB																																																																					
Parcel Valuation																																																																									
<table border="1"> <thead> <tr> <th>Source</th> <th>REAL</th> </tr> </thead> <tbody> <tr> <td>Remove Cap</td> <td>2020</td> </tr> </tbody> </table>		Source	REAL	Remove Cap	2020	<table border="1"> <thead> <tr> <th>Fair Cash</th> <th>Capped</th> <th>Asmnt Level</th> <th>Assessed</th> </tr> </thead> <tbody> <tr> <td>Land Value</td> <td>48,192</td> <td>26,842</td> <td>11%</td> <td>2,953</td> </tr> <tr> <td>Improvements</td> <td>156,097</td> <td>144,324</td> <td></td> <td>15,876</td> </tr> <tr> <td>Uncapped Value</td> <td>0</td> <td>0</td> <td>0</td> <td>0</td> </tr> <tr> <td>TIF Project ID</td> <td>0</td> <td></td> <td></td> <td></td> </tr> <tr> <td>Total Value</td> <td>204,289</td> <td>171,166</td> <td></td> <td>18,829</td> </tr> </tbody> </table>			Fair Cash	Capped	Asmnt Level	Assessed	Land Value	48,192	26,842	11%	2,953	Improvements	156,097	144,324		15,876	Uncapped Value	0	0	0	0	TIF Project ID	0				Total Value	204,289	171,166		18,829	<table border="1"> <thead> <tr> <th>Levy Rate</th> <th>Current Tax</th> </tr> </thead> <tbody> <tr> <td>109.172</td> <td>2,055.60</td> </tr> <tr> <td>Assessed</td> <td>18,829</td> </tr> <tr> <td>Penalty</td> <td>0</td> </tr> <tr> <td>Exemption</td> <td>1,000</td> </tr> <tr> <td>Total Taxable</td> <td>17,829</td> </tr> </tbody> </table>		Levy Rate	Current Tax	109.172	2,055.60	Assessed	18,829	Penalty	0	Exemption	1,000	Total Taxable	17,829																						
Source	REAL																																																																								
Remove Cap	2020																																																																								
Fair Cash	Capped	Asmnt Level	Assessed																																																																						
Land Value	48,192	26,842	11%	2,953																																																																					
Improvements	156,097	144,324		15,876																																																																					
Uncapped Value	0	0	0	0																																																																					
TIF Project ID	0																																																																								
Total Value	204,289	171,166		18,829																																																																					
Levy Rate	Current Tax																																																																								
109.172	2,055.60																																																																								
Assessed	18,829																																																																								
Penalty	0																																																																								
Exemption	1,000																																																																								
Total Taxable	17,829																																																																								
Assessment History																																																																									
<table border="1"> <thead> <tr> <th>Tax Year</th> <th>Statement Number</th> <th>Billed Owner</th> <th>Tax Area</th> <th>Total Value</th> <th>Exemptions</th> <th>Taxable Value</th> <th>Billed Tax</th> </tr> </thead> <tbody> <tr> <td>2025</td> <td>2025-660101659</td> <td>RUSH, HUNTER MASON</td> <td>85</td> <td>198,006</td> <td>1000</td> <td>17,280</td> <td>1,903.00</td> </tr> <tr> <td>2024</td> <td>2024-660101659</td> <td>RUSH, HUNTER MASON</td> <td>85</td> <td>200,308</td> <td>1000</td> <td>16,747</td> <td>1,731.00</td> </tr> <tr> <td>2023</td> <td>2023-660101659</td> <td>RUSH, HUNTER MASON</td> <td>85</td> <td>176,180</td> <td>1000</td> <td>16,231</td> <td>1,665.00</td> </tr> <tr> <td>2022</td> <td>2022-660101659</td> <td>RUSH, HUNTER MASON</td> <td>85</td> <td>177,696</td> <td>1000</td> <td>15,729</td> <td>1,628.00</td> </tr> <tr> <td>2021</td> <td>2021-660101659</td> <td>RUSH, HUNTER MASON</td> <td>85</td> <td>147,651</td> <td>1000</td> <td>15,242</td> <td>1,513.00</td> </tr> <tr> <td>2020</td> <td>2020-660101659</td> <td>RUSH, HUNTER MASON</td> <td>85</td> <td>145,414</td> <td>1000</td> <td>14,996</td> <td>1,538.00</td> </tr> <tr> <td>2019</td> <td>2019-660101659</td> <td>RUSH, HUNTER MASON</td> <td>85</td> <td>3,987</td> <td>0</td> <td>439</td> <td>46.00</td> </tr> </tbody> </table>										Tax Year	Statement Number	Billed Owner	Tax Area	Total Value	Exemptions	Taxable Value	Billed Tax	2025	2025-660101659	RUSH, HUNTER MASON	85	198,006	1000	17,280	1,903.00	2024	2024-660101659	RUSH, HUNTER MASON	85	200,308	1000	16,747	1,731.00	2023	2023-660101659	RUSH, HUNTER MASON	85	176,180	1000	16,231	1,665.00	2022	2022-660101659	RUSH, HUNTER MASON	85	177,696	1000	15,729	1,628.00	2021	2021-660101659	RUSH, HUNTER MASON	85	147,651	1000	15,242	1,513.00	2020	2020-660101659	RUSH, HUNTER MASON	85	145,414	1000	14,996	1,538.00	2019	2019-660101659	RUSH, HUNTER MASON	85	3,987	0	439	46.00
Tax Year	Statement Number	Billed Owner	Tax Area	Total Value	Exemptions	Taxable Value	Billed Tax																																																																		
2025	2025-660101659	RUSH, HUNTER MASON	85	198,006	1000	17,280	1,903.00																																																																		
2024	2024-660101659	RUSH, HUNTER MASON	85	200,308	1000	16,747	1,731.00																																																																		
2023	2023-660101659	RUSH, HUNTER MASON	85	176,180	1000	16,231	1,665.00																																																																		
2022	2022-660101659	RUSH, HUNTER MASON	85	177,696	1000	15,729	1,628.00																																																																		
2021	2021-660101659	RUSH, HUNTER MASON	85	147,651	1000	15,242	1,513.00																																																																		
2020	2020-660101659	RUSH, HUNTER MASON	85	145,414	1000	14,996	1,538.00																																																																		
2019	2019-660101659	RUSH, HUNTER MASON	85	3,987	0	439	46.00																																																																		



Rogers

Assessment Property Record Card for Tax Year 2026

Data provided by LISA DELOZIER County Assessor

Date 04/18/2026
 Time 09:45:55
 Page 2

Lot Data		Square-Foot - NBHD 1109 #1	
Lot Size	0	0	
Lot Count	1		
Units Buildable			
Non-Ag Acres	0.1956		
Topography			
Street Access			
Utilities			
Amenities			0
			0
Method	Square-Foot		
Base Lot Value	8,519.00 x 5.66 = 48,192		
Factor Value			
Adjustments	1.0000		
Lot Value	48,192		



\\tsclient\T\TOMMY DUNLAP\New folder (161)\IMG_0063.JPG 3/29/2023

Residential Data	
Type	1 Single Family Residence
Condition	3 - Average
Quality	2 - Fair
Architecture	
Style	100% One Story
Exterior Wall	80% Frame, Siding, Vinyl 20% Veneer, Masonry
Base/Total Area	1,242 / 1,242
Style	100% One Story
HVAC	100% Warmed & Cooled Air
Roof Cover	1 Composition Shingle
Area on Slab	1,242
Fixture/RghIn	11 /
Bed/F/H Bath	3 / 2.0 /
Basement Area	
Garage Type	606 Attached Garage - Unfinished
Remodel	
Year/Eff Age	2019 / 5

GRM Approach

GRM Code	
Gross Rent	0.00
Indicated Value	

Multiple Regression

MRA Code	1	Test
Adjusted R	0.8445	
Indicated Value	195,115	157.10 Per SqFt

Direct Comparables

Selection Model	A	Adam Test
Adjustment Model	1	2022 Residential
Comparables	8	
Indicated Value	195,000	Per SqFt

Value Reconciliation

Selected Approach	Cost Approach		
Improvements	156,097		
Lot Value	48,192		
Indicated Value	204,289	164.48	Per SqFt
Agland Value			
Site Improvements			
Total Value	204,289	164.48	Total Value Per SqFt

Cost Approach		Manual : 01/2025	
Base Cost	95.67	Total Misc Impr	+ 1,263
Roofing Adj	+ 4.23	Garage Cost	+ 13,538
Subfloor Adj	+ 0.00	Total RCN	= 164,313
Heat/Cool Adj	+ 10.30	Depreciation (5%)	- 8,216
Plumbing Adj	+ 10.18	Lump Sums	+ 0
Basement Adj	+ 0.00	RCNLD	= 156,097
Adj Base Cost	= 120.38	Lot Value	+ 48,192
Total Area	x 1,242	Indicated Value	= 204,289
Adjusted Cost	= 149,512	Value Per SqFt	164.48

Miscellaneous Improvements

Code	Description	Sketch ID	Size	Year	Units	Unit Cost	Depr	Value
PATO	SLAB PORCH - OPEN	143102	4x4		16	10.24		164
PRCH	SLAB PORCH - COVERED	143103	13x4		52	21.13		1,099



Rogers

Assessment Property Record Card for Tax Year 2026

Data provided by LISA DELOZIER County Assessor

Date 04/18/2026
 Time 09:45:55
 Page 3

Sketch Image

660101659

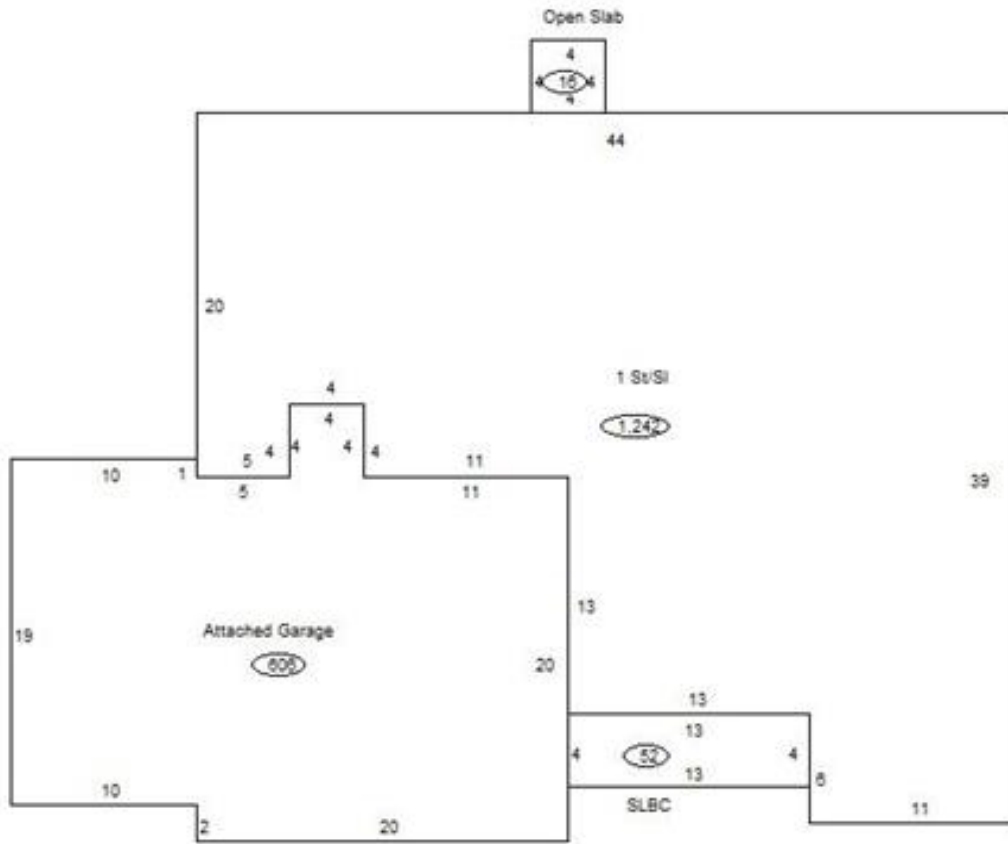

Sketch Vector Information

Sequence	Code	Type	Built Over	Scale	Section Label	Base Area	Multiplier	Total Area
1	R	1	Slab	10	1 St/SI	1,242	1.000	1,242
2	G	1		10	Attached Garage	606	1.000	606
3	M	PATO		10	Open Slab	16	1.000	16
4	M	PRCH		10	SLBC	52	1.000	52
Total Building Area						1,242		1,242